

YOUNG, LENNIE K  
YOUNG, DEBORAH L JT  
204 OLD EAST ROAD  
FORT FAIRFIELD ME 04742

B4172P152 B4428P287

Previous Owner  
LEWIS, BRUCE & NANCY JT  
44 STARK LANE

LITCHFIELD NH 03052  
Sale Date: 4/30/2007

| Property Data  |  |  | Assessment Record |        |           |        |        |
|--|--|--|-------------------|--------|-----------|--------|--------|
| Neighborhood <b>1 Resident/Agric.</b>  |  |  | Year              | Land   | Buildings | Exempt | Total  |
| Tree Growth Year <b>0</b>  |  |  | 2010              | 3,500  | 0         | 0      | 3,500  |
| Recertified Date <b>0</b>  |  |  | 2011              | 3,500  | 0         | 0      | 3,500  |
| Y Coordinate <b>0</b>  |  |  | 2012              | 3,500  | 0         | 0      | 3,500  |
| Zone/Land Use <b>11 Residential</b>  |  |  | 2013              | 3,500  | 0         | 0      | 3,500  |
| Secondary Zone   |  |  | 2014              | 3,500  | 0         | 0      | 3,500  |
| Topography <b>2 Rolling</b>  |  |  | 2015              | 10,000 | 0         | 0      | 10,000 |
| 1.Level 4.Below St 7.<br>2.Rolling 5.Low 8.<br>3.Above St 6.Swampy 9.              |  |  | 2016              | 10,000 | 0         | 0      | 10,000 |
| Utilities <b>9 None</b>  |  |  | 2017              | 10,000 | 0         | 0      | 10,000 |
| 1.Public 4.Dr Well 7.Cesspool<br>2.Water 5.Dug Well 8.<br>3.Sewer 6.Septic 9.None  |  |  | 2018              | 10,000 | 0         | 0      | 10,000 |
| Street <b>1 Paved</b>  |  |  |                   |        |           |        |        |
| 1.Paved 4.Proposed 7.<br>2.Semi Imp 5.R/W 8.<br>3.Gravel 6. 9.None                 |  |  |                   |        |           |        |        |
| FLOOD PLAIN <b>0</b>   |  |  |                   |        |           |        |        |
| CLASS <b>1</b>   |  |  |                   |        |           |        |        |
| <b>Sale Data</b>   |  |  |                   |        |           |        |        |
| Sale Date <b>4/30/2007</b>   |  |  |                   |        |           |        |        |
| Price <b>10,500</b>  |  |  |                   |        |           |        |        |
| Sale Type <b>1 Land Only</b>   |  |  |                   |        |           |        |        |
| 1.Land 4.Mobile 7.<br>2.L & B 5.Other 8.<br>3.Building 6. 9.                       |  |  |                   |        |           |        |        |
| Financing <b>9 Unknown</b>   |  |  |                   |        |           |        |        |
| 1.Convent 4.Seller 7.<br>2.FHA/VA 5.Private 8.<br>3.Assumed 6.Cash 9.Unknown       |  |  |                   |        |           |        |        |
| Validity <b>1 Arms Length Sale</b>   |  |  |                   |        |           |        |        |
| 1.Valid 4.Split 7.Changes<br>2.Related 5.Partial 8.Other<br>3.Distress 6.Exempt 9. |  |  |                   |        |           |        |        |
| Verified <b>5 Public Record</b>  |  |  |                   |        |           |        |        |
| 1.Buyer 4.Agent 7.Family<br>2.Seller 5.Pub Rec 8.Other<br>3.Lender 6.MLS 9.        |  |  |                   |        |           |        |        |

| Land Data         |      |                      |       |             |      |                   |
|-------------------|------|----------------------|-------|-------------|------|-------------------|
| Front Foot        | Type | Effective            |       | Influence   |      | Influence Codes   |
|                   |      | Frontage             | Depth | Factor      | Code |                   |
| 11.Regular Lot    |      |                      |       | %           |      | 1.Unimproved      |
| 12.Delta Triangle |      |                      |       | %           |      | 2.Condition       |
| 13.Nabla Triangle |      |                      |       | %           |      | 3.Topography      |
| 14.Rear Land      |      |                      |       | %           |      | 4.Size/Shape      |
| 15.Miscellaneous  |      |                      |       | %           |      | 5.Access          |
|                   |      |                      |       | %           |      | 6.Restricted      |
|                   |      |                      |       | %           |      | 7.Corner Infl     |
|                   |      |                      |       | %           |      | 8.Environment     |
|                   |      |                      |       | %           |      | 9.Fract Share     |
|                   |      |                      |       | %           |      | Acres             |
|                   |      |                      |       | %           |      | 32.Farmland Tilla |
|                   |      |                      |       | %           |      | 33.C R P          |
|                   |      |                      |       | %           |      | 34.Softwood-Farm  |
|                   |      |                      |       | %           |      | 35.Mixed Wood-Far |
|                   |      |                      |       | %           |      | 36.Hardwood-Farm  |
|                   |      |                      |       | %           |      | 37.Softwood-TG    |
|                   |      |                      |       | %           |      | 38.Mixed Wood-TG  |
|                   |      |                      |       | %           |      | 39.Hardwood-TG    |
|                   |      |                      |       | %           |      | 40.Wasteland      |
|                   |      |                      |       | %           |      | 41.Gravel Pit     |
|                   |      |                      |       | %           |      | 42.Mobile Home Si |
|                   |      |                      |       | %           |      | 43.Excess Indust  |
|                   |      |                      |       | %           |      | 44.Lot Improvemen |
|                   |      |                      |       | %           |      | 45.Tower Site     |
|                   |      |                      |       | %           |      | 46.Miscellaneous  |
|                   |      |                      |       | %           |      | 47.Pavement       |
|                   |      |                      |       | %           |      | 48.Farmland Pastu |
|                   |      |                      |       |             |      |                   |
|                   |      | <b>Total Acreage</b> |       | <b>2.07</b> |      |                   |

Inspection Witnessed By:

| X        | Date        |
|----------|-------------|
| No./Date | Description |
|          | Date Insp.  |
|          |             |
|          |             |
|          |             |

Notes:

**Easton**

Map Lot 008-041

Account 702

Location FULLER ROAD

Card 1 Of 1 9/28/2018

|                 |            |            |   |            |           |                  |            |            |                           |            |            |              |            |    |
|-----------------|------------|------------|---|------------|-----------|------------------|------------|------------|---------------------------|------------|------------|--------------|------------|----|
| Building Style  |            |            | SF Bsmt Living  |            |           | Layout           |            |            |                           |            |            |              |            |    |
| 1.Conv.         | 5.Garrison | 9.Gambrel  | Fin Bsmt Grade  |            |           | 1.Typical        | 4.         | 7.         |                           |            |            |              |            |    |
| 2.Ranch         | 6.Split    | 10.Saltbox | OPEN-5-CUSTOMIZE  |            |           | 2.Inadeq         | 5.         | 8.         |                           |            |            |              |            |    |
| 3.R Ranch       | 7.Contemp  | 11.Other   | Heat Type <b>100%</b>   |            |           | 3.Horrid         | 6.         | 9.         |                           |            |            |              |            |    |
| 4.Cape          | 8.Log      | 12.        | 1.HWBB/Rad  | 5.FWA      | 9.No Heat | Attic            |            |            |                           |            |            |              |            |    |
| Dwelling Units  |            |            | 2.HWCI  | 6.GravWA   | 10.       | 1.1/4 Fin        | 4.Full Fin | 7.         |                           |            |            |              |            |    |
| Other Units     |            |            | 3.H Pump  | 7.Electric | 11.       | 2.1/2 Fin        | 5.FI/Stair | 8.         |                           |            |            |              |            |    |
| Stories         |            |            | 4.Steam   | 8.FI/Wall  | 12.       | 3.3/4 Fin        | 6.         | 9.None     |                           |            |            |              |            |    |
| 1.1             | 4.1.5      | 7.         | Cool Type <b>0%</b>   |            |           | Insulation       |            |            |                           |            |            |              |            |    |
| 2.2             | 5.1.75     | 8.         | 1.Refrig  | 4.W&C Air  | 7.        | 1.Full           | 4.Minimal  | 7.         |                           |            |            |              |            |    |
| 3.3             | 6.2.5      | 9.         | 2.Evapor  | 5.         | 8.        | 2.Heavy          | 5.Partial  | 8.         |                           |            |            |              |            |    |
| Exterior Walls  |            |            | 3.H Pump  | 6.         | 9.None    | 3.Capped         | 6.         | 9.None     |                           |            |            |              |            |    |
| 1.Wood          | 5.Stucco   | 9.Other    | Kitchen Style   |            |           | Unfinished %     |            |            |                           |            |            |              |            |    |
| 2.Vin/Al        | 6.Brick    | 10.        | 1.Modern  | 4.Obsolete | 7.        | Grade & Factor   |            |            |                           |            |            |              |            |    |
| 3.Compos.       | 7.Stone    | 11.        | 2.Typical   | 5.         | 8.        | 1.E Grade        | 4.B Grade  | 7.         |                           |            |            |              |            |    |
| 4.Asbestos      | 8.Concrete | 12.        | 3.Old Type  | 6.         | 9.None    | 2.D Grade        | 5.A Grade  | 8.SC Grade |                           |            |            |              |            |    |
| Roof Surface    |            |            | Bath(s) Style   |            |           | 3.C Grade        | 6.AA Grade | 9.Same     |                           |            |            |              |            |    |
| 1.Asphalt       | 4.Composit | 7.         | 1.Modern  | 4.Obsolete | 7.        | SQFT (Footprint) |            |            |                           |            |            |              |            |    |
| 2.Slate         | 5.Wood     | 8.         | 2.Typical   | 5.         | 8.        | Condition        |            |            |                           |            |            |              |            |    |
| 3.Metal         | 6.Other    | 9.         | 3.Old Type  | 6.         | 9.None    | 1.Poor           | 4.Avg      | 7.V G      |                           |            |            |              |            |    |
| SF Masonry Trim |            |            | # Rooms   |            |           | 2.Fair           | 5.Avg+     | 8.Exc      |                           |            |            |              |            |    |
| OPEN-3-CUSTOM   |            |            | # Bedrooms  |            |           | 3.Avg-           | 6.Good     | 9.Same     |                           |            |            |              |            |    |
| OPEN-4-CUSTOM   |            |            | # Full Baths  |            |           | Phys. % Good     |            |            |                           |            |            |              |            |    |
| Year Built      |            |            | # Half Baths  |            |           | Funct. % Good    |            |            |                           |            |            |              |            |    |
| Year Remodeled  |            |            | # Addn Fixtures   |            |           | Functional Code  |            |            |                           |            |            |              |            |    |
| Foundation      |            |            | # Fireplaces  |            |           | 1.Incomp         | 4.Bsmt     | 7.         |                           |            |            |              |            |    |
| 1.Concrete      | 4.Wood     | 7.         |  |            |           |                  |            |            | 2.O-Built                 | 5.         | 8.LongTerm |              |            |    |
| 2.C Block       | 5.Slab     | 8.         |   |            |           |                  |            |            | 3.Damage                  | 6.L-T Vaca | 9.None     | Econ. % Good |            |    |
| 3.Br/Stone      | 6.Piers    | 9.         |   |            |           |                  |            |            | Economic Code             |            |            | 0.None       | 3.No Power | 7. |
| Basement        |            |            |   |            |           |                  |            |            | Entrance Code <b>0</b>    |            |            | 1.Location   | 4.Generate | 8. |
| 1.1/4 Bmt       | 4.Full Bmt | 7.         |   |            |           |                  |            |            | 1.Interior                |            |            | 4.Vacant     | 7.         |    |
| 2.1/2 Bmt       | 5.None     | 8.         |   |            |           |                  |            |            | 2.Refusal                 |            |            | 5.Estimate   | 8.         |    |
| 3.3/4 Bmt       | 6.         | 9.None     |   |            |           |                  |            |            | 3.Informed                |            |            | 6.Reviewed   | 9.         |    |
| Bsmt Gar # Cars |            |            |   |            |           |                  |            |            | Information Code <b>0</b> |            |            | 1.Owner      | 4.Agent    | 7. |
| Wet Basement    |            |            |   |            |           |                  |            |            | 1.Relative                |            |            | 5.Estimate   | 8.         |    |
| 1.Dry           | 4.         | 7.         |   |            |           |                  |            |            | 2.Tenant                  |            |            | 6.Exterior   | 9.         |    |
| 2.Damp          | 5.         | 8.         | Date Inspected  |            |           |                  |            |            |                           |            |            |              |            |    |
| 3.Wet           | 6.         | 9.         |   |            |           |                  |            |            |                           |            |            |              |            |    |

| Additions, Outbuildings & Improvements |      |       |       |      |       |        |             | 1.One Story Fram  |
|--|------|-------|-------|------|-------|--------|-------------|-------------------|
| Type                                   | Year | Units | Grade | Cond | Phys. | Funct. | Sound Value | 2.Two Story Fram  |
|  |      |       |       |      | %     | %      |             | 3.Three Story Fr  |
|  |      |       |       |      | %     | %      |             | 4.1 & 1/2 Story   |
|  |      |       |       |      | %     | %      |             | 5.1 & 3/4 Story   |
|  |      |       |       |      | %     | %      |             | 6.2 & 1/2 Story   |
|  |      |       |       |      | %     | %      |             | 21.Open Frame Por |
|  |      |       |       |      | %     | %      |             | 22.Encl Frame Por |
|  |      |       |       |      | %     | %      |             | 23.Frame Garage   |
|  |      |       |       |      | %     | %      |             | 24.Frame Shed     |
|  |      |       |       |      | %     | %      |             | 25.Frame Bay Wind |
|  |      |       |       |      | %     | %      |             | 26.1SFr Overhang  |
|  |      |       |       |      | %     | %      |             | 27.Unfin Basement |
|  |      |       |       |      | %     | %      |             | 28.Unfinished Att |
|  |      |       |       |      | %     | %      |             | 29.Finished Attic |

YOUNG, LENNIE K  
YOUNG, DEBORAH L JT  
204 OLD EAST ROAD  
FORT FAIRFIELD ME 04742

B4428P287

Previous Owner  
LEWIS, BRUCE & NANCY JT  
44 STARK LANE

LITCHFIELD NH 03052  
Sale Date: 4/30/2007

Inspection Witnessed By:

| X        | Date        | Date Insp. |
|----------|-------------|------------|
| No./Date | Description | Date Insp. |
|          |             |            |
|          |             |            |
|          |             |            |

Notes:

Easton

| Property Data    |                           |            | Assessment Record   |                      |                  |              |                  |                   |
|------------------|---------------------------|------------|---------------------|----------------------|------------------|--------------|------------------|-------------------|
| Neighborhood     | <b>1 Resident/Agric.</b>  |            | Year                | Land                 | Buildings        | Exempt       | Total            |                   |
| Tree Growth Year | <b>0</b>                  |            | 2010                | 3,500                | 0                | 0            | 3,500            |                   |
| Recertified Date | <b>0</b>                  |            | 2011                | 3,500                | 0                | 0            | 3,500            |                   |
| Y Coordinate     | <b>0</b>                  |            | 2012                | 3,500                | 0                | 0            | 3,500            |                   |
| Zone/Land Use    | <b>11 Residential</b>     |            | 2013                | 3,500                | 0                | 0            | 3,500            |                   |
| Secondary Zone   |                           |            | 2014                | 3,500                | 0                | 0            | 3,500            |                   |
| Topography       | <b>2 Rolling</b>          |            | 2015                | 10,000               | 0                | 0            | 10,000           |                   |
| 1.Level          | 4.Below St                | 7.         | 2016                | 10,000               | 0                | 0            | 10,000           |                   |
| 2.Rolling        | 5.Low                     | 8.         | 2017                | 10,000               | 0                | 0            | 10,000           |                   |
| 3.Above St       | 6.Swampy                  | 9.         | 2018                | 10,000               | 0                | 0            | 10,000           |                   |
| Utilities        | <b>9 None</b>             |            |                     |                      |                  |              |                  |                   |
| 1.Public         | 4.Dr Well                 | 7.Cesspool |                     |                      |                  |              |                  |                   |
| 2.Water          | 5.Dug Well                | 8.         |                     |                      |                  |              |                  |                   |
| 3.Sewer          | 6.Septic                  | 9.None     |                     |                      |                  |              |                  |                   |
| Street           | <b>1 Paved</b>            |            |                     |                      |                  |              |                  |                   |
| 1.Paved          | 4.Proposed                | 7.         |                     |                      |                  |              |                  |                   |
| 2.Semi Imp       | 5.R/W                     | 8.         |                     |                      |                  |              |                  |                   |
| 3.Gravel         | 6.                        | 9.None     |                     |                      |                  |              |                  |                   |
| FLOOD PLAIN      | <b>0</b>                  |            | <b>Land Data</b>    |                      |                  |              |                  |                   |
| CLASS            | <b>1</b>                  |            | <b>Front Foot</b>   | <b>Type</b>          | <b>Effective</b> |              | <b>Influence</b> |                   |
| <b>Sale Data</b> |                           |            | 11.Regular Lot      |                      | <b>Frontage</b>  | <b>Depth</b> | <b>Factor</b>    | <b>Code</b>       |
| Sale Date        | <b>4/30/2007</b>          |            | 12.Delta Triangle   |                      |                  |              | %                | 1.Unimproved      |
| Price            | <b>10,500</b>             |            | 13.Nabla Triangle   |                      |                  |              | %                | 2.Condition       |
| Sale Type        | <b>1 Land Only</b>        |            | 14.Rear Land        |                      |                  |              | %                | 3.Topography      |
| 1.Land           | 4.Mobile                  | 7.         | 15.Miscellaneous    |                      |                  |              | %                | 4.Size/Shape      |
| 2.L & B          | 5.Other                   | 8.         |                     |                      |                  |              | %                | 5.Access          |
| 3.Building       | 6.                        | 9.         |                     |                      |                  |              | %                | 6.Restricted      |
| Financing        | <b>9 Unknown</b>          |            |                     |                      |                  |              | %                | 7.Corner Infl     |
| 1.Convent        | 4.Seller                  | 7.         | <b>Square Foot</b>  | <b>Square Feet</b>   |                  |              |                  | 8.Environment     |
| 2.FHA/VA         | 5.Private                 | 8.         | 16.Regular Lot      |                      |                  |              | %                | 9.Fract Share     |
| 3.Assumed        | 6.Cash                    | 9.Unknown  | 17.Class I Road     |                      |                  |              | %                | <b>Acres</b>      |
| Validity         | <b>1 Arms Length Sale</b> |            | 18.Class II Road    |                      |                  |              | %                | 32.Farmland Tilla |
| 1.Valid          | 4.Split                   | 7.Changes  | 19.Condominium      |                      |                  |              | %                | 33.C R P          |
| 2.Related        | 5.Partial                 | 8.Other    | 20.Sound Value      |                      |                  |              | %                | 34.Softwood-Farm  |
| 3.Distress       | 6.Exempt                  | 9.         |                     |                      |                  |              | %                | 35.Mixed Wood-Far |
| Verified         | <b>5 Public Record</b>    |            |                     |                      |                  |              | %                | 36.Hardwood-Farm  |
| 1.Buyer          | 4.Agent                   | 7.Family   | <b>Fract. Acre</b>  | <b>Acres/Sites</b>   |                  |              |                  | 37.Softwood-TG    |
| 2.Seller         | 5.Pub Rec                 | 8.Other    | 21.Homesite (Fract) | 25                   | 1.00             | 100          | %                | 0                 |
| 3.Lender         | 6.MLS                     | 9.         | 22.Baselot (Fract)  | 28                   | 1.07             | 100          | %                | 0                 |
|                  |                           |            | 23.Misc (Fract)     |                      |                  |              | %                |                   |
|                  |                           |            | <b>Acres</b>        |                      |                  |              | %                |                   |
|                  |                           |            | 24.Homesite         |                      |                  |              | %                |                   |
|                  |                           |            | 25.Baselot          |                      |                  |              | %                |                   |
|                  |                           |            | 26.Secondary        |                      |                  |              | %                |                   |
|                  |                           |            | 27.Frontage         |                      |                  |              | %                |                   |
|                  |                           |            | 28.Rear Land (All   | <b>Total Acreage</b> |                  | 2.07         |                  |                   |
|                  |                           |            | 31.Tillable         |                      |                  |              |                  |                   |
|                  |                           |            |                     |                      |                  |              |                  | 46.Miscellaneous  |
|                  |                           |            |                     |                      |                  |              |                  | 47.Pavement       |
|                  |                           |            |                     |                      |                  |              |                  | 48.Farmland Pastu |

**Easton**

Map Lot 008-042

Account 710

Location FULLER ROAD

Card 1 Of 1 9/28/2018

|                 |            |            |   |            |           |                  |            |            |                           |    |            |                        |            |        |
|-----------------|------------|------------|---|------------|-----------|------------------|------------|------------|---------------------------|----|------------|------------------------|------------|--------|
| Building Style  |            |            | SF Bsmt Living  |            |           | Layout           |            |            |                           |    |            |                        |            |        |
| 1.Conv.         | 5.Garrison | 9.Gambrel  | Fin Bsmt Grade  |            |           | 1.Typical        | 4.         | 7.         |                           |    |            |                        |            |        |
| 2.Ranch         | 6.Split    | 10.Saltbox | OPEN-5-CUSTOMIZE  |            |           | 2.Inadeq         | 5.         | 8.         |                           |    |            |                        |            |        |
| 3.R Ranch       | 7.Contemp  | 11.Other   | Heat Type <b>100%</b>   |            |           | 3.Horrid         | 6.         | 9.         |                           |    |            |                        |            |        |
| 4.Cape          | 8.Log      | 12.        | 1.HWBB/Rad  | 5.FWA      | 9.No Heat | Attic            |            |            |                           |    |            |                        |            |        |
| Dwelling Units  |            |            | 2.HWCI  | 6.GravWA   | 10.       | 1.1/4 Fin        | 4.Full Fin | 7.         |                           |    |            |                        |            |        |
| Other Units     |            |            | 3.H Pump  | 7.Electric | 11.       | 2.1/2 Fin        | 5.F/Stair  | 8.         |                           |    |            |                        |            |        |
| Stories         |            |            | 4.Steam   | 8.F/Wall   | 12.       | 3.3/4 Fin        | 6.         | 9.None     |                           |    |            |                        |            |        |
| 1.1             | 4.1.5      | 7.         | Cool Type <b>0%</b>   |            |           | Insulation       |            |            |                           |    |            |                        |            |        |
| 2.2             | 5.1.75     | 8.         | 1.Refrig  | 4.W&C Air  | 7.        | 1.Full           | 4.Minimal  | 7.         |                           |    |            |                        |            |        |
| 3.3             | 6.2.5      | 9.         | 2.Evapor  | 5.         | 8.        | 2.Heavy          | 5.Partial  | 8.         |                           |    |            |                        |            |        |
| Exterior Walls  |            |            | 3.H Pump  | 6.         | 9.None    | 3.Capped         | 6.         | 9.None     |                           |    |            |                        |            |        |
| 1.Wood          | 5.Stucco   | 9.Other    | Kitchen Style   |            |           | Unfinished %     |            |            |                           |    |            |                        |            |        |
| 2.Vin/Al        | 6.Brick    | 10.        | 1.Modern  | 4.Obsolete | 7.        | Grade & Factor   |            |            |                           |    |            |                        |            |        |
| 3.Compos.       | 7.Stone    | 11.        | 2.Typical   | 5.         | 8.        | 1.E Grade        | 4.B Grade  | 7.         |                           |    |            |                        |            |        |
| 4.Asbestos      | 8.Concrete | 12.        | 3.Old Type  | 6.         | 9.None    | 2.D Grade        | 5.A Grade  | 8.SC Grade |                           |    |            |                        |            |        |
| Roof Surface    |            |            | Bath(s) Style   |            |           | 3.C Grade        | 6.AA Grade | 9.Same     |                           |    |            |                        |            |        |
| 1.Asphalt       | 4.Composit | 7.         | 1.Modern  | 4.Obsolete | 7.        | SQFT (Footprint) |            |            |                           |    |            |                        |            |        |
| 2.Slate         | 5.Wood     | 8.         | 2.Typical   | 5.         | 8.        | Condition        |            |            |                           |    |            |                        |            |        |
| 3.Metal         | 6.Other    | 9.         | 3.Old Type  | 6.         | 9.None    | 1.Poor           | 4.Avg      | 7.V G      |                           |    |            |                        |            |        |
| SF Masonry Trim |            |            | # Rooms   |            |           | 2.Fair           | 5.Avg+     | 8.Exc      |                           |    |            |                        |            |        |
| OPEN-3-CUSTOM   |            |            | # Bedrooms  |            |           | 3.Avg-           | 6.Good     | 9.Same     |                           |    |            |                        |            |        |
| OPEN-4-CUSTOM   |            |            | # Full Baths  |            |           | Phys. % Good     |            |            |                           |    |            |                        |            |        |
| Year Built      |            |            | # Half Baths  |            |           | Funct. % Good    |            |            |                           |    |            |                        |            |        |
| Year Remodeled  |            |            | # Addn Fixtures   |            |           | Functional Code  |            |            |                           |    |            |                        |            |        |
| Foundation      |            |            | # Fireplaces  |            |           | 1.Incomp         | 4.Bsmt     | 7.         |                           |    |            |                        |            |        |
| 1.Concrete      | 4.Wood     | 7.         |  |            |           |                  |            |            | 2.O-Built                 | 5. | 8.LongTerm |                        |            |        |
| 2.C Block       | 5.Slab     | 8.         |   |            |           |                  |            |            | Econ. % Good              |    |            | 3.Damage               | 6.L-T Vaca | 9.None |
| 3.Br/Stone      | 6.Piers    | 9.         |   |            |           |                  |            |            | Economic Code             |    |            | Entrance Code <b>0</b> |            |        |
| Basement        |            |            |   |            |           |                  |            |            | 0.None                    |    |            | 3.No Power             | 7.         |        |
| 1.1/4 Bmt       | 4.Full Bmt | 7.         |   |            |           |                  |            |            | 1.Location                |    |            | 4.Generate             | 8.         |        |
| 2.1/2 Bmt       | 5.None     | 8.         |   |            |           |                  |            |            | 2.Encroach                |    |            | 9.None                 | 9.         |        |
| 3.3/4 Bmt       | 6.         | 9.None     |   |            |           |                  |            |            | Information Code <b>0</b> |    |            | 1.Owner                |            |        |
| Bsmt Gar # Cars |            |            |   |            |           |                  |            |            | 1.Relative                |    |            | 5.Estimate             | 8.         |        |
| Wet Basement    |            |            |   |            |           |                  |            |            | 2.Tenant                  |    |            | 6.Exterior             | 9.         |        |
| 1.Dry           | 4.         | 7.         |   |            |           |                  |            |            | Date Inspected            |    |            |                        |            |        |
| 2.Damp          | 5.         | 8.         |   |            |           |                  |            |            |                           |    |            |                        |            |        |
| 3.Wet           | 6.         | 9.         |   |            |           |                  |            |            |                           |    |            |                        |            |        |

| Additions, Outbuildings & Improvements |      |       |       |      |       |        |             | 1.One Story Fram  |
|--|------|-------|-------|------|-------|--------|-------------|-------------------|
| Type                                   | Year | Units | Grade | Cond | Phys. | Funct. | Sound Value | 2.Two Story Fram  |
|  |      |       |       |      | %     | %      |             | 3.Three Story Fr  |
|  |      |       |       |      | %     | %      |             | 4.1 & 1/2 Story   |
|  |      |       |       |      | %     | %      |             | 5.1 & 3/4 Story   |
|  |      |       |       |      | %     | %      |             | 6.2 & 1/2 Story   |
|  |      |       |       |      | %     | %      |             | 21.Open Frame Por |
|  |      |       |       |      | %     | %      |             | 22.Encl Frame Por |
|  |      |       |       |      | %     | %      |             | 23.Frame Garage   |
|  |      |       |       |      | %     | %      |             | 24.Frame Shed     |
|  |      |       |       |      | %     | %      |             | 25.Frame Bay Wind |
|  |      |       |       |      | %     | %      |             | 26.1SFr Overhang  |
|  |      |       |       |      | %     | %      |             | 27.Unfin Basement |
|  |      |       |       |      | %     | %      |             | 28.Unfinished Att |
|  |      |       |       |      | %     | %      |             | 29.Finished Attic |

LANDEEN, KEITH  
LANDEEN, RUTH JT  
23 FULLER ROAD  
EASTON ME 04740

B4243P189

Inspection Witnessed By:

X Date

| No./Date | Description | Date Insp. |
|----------|-------------|------------|
|          |             |            |
|          |             |            |
|          |             |            |

Notes:

Easton

| Property Data                                   |  |  | Assessment Record    |                    |                  |        |                  |                   |                        |              |
|---|--|--|----------------------|--------------------|------------------|--------|------------------|-------------------|------------------------|--------------|
| Neighborhood <b>1 Resident/Agric.</b>           |  |  | Year                 | Land               | Buildings        | Exempt | Total            |                   |                        |              |
| Tree Growth Year <b>0</b>                       |  |  | 2010                 | 7,000              | 40,700           | 6,050  | 41,650           |                   |                        |              |
| Recertified Date <b>0</b>                       |  |  | 2011                 | 7,000              | 40,400           | 6,050  | 41,350           |                   |                        |              |
| Y Coordinate <b>0</b>                           |  |  | 2012                 | 7,000              | 40,300           | 5,940  | 41,360           |                   |                        |              |
| Zone/Land Use <b>11 Residential</b>             |  |  | 2013                 | 7,000              | 39,800           | 6,160  | 40,640           |                   |                        |              |
| Secondary Zone                                  |  |  | 2014                 | 7,000              | 39,500           | 6,160  | 40,340           |                   |                        |              |
| Topography <b>2 Rolling 3 Above Street</b>      |  |  | 2015                 | 17,500             | 53,900           | 10,000 | 61,400           |                   |                        |              |
| 1.Level 4.Below St 7.                           |  |  | 2016                 | 17,500             | 53,900           | 15,000 | 56,400           |                   |                        |              |
| 2.Rolling 5.Low 8.                              |  |  | 2017                 | 17,500             | 53,900           | 20,000 | 51,400           |                   |                        |              |
| 3.Above St 6.Swampy 9.                          |  |  | 2018                 | 17,500             | 53,900           | 20,000 | 51,400           |                   |                        |              |
| Utilities <b>4 Drilled Well 6 Septic System</b> |  |  |                      |                    |                  |        |                  |                   |                        |              |
| 1.Public 4.Dr Well 7.Cesspool                   |  |  |                      |                    |                  |        |                  |                   |                        |              |
| 2.Water 5.Dug Well 8.                           |  |  |                      |                    |                  |        |                  |                   |                        |              |
| 3.Sewer 6.Septic 9.None                         |  |  |                      |                    |                  |        |                  |                   |                        |              |
| Street <b>1 Paved</b>                           |  |  |                      |                    |                  |        |                  |                   |                        |              |
| 1.Paved 4.Proposed 7.                           |  |  |                      |                    |                  |        |                  |                   |                        |              |
| 2.Semi Imp 5.R/W 8.                             |  |  |                      |                    |                  |        |                  |                   |                        |              |
| 3.Gravel 6. 9.None                              |  |  |                      |                    |                  |        |                  |                   |                        |              |
| FLOOD PLAIN <b>0</b>                            |  |  | <b>Land Data</b>     |                    |                  |        |                  |                   |                        |              |
| CLASS <b>1</b>                                  |  |  | <b>Front Foot</b>    | <b>Type</b>        | <b>Effective</b> |        | <b>Influence</b> |                   | <b>Influence Codes</b> |              |
| Sale Date <b>2/01/2006</b>                      |  |  |                      |                    | Frontage         | Depth  | Factor           | Code              |                        |              |
| Price <b>64,900</b>                             |  |  |                      | 11.Regular Lot     |                  |        |                  |                   |                        | 1.Unimproved |
| Sale Type <b>2 Land &amp; Buildings</b>         |  |  |                      | 12.Delta Triangle  |                  |        |                  |                   |                        | 2.Condition  |
| 1.Land 4.Mobile 7.                              |  |  |                      | 13.Nabla Triangle  |                  |        |                  |                   |                        | 3.Topography |
| 2.L & B 5.Other 8.                              |  |  | 14.Rear Land         |                    |                  |        |                  | 4.Size/Shape      |                        |              |
| 3.Building 6. 9.                                |  |  | 15.Miscellaneous     |                    |                  |        |                  | 5.Access          |                        |              |
| Financing <b>9 Unknown</b>                      |  |  | <b>Square Foot</b>   | <b>Square Feet</b> |                  |        |                  |                   | 6.Restricted           |              |
| 1.Convent 4.Seller 7.                           |  |  |                      |                    |                  |        |                  |                   | 7.Corner Infl          |              |
| 2.FHA/VA 5.Private 8.                           |  |  |                      |                    |                  |        |                  |                   | 8.Environment          |              |
| 3.Assumed 6.Cash 9.Unknown                      |  |  |                      |                    |                  |        |                  |                   | 9.Fract Share          |              |
| Validity <b>1 Arms Length Sale</b>              |  |  |                      |                    |                  |        |                  |                   | <b>Acres</b>           |              |
| 1.Valid 4.Split 7.Changes                       |  |  | <b>Fract. Acre</b>   | <b>Acres/Sites</b> |                  |        |                  |                   | 32.Farmland Tilla      |              |
| 2.Related 5.Partial 8.Other                     |  |  |                      | 24                 | 1.00             | 100    | %                | 0                 | 33.C R P               |              |
| 3.Distress 6.Exempt 9.                          |  |  |                      | 28                 | 1.07             | 100    | %                | 0                 | 34.Softwood-Farm       |              |
| Verified <b>5 Public Record</b>                 |  |  |                      | 44                 | 1.00             | 100    | %                | 0                 | 35.Mixed Wood-Far      |              |
| 1.Buyer 4.Agent 7.Family                        |  |  |                      |                    |                  |        |                  |                   | 36.Hardwood-Farm       |              |
| 2.Seller 5.Pub Rec 8.Other                      |  |  |                      |                    |                  |        |                  | 37.Softwood-TG    |                        |              |
| 3.Lender 6.MLS 9.                               |  |  |                      |                    |                  |        |                  | 38.Mixed Wood-TG  |                        |              |
|   |  |  |                      |                    |                  |        |                  | 39.Hardwood-TG    |                        |              |
|   |  |  |                      |                    |                  |        |                  | 40.Wasteland      |                        |              |
|   |  |  |                      |                    |                  |        |                  | 41.Gravel Pit     |                        |              |
|   |  |  |                      |                    |                  |        |                  | 42.Mobile Home Si |                        |              |
|   |  |  |                      |                    |                  |        |                  | 43.Excess Indust  |                        |              |
|   |  |  |                      |                    |                  |        |                  | 44.Lot Improvemen |                        |              |
|   |  |  |                      |                    |                  |        |                  | 45.Tower Site     |                        |              |
|   |  |  |                      |                    |                  |        |                  | 46.Miscellaneous  |                        |              |
|   |  |  |                      |                    |                  |        |                  | 47.Pavement       |                        |              |
|   |  |  |                      |                    |                  |        |                  | 48.Farmland Pastu |                        |              |
|   |  |  | <b>Total Acreage</b> |                    | 2.07             |        |                  |                   |                        |              |

**Easton**

Map Lot 008-043

Account 535

Location 23 FULLER ROAD

Card 1 Of 1 9/28/2018

|  |   |   |
|--|---|---|
| Building Style <b>2 Ranch</b>          | SF Bsmt Living <b>0</b>   | Layout <b>1 Typical</b>                 |
| 1.Conv. 5.Garrison 9.Gambrel           | Fin Bsmt Grade <b>0 0</b>   | 1.Typical 4. 7.                         |
| 2.Ranch 6.Split 10.Saltbox             | OPEN-5-CUSTOMIZE <b>0</b>   | 2.Inadeq 5. 8.                          |
| 3.R Ranch 7.Contemp 11.Other           | Heat Type <b>100% 5 Forced Warm Air</b>   | 3.Horrid 6. 9.                          |
| 4.Cape 8.Log 12.                       | 1.HWBB/Rad 5.FWA 9.No Heat  | Attic <b>9 None</b>                     |
| Dwelling Units <b>1</b>                | 2.HWCI 6.GravWA 10.   | 1.1/4 Fin 4.Full Fin 7.                 |
| Other Units <b>0</b>                   | 3.H Pump 7.Electric 11.   | 2.1/2 Fin 5.FI/Stair 8.                 |
| Stories <b>1 One Story</b>             | 4.Steam 8.FI/Wall 12.   | 3.3/4 Fin 6. 9.None                     |
| 1.1 4.1.5 7.                           | Cool Type <b>0% 9 None</b>  | Insulation <b>1 Full</b>                |
| 2.2 5.1.75 8.                          | 1.Refrig 4.W&C Air 7.   | 1.Full 4.Minimal 7.                     |
| 3.3 6.2.5 9.                           | 2.Evapor 5. 8.  | 2.Heavy 5.Partial 8.                    |
| Exterior Walls <b>2 Vinyl/Aluminum</b> | 3.H Pump 6. 9.None  | 3.Capped 6. 9.None                      |
| 1.Wood 5.Stucco 9.Other                | Kitchen Style <b>2 Typical</b>  | Unfinished % <b>0%</b>                  |
| 2.Vin/Al 6.Brick 10.                   | 1.Modern 4.Obsolete 7.  | Grade & Factor <b>3 Average 100%</b>    |
| 3.Compos. 7.Stone 11.                  | 2.Typical 5. 8.   | 1.E Grade 4.B Grade 7.                  |
| 4.Asbestos 8.Concrete 12.              | 3.Old Type 6. 9.None  | 2.D Grade 5.A Grade 8.SC Grade          |
| Roof Surface <b>1 Asphalt Shingles</b> | Bath(s) Style <b>2 Typical Bath(s)</b>  | 3.C Grade 6.AA Grade 9.Same             |
| 1.Asphalt 4.Composit 7.                | 1.Modern 4.Obsolete 7.  | SQFT (Footprint) <b>1176</b>            |
| 2.Slate 5.Wood 8.                      | 2.Typical 5. 8.   | Condition <b>4 Average</b>              |
| 3.Metal 6.Other 9.                     | 3.Old Type 6. 9.None  | 1.Poor 4.Avg 7.V G                      |
| SF Masonry Trim <b>0</b>               | # Rooms <b>5</b>  | 2.Fair 5.Avg+ 8.Exc                     |
| OPEN-3-CUSTOM <b>0</b>                 | # Bedrooms <b>3</b>   | 3.Avg- 6.Good 9.Same                    |
| OPEN-4-CUSTOM <b>0</b>                 | # Full Baths <b>1</b>   | Phys. % Good <b>0%</b>                  |
| Year Built <b>1999</b>                 | # Half Baths <b>0</b>   | Funct. % Good <b>100%</b>               |
| Year Remodeled <b>0</b>                | # Addn Fixtures <b>0</b>  | Functional Code <b>9 None</b>           |
| Foundation <b>5 Concrete Slab</b>      | # Fireplaces <b>0</b>   | 1.Incomp 4.Bsmt 7.                      |
| 1.Concrete 4.Wood 7.                   |  <p><b>TRIO</b><br/>Software<br/>A Division of Harris Computer Systems</p> | 2.O-Built 5. 8.LongTerm                 |
| 2.C Block 5.Slab 8.                    |   | 3.Damage 6.L-T Vaca 9.None              |
| 3.Br/Stone 6.Piers 9.                  |   | Econ. % Good <b>100%</b>                |
| Basement <b>9 No Basement</b>          |   | Economic Code <b>None</b>               |
| 1.1/4 Bmt 4.Full Bmt 7.                |   | 0.None 3.No Power 7.                    |
| 2.1/2 Bmt 5.None 8.                    |   | 1.Location 4.Generate 8.                |
| 3.3/4 Bmt 6. 9.None                    |   | 2.Encroach 9.None 9.                    |
| Bsmt Gar # Cars <b>0</b>               |   | Entrance Code <b>1 Interior Inspect</b> |
| Wet Basement <b>9 No Basement</b>      |   | 1.Interior 4.Vacant 7.                  |
| 1.Dry 4. 7.                            |   | 2.Refusal 5.Estimate 8.                 |
| 2.Damp 5. 8.                           | 3.Informed 6.Reviewed 9.  |   |
| 3.Wet 6. 9.                            | Information Code <b>1 Owner</b>   |   |
|  |   | 1.Owner 4.Agent 7.                      |
|  |   | 2.Relative 5.Estimate 8.                |
|  |   | 3.Tenant 6.Exterior 9.                  |

Date Inspected 6/18/2015

**Additions, Outbuildings & Improvements**

| Type              | Year | Units | Grade | Cond | Phys. | Funct. | Sound Value |
|-------------------|------|-------|-------|------|-------|--------|-------------|
| 1 One Story Frame | 0    | 35    | 0 0   | 0    | 0 %   | 0 %    |             |
| 24 Frame Shed     | 2005 |       |       |      | %     | %      | 550         |
| 65 Stable w/Loft  | 2004 | 620   | 2 100 | 4    | 0 %   | 100 %  |             |
| 61 Canopy         | 2004 | 124   | 2 100 | 4    | 0 %   | 100 %  |             |
|                   |      |       |       |      | %     | %      |             |
|                   |      |       |       |      | %     | %      |             |
|                   |      |       |       |      | %     | %      |             |
|                   |      |       |       |      | %     | %      |             |
|                   |      |       |       |      | %     | %      |             |
|                   |      |       |       |      | %     | %      |             |
|                   |      |       |       |      | %     | %      |             |
|                   |      |       |       |      | %     | %      |             |

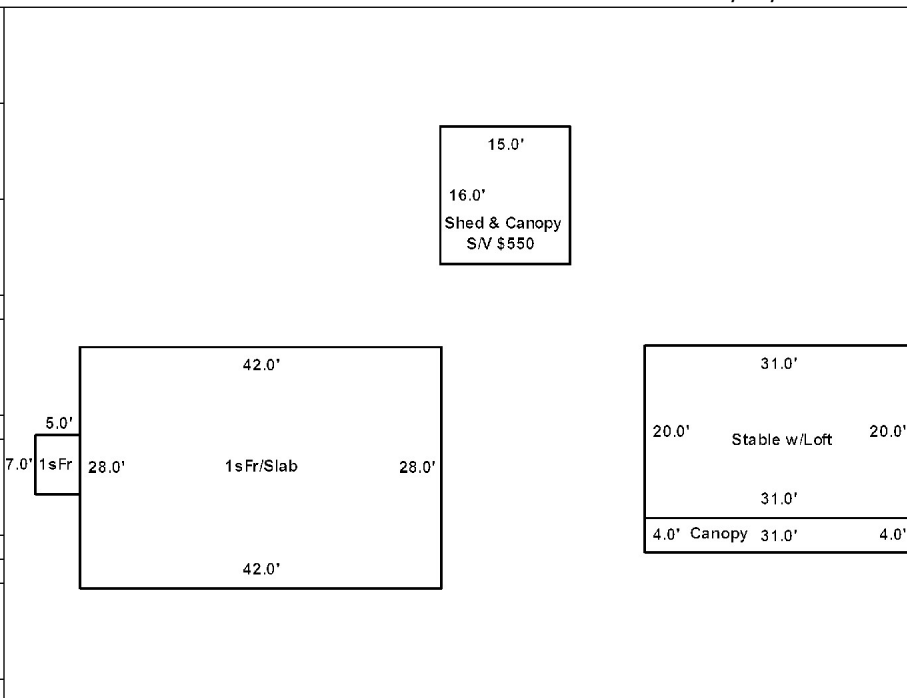



**Easton**

Map Lot 008-044

Account 730

Location FULLER ROAD

Card 1 Of 1 9/28/2018

|                 |            |            |   |            |           |                        |            |            |                          |    |            |                           |            |        |
|-----------------|------------|------------|---|------------|-----------|------------------------|------------|------------|--------------------------|----|------------|---------------------------|------------|--------|
| Building Style  |            |            | SF Bsmt Living  |            |           | Layout                 |            |            |                          |    |            |                           |            |        |
| 1.Conv.         | 5.Garrison | 9.Gambrel  | Fin Bsmt Grade  |            |           | 1.Typical              | 4.         | 7.         |                          |    |            |                           |            |        |
| 2.Ranch         | 6.Split    | 10.Saltbox | OPEN-5-CUSTOMIZE  |            |           | 2.Inadeq               | 5.         | 8.         |                          |    |            |                           |            |        |
| 3.R Ranch       | 7.Contemp  | 11.Other   | Heat Type <b>100%</b>   |            |           | 3.Horrid               | 6.         | 9.         |                          |    |            |                           |            |        |
| 4.Cape          | 8.Log      | 12.        | 1.HWBB/Rad  | 5.FWA      | 9.No Heat | Attic                  |            |            |                          |    |            |                           |            |        |
| Dwelling Units  |            |            | 2.HWCI  | 6.GravWA   | 10.       | 1.1/4 Fin              | 4.Full Fin | 7.         |                          |    |            |                           |            |        |
| Other Units     |            |            | 3.H Pump  | 7.Electric | 11.       | 2.1/2 Fin              | 5.F/Stair  | 8.         |                          |    |            |                           |            |        |
| Stories         |            |            | 4.Steam   | 8.F/Wall   | 12.       | 3.3/4 Fin              | 6.         | 9.None     |                          |    |            |                           |            |        |
| 1.1             | 4.1.5      | 7.         | Cool Type <b>0%</b>   |            |           | Insulation             |            |            |                          |    |            |                           |            |        |
| 2.2             | 5.1.75     | 8.         | 1.Refrig  | 4.W&C Air  | 7.        | 1.Full                 | 4.Minimal  | 7.         |                          |    |            |                           |            |        |
| 3.3             | 6.2.5      | 9.         | 2.Evapor  | 5.         | 8.        | 2.Heavy                | 5.Partial  | 8.         |                          |    |            |                           |            |        |
| Exterior Walls  |            |            | 3.H Pump  | 6.         | 9.None    | 3.Capped               | 6.         | 9.None     |                          |    |            |                           |            |        |
| 1.Wood          | 5.Stucco   | 9.Other    | Kitchen Style   |            |           | Unfinished %           |            |            |                          |    |            |                           |            |        |
| 2.Vin/Al        | 6.Brick    | 10.        | 1.Modern  | 4.Obsolete | 7.        | Grade & Factor         |            |            |                          |    |            |                           |            |        |
| 3.Compos.       | 7.Stone    | 11.        | 2.Typical   | 5.         | 8.        | 1.E Grade              | 4.B Grade  | 7.         |                          |    |            |                           |            |        |
| 4.Asbestos      | 8.Concrete | 12.        | 3.Old Type  | 6.         | 9.None    | 2.D Grade              | 5.A Grade  | 8.SC Grade |                          |    |            |                           |            |        |
| Roof Surface    |            |            | Bath(s) Style   |            |           | 3.C Grade              | 6.AA Grade | 9.Same     |                          |    |            |                           |            |        |
| 1.Asphalt       | 4.Composit | 7.         | 1.Modern  | 4.Obsolete | 7.        | SQFT (Footprint)       |            |            |                          |    |            |                           |            |        |
| 2.Slate         | 5.Wood     | 8.         | 2.Typical   | 5.         | 8.        | Condition              |            |            |                          |    |            |                           |            |        |
| 3.Metal         | 6.Other    | 9.         | 3.Old Type  | 6.         | 9.None    | 1.Poor                 | 4.Avg      | 7.V G      |                          |    |            |                           |            |        |
| SF Masonry Trim |            |            | # Rooms   |            |           | 2.Fair                 | 5.Avg+     | 8.Exc      |                          |    |            |                           |            |        |
| OPEN-3-CUSTOM   |            |            | # Bedrooms  |            |           | 3.Avg-                 | 6.Good     | 9.Same     |                          |    |            |                           |            |        |
| OPEN-4-CUSTOM   |            |            | # Full Baths  |            |           | Phys. % Good           |            |            |                          |    |            |                           |            |        |
| Year Built      |            |            | # Half Baths  |            |           | Funct. % Good          |            |            |                          |    |            |                           |            |        |
| Year Remodeled  |            |            | # Addn Fixtures   |            |           | Functional Code        |            |            |                          |    |            |                           |            |        |
| Foundation      |            |            | # Fireplaces  |            |           | 1.Incomp               | 4.Bsmt     | 7.         |                          |    |            |                           |            |        |
| 1.Concrete      | 4.Wood     | 7.         |  |            |           |                        |            |            | 2.O-Built                | 5. | 8.LongTerm |                           |            |        |
| 2.C Block       | 5.Slab     | 8.         |   |            |           |                        |            |            | Econ. % Good             |    |            | 3.Damage                  | 6.L-T Vaca | 9.None |
| 3.Br/Stone      | 6.Piers    | 9.         |   |            |           |                        |            |            | Economic Code            |    |            | 0.None 3.No Power 7.      |            |        |
| Basement        |            |            |   |            |           |                        |            |            | 0.None 3.No Power 7.     |    |            | 1.Location 4.Generate 8.  |            |        |
| 1.1/4 Bmt       | 4.Full Bmt | 7.         |   |            |           |                        |            |            | 1.Location 4.Generate 8. |    |            | 2.Encroach 9.None 9.      |            |        |
| 2.1/2 Bmt       | 5.None     | 8.         |   |            |           |                        |            |            | Entrance Code <b>0</b>   |    |            | 1.Interior 4.Vacant 7.    |            |        |
| 3.3/4 Bmt       | 6.         | 9.None     |   |            |           |                        |            |            | 1.Interior 4.Vacant 7.   |    |            | 2.Refusal 5.Estimate 8.   |            |        |
| Bsmt Gar # Cars |            |            |   |            |           |                        |            |            | 2.Refusal 5.Estimate 8.  |    |            | 3.Informed 6.Reviewed 9.  |            |        |
| Wet Basement    |            |            |   |            |           |                        |            |            | 3.Informed 6.Reviewed 9. |    |            | Information Code <b>0</b> |            |        |
| 1.Dry           | 4.         | 7.         |   |            |           |                        |            |            | 1.Owner 4.Agent 7.       |    |            | 2.Relative 5.Estimate 8.  |            |        |
| 2.Damp          | 5.         | 8.         | 2.Relative 5.Estimate 8.  |            |           | 3.Tenant 6.Exterior 9. |            |            |                          |    |            |                           |            |        |
| 3.Wet           | 6.         | 9.         | 3.Tenant 6.Exterior 9.  |            |           |                        |            |            |                          |    |            |                           |            |        |

Date Inspected

**Additions, Outbuildings & Improvements**

| Type | Year | Units | Grade | Cond | Phys. | Funct. | Sound Value       |
|------|------|-------|-------|------|-------|--------|-------------------|
|      |      |       |       |      | %     | %      | 1.One Story Fram  |
|      |      |       |       |      | %     | %      | 2.Two Story Fram  |
|      |      |       |       |      | %     | %      | 3.Three Story Fr  |
|      |      |       |       |      | %     | %      | 4.1 & 1/2 Story   |
|      |      |       |       |      | %     | %      | 5.1 & 3/4 Story   |
|      |      |       |       |      | %     | %      | 6.2 & 1/2 Story   |
|      |      |       |       |      | %     | %      | 21.Open Frame Por |
|      |      |       |       |      | %     | %      | 22.Encl Frame Por |
|      |      |       |       |      | %     | %      | 23.Frame Garage   |
|      |      |       |       |      | %     | %      | 24.Frame Shed     |
|      |      |       |       |      | %     | %      | 25.Frame Bay Wind |
|      |      |       |       |      | %     | %      | 26.1SFr Overhang  |
|      |      |       |       |      | %     | %      | 27.Unfin Basement |
|      |      |       |       |      | %     | %      | 28.Unfinished Att |
|      |      |       |       |      | %     | %      | 29.Finished Attic |





**Easton**

Map Lot 008-045

Account 739

Location FULLER ROAD

Card 1 Of 1 9/28/2018

|                 |            |            |   |            |           |                        |            |            |                          |    |            |                           |            |        |
|-----------------|------------|------------|---|------------|-----------|------------------------|------------|------------|--------------------------|----|------------|---------------------------|------------|--------|
| Building Style  |            |            | SF Bsmt Living  |            |           | Layout                 |            |            |                          |    |            |                           |            |        |
| 1.Conv.         | 5.Garrison | 9.Gambrel  | Fin Bsmt Grade  |            |           | 1.Typical              | 4.         | 7.         |                          |    |            |                           |            |        |
| 2.Ranch         | 6.Split    | 10.Saltbox | OPEN-5-CUSTOMIZE  |            |           | 2.Inadeq               | 5.         | 8.         |                          |    |            |                           |            |        |
| 3.R Ranch       | 7.Contemp  | 11.Other   | Heat Type <b>100%</b>   |            |           | 3.Horrid               | 6.         | 9.         |                          |    |            |                           |            |        |
| 4.Cape          | 8.Log      | 12.        | 1.HWBB/Rad  | 5.FWA      | 9.No Heat | Attic                  |            |            |                          |    |            |                           |            |        |
| Dwelling Units  |            |            | 2.HWCI  | 6.GravWA   | 10.       | 1.1/4 Fin              | 4.Full Fin | 7.         |                          |    |            |                           |            |        |
| Other Units     |            |            | 3.H Pump  | 7.Electric | 11.       | 2.1/2 Fin              | 5.F/Stair  | 8.         |                          |    |            |                           |            |        |
| Stories         |            |            | 4.Steam   | 8.F/Wall   | 12.       | 3.3/4 Fin              | 6.         | 9.None     |                          |    |            |                           |            |        |
| 1.1             | 4.1.5      | 7.         | Cool Type <b>0%</b>   |            |           | Insulation             |            |            |                          |    |            |                           |            |        |
| 2.2             | 5.1.75     | 8.         | 1.Refrig  | 4.W&C Air  | 7.        | 1.Full                 | 4.Minimal  | 7.         |                          |    |            |                           |            |        |
| 3.3             | 6.2.5      | 9.         | 2.Evapor  | 5.         | 8.        | 2.Heavy                | 5.Partial  | 8.         |                          |    |            |                           |            |        |
| Exterior Walls  |            |            | 3.H Pump  | 6.         | 9.None    | 3.Capped               | 6.         | 9.None     |                          |    |            |                           |            |        |
| 1.Wood          | 5.Stucco   | 9.Other    | Kitchen Style   |            |           | Unfinished %           |            |            |                          |    |            |                           |            |        |
| 2.Vin/Al        | 6.Brick    | 10.        | 1.Modern  | 4.Obsolete | 7.        | Grade & Factor         |            |            |                          |    |            |                           |            |        |
| 3.Compos.       | 7.Stone    | 11.        | 2.Typical   | 5.         | 8.        | 1.E Grade              | 4.B Grade  | 7.         |                          |    |            |                           |            |        |
| 4.Asbestos      | 8.Concrete | 12.        | 3.Old Type  | 6.         | 9.None    | 2.D Grade              | 5.A Grade  | 8.SC Grade |                          |    |            |                           |            |        |
| Roof Surface    |            |            | Bath(s) Style   |            |           | 3.C Grade              | 6.AA Grade | 9.Same     |                          |    |            |                           |            |        |
| 1.Asphalt       | 4.Composit | 7.         | 1.Modern  | 4.Obsolete | 7.        | SQFT (Footprint)       |            |            |                          |    |            |                           |            |        |
| 2.Slate         | 5.Wood     | 8.         | 2.Typical   | 5.         | 8.        | Condition              |            |            |                          |    |            |                           |            |        |
| 3.Metal         | 6.Other    | 9.         | 3.Old Type  | 6.         | 9.None    | 1.Poor                 | 4.Avg      | 7.V G      |                          |    |            |                           |            |        |
| SF Masonry Trim |            |            | # Rooms   |            |           | 2.Fair                 | 5.Avg+     | 8.Exc      |                          |    |            |                           |            |        |
| OPEN-3-CUSTOM   |            |            | # Bedrooms  |            |           | 3.Avg-                 | 6.Good     | 9.Same     |                          |    |            |                           |            |        |
| OPEN-4-CUSTOM   |            |            | # Full Baths  |            |           | Phys. % Good           |            |            |                          |    |            |                           |            |        |
| Year Built      |            |            | # Half Baths  |            |           | Funct. % Good          |            |            |                          |    |            |                           |            |        |
| Year Remodeled  |            |            | # Addn Fixtures   |            |           | Functional Code        |            |            |                          |    |            |                           |            |        |
| Foundation      |            |            | # Fireplaces  |            |           | 1.Incomp               | 4.Bsmt     | 7.         |                          |    |            |                           |            |        |
| 1.Concrete      | 4.Wood     | 7.         |  |            |           |                        |            |            | 2.O-Built                | 5. | 8.LongTerm |                           |            |        |
| 2.C Block       | 5.Slab     | 8.         |   |            |           |                        |            |            | Econ. % Good             |    |            | 3.Damage                  | 6.L-T Vaca | 9.None |
| 3.Br/Stone      | 6.Piers    | 9.         |   |            |           |                        |            |            | Economic Code            |    |            | 0.None 3.No Power 7.      |            |        |
| Basement        |            |            |   |            |           |                        |            |            | 0.None 3.No Power 7.     |    |            | 1.Location 4.Generate 8.  |            |        |
| 1.1/4 Bmt       | 4.Full Bmt | 7.         |   |            |           |                        |            |            | 1.Location 4.Generate 8. |    |            | 2.Encroach 9.None 9.      |            |        |
| 2.1/2 Bmt       | 5.None     | 8.         |   |            |           |                        |            |            | Entrance Code <b>0</b>   |    |            | 1.Interior 4.Vacant 7.    |            |        |
| 3.3/4 Bmt       | 6.         | 9.None     |   |            |           |                        |            |            | 1.Interior 4.Vacant 7.   |    |            | 2.Refusal 5.Estimate 8.   |            |        |
| Bsmt Gar # Cars |            |            |   |            |           |                        |            |            | 2.Refusal 5.Estimate 8.  |    |            | 3.Informed 6.Reviewed 9.  |            |        |
| Wet Basement    |            |            |   |            |           |                        |            |            | 3.Informed 6.Reviewed 9. |    |            | Information Code <b>0</b> |            |        |
| 1.Dry           | 4.         | 7.         |   |            |           |                        |            |            | 1.Owner 4.Agent 7.       |    |            | 2.Relative 5.Estimate 8.  |            |        |
| 2.Damp          | 5.         | 8.         | 2.Relative 5.Estimate 8.  |            |           | 3.Tenant 6.Exterior 9. |            |            |                          |    |            |                           |            |        |
| 3.Wet           | 6.         | 9.         | 3.Tenant 6.Exterior 9.  |            |           |                        |            |            |                          |    |            |                           |            |        |

Date Inspected

**Additions, Outbuildings & Improvements**

| Type | Year | Units | Grade | Cond | Phys. | Funct. | Sound Value       |
|------|------|-------|-------|------|-------|--------|-------------------|
|      |      |       |       |      | %     | %      | 1.One Story Fram  |
|      |      |       |       |      | %     | %      | 2.Two Story Fram  |
|      |      |       |       |      | %     | %      | 3.Three Story Fr  |
|      |      |       |       |      | %     | %      | 4.1 & 1/2 Story   |
|      |      |       |       |      | %     | %      | 5.1 & 3/4 Story   |
|      |      |       |       |      | %     | %      | 6.2 & 1/2 Story   |
|      |      |       |       |      | %     | %      | 21.Open Frame Por |
|      |      |       |       |      | %     | %      | 22.Encl Frame Por |
|      |      |       |       |      | %     | %      | 23.Frame Garage   |
|      |      |       |       |      | %     | %      | 24.Frame Shed     |
|      |      |       |       |      | %     | %      | 25.Frame Bay Wind |
|      |      |       |       |      | %     | %      | 26.1SFr Overhang  |
|      |      |       |       |      | %     | %      | 27.Unfin Basement |
|      |      |       |       |      | %     | %      | 28.Unfinished Att |
|      |      |       |       |      | %     | %      | 29.Finished Attic |

TOWN OF EASTON  
PO BOX 127  
EASTON ME 04740 0127

B3260P203 B4636P105

Previous Owner  
LEWIS, BRUCE  
LEWIS, NANCY  
44 STARK LANE  
LITCHFIELD NH 03051  
Sale Date: 12/03/2013

Inspection Witnessed By:

| X        | Date        | Date Insp. |
|----------|-------------|------------|
| No./Date | Description | Date Insp. |
|          |             |            |
|          |             |            |
|          |             |            |

Notes:

Easton

| Property Data                         |  |  | Assessment Record |                   |           |        |           |                   |                 |
|---------------------------------------|--|--|-------------------|-------------------|-----------|--------|-----------|-------------------|-----------------|
| Neighborhood <b>1 Resident/Agric.</b> |  |  | Year              | Land              | Buildings | Exempt | Total     |                   |                 |
| Tree Growth Year <b>0</b>             |  |  | 2010              | 3,500             | 0         | 0      | 3,500     |                   |                 |
| Recertified Date <b>0</b>             |  |  | 2011              | 3,500             | 0         | 0      | 3,500     |                   |                 |
| Y Coordinate <b>0</b>                 |  |  | 2012              | 3,500             | 0         | 0      | 3,500     |                   |                 |
| Zone/Land Use <b>11 Residential</b>   |  |  | 2013              | 3,500             | 0         | 0      | 3,500     |                   |                 |
| Secondary Zone                        |  |  | 2014              | 3,500             | 0         | 3,500  | 0         |                   |                 |
| Topography <b>2 Rolling</b>           |  |  | 2015              | 10,000            | 0         | 10,000 | 0         |                   |                 |
| 1.Level 4.Below St 7.                 |  |  | 2016              | 10,000            | 0         | 10,000 | 0         |                   |                 |
| 2.Rolling 5.Low 8.                    |  |  | 2017              | 10,000            | 0         | 10,000 | 0         |                   |                 |
| 3.Above St 6.Swampy 9.                |  |  | 2018              | 10,000            | 0         | 10,000 | 0         |                   |                 |
| Utilities <b>9 None</b>               |  |  |                   |                   |           |        |           |                   |                 |
| 1.Public 4.Dr Well 7.Cesspool         |  |  |                   |                   |           |        |           |                   |                 |
| 2.Water 5.Dug Well 8.                 |  |  |                   |                   |           |        |           |                   |                 |
| 3.Sewer 6.Septic 9.None               |  |  |                   |                   |           |        |           |                   |                 |
| Street <b>1 Paved</b>                 |  |  |                   |                   |           |        |           |                   |                 |
| 1.Paved 4.Proposed 7.                 |  |  |                   |                   |           |        |           |                   |                 |
| 2.Semi Imp 5.R/W 8.                   |  |  |                   |                   |           |        |           |                   |                 |
| 3.Gravel 6. 9.None                    |  |  |                   |                   |           |        |           |                   |                 |
| FLOOD PLAIN <b>0</b>                  |  |  |                   |                   |           |        |           |                   |                 |
| CLASS <b>1</b>                        |  |  |                   |                   |           |        |           |                   |                 |
| Sale Data                             |  |  | Land Data         |                   |           |        |           |                   |                 |
| Sale Date                             |  |  | Front Foot        | Type              | Effective |        | Influence |                   | Influence Codes |
| Price                                 |  |  |                   |                   | Frontage  | Depth  | Factor    | Code              |                 |
| Sale Type                             |  |  | 11.Regular Lot    |                   |           |        |           | 1.Unimproved      |                 |
| 1.Land 4.Mobile 7.                    |  |  | 12.Delta Triangle |                   |           |        |           | 2.Condition       |                 |
| 2.L & B 5.Other 8.                    |  |  | 13.Nabla Triangle |                   |           |        |           | 3.Topography      |                 |
| 3.Building 6. 9.                      |  |  | 14.Rear Land      |                   |           |        |           | 4.Size/Shape      |                 |
| Financing                             |  |  | 15.Miscellaneous  |                   |           |        |           | 5.Access          |                 |
| 1.Convent 4.Seller 7.                 |  |  | Square Foot       | Square Feet       |           |        |           | 6.Restricted      |                 |
| 2.FHA/VA 5.Private 8.                 |  |  |                   | 16.Regular Lot    |           |        |           | 7.Corner Infl     |                 |
| 3.Assumed 6.Cash 9.Unknown            |  |  | 17.Class I Road   |                   |           |        |           | 8.Environment     |                 |
| Validity                              |  |  | 18.Class II Road  |                   |           |        |           | 9.Fract Share     |                 |
| 1.Valid 4.Split 7.Changes             |  |  | 19.Condominium    |                   |           |        |           | Acres             |                 |
| 2.Related 5.Partial 8.Other           |  |  | 20.Sound Value    |                   |           |        |           | 32.Farmland Tilla |                 |
| 3.Distress 6.Exempt 9.                |  |  | Fract. Acre       | Acreage/Sites     |           |        |           | 33.C R P          |                 |
| Verified                              |  |  |                   | 21.Homesite (Frac | 25        | 1.00   | 100       | %                 | 0               |
| 1.Buyer 4.Agent 7.Family              |  |  | 22.Baslot (Fract  | 28                | 1.07      | 100    | %         | 0                 |                 |
| 2.Seller 5.Pub Rec 8.Other            |  |  | 23.Misc (Fract)   |                   |           |        |           |                   |                 |
| 3.Lender 6.MLS 9.                     |  |  | Acres             |                   |           |        |           |                   |                 |
|                                       |  |  | 24.Homesite       |                   |           |        |           |                   |                 |
|                                       |  |  | 25.Baslot         |                   |           |        |           |                   |                 |
|                                       |  |  | 26.Secondary      |                   |           |        |           |                   |                 |
|                                       |  |  | 27.Frontage       |                   |           |        |           |                   |                 |
|                                       |  |  | 28.Rear Land (All | Total Acreage     |           | 2.07   |           |                   |                 |
|                                       |  |  | 31.Tillable       |                   |           |        |           |                   |                 |

- 1.Unimproved
- 2.Condition
- 3.Topography
- 4.Size/Shape
- 5.Access
- 6.Restricted
- 7.Corner Infl
- 8.Environment
- 9.Fract Share
- Acres
- 32.Farmland Tilla
- 33.C R P
- 34.Softwood-Farm
- 35.Mixed Wood-Far
- 36.Hardwood-Farm
- 37.Softwood-TG
- 38.Mixed Wood-TG
- 39.Hardwood-TG
- 40.Wasteland
- 41.Gravel Pit
- 42.Mobile Home Si
- 43.Excess Indust
- 44.Lot Improvemen
- 45.Tower Site
- 46.Miscellaneous
- 47.Pavement
- 48.Farmland Pastu

**Easton**

Map Lot 008-046

Account 741

Location FULLER ROAD

Card 1 Of 1 9/28/2018

|                              |   |                                |
|------------------------------|---|--------------------------------|
| Building Style               | SF Bsmt Living  | Layout                         |
| 1.Conv. 5.Garrison 9.Gambrel | Fin Bsmt Grade  | 1.Typical 4. 7.                |
| 2.Ranch 6.Split 10.Saltbox   | OPEN-5-CUSTOMIZE  | 2.Inadeq 5. 8.                 |
| 3.R Ranch 7.Contemp 11.Other | Heat Type <b>100%</b>   | 3.Horrid 6. 9.                 |
| 4.Cape 8.Log 12.             | 1.HWBB/Rad 5.FWA 9.No Heat  | Attic                          |
| Dwelling Units               | 2.HWCI 6.GravWA 10.   | 1.1/4 Fin 4.Full Fin 7.        |
| Other Units                  | 3.H Pump 7.Electric 11.   | 2.1/2 Fin 5.F/Stair 8.         |
| Stories                      | 4.Steam 8.F/Wall 12.  | 3.3/4 Fin 6. 9.None            |
| 1.1 4.1.5 7.                 | Cool Type <b>0%</b>   | Insulation                     |
| 2.2 5.1.75 8.                | 1.Refrig 4.W&C Air 7.   | 1.Full 4.Minimal 7.            |
| 3.3 6.2.5 9.                 | 2.Evapor 5. 8.  | 2.Heavy 5.Partial 8.           |
| Exterior Walls               | 3.H Pump 6. 9.None  | 3.Capped 6. 9.None             |
| 1.Wood 5.Stucco 9.Other      | Kitchen Style   | Unfinished %                   |
| 2.Vin/Al 6.Brick 10.         | 1.Modern 4.Obsolete 7.  | Grade & Factor                 |
| 3.Compos. 7.Stone 11.        | 2.Typical 5. 8.   | 1.E Grade 4.B Grade 7.         |
| 4.Asbestos 8.Concrete 12.    | 3.Old Type 6. 9.None  | 2.D Grade 5.A Grade 8.SC Grade |
| Roof Surface                 | Bath(s) Style   | 3.C Grade 6.AA Grade 9.Same    |
| 1.Asphalt 4.Composit 7.      | 1.Modern 4.Obsolete 7.  | SQFT (Footprint)               |
| 2.Slate 5.Wood 8.            | 2.Typical 5. 8.   | Condition                      |
| 3.Metal 6.Other 9.           | 3.Old Type 6. 9.None  | 1.Poor 4.Avg 7.V G             |
| SF Masonry Trim              | # Rooms   | 2.Fair 5.Avg+ 8.Exc            |
| OPEN-3-CUSTOM                | # Bedrooms  | 3.Avg- 6.Good 9.Same           |
| OPEN-4-CUSTOM                | # Full Baths  | Phys. % Good                   |
| Year Built                   | # Half Baths  | Funct. % Good                  |
| Year Remodeled               | # Addn Fixtures   | Functional Code                |
| Foundation                   | # Fireplaces  | 1.Incomp 4.Bsmt 7.             |
| 1.Concrete 4.Wood 7.         |  | 2.O-Built 5. 8.LongTerm        |
| 2.C Block 5.Slab 8.          |   | 3.Damage 6.L-T Vaca 9.None     |
| 3.Br/Stone 6.Piers 9.        |   | Econ. % Good                   |
| Basement                     |   | Economic Code                  |
| 1.1/4 Bmt 4.Full Bmt 7.      |   | 0.None 3.No Power 7.           |
| 2.1/2 Bmt 5.None 8.          |   | 1.Location 4.Generate 8.       |
| 3.3/4 Bmt 6. 9.None          |   | 2.Encroach 9.None 9.           |
| Bsmt Gar # Cars              |   | Entrance Code <b>0</b>         |
| Wet Basement                 |   | 1.Interior 4.Vacant 7.         |
| 1.Dry 4. 7.                  |   | 2.Refusal 5.Estimate 8.        |
| 2.Damp 5. 8.                 | 3.Informed 6.Reviewed 9.  |                                |
| 3.Wet 6. 9.                  | Information Code <b>0</b>   |                                |
| Date Inspected               | 1.Owner 4.Agent 7.  |                                |
|                              | 2.Relative 5.Estimate 8.  |                                |
|                              | 3.Tenant 6.Exterior 9.  |                                |

| Additions, Outbuildings & Improvements |      |       |       |      |       |        |             | 1.One Story Fram  |
|--|------|-------|-------|------|-------|--------|-------------|-------------------|
| Type                                   | Year | Units | Grade | Cond | Phys. | Funct. | Sound Value | 2.Two Story Fram  |
|  |      |       |       |      | %     | %      |             | 3.Three Story Fr  |
|  |      |       |       |      | %     | %      |             | 4.1 & 1/2 Story   |
|  |      |       |       |      | %     | %      |             | 5.1 & 3/4 Story   |
|  |      |       |       |      | %     | %      |             | 6.2 & 1/2 Story   |
|  |      |       |       |      | %     | %      |             | 21.Open Frame Por |
|  |      |       |       |      | %     | %      |             | 22.Encl Frame Por |
|  |      |       |       |      | %     | %      |             | 23.Frame Garage   |
|  |      |       |       |      | %     | %      |             | 24.Frame Shed     |
|  |      |       |       |      | %     | %      |             | 25.Frame Bay Wind |
|  |      |       |       |      | %     | %      |             | 26.1SFr Overhang  |
|  |      |       |       |      | %     | %      |             | 27.Unfin Basement |
|  |      |       |       |      | %     | %      |             | 28.Unfinished Att |
|  |      |       |       |      | %     | %      |             | 29.Finished Attic |



**Easton**

Map Lot 008-047

Account 744

Location FULLER ROAD

Card 1 Of 1 9/28/2018

|                              |   |                                |
|------------------------------|---|--------------------------------|
| Building Style               | SF Bsmt Living  | Layout                         |
| 1.Conv. 5.Garrison 9.Gambrel | Fin Bsmt Grade  | 1.Typical 4. 7.                |
| 2.Ranch 6.Split 10.Saltbox   | OPEN-5-CUSTOMIZE  | 2.Inadeq 5. 8.                 |
| 3.R Ranch 7.Contemp 11.Other | Heat Type <b>100%</b>   | 3.Horrid 6. 9.                 |
| 4.Cape 8.Log 12.             | 1.HWBB/Rad 5.FWA 9.No Heat  | Attic                          |
| Dwelling Units               | 2.HWCI 6.GravWA 10.   | 1.1/4 Fin 4.Full Fin 7.        |
| Other Units                  | 3.H Pump 7.Electric 11.   | 2.1/2 Fin 5.F/Stair 8.         |
| Stories                      | 4.Steam 8.F/Wall 12.  | 3.3/4 Fin 6. 9.None            |
| 1.1 4.1.5 7.                 | Cool Type <b>0%</b>   | Insulation                     |
| 2.2 5.1.75 8.                | 1.Refrig 4.W&C Air 7.   | 1.Full 4.Minimal 7.            |
| 3.3 6.2.5 9.                 | 2.Evapor 5. 8.  | 2.Heavy 5.Partial 8.           |
| Exterior Walls               | 3.H Pump 6. 9.None  | 3.Capped 6. 9.None             |
| 1.Wood 5.Stucco 9.Other      | Kitchen Style   | Unfinished %                   |
| 2.Vin/Al 6.Brick 10.         | 1.Modern 4.Obsolete 7.  | Grade & Factor                 |
| 3.Compos. 7.Stone 11.        | 2.Typical 5. 8.   | 1.E Grade 4.B Grade 7.         |
| 4.Asbestos 8.Concrete 12.    | 3.Old Type 6. 9.None  | 2.D Grade 5.A Grade 8.SC Grade |
| Roof Surface                 | Bath(s) Style   | 3.C Grade 6.AA Grade 9.Same    |
| 1.Asphalt 4.Composit 7.      | 1.Modern 4.Obsolete 7.  | SQFT (Footprint)               |
| 2.Slate 5.Wood 8.            | 2.Typical 5. 8.   | Condition                      |
| 3.Metal 6.Other 9.           | 3.Old Type 6. 9.None  | 1.Poor 4.Avg 7.V G             |
| SF Masonry Trim              | # Rooms   | 2.Fair 5.Avg+ 8.Exc            |
| OPEN-3-CUSTOM                | # Bedrooms  | 3.Avg- 6.Good 9.Same           |
| OPEN-4-CUSTOM                | # Full Baths  | Phys. % Good                   |
| Year Built                   | # Half Baths  | Funct. % Good                  |
| Year Remodeled               | # Addn Fixtures   | Functional Code                |
| Foundation                   | # Fireplaces  | 1.Incomp 4.Bsmt 7.             |
| 1.Concrete 4.Wood 7.         |  | 2.O-Built 5. 8.LongTerm        |
| 2.C Block 5.Slab 8.          |   | 3.Damage 6.L-T Vaca 9.None     |
| 3.Br/Stone 6.Piers 9.        |   | Econ. % Good                   |
| Basement                     |   | Economic Code                  |
| 1.1/4 Bmt 4.Full Bmt 7.      |   | 0.None 3.No Power 7.           |
| 2.1/2 Bmt 5.None 8.          |   | 1.Location 4.Generate 8.       |
| 3.3/4 Bmt 6. 9.None          |   | 2.Encroach 9.None 9.           |
| Bsmt Gar # Cars              |   | Entrance Code <b>0</b>         |
| Wet Basement                 |   | 1.Interior 4.Vacant 7.         |
| 1.Dry 4. 7.                  |   | 2.Refusal 5.Estimate 8.        |
| 2.Damp 5. 8.                 | 3.Informed 6.Reviewed 9.  |                                |
| 3.Wet 6. 9.                  | Information Code <b>0</b>   |                                |
| Date Inspected               | 1.Owner 4.Agent 7.  |                                |
|                              | 2.Relative 5.Estimate 8.  |                                |
|                              | 3.Tenant 6.Exterior 9.  |                                |

| Additions, Outbuildings & Improvements |      |       |       |      |       |        |             | 1.One Story Fram  |
|--|------|-------|-------|------|-------|--------|-------------|-------------------|
| Type                                   | Year | Units | Grade | Cond | Phys. | Funct. | Sound Value | 2.Two Story Fram  |
|  |      |       |       |      | %     | %      |             | 3.Three Story Fr  |
|  |      |       |       |      | %     | %      |             | 4.1 & 1/2 Story   |
|  |      |       |       |      | %     | %      |             | 5.1 & 3/4 Story   |
|  |      |       |       |      | %     | %      |             | 6.2 & 1/2 Story   |
|  |      |       |       |      | %     | %      |             | 21.Open Frame Por |
|  |      |       |       |      | %     | %      |             | 22.Encl Frame Por |
|  |      |       |       |      | %     | %      |             | 23.Frame Garage   |
|  |      |       |       |      | %     | %      |             | 24.Frame Shed     |
|  |      |       |       |      | %     | %      |             | 25.Frame Bay Wind |
|  |      |       |       |      | %     | %      |             | 26.1SFr Overhang  |
|  |      |       |       |      | %     | %      |             | 27.Unfin Basement |
|  |      |       |       |      | %     | %      |             | 28.Unfinished Att |
|  |      |       |       |      | %     | %      |             | 29.Finished Attic |

RACE, BYRON A  
PO BOX 4211  
PRESQUE ISLE ME 04769

B4853P31

Previous Owner  
LEWIS, BRUCE  
LEWIS, NANCY  
44 STARK LANE  
LITCHFIELD NH 03051  
Sale Date: 8/16/2010

Inspection Witnessed By:

X Date

| No./Date | Description | Date Insp. |
|----------|-------------|------------|
|          |             |            |
|          |             |            |
|          |             |            |

Notes:

Easton

| Property Data                         |  |  | Assessment Record   |                           |                  |        |                  |      |                        |
|---------------------------------------|--|--|---------------------|---------------------------|------------------|--------|------------------|------|------------------------|
| Neighborhood <b>1 Resident/Agric.</b> |  |  | Year                | Land                      | Buildings        | Exempt | Total            |      |                        |
| Tree Growth Year <b>0</b>             |  |  | 2010                | 3,500                     | 0                | 0      | 3,500            |      |                        |
| Recertified Date <b>0</b>             |  |  | 2011                | 3,500                     | 0                | 0      | 3,500            |      |                        |
| Y Coordinate <b>0</b>                 |  |  | 2012                | 3,500                     | 0                | 0      | 3,500            |      |                        |
| Zone/Land Use <b>11 Residential</b>   |  |  | 2013                | 3,500                     | 0                | 0      | 3,500            |      |                        |
| Secondary Zone                        |  |  | 2014                | 3,500                     | 0                | 0      | 3,500            |      |                        |
| Topography <b>2 Rolling</b>           |  |  | 2015                | 10,000                    | 0                | 0      | 10,000           |      |                        |
| 1.Level 4.Below St 7.                 |  |  | 2016                | 10,000                    | 0                | 0      | 10,000           |      |                        |
| 2.Rolling 5.Low 8.                    |  |  | 2017                | 10,000                    | 0                | 0      | 10,000           |      |                        |
| 3.Above St 6.Swampy 9.                |  |  | 2018                | 10,000                    | 0                | 0      | 10,000           |      |                        |
| Utilities <b>9 None</b>               |  |  |                     |                           |                  |        |                  |      |                        |
| 1.Public 4.Dr Well 7.Cesspool         |  |  |                     |                           |                  |        |                  |      |                        |
| 2.Water 5.Dug Well 8.                 |  |  |                     |                           |                  |        |                  |      |                        |
| 3.Sewer 6.Septic 9.None               |  |  |                     |                           |                  |        |                  |      |                        |
| Street <b>1 Paved</b>                 |  |  |                     |                           |                  |        |                  |      |                        |
| 1.Paved 4.Proposed 7.                 |  |  |                     |                           |                  |        |                  |      |                        |
| 2.Semi Imp 5.R/W 8.                   |  |  |                     |                           |                  |        |                  |      |                        |
| 3.Gravel 6. 9.None                    |  |  |                     |                           |                  |        |                  |      |                        |
| FLOOD PLAIN <b>0</b>                  |  |  | <b>Land Data</b>    |                           |                  |        |                  |      |                        |
| CLASS <b>1</b>                        |  |  | <b>Front Foot</b>   | <b>Type</b>               | <b>Effective</b> |        | <b>Influence</b> |      | <b>Influence Codes</b> |
| <b>Sale Data</b>                      |  |  |                     |                           | Frontage         | Depth  | Factor           | Code |                        |
| Sale Date <b>8/16/2010</b>            |  |  | 11.Regular Lot      |                           |                  |        |                  |      | 1.Unimproved           |
| Price <b>7,500</b>                    |  |  | 12.Delta Triangle   |                           |                  |        |                  |      | 2.Condition            |
| Sale Type <b>1 Land Only</b>          |  |  | 13.Nabla Triangle   |                           |                  |        |                  |      | 3.Topography           |
| 1.Land 4.Mobile 7.                    |  |  | 14.Rear Land        |                           |                  |        |                  |      | 4.Size/Shape           |
| 2.L & B 5.Other 8.                    |  |  | 15.Miscellaneous    |                           |                  |        |                  |      | 5.Access               |
| 3.Building 6. 9.                      |  |  |                     |                           |                  |        |                  |      | 6.Restricted           |
| Financing <b>9 Unknown</b>            |  |  |                     |                           |                  |        |                  |      | 7.Corner Infl          |
| 1.Convent 4.Seller 7.                 |  |  | <b>Square Foot</b>  | <b>Square Feet</b>        |                  |        |                  |      | 8.Environment          |
| 2.FHA/VA 5.Private 8.                 |  |  | 16.Regular Lot      |                           |                  |        |                  |      | 9.Fract Share          |
| 3.Assumed 6.Cash 9.Unknown            |  |  | 17.Class I Road     |                           |                  |        |                  |      | <b>Acres</b>           |
| Validity <b>1 Arms Length Sale</b>    |  |  | 18.Class II Road    |                           |                  |        |                  |      | 32.Farmland Tilla      |
| 1.Valid 4.Split 7.Changes             |  |  | 19.Condominium      |                           |                  |        |                  |      | 33.C R P               |
| 2.Related 5.Partial 8.Other           |  |  | 20.Sound Value      |                           |                  |        |                  |      | 34.Softwood-Farm       |
| 3.Distress 6.Exempt 9.                |  |  |                     |                           |                  |        |                  |      | 35.Mixed Wood-Far      |
| Verified <b>5 Public Record</b>       |  |  | <b>Fract. Acre</b>  | <b>Acres/Sites</b>        |                  |        |                  |      | 36.Hardwood-Farm       |
| 1.Buyer 4.Agent 7.Family              |  |  | 21.Homesite (Fract) | 25                        | 1.00             | 100    | %                | 0    | 37.Softwood-TG         |
| 2.Seller 5.Pub Rec 8.Other            |  |  | 22.Baselot (Fract)  | 28                        | 1.07             | 100    | %                | 0    | 38.Mixed Wood-TG       |
| 3.Lender 6.MLS 9.                     |  |  | 23.Misc (Fract)     |                           |                  |        |                  |      | 39.Hardwood-TG         |
|                                       |  |  | <b>Acres</b>        |                           |                  |        |                  |      | 40.Wasteland           |
|                                       |  |  | 24.Homesite         |                           |                  |        |                  |      | 41.Gravel Pit          |
|                                       |  |  | 25.Baselot          |                           |                  |        |                  |      | 42.Mobile Home Si      |
|                                       |  |  | 26.Secondary        |                           |                  |        |                  |      | 43.Excess Indust       |
|                                       |  |  | 27.Frontage         |                           |                  |        |                  |      | 44.Lot Improvemen      |
|                                       |  |  | 28.Rear Land (All   | <b>Total Acreage 2.07</b> |                  |        |                  |      | 45.Tower Site          |
|                                       |  |  | 31.Tillable         |                           |                  |        |                  |      | 46.Miscellaneous       |
|                                       |  |  |                     |                           |                  |        |                  |      | 47.Pavement            |
|                                       |  |  |                     |                           |                  |        |                  |      | 48.Farmland Pastu      |

**Easton**

Map Lot 008-048

Account 771

Location FULLER ROAD

Card 1 Of 1 9/28/2018

|                              |   |                                |
|------------------------------|---|--------------------------------|
| Building Style               | SF Bsmt Living  | Layout                         |
| 1.Conv. 5.Garrison 9.Gambrel | Fin Bsmt Grade  | 1.Typical 4. 7.                |
| 2.Ranch 6.Split 10.Saltbox   | OPEN-5-CUSTOMIZE  | 2.Inadeq 5. 8.                 |
| 3.R Ranch 7.Contemp 11.Other | Heat Type <b>100%</b>   | 3.Horrid 6. 9.                 |
| 4.Cape 8.Log 12.             | 1.HWBB/Rad 5.FWA 9.No Heat  | Attic                          |
| Dwelling Units               | 2.HWCI 6.GravWA 10.   | 1.1/4 Fin 4.Full Fin 7.        |
| Other Units                  | 3.H Pump 7.Electric 11.   | 2.1/2 Fin 5.F/Stair 8.         |
| Stories                      | 4.Steam 8.F/Wall 12.  | 3.3/4 Fin 6. 9.None            |
| 1.1 4.1.5 7.                 | Cool Type <b>0%</b>   | Insulation                     |
| 2.2 5.1.75 8.                | 1.Refrig 4.W&C Air 7.   | 1.Full 4.Minimal 7.            |
| 3.3 6.2.5 9.                 | 2.Evapor 5. 8.  | 2.Heavy 5.Partial 8.           |
| Exterior Walls               | 3.H Pump 6. 9.None  | 3.Capped 6. 9.None             |
| 1.Wood 5.Stucco 9.Other      | Kitchen Style   | Unfinished %                   |
| 2.Vin/Al 6.Brick 10.         | 1.Modern 4.Obsolete 7.  | Grade & Factor                 |
| 3.Compos. 7.Stone 11.        | 2.Typical 5. 8.   | 1.E Grade 4.B Grade 7.         |
| 4.Asbestos 8.Concrete 12.    | 3.Old Type 6. 9.None  | 2.D Grade 5.A Grade 8.SC Grade |
| Roof Surface                 | Bath(s) Style   | 3.C Grade 6.AA Grade 9.Same    |
| 1.Asphalt 4.Composit 7.      | 1.Modern 4.Obsolete 7.  | SQFT (Footprint)               |
| 2.Slate 5.Wood 8.            | 2.Typical 5. 8.   | Condition                      |
| 3.Metal 6.Other 9.           | 3.Old Type 6. 9.None  | 1.Poor 4.Avg 7.V G             |
| SF Masonry Trim              | # Rooms   | 2.Fair 5.Avg+ 8.Exc            |
| OPEN-3-CUSTOM                | # Bedrooms  | 3.Avg- 6.Good 9.Same           |
| OPEN-4-CUSTOM                | # Full Baths  | Phys. % Good                   |
| Year Built                   | # Half Baths  | Funct. % Good                  |
| Year Remodeled               | # Addn Fixtures   | Functional Code                |
| Foundation                   | # Fireplaces  | 1.Incomp 4.Bsmt 7.             |
| 1.Concrete 4.Wood 7.         |  | 2.O-Built 5. 8.LongTerm        |
| 2.C Block 5.Slab 8.          |   | 3.Damage 6.L-T Vaca 9.None     |
| 3.Br/Stone 6.Piers 9.        |   | Econ. % Good                   |
| Basement                     |   | Economic Code                  |
| 1.1/4 Bmt 4.Full Bmt 7.      |   | 0.None 3.No Power 7.           |
| 2.1/2 Bmt 5.None 8.          |   | 1.Location 4.Generate 8.       |
| 3.3/4 Bmt 6. 9.None          |   | 2.Encroach 9.None 9.           |
| Bsmt Gar # Cars              |   | Entrance Code <b>0</b>         |
| Wet Basement                 |   | 1.Interior 4.Vacant 7.         |
| 1.Dry 4. 7.                  |   | 2.Refusal 5.Estimate 8.        |
| 2.Damp 5. 8.                 | 3.Informed 6.Reviewed 9.  |                                |
| 3.Wet 6. 9.                  | Information Code <b>0</b>   |                                |
|                              | 1.Owner 4.Agent 7.  |                                |
|                              | 2.Relative 5.Estimate 8.  |                                |
|                              | 3.Tenant 6.Exterior 9.  |                                |

Date Inspected

**Additions, Outbuildings & Improvements**

| Type | Year | Units | Grade | Cond | Phys. | Funct. | Sound Value       |
|------|------|-------|-------|------|-------|--------|-------------------|
|      |      |       |       |      | %     | %      | 1.One Story Fram  |
|      |      |       |       |      | %     | %      | 2.Two Story Fram  |
|      |      |       |       |      | %     | %      | 3.Three Story Fr  |
|      |      |       |       |      | %     | %      | 4.1 & 1/2 Story   |
|      |      |       |       |      | %     | %      | 5.1 & 3/4 Story   |
|      |      |       |       |      | %     | %      | 6.2 & 1/2 Story   |
|      |      |       |       |      | %     | %      | 21.Open Frame Por |
|      |      |       |       |      | %     | %      | 22.Encl Frame Por |
|      |      |       |       |      | %     | %      | 23.Frame Garage   |
|      |      |       |       |      | %     | %      | 24.Frame Shed     |
|      |      |       |       |      | %     | %      | 25.Frame Bay Wind |
|      |      |       |       |      | %     | %      | 26.1SFr Overhang  |
|      |      |       |       |      | %     | %      | 27.Unfin Basement |
|      |      |       |       |      | %     | %      | 28.Unfinished Att |
|      |      |       |       |      | %     | %      | 29.Finished Attic |



GADAIRE, KRISTLE  
85 FULLER ROAD  
EASTON ME 04740 0968

B5222P307 B5666P224

Previous Owner  
NICKERSON PRATT, AMBER  
85 FULLER ROAD

EASTON ME 04740 0968  
Sale Date: 6/07/2017

Previous Owner  
LAMOREAU, CRAIG & AMANDA  
85 FULLER ROAD

EASTON ME 04740  
Sale Date: 8/21/2013

Previous Owner  
PELKEY, THOMAS J

85 FULLER RD  
PRESQUE ISLE ME 04769  
Sale Date: 12/29/2006

Inspection Witnessed By:

| X        | Date        |
|----------|-------------|
| No./Date | Description |
|          |             |
|          |             |
|          |             |

Notes:

| Property Data                                   |  |  | Assessment Record  |                      |                    |              |                  |             |                        |
|---|--|--|--------------------|----------------------|--------------------|--------------|------------------|-------------|------------------------|
| Neighborhood <b>1 Resident/Agric.</b>           |  |  | Year               | Land                 | Buildings          | Exempt       | Total            |             |                        |
| Tree Growth Year <b>0</b>                       |  |  | 2010               | 7,000                | 47,100             | 6,050        | 48,050           |             |                        |
| Recertified Date <b>0</b>                       |  |  | 2011               | 7,000                | 46,600             | 6,050        | 47,550           |             |                        |
| Y Coordinate <b>0</b>                           |  |  | 2012               | 7,000                | 46,100             | 5,940        | 47,160           |             |                        |
| Zone/Land Use <b>11 Residential</b>             |  |  | 2013               | 7,000                | 46,100             | 6,160        | 46,940           |             |                        |
| Secondary Zone                                  |  |  | 2014               | 7,000                | 45,500             | 0            | 52,500           |             |                        |
| Topography <b>2 Rolling</b>                     |  |  | 2015               | 17,500               | 67,700             | 0            | 85,200           |             |                        |
| 1.Level 4.Below St 7.                           |  |  | 2016               | 17,500               | 67,700             | 0            | 85,200           |             |                        |
| 2.Rolling 5.Low 8.                              |  |  | 2017               | 17,500               | 67,700             | 0            | 85,200           |             |                        |
| 3.Above St 6.Swampy 9.                          |  |  | 2018               | 17,500               | 67,700             | 20,000       | 65,200           |             |                        |
| Utilities <b>4 Drilled Well 6 Septic System</b> |  |  |                    |                      |                    |              |                  |             |                        |
| 1.Public 4.Dr Well 7.Cesspool                   |  |  |                    |                      |                    |              |                  |             |                        |
| 2.Water 5.Dug Well 8.                           |  |  |                    |                      |                    |              |                  |             |                        |
| 3.Sewer 6.Septic 9.None                         |  |  |                    |                      |                    |              |                  |             |                        |
| Street <b>1 Paved</b>                           |  |  |                    |                      |                    |              |                  |             |                        |
| 1.Paved 4.Proposed 7.                           |  |  |                    |                      |                    |              |                  |             |                        |
| 2.Semi Imp 5.R/W 8.                             |  |  |                    |                      |                    |              |                  |             |                        |
| 3.Gravel 6. 9.None                              |  |  |                    |                      |                    |              |                  |             |                        |
| FLOOD PLAIN <b>0</b>                            |  |  |                    |                      |                    |              |                  |             |                        |
| CLASS <b>1</b>                                  |  |  |                    |                      |                    |              |                  |             |                        |
| <b>Sale Data</b>                                |  |  |                    |                      |                    |              |                  |             |                        |
| Sale Date <b>6/07/2017</b>                      |  |  |                    |                      |                    |              |                  |             |                        |
| Price <b>132,500</b>                            |  |  |                    |                      |                    |              |                  |             |                        |
| Sale Type <b>2 Land &amp; Buildings</b>         |  |  |                    |                      |                    |              |                  |             |                        |
| 1.Land 4.Mobile 7.                              |  |  |                    |                      |                    |              |                  |             |                        |
| 2.L & B 5.Other 8.                              |  |  |                    |                      |                    |              |                  |             |                        |
| 3.Building 6. 9.                                |  |  |                    |                      |                    |              |                  |             |                        |
| Financing <b>1 Conventional</b>                 |  |  |                    |                      |                    |              |                  |             |                        |
| 1.Convent 4.Seller 7.                           |  |  |                    |                      |                    |              |                  |             |                        |
| 2.FHA/VA 5.Private 8.                           |  |  |                    |                      |                    |              |                  |             |                        |
| 3.Assumed 6.Cash 9.Unknown                      |  |  |                    |                      |                    |              |                  |             |                        |
| Validity <b>1 Arms Length Sale</b>              |  |  |                    |                      |                    |              |                  |             |                        |
| 1.Valid 4.Split 7.Changes                       |  |  |                    |                      |                    |              |                  |             |                        |
| 2.Related 5.Partial 8.Other                     |  |  |                    |                      |                    |              |                  |             |                        |
| 3.Distress 6.Exempt 9.                          |  |  |                    |                      |                    |              |                  |             |                        |
| Verified <b>5 Public Record</b>                 |  |  |                    |                      |                    |              |                  |             |                        |
| 1.Buyer 4.Agent 7.Family                        |  |  |                    |                      |                    |              |                  |             |                        |
| 2.Seller 5.Pub Rec 8.Other                      |  |  |                    |                      |                    |              |                  |             |                        |
| 3.Lender 6.MLS 9.                               |  |  |                    |                      |                    |              |                  |             |                        |
|   |  |  | <b>Land Data</b>   |                      |                    |              |                  |             |                        |
|   |  |  | <b>Front Foot</b>  | <b>Type</b>          | <b>Effective</b>   |              | <b>Influence</b> |             | <b>Influence Codes</b> |
|   |  |  |                    |                      | <b>Frontage</b>    | <b>Depth</b> | <b>Factor</b>    | <b>Code</b> |                        |
|   |  |  | 11.Regular Lot     |                      |                    |              | %                |             | 1.Unimproved           |
|   |  |  | 12.Delta Triangle  |                      |                    |              | %                |             | 2.Condition            |
|   |  |  | 13.Nabla Triangle  |                      |                    |              | %                |             | 3.Topography           |
|   |  |  | 14.Rear Land       |                      |                    |              | %                |             | 4.Size/Shape           |
|   |  |  | 15.Miscellaneous   |                      |                    |              | %                |             | 5.Access               |
|   |  |  |                    |                      |                    |              | %                |             | 6.Restricted           |
|   |  |  |                    |                      |                    |              | %                |             | 7.Corner Infl          |
|   |  |  |                    |                      |                    |              | %                |             | 8.Environment          |
|   |  |  |                    |                      |                    |              | %                |             | 9.Fract Share          |
|   |  |  |                    |                      |                    |              | %                |             | <b>Acres</b>           |
|   |  |  |                    |                      |                    |              | %                |             | 32.Farmland Tilla      |
|   |  |  |                    |                      |                    |              | %                |             | 33.C R P               |
|   |  |  |                    |                      |                    |              | %                |             | 34.Softwood-Farm       |
|   |  |  |                    |                      |                    |              | %                |             | 35.Mixed Wood-Far      |
|   |  |  |                    |                      |                    |              | %                |             | 36.Hardwood-Farm       |
|   |  |  |                    |                      |                    |              | %                |             | 37.Softwood-TG         |
|   |  |  |                    |                      |                    |              | %                |             | 38.Mixed Wood-TG       |
|   |  |  |                    |                      |                    |              | %                |             | 39.Hardwood-TG         |
|   |  |  |                    |                      |                    |              | %                |             | 40.Wasteland           |
|   |  |  |                    |                      |                    |              | %                |             | 41.Gravel Pit          |
|   |  |  |                    |                      |                    |              | %                |             | 42.Mobile Home Si      |
|   |  |  |                    |                      |                    |              | %                |             | 43.Excess Indust       |
|   |  |  |                    |                      |                    |              | %                |             | 44.Lot Improvemen      |
|   |  |  |                    |                      |                    |              | %                |             | 45.Tower Site          |
|   |  |  |                    |                      |                    |              | %                |             | 46.Miscellaneous       |
|   |  |  |                    |                      |                    |              | %                |             | 47.Pavement            |
|   |  |  |                    |                      |                    |              | %                |             | 48.Farmland Pastu      |
|   |  |  | <b>Square Foot</b> |                      | <b>Square Feet</b> |              |                  |             |                        |
|   |  |  | 16.Regular Lot     |                      |                    |              | %                |             |                        |
|   |  |  | 17.Class I Road    |                      |                    |              | %                |             |                        |
|   |  |  | 18.Class II Road   |                      |                    |              | %                |             |                        |
|   |  |  | 19.Condominium     |                      |                    |              | %                |             |                        |
|   |  |  | 20.Sound Value     |                      |                    |              | %                |             |                        |
|   |  |  |                    |                      |                    |              | %                |             |                        |
|   |  |  | <b>Fract. Acre</b> | <b>Acres/Sites</b>   |                    |              |                  |             |                        |
|   |  |  | 21.Homesite (Frac  | 24                   | 1.00               | 100          | %                | 0           |                        |
|   |  |  | 22.Baselot (Fract  | 28                   | 1.07               | 100          | %                | 0           |                        |
|   |  |  | 23.Misc (Fract)    | 44                   | 1.00               | 100          | %                | 0           |                        |
|   |  |  | <b>Acres</b>       |                      |                    |              | %                |             |                        |
|   |  |  | 24.Homesite        |                      |                    |              | %                |             |                        |
|   |  |  | 25.Baselot         |                      |                    |              | %                |             |                        |
|   |  |  | 26.Secondary       |                      |                    |              | %                |             |                        |
|   |  |  | 27.Frontage        |                      |                    |              | %                |             |                        |
|   |  |  | 28.Rear Land (All  | <b>Total Acreage</b> |                    | 2.07         |                  |             |                        |
|   |  |  | 31.Tillable        |                      |                    |              |                  |             |                        |

**Easton**

Map Lot 008-049

Account 777

Location 85 FULLER ROAD

Card 1 Of 1 9/28/2018

|  |   |                                   |
|--|---|-----------------------------------|
| Building Style <b>2 Ranch</b>          | SF Bsmt Living <b>0</b>   | Layout <b>1 Typical</b>           |
| 1.Conv. 5.Garrison 9.Gambrel           | Fin Bsmt Grade <b>0 0</b>   | 1.Typical 4. 7.                   |
| 2.Ranch 6.Split 10.Saltbox             | OPEN-5-CUSTOMIZE <b>0</b>   | 2.Inadeq 5. 8.                    |
| 3.R Ranch 7.Contemp 11.Other           | Heat Type <b>100% 1 Hot Water BB/Radiant</b>  | 3.Horrid 6. 9.                    |
| 4.Cape 8.Log 12.                       | 1.HWBB/Rad 5.FWA 9.No Heat  | Attic <b>9 None</b>               |
| Dwelling Units <b>1</b>                | 2.HWCI 6.GravWA 10.   | 1.1/4 Fin 4.Full Fin 7.           |
| Other Units <b>0</b>                   | 3.H Pump 7.Electric 11.   | 2.1/2 Fin 5.FI/Stair 8.           |
| Stories <b>1 One Story</b>             | 4.Steam 8.FI/Wall 12.   | 3.3/4 Fin 6. 9.None               |
| 1.1 4.1.5 7.                           | Cool Type <b>100% 3 Heat Pump</b>   | Insulation <b>1 Full</b>          |
| 2.2 5.1.75 8.                          | 1.Refrig 4.W&C Air 7.   | 1.Full 4.Minimal 7.               |
| 3.3 6.2.5 9.                           | 2.Evapor 5. 8.  | 2.Heavy 5.Partial 8.              |
| Exterior Walls <b>2 Vinyl/Aluminum</b> | 3.H Pump 6. 9.None  | 3.Capped 6. 9.None                |
| 1.Wood 5.Stucco 9.Other                | Kitchen Style <b>2 Typical</b>  | Unfinished % <b>0%</b>            |
| 2.Vin/Al 6.Brick 10.                   | 1.Modern 4.Obsolete 7.  | Grade & Factor <b>4 Good 100%</b> |
| 3.Compos. 7.Stone 11.                  | 2.Typical 5. 8.   | 1.E Grade 4.B Grade 7.            |
| 4.Asbestos 8.Concrete 12.              | 3.Old Type 6. 9.None  | 2.D Grade 5.A Grade 8.SC Grade    |
| Roof Surface <b>1 Asphalt Shingles</b> | Bath(s) Style <b>2 Typical Bath(s)</b>  | 3.C Grade 6.AA Grade 9.Same       |
| 1.Asphalt 4.Composit 7.                | 1.Modern 4.Obsolete 7.  | SQFT (Footprint) <b>1232</b>      |
| 2.Slate 5.Wood 8.                      | 2.Typical 5. 8.   | Condition <b>6 Good</b>           |
| 3.Metal 6.Other 9.                     | 3.Old Type 6. 9.None  | 1.Poor 4.Avg 7.V G                |
| SF Masonry Trim <b>0</b>               | # Rooms <b>5</b>  | 2.Fair 5.Avg+ 8.Exc               |
| OPEN-3-CUSTOM <b>0</b>                 | # Bedrooms <b>3</b>   | 3.Avg- 6.Good 9.Same              |
| OPEN-4-CUSTOM <b>0</b>                 | # Full Baths <b>1</b>   | Phys. % Good <b>0%</b>            |
| Year Built <b>2000</b>                 | # Half Baths <b>0</b>   | Funct. % Good <b>100%</b>         |
| Year Remodeled <b>0</b>                | # Addn Fixtures <b>0</b>  | Functional Code <b>9 None</b>     |
| Foundation <b>1 Concrete</b>           | # Fireplaces <b>0</b>   | 1.Incomp 4.Bsmt 7.                |
| 1.Concrete 4.Wood 7.                   |  <p><b>TRIO</b><br/>Software<br/>A Division of Harris Computer Systems</p> | 2.O-Built 5. 8.LongTerm           |
| 2.C Block 5.Slab 8.                    |   | 3.Damage 6.L-T Vaca 9.None        |
| 3.Br/Stone 6.Piers 9.                  |   | Econ. % Good <b>100%</b>          |
| Basement <b>4 Full Basement</b>        |   | Economic Code <b>None</b>         |
| 1.1/4 Bmt 4.Full Bmt 7.                |   | 0.None 3.No Power 7.              |
| 2.1/2 Bmt 5.None 8.                    |   | 1.Location 4.Generate 8.          |
| 3.3/4 Bmt 6. 9.None                    |   | 2.Encroach 9.None 9.              |
| Bsmt Gar # Cars <b>0</b>               |   | Entrance Code <b>5 Estimated</b>  |
| Wet Basement <b>1 Dry Basement</b>     |   | 1.Interior 4.Vacant 7.            |
| 1.Dry 4. 7.                            |   | 2.Refusal 5.Estimate 8.           |
| 2.Damp 5. 8.                           | 3.Informed 6.Reviewed 9.  |                                   |
| 3.Wet 6. 9.                            | Information Code <b>6 Exterior</b>  |                                   |
|  |   | 1.Owner 4.Agent 7.                |
|  |   | 2.Relative 5.Estimate 8.          |
|  |   | 3.Tenant 6.Exterior 9.            |

16.0'  
12.0' Shed  
S/V S800

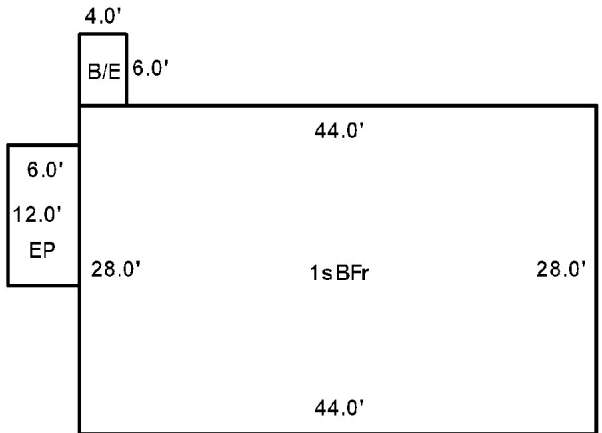

Date Inspected 6/18/2015

**Additions, Outbuildings & Improvements**

| Type                | Year | Units | Grade | Cond | Phys. | Funct. | Sound Value |
|---------------------|------|-------|-------|------|-------|--------|-------------|
| 22 Encl Frame Porch | 2004 | 72    | 9 100 | 9    | 0 %   | 100 %  |             |
| 24 Frame Shed       | 2004 |       |       |      | %     | %      | 1,500       |
| 83 Frame BSMT       | 0    | 24    | 0 0   | 0    | 0 %   | 0 %    |             |
|                     |      |       |       |      | %     | %      |             |
|                     |      |       |       |      | %     | %      |             |
|                     |      |       |       |      | %     | %      |             |
|                     |      |       |       |      | %     | %      |             |
|                     |      |       |       |      | %     | %      |             |
|                     |      |       |       |      | %     | %      |             |
|                     |      |       |       |      | %     | %      |             |
|                     |      |       |       |      | %     | %      |             |



- 1.One Story Fram
- 2.Two Story Fram
- 3.Three Story Fr
- 4.1 & 1/2 Story
- 5.1 & 3/4 Story
- 6.2 & 1/2 Story
- 21.Open Frame Por
- 22.Encl Frame Por
- 23.Frame Garage
- 24.Frame Shed
- 25.Frame Bay Wind
- 26.1SFr Overhang
- 27.Unfin Basement
- 28.Unfinished Att
- 29.Finished Attic

RACE, BYRON  
PO BOX 4211  
PRESQUE ISLE ME 04769

B4252P26

Inspection Witnessed By:

| No./Date | Description | Date Insp. |
|----------|-------------|------------|
| X        |             |            |
|          |             |            |
|          |             |            |

Notes:

Easton

| Property Data    |                                       |            | Assessment Record |               |                      |             |           |      |                   |
|------------------|---------------------------------------|------------|-------------------|---------------|----------------------|-------------|-----------|------|-------------------|
| Neighborhood     | <b>1 Resident/Agric.</b>              |            | Year              | Land          | Buildings            | Exempt      | Total     |      |                   |
| Tree Growth Year | <b>0</b>                              |            | 2010              | 3,500         | 0                    | 0           | 3,500     |      |                   |
| Recertified Date | <b>0</b>                              |            | 2011              | 3,500         | 0                    | 0           | 3,500     |      |                   |
| Y Coordinate     | <b>0</b>                              |            | 2012              | 3,500         | 0                    | 0           | 3,500     |      |                   |
| Zone/Land Use    | <b>11 Residential</b>                 |            | 2013              | 7,000         | 57,100               | 0           | 64,100    |      |                   |
| Secondary Zone   |                                       |            | 2014              | 7,000         | 57,100               | 0           | 64,100    |      |                   |
| Topography       | <b>2 Rolling</b>                      |            | 2015              | 17,500        | 76,700               | 0           | 94,200    |      |                   |
| 1.Level          | 4.Below St                            | 7.         | 2016              | 17,500        | 76,700               | 15,000      | 79,200    |      |                   |
| 2.Rolling        | 5.Low                                 | 8.         | 2017              | 17,500        | 76,700               | 20,000      | 74,200    |      |                   |
| 3.Above St       | 6.Swampy                              | 9.         | 2018              | 17,500        | 76,700               | 20,000      | 74,200    |      |                   |
| Utilities        | <b>4 Drilled Well 6 Septic System</b> |            |                   |               |                      |             |           |      |                   |
| 1.Public         | 4.Dr Well                             | 7.Cesspool |                   |               |                      |             |           |      |                   |
| 2.Water          | 5.Dug Well                            | 8.         |                   |               |                      |             |           |      |                   |
| 3.Sewer          | 6.Septic                              | 9.None     |                   |               |                      |             |           |      |                   |
| Street           | <b>1 Paved</b>                        |            |                   |               |                      |             |           |      |                   |
| 1.Paved          | 4.Proposed                            | 7.         |                   |               |                      |             |           |      |                   |
| 2.Semi Imp       | 5.R/W                                 | 8.         |                   |               |                      |             |           |      |                   |
| 3.Gravel         | 6.                                    | 9.None     |                   |               |                      |             |           |      |                   |
| FLOOD PLAIN      | <b>0</b>                              |            |                   |               |                      |             |           |      |                   |
| CLASS            | <b>1</b>                              |            |                   |               |                      |             |           |      |                   |
| Sale Data        |                                       |            |                   |               |                      |             |           |      |                   |
| Sale Date        | <b>3/01/2006</b>                      |            |                   |               |                      |             |           |      |                   |
| Price            | <b>9,000</b>                          |            |                   |               |                      |             |           |      |                   |
| Sale Type        | <b>1 Land Only</b>                    |            |                   |               |                      |             |           |      |                   |
| 1.Land           | 4.Mobile                              | 7.         |                   |               |                      |             |           |      |                   |
| 2.L & B          | 5.Other                               | 8.         |                   |               |                      |             |           |      |                   |
| 3.Building       | 6.                                    | 9.         |                   |               |                      |             |           |      |                   |
| Financing        | <b>9 Unknown</b>                      |            |                   |               |                      |             |           |      |                   |
| 1.Convent        | 4.Seller                              | 7.         |                   |               |                      |             |           |      |                   |
| 2.FHA/VA         | 5.Private                             | 8.         |                   |               |                      |             |           |      |                   |
| 3.Assumed        | 6.Cash                                | 9.Unknown  |                   |               |                      |             |           |      |                   |
| Validity         | <b>1 Arms Length Sale</b>             |            |                   |               |                      |             |           |      |                   |
| 1.Valid          | 4.Split                               | 7.Changes  |                   |               |                      |             |           |      |                   |
| 2.Related        | 5.Partial                             | 8.Other    |                   |               |                      |             |           |      |                   |
| 3.Distress       | 6.Exempt                              | 9.         |                   |               |                      |             |           |      |                   |
| Verified         | <b>5 Public Record</b>                |            |                   |               |                      |             |           |      |                   |
| 1.Buyer          | 4.Agent                               | 7.Family   |                   |               |                      |             |           |      |                   |
| 2.Seller         | 5.Pub Rec                             | 8.Other    |                   |               |                      |             |           |      |                   |
| 3.Lender         | 6.MLS                                 | 9.         |                   |               |                      |             |           |      |                   |
| Land Data        |                                       |            |                   |               |                      |             |           |      |                   |
|                  |                                       |            | Front Foot        | Type          | Effective            |             | Influence |      | Influence Codes   |
|                  |                                       |            |                   |               | Frontage             | Depth       | Factor    | Code |                   |
|                  |                                       |            | 11.Regular Lot    |               |                      |             | %         |      | 1.Unimproved      |
|                  |                                       |            | 12.Delta Triangle |               |                      |             | %         |      | 2.Condition       |
|                  |                                       |            | 13.Nabla Triangle |               |                      |             | %         |      | 3.Topography      |
|                  |                                       |            | 14.Rear Land      |               |                      |             | %         |      | 4.Size/Shape      |
|                  |                                       |            | 15.Miscellaneous  |               |                      |             | %         |      | 5.Access          |
|                  |                                       |            |                   |               |                      |             | %         |      | 6.Restricted      |
|                  |                                       |            |                   |               |                      |             | %         |      | 7.Corner Infl     |
|                  |                                       |            |                   |               |                      |             | %         |      | 8.Environment     |
|                  |                                       |            |                   |               |                      |             | %         |      | 9.Fract Share     |
|                  |                                       |            | Square Foot       | Square Feet   |                      |             |           |      | Acres             |
|                  |                                       |            | 16.Regular Lot    |               |                      |             | %         |      | 32.Farmland Tilla |
|                  |                                       |            | 17.Class I Road   |               |                      |             | %         |      | 33.C R P          |
|                  |                                       |            | 18.Class II Road  |               |                      |             | %         |      | 34.Softwood-Farm  |
|                  |                                       |            | 19.Condominium    |               |                      |             | %         |      | 35.Mixed Wood-Far |
|                  |                                       |            | 20.Sound Value    |               |                      |             | %         |      | 36.Hardwood-Farm  |
|                  |                                       |            |                   |               |                      |             | %         |      | 37.Softwood-TG    |
|                  |                                       |            | Fract. Acre       | Acreage/Sites |                      |             |           |      | 38.Mixed Wood-TG  |
|                  |                                       |            | 21.Homesite (Frac | 24            |                      | 1.00        | 100 %     | 0    | 39.Hardwood-TG    |
|                  |                                       |            | 22.Baslot (Fract  | 28            |                      | 1.07        | 100 %     | 0    | 40.Wasteland      |
|                  |                                       |            | 23.Misc (Fract)   | 44            |                      | 1.00        | 100 %     | 0    | 41.Gravel Pit     |
|                  |                                       |            | Acres             |               |                      |             | %         |      | 42.Mobile Home Si |
|                  |                                       |            | 24.Homesite       |               |                      |             | %         |      | 43.Excess Indust  |
|                  |                                       |            | 25.Baslot         |               |                      |             | %         |      | 44.Lot Improvemen |
|                  |                                       |            | 26.Secondary      |               |                      |             | %         |      | 45.Tower Site     |
|                  |                                       |            | 27.Frontage       |               |                      |             | %         |      | 46.Miscellaneous  |
|                  |                                       |            | 28.Rear Land (All |               |                      |             | %         |      | 47.Pavement       |
|                  |                                       |            | 31.Tillable       |               |                      |             | %         |      | 48.Farmland Pastu |
|                  |                                       |            |                   |               | <b>Total Acreage</b> | <b>2.07</b> |           |      |                   |

**Easton**

Map Lot 008-050

Account 819

Location 87 FULLER ROAD

Card 1 Of 1 9/28/2018

|  |   |   |
|--|---|---|
| Building Style <b>4 Cape Cod</b>       | SF Bsmt Living <b>0</b>   | Layout <b>1 Typical</b>                 |
| 1.Conv. 5.Garrison 9.Gambrel           | Fin Bsmt Grade <b>0 0</b>   | 1.Typical 4. 7.                         |
| 2.Ranch 6.Split 10.Saltbox             | OPEN-5-CUSTOMIZE <b>0</b>   | 2.Inadeq 5. 8.                          |
| 3.R Ranch 7.Contemp 11.Other           | Heat Type <b>100% 1 Hot Water BB/Radiant</b>  | 3.Horrid 6. 9.                          |
| 4.Cape 8.Log 12.                       | 1.HWBB/Rad 5.FWA 9.No Heat  | Attic <b>9 None</b>                     |
| Dwelling Units <b>1</b>                | 2.HWCI 6.GravWA 10.   | 1.1/4 Fin 4.Full Fin 7.                 |
| Other Units <b>0</b>                   | 3.H Pump 7.Electric 11.   | 2.1/2 Fin 5.FI/Stair 8.                 |
| Stories <b>4 One &amp; 1/2 Story</b>   | 4.Steam 8.FI/Wall 12.   | 3.3/4 Fin 6. 9.None                     |
| 1.1 4.1.5 7.                           | Cool Type <b>0% 9 None</b>  | Insulation <b>1 Full</b>                |
| 2.2 5.1.75 8.                          | 1.Refrig 4.W&C Air 7.   | 1.Full 4.Minimal 7.                     |
| 3.3 6.2.5 9.                           | 2.Evapor 5. 8.  | 2.Heavy 5.Partial 8.                    |
| Exterior Walls <b>2 Vinyl/Aluminum</b> | 3.H Pump 6. 9.None  | 3.Capped 6. 9.None                      |
| 1.Wood 5.Stucco 9.Other                | Kitchen Style <b>2 Typical</b>  | Unfinished % <b>0%</b>                  |
| 2.Vin/Al 6.Brick 10.                   | 1.Modern 4.Obsolete 7.  | Grade & Factor <b>3 Average 105%</b>    |
| 3.Compos. 7.Stone 11.                  | 2.Typical 5. 8.   | 1.E Grade 4.B Grade 7.                  |
| 4.Asbestos 8.Concrete 12.              | 3.Old Type 6. 9.None  | 2.D Grade 5.A Grade 8.SC Grade          |
| Roof Surface <b>3 Sheet Metal</b>      | Bath(s) Style <b>2 Typical Bath(s)</b>  | 3.C Grade 6.AA Grade 9.Same             |
| 1.Asphalt 4.Composit 7.                | 1.Modern 4.Obsolete 7.  | SQFT (Footprint) <b>784</b>             |
| 2.Slate 5.Wood 8.                      | 2.Typical 5. 8.   | Condition <b>4 Average</b>              |
| 3.Metal 6.Other 9.                     | 3.Old Type 6. 9.None  | 1.Poor 4.Avg 7.V G                      |
| SF Masonry Trim <b>0</b>               | # Rooms <b>5</b>  | 2.Fair 5.Avg+ 8.Exc                     |
| OPEN-3-CUSTOM <b>0</b>                 | # Bedrooms <b>2</b>   | 3.Avg- 6.Good 9.Same                    |
| OPEN-4-CUSTOM <b>0</b>                 | # Full Baths <b>1</b>   | Phys. % Good <b>0%</b>                  |
| Year Built <b>2012</b>                 | # Half Baths <b>1</b>   | Funct. % Good <b>100%</b>               |
| Year Remodeled <b>0</b>                | # Addn Fixtures <b>0</b>  | Functional Code <b>9 None</b>           |
| Foundation <b>1 Concrete</b>           | # Fireplaces <b>0</b>   | 1.Incomp 4.Bsmt 7.                      |
| 1.Concrete 4.Wood 7.                   |  <p><b>TRIO</b><br/>Software<br/>A Division of Harris Computer Systems</p> | 2.O-Built 5. 8.LongTerm                 |
| 2.C Block 5.Slab 8.                    |   | 3.Damage 6.L-T Vaca 9.None              |
| 3.Br/Stone 6.Piers 9.                  |   | Econ. % Good <b>100%</b>                |
| Basement <b>4 Full Basement</b>        |   | Economic Code <b>None</b>               |
| 1.1/4 Bmt 4.Full Bmt 7.                |   | 0.None 3.No Power 7.                    |
| 2.1/2 Bmt 5.None 8.                    |   | 1.Location 4.Generate 8.                |
| 3.3/4 Bmt 6. 9.None                    |   | 2.Encroach 9.None 9.                    |
| Bsmt Gar # Cars <b>0</b>               |   | Entrance Code <b>1 Interior Inspect</b> |
| Wet Basement <b>1 Dry Basement</b>     |   | 1.Interior 4.Vacant 7.                  |
| 1.Dry 4. 7.                            |   | 2.Refusal 5.Estimate 8.                 |
| 2.Damp 5. 8.                           | 3.Informed 6.Reviewed 9.  |   |
| 3.Wet 6. 9.                            | Information Code <b>1 Owner</b>   |   |
|  | 1.Owner 4.Agent 7.  |   |
|  | 2.Relative 5.Estimate 8.  |   |
|  | 3.Tenant 6.Exterior 9.  |   |

Date Inspected 7/30/2015

**Additions, Outbuildings & Improvements**

| Type            | Year | Units | Grade | Cond | Phys. | Funct. | Sound Value |
|-----------------|------|-------|-------|------|-------|--------|-------------|
| 68 Wood Deck    | 0    | 64    | 4 100 | 4    | 0 %   | 100 %  |             |
| 68 Wood Deck    | 0    | 320   | 9 100 | 4    | 0 %   | 100 %  |             |
| 23 Frame Garage | 0    | 1008  | 3 100 | 4    | 0 %   | 75 %   |             |
| 24 Frame Shed   | 0    | 144   | 3 100 | 4    | 0 %   | 100 %  |             |
|                 |      |       |       |      | %     | %      |             |
|                 |      |       |       |      | %     | %      |             |
|                 |      |       |       |      | %     | %      |             |
|                 |      |       |       |      | %     | %      |             |
|                 |      |       |       |      | %     | %      |             |
|                 |      |       |       |      | %     | %      |             |
|                 |      |       |       |      | %     | %      |             |
|                 |      |       |       |      | %     | %      |             |

