



**Easton**

Map Lot 006-031

Account 852

Location GRAHAM ROAD

Card 1 Of 1 9/27/2018

Building Style	SF Bsmt Living	Layout
1.Conv. 5.Garrison 9.Gambrel	Fin Bsmt Grade	1.Typical 4. 7.
2.Ranch 6.Split 10.Saltbox	OPEN-5-CUSTOMIZE	2.Inadeq 5. 8.
3.R Ranch 7.Contemp 11.Other	Heat Type <b>100%</b>	3.Horrid 6. 9.
4.Cape 8.Log 12.	1.HWBB/Rad 5.FWA 9.No Heat	Attic
Dwelling Units	2.HWCI 6.GravWA 10.	1.1/4 Fin 4.Full Fin 7.
Other Units	3.H Pump 7.Electric 11.	2.1/2 Fin 5.F/Stair 8.
Stories	4.Steam 8.F/Wall 12.	3.3/4 Fin 6. 9.None
1.1 4.1.5 7.	Cool Type <b>0%</b>	Insulation
2.2 5.1.75 8.	1.Refrig 4.W&C Air 7.	1.Full 4.Minimal 7.
3.3 6.2.5 9.	2.Evapor 5. 8.	2.Heavy 5.Partial 8.
Exterior Walls	3.H Pump 6. 9.None	3.Capped 6. 9.None
1.Wood 5.Stucco 9.Other	Kitchen Style	Unfinished %
2.Vin/Al 6.Brick 10.	1.Modern 4.Obsolete 7.	Grade & Factor
3.Compos. 7.Stone 11.	2.Typical 5. 8.	1.E Grade 4.B Grade 7.
4.Asbestos 8.Concrete 12.	3.Old Type 6. 9.None	2.D Grade 5.A Grade 8.SC Grade
Roof Surface	Bath(s) Style	3.C Grade 6.AA Grade 9.Same
1.Asphalt 4.Composit 7.	1.Modern 4.Obsolete 7.	SQFT (Footprint)
2.Slate 5.Wood 8.	2.Typical 5. 8.	Condition
3.Metal 6.Other 9.	3.Old Type 6. 9.None	1.Poor 4.Avg 7.V G
SF Masonry Trim	# Rooms	2.Fair 5.Avg+ 8.Exc
OPEN-3-CUSTOM	# Bedrooms	3.Avg- 6.Good 9.Same
OPEN-4-CUSTOM	# Full Baths	Phys. % Good
Year Built	# Half Baths	Funct. % Good
Year Remodeled	# Addn Fixtures	Functional Code
Foundation	# Fireplaces	1.Incomp 4.Bsmt 7.
1.Concrete 4.Wood 7.		2.O-Built 5. 8.LongTerm
2.C Block 5.Slab 8.		3.Damage 6.L-T Vaca 9.None
3.Br/Stone 6.Piers 9.		Econ. % Good
Basement		Economic Code
1.1/4 Bmt 4.Full Bmt 7.		0.None 3.No Power 7.
2.1/2 Bmt 5.None 8.		1.Location 4.Generate 8.
3.3/4 Bmt 6. 9.None		2.Encroach 9.None 9.
Bsmt Gar # Cars		Entrance Code <b>0</b>
Wet Basement		1.Interior 4.Vacant 7.
1.Dry 4. 7.		2.Refusal 5.Estimate 8.
2.Damp 5. 8.	3.Informed 6.Reviewed 9.	
3.Wet 6. 9.	Information Code <b>0</b>	
	1.Owner 4.Agent 7.	
	2.Relative 5.Estimate 8.	
	3.Tenant 6.Exterior 9.	

Date Inspected

**Additions, Outbuildings & Improvements**

Type	Year	Units	Grade	Cond	Phys.	Funct.	Sound Value
					%	%	1.One Story Fram
					%	%	2.Two Story Fram
					%	%	3.Three Story Fr
					%	%	4.1 & 1/2 Story
					%	%	5.1 & 3/4 Story
					%	%	6.2 & 1/2 Story
					%	%	21.Open Frame Por
					%	%	22.Encl Frame Por
					%	%	23.Frame Garage
					%	%	24.Frame Shed
					%	%	25.Frame Bay Wind
					%	%	26.1SFr Overhang
					%	%	27.Unfin Basement
					%	%	28.Unfinished Att
					%	%	29.Finished Attic



**Easton**

Map Lot 006-032

Account 78

Location GRAHAM ROAD

Card 1 Of 1 9/27/2018

Building Style	SF Bsmt Living	Layout
1.Conv. 5.Garrison 9.Gambrel	Fin Bsmt Grade	1.Typical 4. 7.
2.Ranch 6.Split 10.Saltbox	OPEN-5-CUSTOMIZE	2.Inadeq 5. 8.
3.R Ranch 7.Contemp 11.Other	Heat Type <b>100%</b>	3.Horrid 6. 9.
4.Cape 8.Log 12.	1.HWBB/Rad 5.FWA 9.No Heat	Attic
Dwelling Units	2.HWCI 6.GravWA 10.	1.1/4 Fin 4.Full Fin 7.
Other Units	3.H Pump 7.Electric 11.	2.1/2 Fin 5.FI/Stair 8.
Stories	4.Steam 8.FI/Wall 12.	3.3/4 Fin 6. 9.None
1.1 4.1.5 7.	Cool Type <b>0%</b>	Insulation
2.2 5.1.75 8.	1.Refrig 4.W&C Air 7.	1.Full 4.Minimal 7.
3.3 6.2.5 9.	2.Evapor 5. 8.	2.Heavy 5.Partial 8.
Exterior Walls	3.H Pump 6. 9.None	3.Capped 6. 9.None
1.Wood 5.Stucco 9.Other	Kitchen Style	Unfinished %
2.Vin/Al 6.Brick 10.	1.Modern 4.Obsolete 7.	Grade & Factor
3.Compos. 7.Stone 11.	2.Typical 5. 8.	1.E Grade 4.B Grade 7.
4.Asbestos 8.Concrete 12.	3.Old Type 6. 9.None	2.D Grade 5.A Grade 8.SC Grade
Roof Surface	Bath(s) Style	3.C Grade 6.AA Grade 9.Same
1.Asphalt 4.Composit 7.	1.Modern 4.Obsolete 7.	SQFT (Footprint)
2.Slate 5.Wood 8.	2.Typical 5. 8.	Condition
3.Metal 6.Other 9.	3.Old Type 6. 9.None	1.Poor 4.Avg 7.V G
SF Masonry Trim	# Rooms	2.Fair 5.Avg+ 8.Exc
OPEN-3-CUSTOM	# Bedrooms	3.Avg- 6.Good 9.Same
OPEN-4-CUSTOM	# Full Baths	Phys. % Good
Year Built	# Half Baths	Funct. % Good
Year Remodeled	# Addn Fixtures	Functional Code
Foundation	# Fireplaces	1.Incomp 4.Bsmt 7.
1.Concrete 4.Wood 7.		2.O-Built 5. 8.LongTerm
2.C Block 5.Slab 8.		3.Damage 6.L-T Vaca 9.None
3.Br/Stone 6.Piers 9.		Econ. % Good
Basement		Economic Code
1.1/4 Bmt 4.Full Bmt 7.		0.None 3.No Power 7.
2.1/2 Bmt 5.None 8.		1.Location 4.Generate 8.
3.3/4 Bmt 6. 9.None		2.Encroach 9.None 9.
Bsmt Gar # Cars		Entrance Code <b>0</b>
Wet Basement		1.Interior 4.Vacant 7.
1.Dry 4. 7.		2.Refusal 5.Estimate 8.
2.Damp 5. 8.	3.Informed 6.Reviewed 9.	
3.Wet 6. 9.	Information Code <b>0</b>	
	1.Owner 4.Agent 7.	
	2.Relative 5.Estimate 8.	
	3.Tenant 6.Exterior 9.	
Date Inspected		

Additions, Outbuildings & Improvements								
Type	Year	Units	Grade	Cond	Phys.	Funct.	Sound Value	
					%	%		1.One Story Fram
					%	%		2.Two Story Fram
					%	%		3.Three Story Fr
					%	%		4.1 & 1/2 Story
					%	%		5.1 & 3/4 Story
					%	%		6.2 & 1/2 Story
					%	%		21.Open Frame Por
					%	%		22.Encl Frame Por
					%	%		23.Frame Garage
					%	%		24.Frame Shed
					%	%		25.Frame Bay Wind
					%	%		26.1SFr Overhang
					%	%		27.Unfin Basement
					%	%		28.Unfinished Att
					%	%		29.Finished Attic

TRASK, NORMAN G  
TRASK, ELLEN B  
PO BOX 264  
EASTON ME 04740

B3946P121

Inspection Witnessed By:

X

Date

No./Date	Description	Date Insp.

Notes:

1>M 00 00 00 00 00 00 00 00 001U 068U 001K  
023= 000 000 000 000 000 000  
00127700000001 1 062397  
19901.....  
~~0007741T3 21T 44~ 00 00 00 00 00 068...  
021J 022b 001 000 000 000 000 000  
0010160000.421 1 062397  
19791.....  
~~0007752T3 22U 00 00 00 00 00 00 000  
Easton 000 000 000 000 000 000 000  
0000000000 341 1 062397

Property Data			Assessment Record						
Neighborhood <b>1 Resident/Agric.</b>			Year	Land	Buildings	Exempt	Total		
Tree Growth Year <b>0</b>			2010	35,400	108,800	6,050	138,150		
Recertified Date <b>0</b>			2011	35,400	108,800	6,050	138,150		
Y Coordinate <b>0</b>			2012	35,400	107,600	5,940	137,060		
Zone/Land Use <b>11 Residential</b>			2013	35,400	106,400	6,160	135,640		
Secondary Zone			2014	35,400	106,400	6,160	135,640		
Topography <b>2 Rolling 3 Above Street</b>			2015	80,800	122,300	10,000	193,100		
1.Level 4.Below St 7.			2016	80,800	122,300	15,000	188,100		
2.Rolling 5.Low 8.			2017	80,800	122,300	20,000	183,100		
3.Above St 6.Swampy 9.			2018	80,800	122,300	20,000	183,100		
Utilities <b>4 Drilled Well 6 Septic System</b>									
1.Public 4.Dr Well 7.Cesspool									
2.Water 5.Dug Well 8.									
3.Sewer 6.Septic 9.None									
Street <b>1 Paved</b>									
1.Paved 4.Proposed 7.									
2.Semi Imp 5.R/W 8.									
3.Gravel 6. 9.None									
FLOOD PLAIN <b>0</b>									
CLASS <b>1</b>									
<b>Sale Data</b>									
Sale Date									
Price									
Sale Type									
1.Land 4.Mobile 7.									
2.L & B 5.Other 8.									
3.Building 6. 9.									
Financing									
1.Convent 4.Seller 7.									
2.FHA/VA 5.Private 8.									
3.Assumed 6.Cash 9.Unknown									
Validity									
1.Valid 4.Split 7.Changes									
2.Related 5.Partial 8.Other									
3.Distress 6.Exempt 9.									
Verified									
1.Buyer 4.Agent 7.Family									
2.Seller 5.Pub Rec 8.Other									
3.Lender 6.MLS 9.									
			<b>Land Data</b>						
			<b>Front Foot</b>	<b>Type</b>	<b>Effective</b>		<b>Influence</b>		<b>Influence Codes</b>
					<b>Frontage</b>	<b>Depth</b>	<b>Factor</b>	<b>Code</b>	
			11.Regular Lot					%	1.Unimproved
			12.Delta Triangle					%	2.Condition
			13.Nabla Triangle					%	3.Topography
			14.Rear Land					%	4.Size/Shape
			15.Miscellaneous					%	5.Access
								%	6.Restricted
								%	7.Corner Infl
								%	8.Environment
								%	9.Fract Share
			<b>Square Foot</b>	<b>Square Feet</b>					<b>Acres</b>
			16.Regular Lot	47	900		100	%	0
			17.Class I Road					%	32.Farmland Tilla
			18.Class II Road					%	33.C R P
			19.Condominium					%	34.Softwood-Farm
			20.Sound Value					%	35.Mixed Wood-Far
								%	36.Hardwood-Farm
								%	37.Softwood-TG
								%	38.Mixed Wood-TG
			<b>Fract. Acre</b>	<b>Acreage/Sites</b>					
			21.Homesite (Frac	24	1.00		100	%	0
			22.Baselot (Frac	28	49.10		100	%	0
			23.Misc (Frac)	31	37.00		100	%	0
			<b>Acres</b>	44	1.00		100	%	0
			24.Homesite					%	42.Mobile Home Si
			25.Baselot					%	43.Excess Indust
			26.Secondary					%	44.Lot Improvemen
			27.Frontage					%	45.Tower Site
			28.Rear Land (All					%	46.Miscellaneous
			31.Tillable					%	47.Pavement
			<b>Total Acreage</b>		87.10				48.Farmland Pastu

**Easton**

Map Lot 006-033

Account 79

Location 45 GRAHAM ROAD

Card 1 Of 1 9/27/2018

Building Style <b>1 Conventional</b>	SF Bsmt Living <b>884</b>	Layout <b>1 Typical</b>
1.Conv. 5.Garrison 9.Gambrel	Fin Bsmt Grade <b>9 100</b>	1.Typical 4. 7.
2.Ranch 6.Split 10.Saltbox	OPEN-5-CUSTOMIZE <b>0</b>	2.Inadeq 5. 8.
3.R Ranch 7.Contemp 11.Other	Heat Type <b>100% 1 Hot Water BB/Radiant</b>	3.Horrid 6. 9.
4.Cape 8.Log 12.	1.HWBB/Rad 5.FWA 9.No Heat	Attic <b>9 None</b>
Dwelling Units <b>1</b>	2.HWCI 6.GravWA 10.	1.1/4 Fin 4.Full Fin 7.
Other Units <b>0</b>	3.H Pump 7.Electric 11.	2.1/2 Fin 5.FI/Stair 8.
Stories <b>2 Two Story</b>	4.Steam 8.FI/Wall 12.	3.3/4 Fin 6. 9.None
1.1 4.1.5 7.	Cool Type <b>0% 9 None</b>	Insulation <b>1 Full</b>
2.2 5.1.75 8.	1.Refrig 4.W&C Air 7.	1.Full 4.Minimal 7.
3.3 6.2.5 9.	2.Evapor 5. 8.	2.Heavy 5.Partial 8.
Exterior Walls <b>2 Vinyl/Aluminum</b>	3.H Pump 6. 9.None	3.Capped 6. 9.None
1.Wood 5.Stucco 9.Other	Kitchen Style <b>2 Typical</b>	Unfinished % <b>0%</b>
2.Vin/Al 6.Brick 10.	1.Modern 4.Obsolete 7.	Grade & Factor <b>3 Average 110%</b>
3.Compos. 7.Stone 11.	2.Typical 5. 8.	1.E Grade 4.B Grade 7.
4.Asbestos 8.Concrete 12.	3.Old Type 6. 9.None	2.D Grade 5.A Grade 8.SC Grade
Roof Surface <b>1 Asphalt Shingles</b>	Bath(s) Style <b>2 Typical Bath(s)</b>	3.C Grade 6.AA Grade 9.Same
1.Asphalt 4.Composit 7.	1.Modern 4.Obsolete 7.	SQFT (Footprint) <b>1178</b>
2.Slate 5.Wood 8.	2.Typical 5. 8.	Condition <b>4 Average</b>
3.Metal 6.Other 9.	3.Old Type 6. 9.None	1.Poor 4.Avg 7.V G
SF Masonry Trim <b>0</b>	# Rooms <b>7</b>	2.Fair 5.Avg+ 8.Exc
OPEN-3-CUSTOM <b>0</b>	# Bedrooms <b>3</b>	3.Avg- 6.Good 9.Same
OPEN-4-CUSTOM <b>0</b>	# Full Baths <b>2</b>	Phys. % Good <b>0%</b>
Year Built <b>2004</b>	# Half Baths <b>1</b>	Funct. % Good <b>100%</b>
Year Remodeled <b>0</b>	# Addn Fixtures <b>1</b>	Functional Code <b>9 None</b>
Foundation <b>1 Concrete</b>	# Fireplaces <b>0</b>	1.Incomp 4.Bsmt 7.
1.Concrete 4.Wood 7.		2.O-Built 5. 8.LongTerm
2.C Block 5.Slab 8.		3.Damage 6.L-T Vaca 9.None
3.Br/Stone 6.Piers 9.		Econ. % Good <b>100%</b>
Basement <b>4 Full Basement</b>		Economic Code <b>None</b>
1.1/4 Bmt 4.Full Bmt 7.		0.None 3.No Power 7.
2.1/2 Bmt 5.None 8.		1.Location 4.Generate 8.
3.3/4 Bmt 6. 9.None		2.Encroach 9.None 9.
Bsmt Gar # Cars <b>0</b>		Entrance Code <b>1 Interior Inspect</b>
Wet Basement <b>3 Wet Basement</b>		1.Interior 4.Vacant 7.
1.Dry 4. 7.		2.Refusal 5.Estimate 8.
2.Damp 5. 8.	3.Informed 6.Reviewed 9.	
3.Wet 6. 9.	Information Code <b>1 Owner</b>	
		1.Owner 4.Agent 7.
		2.Relative 5.Estimate 8.
		3.Tenant 6.Exterior 9.

Date Inspected 7/01/2015

**Additions, Outbuildings & Improvements**

Type	Year	Units	Grade	Cond	Phys.	Funct.	Sound Value
21 Open Frame	0	341	0 0	0	0 %	0 %	
68 Wood Deck	2007	196	3 100	4	0 %	100 %	
79 1.25 S-Gar	0	896	9 100	9	0 %	80 %	
67 Barn	0	900	3 100	4	0 %	100 %	
					%	%	
					%	%	
					%	%	
					%	%	
					%	%	
					%	%	
					%	%	
					%	%	

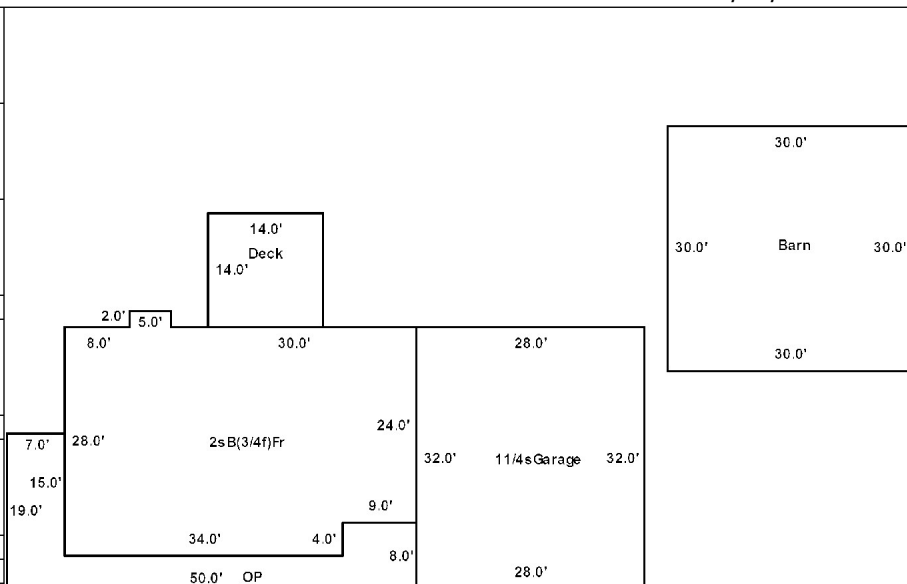

TRASK, NORMAN D  
TRASK, ELLEN B JT  
PO BOX 264  
EASTON ME 04740 0264

B5168P72

Previous Owner  
SHANNON, JOHN  
37 JULIAN ST

HICKSVILLE NY 11801  
Sale Date: 4/10/2013

Inspection Witnessed By:

X Date

No./Date	Description	Date Insp.

Notes:  
\*Formerly a homesite, well and septic remain

Easton

Property Data			Assessment Record					
Neighborhood <b>1 Resident/Agric.</b>			Year	Land	Buildings	Exempt	Total	
Tree Growth Year <b>0</b>			2010	13,900	10,400	0	24,300	
Recertified Date <b>0</b>			2011	13,900	10,400	0	24,300	
Y Coordinate <b>0</b>			2012	13,900	10,400	0	24,300	
Zone/Land Use <b>11 Residential</b>			2013	13,900	10,400	0	24,300	
Secondary Zone			2014	13,900	700	0	14,600	
Topography <b>1 Level 2 Rolling</b>			2015	32,500	5,300	0	37,800	
1.Level 4.Below St 7.			2016	32,500	5,300	0	37,800	
2.Rolling 5.Low 8.			2017	25,000	5,300	0	30,300	
3.Above St 6.Swampy 9.			2018	25,000	5,300	0	30,300	
Utilities <b>4 Drilled Well 6 Septic System</b>								
1.Public 4.Dr Well 7.Cesspool								
2.Water 5.Dug Well 8.								
3.Sewer 6.Septic 9.None								
Street <b>1 Paved</b>								
1.Paved 4.Proposed 7.								
2.Semi Imp 5.R/W 8.								
3.Gravel 6. 9.None								
FLOOD PLAIN <b>0</b>			<b>Land Data</b>					
CLASS <b>1</b>			<b>Front Foot</b>	<b>Type</b>	<b>Effective</b>		<b>Influence</b>	
<b>Sale Data</b>			11.Regular Lot		<b>Frontage</b>	<b>Depth</b>	<b>Factor</b>	<b>Code</b>
			12.Delta Triangle					
Sale Date <b>4/10/2013</b>			13.Nabla Triangle					
Price <b>20,000</b>			14.Rear Land					
Sale Type <b>2 Land &amp; Buildings</b>			15.Miscellaneous					
1.Land 4.Mobile 7.			<b>Square Foot</b>		<b>Square Feet</b>			
2.L & B 5.Other 8.			16.Regular Lot					
3.Building 6. 9.			17.Class I Road					
Financing <b>9 Unknown</b>			18.Class II Road					
1.Convent 4.Seller 7.			19.Condominium					
2.FHA/VA 5.Private 8.			20.Sound Value					
3.Assumed 6.Cash 9.Unknown			<b>Fract. Acre</b>		<b>Acreage/Sites</b>			
Validity <b>3 Distressed Sale</b>			21.Homesite (Frac	24		1.00	100 %	0
1.Valid 4.Split 7.Changes			22.Baselot (Frac	28		18.90	100 %	0
2.Related 5.Partial 8.Other			23.Misc (Fract)	31		6.00	100 %	0
3.Distress 6.Exempt 9.			<b>Acres</b>					
Verified <b>5 Public Record</b>			24.Homesite					
1.Buyer 4.Agent 7.Family			25.Baselot					
2.Seller 5.Pub Rec 8.Other			26.Secondary					
3.Lender 6.MLS 9.			27.Frontage					
			28.Rear Land (All					
			31.Tillable					
			<b>Total Acreage</b>		<b>25.90</b>			

- 1.Unimproved
- 2.Condition
- 3.Topography
- 4.Size/Shape
- 5.Access
- 6.Restricted
- 7.Corner Infl
- 8.Environment
- 9.Fract Share
- Acres**
- 32.Farmland Tilla
- 33.C R P
- 34.Softwood-Farm
- 35.Mixed Wood-Far
- 36.Hardwood-Farm
- 37.Softwood-TG
- 38.Mixed Wood-TG
- 39.Hardwood-TG
- 40.Wasteland
- 41.Gravel Pit
- 42.Mobile Home Si
- 43.Excess Indust
- 44.Lot Improvemen
- 45.Tower Site
- 46.Miscellaneous
- 47.Pavement
- 48.Farmland Pastu

