



**Easton**

Map Lot 006-011

Account 77

Location CURTIS ROAD

Card 1 Of 1 9/27/2018

Building Style	SF Bsmt Living	Layout
1.Conv. 5.Garrison 9.Gambrel	Fin Bsmt Grade	1.Typical 4. 7.
2.Ranch 6.Split 10.Saltbox	OPEN-5-CUSTOMIZE	2.Inadeq 5. 8.
3.R Ranch 7.Contemp 11.Other	Heat Type <b>100%</b>	3.Horrid 6. 9.
4.Cape 8.Log 12.	1.HWBB/Rad 5.FWA 9.No Heat	Attic
Dwelling Units	2.HWCI 6.GravWA 10.	1.1/4 Fin 4.Full Fin 7.
Other Units	3.H Pump 7.Electric 11.	2.1/2 Fin 5.F/Stair 8.
Stories	4.Steam 8.F/Wall 12.	3.3/4 Fin 6. 9.None
1.1 4.1.5 7.	Cool Type <b>0%</b>	Insulation
2.2 5.1.75 8.	1.Refrig 4.W&C Air 7.	1.Full 4.Minimal 7.
3.3 6.2.5 9.	2.Evapor 5. 8.	2.Heavy 5.Partial 8.
Exterior Walls	3.H Pump 6. 9.None	3.Capped 6. 9.None
1.Wood 5.Stucco 9.Other	Kitchen Style	Unfinished %
2.Vin/Al 6.Brick 10.	1.Modern 4.Obsolete 7.	Grade & Factor
3.Compos. 7.Stone 11.	2.Typical 5. 8.	1.E Grade 4.B Grade 7.
4.Asbestos 8.Concrete 12.	3.Old Type 6. 9.None	2.D Grade 5.A Grade 8.SC Grade
Roof Surface	Bath(s) Style	3.C Grade 6.AA Grade 9.Same
1.Asphalt 4.Composit 7.	1.Modern 4.Obsolete 7.	SQFT (Footprint)
2.Slate 5.Wood 8.	2.Typical 5. 8.	Condition
3.Metal 6.Other 9.	3.Old Type 6. 9.None	1.Poor 4.Avg 7.V G
SF Masonry Trim	# Rooms	2.Fair 5.Avg+ 8.Exc
OPEN-3-CUSTOM	# Bedrooms	3.Avg- 6.Good 9.Same
OPEN-4-CUSTOM	# Full Baths	Phys. % Good
Year Built	# Half Baths	Funct. % Good
Year Remodeled	# Addn Fixtures	Functional Code
Foundation	# Fireplaces	1.Incomp 4.Bsmt 7.
1.Concrete 4.Wood 7.		2.O-Built 5. 8.LongTerm
2.C Block 5.Slab 8.		3.Damage 6.L-T Vaca 9.None
3.Br/Stone 6.Piers 9.		Econ. % Good
Basement		Economic Code
1.1/4 Bmt 4.Full Bmt 7.		0.None 3.No Power 7.
2.1/2 Bmt 5.None 8.		1.Location 4.Generate 8.
3.3/4 Bmt 6. 9.None		2.Encroach 9.None 9.
Bsmt Gar # Cars		Entrance Code <b>0</b>
Wet Basement		1.Interior 4.Vacant 7.
1.Dry 4. 7.		2.Refusal 5.Estimate 8.
2.Damp 5. 8.	3.Informed 6.Reviewed 9.	
3.Wet 6. 9.	Information Code <b>0</b>	
Date Inspected	1.Owner 4.Agent 7.	
	2.Relative 5.Estimate 8.	
	3.Tenant 6.Exterior 9.	

Additions, Outbuildings & Improvements								1.One Story Fram
Type	Year	Units	Grade	Cond	Phys.	Funct.	Sound Value	2.Two Story Fram
					%	%		3.Three Story Fr
					%	%		4.1 & 1/2 Story
					%	%		5.1 & 3/4 Story
					%	%		6.2 & 1/2 Story
					%	%		21.Open Frame Por
					%	%		22.Encl Frame Por
					%	%		23.Frame Garage
					%	%		24.Frame Shed
					%	%		25.Frame Bay Wind
					%	%		26.1SFr Overhang
					%	%		27.Unfin Basement
					%	%		28.Unfinished Att
					%	%		29.Finished Attic

ALLEN, LORIS WINGER  
ALLEN, MICHAEL B  
62 CURTIS RD  
EASTON ME 04740

B1731P63

Inspection Witnessed By:

No./Date	Description	Date Insp.
X		

Notes:  
Garage -5% for partial attached

Easton

Property Data			Assessment Record						
Neighborhood <b>1 Resident/Agric.</b>			Year	Land	Buildings	Exempt	Total		
Tree Growth Year <b>0</b>			2010	5,100	28,900	6,050	27,950		
Recertified Date <b>0</b>			2011	5,100	28,800	6,050	27,850		
Y Coordinate <b>0</b>			2012	5,100	28,400	5,940	27,560		
Zone/Land Use <b>11 Residential</b>			2013	5,100	28,000	6,160	26,940		
Secondary Zone			2014	5,100	27,900	6,160	26,840		
Topography <b>1 Level 2 Rolling</b>			2015	15,400	43,700	10,000	49,100		
1.Level 4.Below St 7.			2016	15,400	43,700	15,000	44,100		
2.Rolling 5.Low 8.			2017	15,400	43,700	20,000	39,100		
3.Above St 6.Swampy 9.			2018	15,400	43,700	20,000	39,100		
Utilities <b>4 Drilled Well 6 Septic System</b>									
1.Public 4.Dr Well 7.Cesspool									
2.Water 5.Dug Well 8.									
3.Sewer 6.Septic 9.None									
Street <b>1 Paved</b>									
1.Paved 4.Proposed 7.									
2.Semi Imp 5.R/W 8.									
3.Gravel 6. 9.None									
FLOOD PLAIN <b>0</b>									
CLASS <b>1</b>									
Sale Data									
Sale Date			11.Regular Lot						
Price			12.Delta Triangle						
Sale Type			13.Nabla Triangle						
1.Land 4.Mobile 7.			14.Rear Land						
2.L & B 5.Other 8.			15.Miscellaneous						
3.Building 6. 9.									
Financing			<b>Square Foot</b>						
1.Convent 4.Seller 7.			16.Regular Lot						
2.FHA/VA 5.Private 8.			17.Class I Road						
3.Assumed 6.Cash 9.Unknown			18.Class II Road						
Validity			19.Condominium						
1.Valid 4.Split 7.Changes			20.Sound Value						
2.Related 5.Partial 8.Other									
3.Distress 6.Exempt 9.									
Verified			<b>Fract. Acre</b>						
1.Buyer 4.Agent 7.Family			21.Homesite (Fract)						
2.Seller 5.Pub Rec 8.Other			22.Baselot (Fract)						
3.Lender 6.MLS 9.			23.Misc (Fract)						
			<b>Acres</b>						
			24.Homesite						
			25.Baselot						
			26.Secondary						
			27.Frontage						
			28.Rear Land (All						
			31.Tillable						
			<b>Land Data</b>						
			<b>Front Foot</b>	<b>Type</b>	<b>Effective</b>		<b>Influence</b>		<b>Influence Codes</b>
					<b>Frontage</b>	<b>Depth</b>	<b>Factor</b>	<b>Code</b>	
							%		1.Unimproved
							%		2.Condition
							%		3.Topography
							%		4.Size/Shape
							%		5.Access
							%		6.Restricted
							%		7.Corner Infl
							%		8.Environment
							%		9.Fract Share
							%		<b>Acres</b>
							%		32.Farmland Tilla
							%		33.C R P
							%		34.Softwood-Farm
							%		35.Mixed Wood-Far
							%		36.Hardwood-Farm
							%		37.Softwood-TG
							%		38.Mixed Wood-TG
							%		39.Hardwood-TG
							%		40.Wasteland
							%		41.Gravel Pit
							%		42.Mobile Home Si
							%		43.Excess Indust
							%		44.Lot Improvemen
							%		45.Tower Site
							%		46.Miscellaneous
							%		47.Pavement
							%		48.Farmland Pastu
					<b>Total Acreage</b>		0.29		





**Easton**

Map Lot 006-012

Account 87

Location CURTIS ROAD

Card 1 Of 1 9/27/2018

Building Style	SF Bsmt Living	Layout
1.Conv. 5.Garrison 9.Gambrel	Fin Bsmt Grade	1.Typical 4. 7.
2.Ranch 6.Split 10.Saltbox	OPEN-5-CUSTOMIZE	2.Inadeq 5. 8.
3.R Ranch 7.Contemp 11.Other	Heat Type <b>100%</b>	3.Horrid 6. 9.
4.Cape 8.Log 12.	1.HWBB/Rad 5.FWA 9.No Heat	Attic
Dwelling Units	2.HWCI 6.GravWA 10.	1.1/4 Fin 4.Full Fin 7.
Other Units	3.H Pump 7.Electric 11.	2.1/2 Fin 5.F/Stair 8.
Stories	4.Steam 8.F/Wall 12.	3.3/4 Fin 6. 9.None
1.1 4.1.5 7.	Cool Type <b>0%</b>	Insulation
2.2 5.1.75 8.	1.Refrig 4.W&C Air 7.	1.Full 4.Minimal 7.
3.3 6.2.5 9.	2.Evapor 5. 8.	2.Heavy 5.Partial 8.
Exterior Walls	3.H Pump 6. 9.None	3.Capped 6. 9.None
1.Wood 5.Stucco 9.Other	Kitchen Style	Unfinished %
2.Vin/Al 6.Brick 10.	1.Modern 4.Obsolete 7.	Grade & Factor
3.Compos. 7.Stone 11.	2.Typical 5. 8.	1.E Grade 4.B Grade 7.
4.Asbestos 8.Concrete 12.	3.Old Type 6. 9.None	2.D Grade 5.A Grade 8.SC Grade
Roof Surface	Bath(s) Style	3.C Grade 6.AA Grade 9.Same
1.Asphalt 4.Composit 7.	1.Modern 4.Obsolete 7.	SQFT (Footprint)
2.Slate 5.Wood 8.	2.Typical 5. 8.	Condition
3.Metal 6.Other 9.	3.Old Type 6. 9.None	1.Poor 4.Avg 7.V G
SF Masonry Trim	# Rooms	2.Fair 5.Avg+ 8.Exc
OPEN-3-CUSTOM	# Bedrooms	3.Avg- 6.Good 9.Same
OPEN-4-CUSTOM	# Full Baths	Phys. % Good
Year Built	# Half Baths	Funct. % Good
Year Remodeled	# Addn Fixtures	Functional Code
Foundation	# Fireplaces	1.Incomp 4.Bsmt 7.
1.Concrete 4.Wood 7.		2.O-Built 5. 8.LongTerm
2.C Block 5.Slab 8.		3.Damage 6.L-T Vaca 9.None
3.Br/Stone 6.Piers 9.		Econ. % Good
Basement		Economic Code
1.1/4 Bmt 4.Full Bmt 7.		0.None 3.No Power 7.
2.1/2 Bmt 5.None 8.		1.Location 4.Generate 8.
3.3/4 Bmt 6. 9.None		2.Encroach 9.None 9.
Bsmt Gar # Cars		Entrance Code <b>0</b>
Wet Basement		1.Interior 4.Vacant 7.
1.Dry 4. 7.		2.Refusal 5.Estimate 8.
2.Damp 5. 8.	3.Informed 6.Reviewed 9.	
3.Wet 6. 9.	Information Code <b>0</b>	
Date Inspected	1.Owner 4.Agent 7.	
	2.Relative 5.Estimate 8.	
	3.Tenant 6.Exterior 9.	

Additions, Outbuildings & Improvements								1.One Story Fram
Type	Year	Units	Grade	Cond	Phys.	Funct.	Sound Value	2.Two Story Fram
					%	%		3.Three Story Fr
					%	%		4.1 & 1/2 Story
					%	%		5.1 & 3/4 Story
					%	%		6.2 & 1/2 Story
					%	%		21.Open Frame Por
					%	%		22.Encl Frame Por
					%	%		23.Frame Garage
					%	%		24.Frame Shed
					%	%		25.Frame Bay Wind
					%	%		26.1SFr Overhang
					%	%		27.Unfin Basement
					%	%		28.Unfinished Att
					%	%		29.Finished Attic













**Easton**

Map Lot 006-013

Account 81

Location CURTIS ROAD

Card 1 Of 1 9/27/2018

Building Style	SF Bsmt Living	Layout
1.Conv. 5.Garrison 9.Gambrel	Fin Bsmt Grade	1.Typical 4. 7.
2.Ranch 6.Split 10.Saltbox	OPEN-5-CUSTOMIZE	2.Inadeq 5. 8.
3.R Ranch 7.Contemp 11.Other	Heat Type <b>100%</b>	3.Horrid 6. 9.
4.Cape 8.Log 12.	1.HWBB/Rad 5.FWA 9.No Heat	Attic
Dwelling Units	2.HWCI 6.GravWA 10.	1.1/4 Fin 4.Full Fin 7.
Other Units	3.H Pump 7.Electric 11.	2.1/2 Fin 5.F/Stair 8.
Stories	4.Steam 8.F/Wall 12.	3.3/4 Fin 6. 9.None
1.1 4.1.5 7.	Cool Type <b>100%</b>	Insulation
2.2 5.1.75 8.	1.Refrig 4.W&C Air 7.	1.Full 4.Minimal 7.
3.3 6.2.5 9.	2.Evapor 5. 8.	2.Heavy 5.Partial 8.
Exterior Walls	3.H Pump 6. 9.None	3.Capped 6. 9.None
1.Wood 5.Stucco 9.Other	Kitchen Style	Unfinished %
2.Vin/Al 6.Brick 10.	1.Modern 4.Obsolete 7.	Grade & Factor
3.Compos. 7.Stone 11.	2.Typical 5. 8.	1.E Grade 4.B Grade 7.
4.Asbestos 8.Concrete 12.	3.Old Type 6. 9.None	2.D Grade 5.A Grade 8.SC Grade
Roof Surface	Bath(s) Style	3.C Grade 6.AA Grade 9.Same
1.Asphalt 4.Composit 7.	1.Modern 4.Obsolete 7.	SQFT (Footprint)
2.Slate 5.Wood 8.	2.Typical 5. 8.	Condition
3.Metal 6.Other 9.	3.Old Type 6. 9.None	1.Poor 4.Avg 7.V G
SF Masonry Trim	# Rooms	2.Fair 5.Avg+ 8.Exc
OPEN-3-CUSTOM	# Bedrooms	3.Avg- 6.Good 9.Same
OPEN-4-CUSTOM	# Full Baths	Phys. % Good
Year Built	# Half Baths	Funct. % Good
Year Remodeled	# Addn Fixtures	Functional Code
Foundation	# Fireplaces	1.Incomp 4.Bsmt 7.
1.Concrete 4.Wood 7.		2.O-Built 5. 8.LongTerm
2.C Block 5.Slab 8.		3.Damage 6.L-T Vaca 9.None
3.Br/Stone 6.Piers 9.		Econ. % Good
Basement		Economic Code
1.1/4 Bmt 4.Full Bmt 7.		0.None 3.No Power 7.
2.1/2 Bmt 5.None 8.		1.Location 4.Generate 8.
3.3/4 Bmt 6. 9.None		2.Encroach 9.None 9.
Bsmt Gar # Cars		Entrance Code <b>0</b>
Wet Basement		1.Interior 4.Vacant 7.
1.Dry 4. 7.		2.Refusal 5.Estimate 8.
2.Damp 5. 8.	3.Informed 6.Reviewed 9.	
3.Wet 6. 9.	Information Code <b>0</b>	
	1.Owner 4.Agent 7.	
	2.Relative 5.Estimate 8.	
	3.Tenant 6.Exterior 9.	

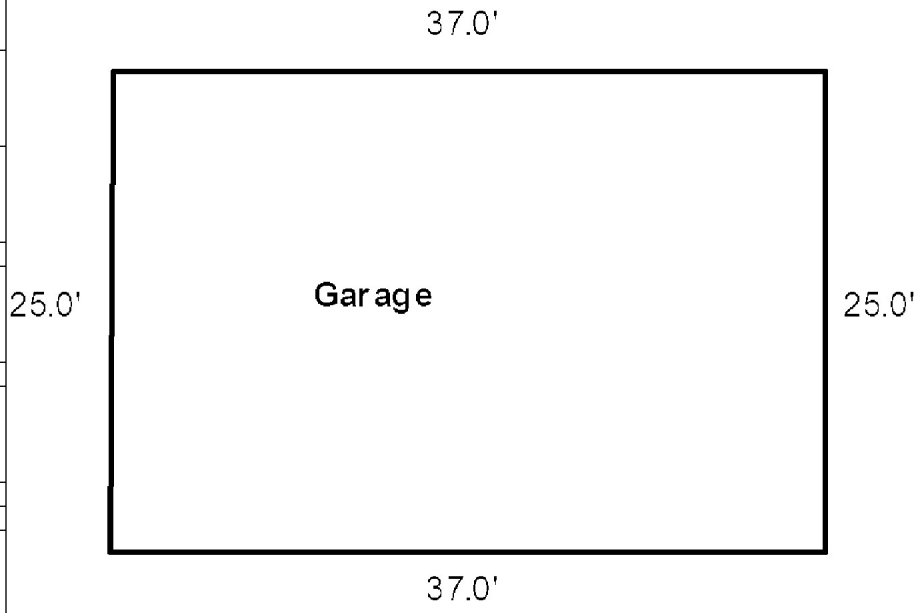

Date Inspected

**Additions, Outbuildings & Improvements**

Type	Year	Units	Grade	Cond	Phys.	Funct.	Sound Value
23 Frame Garage	1940	925	1 100	4	0 %	100 %	
					%	%	
					%	%	
					%	%	
					%	%	
					%	%	
					%	%	
					%	%	
					%	%	
					%	%	
					%	%	
					%	%	

- 1.One Story Fram
- 2.Two Story Fram
- 3.Three Story Fr
- 4.1 & 1/2 Story
- 5.1 & 3/4 Story
- 6.2 & 1/2 Story
- 21.Open Frame Por
- 22.Encl Frame Por
- 23.Frame Garage
- 24.Frame Shed
- 25.Frame Bay Wind
- 26.1SFr Overhang
- 27.Unfin Basement
- 28.Unfinished Att
- 29.Finished Attic

SUNNY SIDE LAND HOLDINGS LLC  
C/O MARK RICHARDSON  
1 CURTIS ROAD  
EASTON ME 04740

B4975P342

Previous Owner  
WALTON, ADAM R  
90 HOULTON ROAD

PRESQUE ISLE ME 04769  
Sale Date: 11/01/2011

Previous Owner  
MACDOUGAL, RODNEY L II  
PO BOX 1761

PRESQUE ISLE ME 04769  
Sale Date: 12/05/2006

Previous Owner  
MACDOUGAL, RODNEY

PO BOX 862  
VASSELBORO ME 04572  
Sale Date: 8/30/2006

Inspection Witnessed By:

X Date

No./Date	Description	Date Insp.

Notes:

Easton

Property Data			Assessment Record						
Neighborhood <b>1 Resident/Agric.</b>			Year	Land	Buildings	Exempt	Total		
Tree Growth Year <b>0</b>			2010	6,600	0	0	6,600		
Recertified Date <b>0</b>			2011	6,600	0	0	6,600		
Y Coordinate <b>0</b>			2012	6,600	0	0	6,600		
Zone/Land Use <b>11 Residential</b>			2013	6,600	0	0	6,600		
Secondary Zone			2014	6,600	5,100	0	11,700		
Topography <b>1 Level 2 Rolling</b>			2015	17,100	3,200	0	20,300		
1.Level 4.Below St 7.			2016	17,100	3,200	0	20,300		
2.Rolling 5.Low 8.			2017	17,100	7,400	0	24,500		
3.Above St 6.Swampy 9.			2018	17,100	7,400	0	24,500		
Utilities <b>4 Drilled Well 6 Septic System</b>									
1.Public 4.Dr Well 7.Cesspool									
2.Water 5.Dug Well 8.									
3.Sewer 6.Septic 9.None									
Street <b>1 Paved</b>									
1.Paved 4.Proposed 7.									
2.Semi Imp 5.R/W 8.									
3.Gravel 6. 9.None									
FLOOD PLAIN <b>0</b>			<b>Land Data</b>						
CLASS <b>9</b>			<b>Front Foot</b>	<b>Type</b>	<b>Effective</b>		<b>Influence</b>		<b>Influence Codes</b>
Sale Date <b>12/05/2006</b>					Frontage	Depth	Factor	Code	
Price <b>15,000</b>			11.Regular Lot					1.Unimproved	
Sale Type <b>1 Land Only</b>			12.Delta Triangle					2.Condition	
1.Land 4.Mobile 7.			13.Nabla Triangle					3.Topography	
2.L & B 5.Other 8.			14.Rear Land					4.Size/Shape	
3.Building 6. 9.			15.Miscellaneous					5.Access	
Financing <b>9 Unknown</b>								6.Restricted	
1.Convent 4.Seller 7.			<b>Square Foot</b>	<b>Square Feet</b>				7.Corner Infl	
2.FHA/VA 5.Private 8.								8.Environment	
3.Assumed 6.Cash 9.Unknown			16.Regular Lot					9.Fract Share	
Validity <b>1 Arms Length Sale</b>			17.Class I Road					<b>Acres</b>	
1.Valid 4.Split 7.Changes			18.Class II Road					32.Farmland Tilla	
2.Related 5.Partial 8.Other			19.Condominium					33.C R P	
3.Distress 6.Exempt 9.			20.Sound Value					34.Softwood-Farm	
Verified <b>5 Public Record</b>			<b>Fract. Acre</b>	<b>Acres/Sites</b>				35.Mixed Wood-Far	
1.Buyer 4.Agent 7.Family				24	1.00	100	%	0	36.Hardwood-Farm
2.Seller 5.Pub Rec 8.Other			22.Baslot (Fract)	28	0.22	100	%	0	37.Softwood-TG
3.Lender 6.MLS 9.			23.Misc (Fract)	44	1.00	100	%	0	38.Mixed Wood-TG
			<b>Acres</b>						39.Hardwood-TG
			24.Homesite						40.Wasteland
			25.Baslot						41.Gravel Pit
			26.Secondary						42.Mobile Home Si
			27.Frontage						43.Excess Indust
			28.Rear Land (All	<b>Total Acreage 1.22</b>					44.Lot Improvemen
			31.Tillable						
									46.Miscellaneous
									47.Pavement
									48.Farmland Pastu

Easton

Map Lot 006-013-A

Account 477

Location CURTIS ROAD

Card 1 Of 1 9/27/2018

Building Style 0	SF Bsmt Living 0	Layout 0
1.Conv. 5.Garrison 9.Gambrel	Fin Bsmt Grade 0 0	1.Typical 4. 7.
2.Ranch 6.Split 10.Saltbox	OPEN-5-CUSTOMIZE 0	2.Inadeq 5. 8.
3.R Ranch 7.Contemp 11.Other	Heat Type 100% 0	3.Horrid 6. 9.
4.Cape 8.Log 12.	1.HWBB/Rad 5.FWA 9.No Heat	Attic 0
Dwelling Units 0	2.HWCI 6.GravWA 10.	1.1/4 Fin 4.Full Fin 7.
Other Units 0	3.H Pump 7.Electric 11.	2.1/2 Fin 5.F/Stair 8.
Stories 0	4.Steam 8.F/Wall 12.	3.3/4 Fin 6. 9.None
1.1 4.1.5 7.	Cool Type 0% 9 None	Insulation 0
2.2 5.1.75 8.	1.Refrig 4.W&C Air 7.	1.Full 4.Minimal 7.
3.3 6.2.5 9.	2.Evapor 5. 8.	2.Heavy 5.Partial 8.
Exterior Walls 0	3.H Pump 6. 9.None	3.Capped 6. 9.None
1.Wood 5.Stucco 9.Other	Kitchen Style 0	Unfinished % 0%
2.Vin/Al 6.Brick 10.	1.Modern 4.Obsolete 7.	Grade & Factor 0 0%
3.Compos. 7.Stone 11.	2.Typical 5. 8.	1.E Grade 4.B Grade 7.
4.Asbestos 8.Concrete 12.	3.Old Type 6. 9.None	2.D Grade 5.A Grade 8.SC Grade
Roof Surface 0	Bath(s) Style 0	3.C Grade 6.AA Grade 9.Same
1.Asphalt 4.Composit 7.	1.Modern 4.Obsolete 7.	SQFT (Footprint) 0
2.Slate 5.Wood 8.	2.Typical 5. 8.	Condition 0
3.Metal 6.Other 9.	3.Old Type 6. 9.None	1.Poor 4.Avg 7.V G
SF Masonry Trim 0	# Rooms 0	2.Fair 5.Avg+ 8.Exc
OPEN-3-CUSTOM 0	# Bedrooms 0	3.Avg- 6.Good 9.Same
OPEN-4-CUSTOM 0	# Full Baths 0	Phys. % Good 0%
Year Built 0	# Half Baths 0	Funct. % Good 100%
Year Remodeled 0	# Addn Fixtures 0	Functional Code 9 None
Foundation 0	# Fireplaces 0	1.Incomp 4.Bsmt 7.
1.Concrete 4.Wood 7.	 <p><b>TRIO</b> Software A Division of Harris Computer Systems</p>	2.O-Built 5. 8.LongTerm
2.C Block 5.Slab 8.		3.Damage 6.L-T Vaca 9.None
3.Br/Stone 6.Piers 9.		Econ. % Good 100%
Basement 0		Economic Code None
1.1/4 Bmt 4.Full Bmt 7.		0.None 3.No Power 7.
2.1/2 Bmt 5.None 8.		1.Location 4.Generate 8.
3.3/4 Bmt 6. 9.None		2.Encroach 9.None 9.
Bsmt Gar # Cars 0		Entrance Code 3 Information Only
Wet Basement 0		1.Interior 4.Vacant 7.
1.Dry 4. 7.		2.Refusal 5.Estimate 8.
2.Damp 5. 8.	3.Informed 6.Reviewed 9.	
3.Wet 6. 9.	Information Code 3 Tenant	
	1.Owner 4.Agent 7.	
	2.Relative 5.Estimate 8.	
	3.Tenant 6.Exterior 9.	

Date Inspected 6/29/2015

**Additions, Outbuildings & Improvements**

Type	Year	Units	Grade	Cond	Phys.	Funct.	Sound Value	
998 14Mobile Home	0	14x66	3 100	3	0 %	100 %		1.One Story Fram
24 Frame Shed	2016	192	3 100	4	0 %	100 %		2.Two Story Fram
					%	%		3.Three Story Fr
					%	%		4.1 & 1/2 Story
					%	%		5.1 & 3/4 Story
					%	%		6.2 & 1/2 Story
					%	%		21.Open Frame Por
					%	%		22.Encl Frame Por
					%	%		23.Frame Garage
					%	%		24.Frame Shed
					%	%		25.Frame Bay Wind
					%	%		26.1SFr Overhang
					%	%		27.Unfin Basement
					%	%		28.Unfinished Att
					%	%		29.Finished Attic

Shed  
16.0'  
12.0'

? Year - Mobile Home  
66.0'  
14.0'



HALVORSON, CHARLES A  
HALVORSON, TRACI A JT  
374 LADNER RD  
EASTON ME 04740

B3666P339

Inspection Witnessed By:

X Date

No./Date	Description	Date Insp.

Notes:

SALE FOR \$48,000. 5/28/2002 INCLUDED MAP 6 LOTS 14 & 15

\*Owner refused entry, told assessor that there has been no change to the interior

Easton

Property Data			Assessment Record						
Neighborhood <b>1 Resident/Agric.</b>			Year	Land	Buildings	Exempt	Total		
Tree Growth Year <b>0</b>			2010	38,100	105,500	6,050	137,550		
Recertified Date <b>0</b>			2011	38,100	104,300	6,050	136,350		
Y Coordinate <b>0</b>			2012	38,100	103,200	5,940	135,360		
Zone/Land Use <b>11 Residential</b>			2013	38,100	103,200	6,160	135,140		
Secondary Zone			2014	38,100	102,000	6,160	133,940		
Topography <b>2 Rolling</b>			2015	87,500	168,600	10,000	246,100		
1.Level 4.Below St 7.			2016	87,500	168,600	15,000	241,100		
2.Rolling 5.Low 8.			2017	87,500	168,600	20,000	236,100		
3.Above St 6.Swampy 9.			2018	87,500	168,600	20,000	236,100		
Utilities <b>4 Drilled Well 6 Septic System</b>									
1.Public 4.Dr Well 7.Cesspool									
2.Water 5.Dug Well 8.									
3.Sewer 6.Septic 9.None									
Street <b>1 Paved</b>									
1.Paved 4.Proposed 7.									
2.Semi Imp 5.R/W 8.									
3.Gravel 6. 9.None									
FLOOD PLAIN <b>0</b>			<b>Land Data</b>						
CLASS <b>1</b>			<b>Front Foot</b>	<b>Type</b>	<b>Effective</b>		<b>Influence</b>		
<b>Sale Data</b>			11.Regular Lot		<b>Frontage</b>	<b>Depth</b>	<b>Factor</b>	<b>Code</b>	
Sale Date <b>5/01/2002</b>			12.Delta Triangle					1.Unimproved	
Price <b>48,000</b>			13.Nabla Triangle					2.Condition	
Sale Type <b>1 Land Only</b>			14.Rear Land					3.Topography	
1.Land 4.Mobile 7.			15.Miscellaneous					4.Size/Shape	
2.L & B 5.Other 8.								5.Access	
3.Building 6. 9.								6.Restricted	
Financing <b>9 Unknown</b>								7.Corner Infl	
1.Convent 4.Seller 7.			<b>Square Foot</b>	<b>Square Feet</b>				8.Environment	
2.FHA/VA 5.Private 8.			16.Regular Lot	47	800	100	%	0	9.Fract Share
3.Assumed 6.Cash 9.Unknown			17.Class I Road						<b>Acres</b>
Validity <b>4 Split/Assemlage</b>			18.Class II Road						32.Farmland Tilla
1.Valid 4.Split 7.Changes			19.Condominium						33.C R P
2.Related 5.Partial 8.Other			20.Sound Value						34.Softwood-Farm
3.Distress 6.Exempt 9.									35.Mixed Wood-Far
Verified <b>5 Public Record</b>			<b>Fract. Acre</b>	<b>Acreege/Sites</b>					36.Hardwood-Farm
1.Buyer 4.Agent 7.Family			21.Homesite (Frac	24	1.00	100	%	0	37.Softwood-TG
2.Seller 5.Pub Rec 8.Other			22.Baslot (Fract	28	61.00	100	%	0	38.Mixed Wood-TG
3.Lender 6.MLS 9.			23.Misc (Fract)	31	38.00	100	%	0	39.Hardwood-TG
			<b>Acres</b>	44	1.00	100	%	0	40.Wasteland
			24.Homesite						41.Gravel Pit
			25.Baslot						42.Mobile Home Si
			26.Secondary						43.Excess Indust
			27.Frontage						44.Lot Improvemen
			28.Rear Land (All						45.Tower Site
			31.Tillable						46.Miscellaneous
			<b>Total Acreage</b>		100.00				47.Pavement
									48.Farmland Pastu

**Easton**

Map Lot 006-014

Account 956

Location 374 LADNER RD

Card 1

Of 1

9/27/2018

Building Style <b>7 Contemporary</b>	SF Bsmt Living <b>0</b>	Layout <b>1 Typical</b>
1.Conv. 5.Garrison 9.Gambrel	Fin Bsmt Grade <b>0 0</b>	1.Typical 4. 7.
2.Ranch 6.Split 10.Saltbox	OPEN-5-CUSTOMIZE <b>0</b>	2.Inadeq 5. 8.
3.R Ranch 7.Contemp 11.Other	Heat Type <b>100%</b> <b>1 Hot Water BB/Radiant</b>	3.Horrid 6. 9.
4.Cape 8.Log 12.	1.HWBB/Rad 5.FWA 9.No Heat	Attic <b>9 None</b>
Dwelling Units <b>1</b>	2.HWCI 6.GravWA 10.	1.1/4 Fin 4.Full Fin 7.
Other Units <b>0</b>	3.H Pump 7.Electric 11.	2.1/2 Fin 5.FI/Stair 8.
Stories <b>4 One &amp; 1/2 Story</b>	4.Steam 8.FI/Wall 12.	3.3/4 Fin 6. 9.None
1.1 4.1.5 7.	Cool Type <b>0%</b> <b>9 None</b>	Insulation <b>1 Full</b>
2.2 5.1.75 8.	1.Refrig 4.W&C Air 7.	1.Full 4.Minimal 7.
3.3 6.2.5 9.	2.Evapor 5. 8.	2.Heavy 5.Partial 8.
Exterior Walls <b>1 Wood Siding</b>	3.H Pump 6. 9.None	3.Capped 6. 9.None
1.Wood 5.Stucco 9.Other	Kitchen Style <b>2 Typical</b>	Unfinished % <b>0%</b>
2.Vin/Al 6.Brick 10.	1.Modern 4.Obsolete 7.	Grade & Factor <b>4 Good 110%</b>
3.Compos. 7.Stone 11.	2.Typical 5. 8.	1.E Grade 4.B Grade 7.
4.Asbestos 8.Concrete 12.	3.Old Type 6. 9.None	2.D Grade 5.A Grade 8.SC Grade
Roof Surface <b>1 Asphalt Shingles</b>	Bath(s) Style <b>2 Typical Bath(s)</b>	3.C Grade 6.AA Grade 9.Same
1.Asphalt 4.Composit 7.	1.Modern 4.Obsolete 7.	SQFT (Footprint) <b>1313</b>
2.Slate 5.Wood 8.	2.Typical 5. 8.	Condition <b>4 Average</b>
3.Metal 6.Other 9.	3.Old Type 6. 9.None	1.Poor 4.Avg 7.V G
SF Masonry Trim <b>0</b>	# Rooms <b>7</b>	2.Fair 5.Avg+ 8.Exc
OPEN-3-CUSTOM <b>0</b>	# Bedrooms <b>4</b>	3.Avg- 6.Good 9.Same
OPEN-4-CUSTOM <b>0</b>	# Full Baths <b>2</b>	Phys. % Good <b>0%</b>
Year Built <b>2003</b>	# Half Baths <b>0</b>	Funct. % Good <b>100%</b>
Year Remodeled <b>0</b>	# Addn Fixtures <b>2</b>	Functional Code <b>9 None</b>
Foundation <b>5 Concrete Slab</b>	# Fireplaces <b>1</b>	1.Incomp 4.Bsmt 7.
1.Concrete 4.Wood 7.		2.O-Built 5. 8.LongTerm
2.C Block 5.Slab 8.		3.Damage 6.L-T Vaca 9.None
3.Br/Stone 6.Piers 9.		Econ. % Good <b>100%</b>
Basement <b>9 No Basement</b>		Economic Code <b>None</b>
1.1/4 Bmt 4.Full Bmt 7.		0.None 3.No Power 7.
2.1/2 Bmt 5.None 8.		1.Location 4.Generate 8.
3.3/4 Bmt 6. 9.None		2.Encroach 9.None 9.
Bsmt Gar # Cars <b>0</b>		Entrance Code <b>2 Refused Entry</b>
Wet Basement <b>9 No Basement</b>		1.Interior 4.Vacant 7.
1.Dry 4. 7.		2.Refusal 5.Estimate 8.
2.Damp 5. 8.		3.Informed 6.Reviewed 9.
3.Wet 6. 9.		Information Code <b>1 Owner</b>
		1.Owner 4.Agent 7.
		2.Relative 5.Estimate 8.
		3.Tenant 6.Exterior 9.

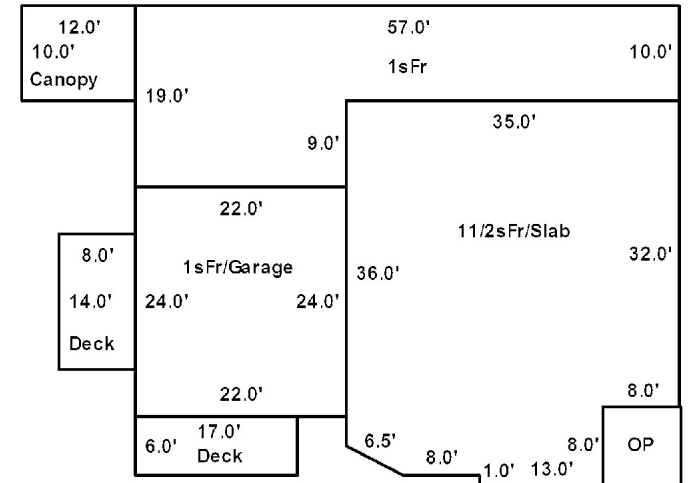
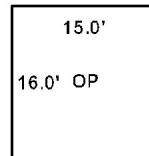

Date Inspected 7/03/2015

**Additions, Outbuildings & Improvements**

Type	Year	Units	Grade	Cond	Phys.	Funct.	Sound Value
1 One Story Frame	0	768	0 0	0	0 %	0 %	
75 1S-Ad/Gar	0	528	0 0	0	0 %	80 %	
21 Open Frame	0	64	0 0	0	0 %	0 %	
68 Wood Deck	0	102	0 0	0	0 %	0 %	
68 Wood Deck	0	112	0 0	0	0 %	0 %	
61 Canopy	0	120	0 0	0	0 %	0 %	
21 Open Frame	0	240	0 0	0	0 %	0 %	
					%	%	
					%	%	
					%	%	







**Easton**

Map Lot 006-015

Account 84

Location LADNER ROAD

Card 1 Of 1 9/27/2018

Building Style <b>0</b>	SF Bsmt Living <b>0</b>	Layout <b>0</b>
1.Conv. 5.Garrison 9.Gambrel	Fin Bsmt Grade <b>0 0</b>	1.Typical 4. 7.
2.Ranch 6.Split 10.Saltbox	OPEN-5-CUSTOMIZE <b>0</b>	2.Inadeq 5. 8.
3.R Ranch 7.Contemp 11.Other	Heat Type <b>100% 0</b>	3.Horrid 6. 9.
4.Cape 8.Log 12.	1.HWBB/Rad 5.FWA 9.No Heat	Attic <b>0</b>
Dwelling Units <b>0</b>	2.HWCI 6.GravWA 10.	1.1/4 Fin 4.Full Fin 7.
Other Units <b>0</b>	3.H Pump 7.Electric 11.	2.1/2 Fin 5.F/Stair 8.
Stories <b>0</b>	4.Steam 8.F/Wall 12.	3.3/4 Fin 6. 9.None
1.1 4.1.5 7.	Cool Type <b>0% 9 None</b>	Insulation <b>0</b>
2.2 5.1.75 8.	1.Refrig 4.W&C Air 7.	1.Full 4.Minimal 7.
3.3 6.2.5 9.	2.Evapor 5. 8.	2.Heavy 5.Partial 8.
Exterior Walls <b>0</b>	3.H Pump 6. 9.None	3.Capped 6. 9.None
1.Wood 5.Stucco 9.Other	Kitchen Style <b>0</b>	Unfinished % <b>0%</b>
2.Vin/Al 6.Brick 10.	1.Modern 4.Obsolete 7.	Grade & Factor <b>0 0%</b>
3.Compos. 7.Stone 11.	2.Typical 5. 8.	1.E Grade 4.B Grade 7.
4.Asbestos 8.Concrete 12.	3.Old Type 6. 9.None	2.D Grade 5.A Grade 8.SC Grade
Roof Surface <b>0</b>	Bath(s) Style <b>0</b>	3.C Grade 6.AA Grade 9.Same
1.Asphalt 4.Composit 7.	1.Modern 4.Obsolete 7.	SQFT (Footprint) <b>0</b>
2.Slate 5.Wood 8.	2.Typical 5. 8.	Condition <b>0</b>
3.Metal 6.Other 9.	3.Old Type 6. 9.None	1.Poor 4.Avg 7.V G
SF Masonry Trim <b>0</b>	# Rooms <b>0</b>	2.Fair 5.Avg+ 8.Exc
OPEN-3-CUSTOM <b>0</b>	# Bedrooms <b>0</b>	3.Avg- 6.Good 9.Same
OPEN-4-CUSTOM <b>0</b>	# Full Baths <b>0</b>	Phys. % Good <b>0%</b>
Year Built <b>0</b>	# Half Baths <b>0</b>	Funct. % Good <b>100%</b>
Year Remodeled <b>0</b>	# Addn Fixtures <b>0</b>	Functional Code <b>9 None</b>
Foundation <b>0</b>	# Fireplaces <b>0</b>	1.Incomp 4.Bsmt 7.
1.Concrete 4.Wood 7.		2.O-Built 5. 8.LongTerm
2.C Block 5.Slab 8.		3.Damage 6.L-T Vaca 9.None
3.Br/Stone 6.Piers 9.		Econ. % Good <b>100%</b>
Basement <b>0</b>		Economic Code <b>None</b>
1.1/4 Bmt 4.Full Bmt 7.		0.None 3.No Power 7.
2.1/2 Bmt 5.None 8.		1.Location 4.Generate 8.
3.3/4 Bmt 6. 9.None		2.Encroach 9.None 9.
Bsmt Gar # Cars <b>0</b>		Entrance Code <b>0</b>
Wet Basement <b>0</b>		1.Interior 4.Vacant 7.
1.Dry 4. 7.		2.Refusal 5.Estimate 8.
2.Damp 5. 8.	3.Informed 6.Reviewed 9.	
3.Wet 6. 9.	Information Code <b>0</b>	
	1.Owner 4.Agent 7.	
	2.Relative 5.Estimate 8.	
	3.Tenant 6.Exterior 9.	

Date Inspected

**Additions, Outbuildings & Improvements**

Type	Year	Units	Grade	Cond	Phys.	Funct.	Sound Value
					%	%	1.One Story Fram
					%	%	2.Two Story Fram
					%	%	3.Three Story Fr
					%	%	4.1 & 1/2 Story
					%	%	5.1 & 3/4 Story
					%	%	6.2 & 1/2 Story
					%	%	21.Open Frame Por
					%	%	22.Encl Frame Por
					%	%	23.Frame Garage
					%	%	24.Frame Shed
					%	%	25.Frame Bay Wind
					%	%	26.1SFr Overhang
					%	%	27.Unfin Basement
					%	%	28.Unfinished Att
					%	%	29.Finished Attic



**Easton**

Map Lot 006-016

Account 682

Location RIVER DE CHUTE ROAD

Card 1 Of 1 9/27/2018

Building Style <b>0</b>	SF Bsmt Living <b>0</b>	Layout <b>0</b>
1.Conv. 5.Garrison 9.Gambrel	Fin Bsmt Grade <b>0 0</b>	1.Typical 4. 7.
2.Ranch 6.Split 10.Saltbox	OPEN-5-CUSTOMIZE <b>0</b>	2.Inadeq 5. 8.
3.R Ranch 7.Contemp 11.Other	Heat Type <b>100% 0</b>	3.Horrid 6. 9.
4.Cape 8.Log 12.	1.HWBB/Rad 5.FWA 9.No Heat	Attic <b>0</b>
Dwelling Units <b>0</b>	2.HWCI 6.GravWA 10.	1.1/4 Fin 4.Full Fin 7.
Other Units <b>0</b>	3.H Pump 7.Electric 11.	2.1/2 Fin 5.FI/Stair 8.
Stories <b>0</b>	4.Steam 8.FI/Wall 12.	3.3/4 Fin 6. 9.None
1.1 4.1.5 7.	Cool Type <b>0% 9 None</b>	Insulation <b>0</b>
2.2 5.1.75 8.	1.Refrig 4.W&C Air 7.	1.Full 4.Minimal 7.
3.3 6.2.5 9.	2.Evapor 5. 8.	2.Heavy 5.Partial 8.
Exterior Walls <b>0</b>	3.H Pump 6. 9.None	3.Capped 6. 9.None
1.Wood 5.Stucco 9.Other	Kitchen Style <b>0</b>	Unfinished % <b>0%</b>
2.Vin/Al 6.Brick 10.	1.Modern 4.Obsolete 7.	Grade & Factor <b>0 0%</b>
3.Compos. 7.Stone 11.	2.Typical 5. 8.	1.E Grade 4.B Grade 7.
4.Asbestos 8.Concrete 12.	3.Old Type 6. 9.None	2.D Grade 5.A Grade 8.SC Grade
Roof Surface <b>0</b>	Bath(s) Style <b>0</b>	3.C Grade 6.AA Grade 9.Same
1.Asphalt 4.Composit 7.	1.Modern 4.Obsolete 7.	SQFT (Footprint) <b>0</b>
2.Slate 5.Wood 8.	2.Typical 5. 8.	Condition <b>0</b>
3.Metal 6.Other 9.	3.Old Type 6. 9.None	1.Poor 4.Avg 7.V G
SF Masonry Trim <b>0</b>	# Rooms <b>0</b>	2.Fair 5.Avg+ 8.Exc
OPEN-3-CUSTOM <b>0</b>	# Bedrooms <b>0</b>	3.Avg- 6.Good 9.Same
OPEN-4-CUSTOM <b>0</b>	# Full Baths <b>0</b>	Phys. % Good <b>0%</b>
Year Built <b>0</b>	# Half Baths <b>0</b>	Funct. % Good <b>100%</b>
Year Remodeled <b>0</b>	# Addn Fixtures <b>0</b>	Functional Code <b>9 None</b>
Foundation <b>0</b>	# Fireplaces <b>0</b>	1.Incomp 4.Bsmt 7.
1.Concrete 4.Wood 7.		2.O-Built 5. 8.LongTerm
2.C Block 5.Slab 8.		3.Damage 6.L-T Vaca 9.None
3.Br/Stone 6.Piers 9.		Econ. % Good <b>100%</b>
Basement <b>0</b>		Economic Code <b>None</b>
1.1/4 Bmt 4.Full Bmt 7.		0.None 3.No Power 7.
2.1/2 Bmt 5.None 8.		1.Location 4.Generate 8.
3.3/4 Bmt 6. 9.None		2.Encroach 9.None 9.
Bsmt Gar # Cars <b>0</b>		Entrance Code <b>0</b>
Wet Basement <b>0</b>		1.Interior 4.Vacant 7.
1.Dry 4. 7.		2.Refusal 5.Estimate 8.
2.Damp 5. 8.	3.Informed 6.Reviewed 9.	
3.Wet 6. 9.	Information Code <b>0</b>	
		1.Owner 4.Agent 7.
		2.Relative 5.Estimate 8.
		3.Tenant 6.Exterior 9.

Date Inspected

**Additions, Outbuildings & Improvements**

Type	Year	Units	Grade	Cond	Phys.	Funct.	Sound Value
					%	%	1.One Story Fram
					%	%	2.Two Story Fram
					%	%	3.Three Story Fr
					%	%	4.1 & 1/2 Story
					%	%	5.1 & 3/4 Story
					%	%	6.2 & 1/2 Story
					%	%	21.Open Frame Por
					%	%	22.Encl Frame Por
					%	%	23.Frame Garage
					%	%	24.Frame Shed
					%	%	25.Frame Bay Wind
					%	%	26.1SFr Overhang
					%	%	27.Unfin Basement
					%	%	28.Unfinished Att
					%	%	29.Finished Attic



**Easton**

Map Lot 006-016-A

Account 687

Location RIVER DE CHUTE ROAD

Card 1 Of 1 9/27/2018

Building Style	SF Bsmt Living	Layout
1.Conv. 5.Garrison 9.Gambrel	Fin Bsmt Grade	1.Typical 4. 7.
2.Ranch 6.Split 10.Saltbox	OPEN-5-CUSTOMIZE	2.Inadeq 5. 8.
3.R Ranch 7.Contemp 11.Other	Heat Type <b>100%</b>	3.Horrid 6. 9.
4.Cape 8.Log 12.	1.HWBB/Rad 5.FWA 9.No Heat	Attic
Dwelling Units	2.HWCI 6.GravWA 10.	1.1/4 Fin 4.Full Fin 7.
Other Units	3.H Pump 7.Electric 11.	2.1/2 Fin 5.F/Stair 8.
Stories	4.Steam 8.F/Wall 12.	3.3/4 Fin 6. 9.None
1.1 4.1.5 7.	Cool Type <b>0%</b>	Insulation
2.2 5.1.75 8.	1.Refrig 4.W&C Air 7.	1.Full 4.Minimal 7.
3.3 6.2.5 9.	2.Evapor 5. 8.	2.Heavy 5.Partial 8.
Exterior Walls	3.H Pump 6. 9.None	3.Capped 6. 9.None
1.Wood 5.Stucco 9.Other	Kitchen Style	Unfinished %
2.Vin/Al 6.Brick 10.	1.Modern 4.Obsolete 7.	Grade & Factor
3.Compos. 7.Stone 11.	2.Typical 5. 8.	1.E Grade 4.B Grade 7.
4.Asbestos 8.Concrete 12.	3.Old Type 6. 9.None	2.D Grade 5.A Grade 8.SC Grade
Roof Surface	Bath(s) Style	3.C Grade 6.AA Grade 9.Same
1.Asphalt 4.Composit 7.	1.Modern 4.Obsolete 7.	SQFT (Footprint)
2.Slate 5.Wood 8.	2.Typical 5. 8.	Condition
3.Metal 6.Other 9.	3.Old Type 6. 9.None	1.Poor 4.Avg 7.V G
SF Masonry Trim	# Rooms	2.Fair 5.Avg+ 8.Exc
OPEN-3-CUSTOM	# Bedrooms	3.Avg- 6.Good 9.Same
OPEN-4-CUSTOM	# Full Baths	Phys. % Good
Year Built	# Half Baths	Funct. % Good
Year Remodeled	# Addn Fixtures	Functional Code
Foundation	# Fireplaces	1.Incomp 4.Bsmt 7.
1.Concrete 4.Wood 7.		2.O-Built 5. 8.LongTerm
2.C Block 5.Slab 8.		3.Damage 6.L-T Vaca 9.None
3.Br/Stone 6.Piers 9.		Econ. % Good
Basement		Economic Code
1.1/4 Bmt 4.Full Bmt 7.		0.None 3.No Power 7.
2.1/2 Bmt 5.None 8.		1.Location 4.Generate 8.
3.3/4 Bmt 6. 9.None		2.Encroach 9.None 9.
Bsmt Gar # Cars		Entrance Code <b>0</b>
Wet Basement		1.Interior 4.Vacant 7.
1.Dry 4. 7.		2.Refusal 5.Estimate 8.
2.Damp 5. 8.	3.Informed 6.Reviewed 9.	
3.Wet 6. 9.	Information Code <b>0</b>	
Date Inspected	1.Owner 4.Agent 7.	
	2.Relative 5.Estimate 8.	
	3.Tenant 6.Exterior 9.	

Additions, Outbuildings & Improvements								1.One Story Fram
Type	Year	Units	Grade	Cond	Phys.	Funct.	Sound Value	2.Two Story Fram
					%	%		3.Three Story Fr
					%	%		4.1 & 1/2 Story
					%	%		5.1 & 3/4 Story
					%	%		6.2 & 1/2 Story
					%	%		21.Open Frame Por
					%	%		22.Encl Frame Por
					%	%		23.Frame Garage
					%	%		24.Frame Shed
					%	%		25.Frame Bay Wind
					%	%		26.1SFr Overhang
					%	%		27.Unfin Basement
					%	%		28.Unfinished Att
					%	%		29.Finished Attic



**Easton**

Map Lot 006-016-B

Account 1061

Location LADNER ROAD

Card 1 Of 1 9/27/2018

Building Style <b>0</b>	SF Bsmt Living <b>0</b>	Layout <b>0</b>
1.Conv. 5.Garrison 9.Gambrel	Fin Bsmt Grade <b>0 0</b>	1.Typical 4. 7.
2.Ranch 6.Split 10.Saltbox	OPEN-5-CUSTOMIZE <b>0</b>	2.Inadeq 5. 8.
3.R Ranch 7.Contemp 11.Other	Heat Type <b>100% 0</b>	3.Horrid 6. 9.
4.Cape 8.Log 12.	1.HWBB/Rad 5.FWA 9.No Heat	Attic <b>0</b>
Dwelling Units <b>0</b>	2.HWCI 6.GravWA 10.	1.1/4 Fin 4.Full Fin 7.
Other Units <b>0</b>	3.H Pump 7.Electric 11.	2.1/2 Fin 5.F/Stair 8.
Stories <b>0</b>	4.Steam 8.F/Wall 12.	3.3/4 Fin 6. 9.None
1.1 4.1.5 7.	Cool Type <b>0% 9 None</b>	Insulation <b>0</b>
2.2 5.1.75 8.	1.Refrig 4.W&C Air 7.	1.Full 4.Minimal 7.
3.3 6.2.5 9.	2.Evapor 5. 8.	2.Heavy 5.Partial 8.
Exterior Walls <b>0</b>	3.H Pump 6. 9.None	3.Capped 6. 9.None
1.Wood 5.Stucco 9.Other	Kitchen Style <b>0</b>	Unfinished % <b>0%</b>
2.Vin/Al 6.Brick 10.	1.Modern 4.Obsolete 7.	Grade & Factor <b>0 0%</b>
3.Compos. 7.Stone 11.	2.Typical 5. 8.	1.E Grade 4.B Grade 7.
4.Asbestos 8.Concrete 12.	3.Old Type 6. 9.None	2.D Grade 5.A Grade 8.SC Grade
Roof Surface <b>0</b>	Bath(s) Style <b>0</b>	3.C Grade 6.AA Grade 9.Same
1.Asphalt 4.Composit 7.	1.Modern 4.Obsolete 7.	SQFT (Footprint) <b>0</b>
2.Slate 5.Wood 8.	2.Typical 5. 8.	Condition <b>0</b>
3.Metal 6.Other 9.	3.Old Type 6. 9.None	1.Poor 4.Avg 7.V G
SF Masonry Trim <b>0</b>	# Rooms <b>0</b>	2.Fair 5.Avg+ 8.Exc
OPEN-3-CUSTOM <b>0</b>	# Bedrooms <b>0</b>	3.Avg- 6.Good 9.Same
OPEN-4-CUSTOM <b>0</b>	# Full Baths <b>0</b>	Phys. % Good <b>0%</b>
Year Built <b>0</b>	# Half Baths <b>0</b>	Funct. % Good <b>100%</b>
Year Remodeled <b>0</b>	# Addn Fixtures <b>0</b>	Functional Code <b>9 None</b>
Foundation <b>0</b>	# Fireplaces <b>0</b>	1.Incomp 4.Bsmt 7.
1.Concrete 4.Wood 7.		2.O-Built 5. 8.LongTerm
2.C Block 5.Slab 8.		3.Damage 6.L-T Vaca 9.None
3.Br/Stone 6.Piers 9.		Econ. % Good <b>100%</b>
Basement <b>0</b>		Economic Code <b>None</b>
1.1/4 Bmt 4.Full Bmt 7.		0.None 3.No Power 7.
2.1/2 Bmt 5.None 8.		1.Location 4.Generate 8.
3.3/4 Bmt 6. 9.None		2.Encroach 9.None 9.
Bsmt Gar # Cars <b>0</b>		Entrance Code <b>0</b>
Wet Basement <b>0</b>		1.Interior 4.Vacant 7.
1.Dry 4. 7.		2.Refusal 5.Estimate 8.
2.Damp 5. 8.	3.Informed 6.Reviewed 9.	
3.Wet 6. 9.	Information Code <b>0</b>	
		1.Owner 4.Agent 7.
		2.Relative 5.Estimate 8.
		3.Tenant 6.Exterior 9.

Date Inspected

**Additions, Outbuildings & Improvements**

Type	Year	Units	Grade	Cond	Phys.	Funct.	Sound Value
					%	%	1.One Story Fram
					%	%	2.Two Story Fram
					%	%	3.Three Story Fr
					%	%	4.1 & 1/2 Story
					%	%	5.1 & 3/4 Story
					%	%	6.2 & 1/2 Story
					%	%	21.Open Frame Por
					%	%	22.Encl Frame Por
					%	%	23.Frame Garage
					%	%	24.Frame Shed
					%	%	25.Frame Bay Wind
					%	%	26.1SFr Overhang
					%	%	27.Unfin Basement
					%	%	28.Unfinished Att
					%	%	29.Finished Attic





**Easton**

Map Lot 006-016-C

Account 923

Location LADNER ROAD

Card 1 Of 1 9/27/2018

Building Style			SF Bsmt Living			Layout								
1.Conv.	5.Garrison	9.Gambrel	Fin Bsmt Grade			1.Typical	4.	7.						
2.Ranch	6.Split	10.Saltbox	OPEN-5-CUSTOMIZE			2.Inadeq	5.	8.						
3.R Ranch	7.Contemp	11.Other	Heat Type <b>100%</b>			3.Horrid	6.	9.						
4.Cape	8.Log	12.	1.HWBB/Rad	5.FWA	9.No Heat	Attic								
Dwelling Units			2.HWCI	6.GravWA	10.	1.1/4 Fin	4.Full Fin	7.						
Other Units			3.H Pump	7.Electric	11.	2.1/2 Fin	5.F/Stair	8.						
Stories			4.Steam	8.F/Wall	12.	3.3/4 Fin	6.	9.None						
1.1	4.1.5	7.	Cool Type <b>0%</b>			Insulation								
2.2	5.1.75	8.	1.Refrig	4.W&C Air	7.	1.Full	4.Minimal	7.						
3.3	6.2.5	9.	2.Evapor	5.	8.	2.Heavy	5.Partial	8.						
Exterior Walls			3.H Pump	6.	9.None	3.Capped	6.	9.None						
1.Wood	5.Stucco	9.Other	Kitchen Style			Unfinished %								
2.Vin/Al	6.Brick	10.	1.Modern	4.Obsolete	7.	Grade & Factor								
3.Compos.	7.Stone	11.	2.Typical	5.	8.	1.E Grade	4.B Grade	7.						
4.Asbestos	8.Concrete	12.	3.Old Type	6.	9.None	2.D Grade	5.A Grade	8.SC Grade						
Roof Surface			Bath(s) Style			3.C Grade	6.AA Grade	9.Same						
1.Asphalt	4.Composit	7.	1.Modern	4.Obsolete	7.	SQFT (Footprint)								
2.Slate	5.Wood	8.	2.Typical	5.	8.	Condition								
3.Metal	6.Other	9.	3.Old Type	6.	9.None	1.Poor	4.Avg	7.V G						
SF Masonry Trim			# Rooms			2.Fair	5.Avg+	8.Exc						
OPEN-3-CUSTOM			# Bedrooms			3.Avg-	6.Good	9.Same						
OPEN-4-CUSTOM			# Full Baths			Phys. % Good								
Year Built			# Half Baths			Funct. % Good								
Year Remodeled			# Addn Fixtures			Functional Code								
Foundation			# Fireplaces			1.Incomp	4.Bsmt	7.						
1.Concrete	4.Wood	7.							2.O-Built	5.	8.LongTerm			
2.C Block	5.Slab	8.							Econ. % Good			3.Damage	6.L-T Vaca	9.None
3.Br/Stone	6.Piers	9.							Economic Code			0.None 3.No Power 7.		
Basement									0.None 3.No Power 7.			1.Location 4.Generate 8.		
1.1/4 Bmt	4.Full Bmt	7.							1.Location 4.Generate 8.			2.Encroach 9.None 9.		
2.1/2 Bmt	5.None	8.							Entrance Code <b>0</b>			1.Interior 4.Vacant 7.		
3.3/4 Bmt	6.	9.None							1.Interior 4.Vacant 7.			2.Refusal 5.Estimate 8.		
Bsmt Gar # Cars									2.Refusal 5.Estimate 8.			3.Informed 6.Reviewed 9.		
Wet Basement									3.Informed 6.Reviewed 9.			Information Code <b>0</b>		
1.Dry	4.	7.							1.Owner 4.Agent 7.			2.Relative 5.Estimate 8.		
2.Damp	5.	8.	2.Relative 5.Estimate 8.			3.Tenant 6.Exterior 9.								
3.Wet	6.	9.	3.Tenant 6.Exterior 9.											

Date Inspected

**Additions, Outbuildings & Improvements**

Type	Year	Units	Grade	Cond	Phys.	Funct.	Sound Value
					%	%	1.One Story Fram
					%	%	2.Two Story Fram
					%	%	3.Three Story Fr
					%	%	4.1 & 1/2 Story
					%	%	5.1 & 3/4 Story
					%	%	6.2 & 1/2 Story
					%	%	21.Open Frame Por
					%	%	22.Encl Frame Por
					%	%	23.Frame Garage
					%	%	24.Frame Shed
					%	%	25.Frame Bay Wind
					%	%	26.1SFr Overhang
					%	%	27.Unfin Basement
					%	%	28.Unfinished Att
					%	%	29.Finished Attic

FOX, BRADLEY R  
FOX, SUE A JT  
81 CANTERBURY STREET  
PRESQUE ISLE ME 04769

B5123P188

Previous Owner  
SHAW-ALPERN, HEIDI J & JEFFREY M JT  
28 SOUTHERLY VIEW ROAD

NORTH YARMOUTH ME 04097  
Sale Date: 11/14/2012

Inspection Witnessed By:

X Date

No./Date	Description	Date Insp.

Notes:

Easton

Property Data			Assessment Record						
Neighborhood <b>1 Resident/Agric.</b>			Year	Land	Buildings	Exempt	Total		
Tree Growth Year <b>0</b>			2010	12,900	0	0	12,900		
Recertified Date <b>0</b>			2011	12,900	0	0	12,900		
Y Coordinate <b>0</b>			2012	12,900	0	0	12,900		
Zone/Land Use <b>11 Residential</b>			2013	12,900	0	0	12,900		
Secondary Zone			2014	12,900	0	0	12,900		
Topography <b>1 Level 2 Rolling</b>			2015	28,600	0	0	28,600		
1.Level 4.Below St 7.			2016	28,600	0	0	28,600		
2.Rolling 5.Low 8.			2017	28,600	0	0	28,600		
3.Above St 6.Swampy 9.			2018	28,600	0	0	28,600		
Utilities <b>9 None</b>									
1.Public 4.Dr Well 7.Cesspool									
2.Water 5.Dug Well 8.									
3.Sewer 6.Septic 9.None									
Street <b>1 Paved</b>									
1.Paved 4.Proposed 7.									
2.Semi Imp 5.R/W 8.									
3.Gravel 6. 9.None									
FLOOD PLAIN <b>0</b>			<b>Land Data</b>						
CLASS <b>1</b>			<b>Front Foot</b>	<b>Type</b>	<b>Effective</b>		<b>Influence</b>		<b>Influence Codes</b>
					Frontage	Depth	Factor	Code	
<b>Sale Data</b>			11.Regular Lot						1.Unimproved
Sale Date <b>11/14/2012</b>			12.Delta Triangle						2.Condition
Price <b>38,500</b>			13.Nabla Triangle						3.Topography
Sale Type <b>1 Land Only</b>			14.Rear Land						4.Size/Shape
1.Land 4.Mobile 7.			15.Miscellaneous						5.Access
2.L & B 5.Other 8.									6.Restricted
3.Building 6. 9.									7.Corner Infl
Financing <b>9 Unknown</b>									8.Environment
1.Convent 4.Seller 7.			<b>Square Foot</b>		<b>Square Feet</b>				9.Fract Share
2.FHA/VA 5.Private 8.			16.Regular Lot						
3.Assumed 6.Cash 9.Unknown			17.Class I Road						
Validity <b>1 Arms Length Sale</b>			18.Class II Road						
1.Valid 4.Split 7.Changes			19.Condominium						
2.Related 5.Partial 8.Other			20.Sound Value						
3.Distress 6.Exempt 9.									
Verified <b>5 Public Record</b>			<b>Fract. Acre</b>		<b>Acreage/Sites</b>				
1.Buyer 4.Agent 7.Family			21.Homesite (Frac	25	1.00	100	%	0	
2.Seller 5.Pub Rec 8.Other			22.Baselot (Fract	28	12.25	100	%	0	
3.Lender 6.MLS 9.			23.Misc (Fract)	31	13.00	100	%	0	
			<b>Acres</b>						
			24.Homesite						
			25.Baselot						
			26.Secondary						
			27.Frontage						
			28.Rear Land (All	<b>Total Acreage</b>		26.25			
			31.Tillable						

- 1.Unimproved
- 2.Condition
- 3.Topography
- 4.Size/Shape
- 5.Access
- 6.Restricted
- 7.Corner Infl
- 8.Environment
- 9.Fract Share
- 
- 32.Farmland Tilla
- 33.C R P
- 34.Softwood-Farm
- 35.Mixed Wood-Far
- 36.Hardwood-Farm
- 37.Softwood-TG
- 38.Mixed Wood-TG
- 39.Hardwood-TG
- 40.Wasteland
- 41.Gravel Pit
- 42.Mobile Home Si
- 43.Excess Indust
- 44.Lot Improvemen
- 45.Tower Site
- 46.Miscellaneous
- 47.Pavement
- 48.Farmland Pastu

**Easton**

Map Lot 006-017

Account 681

Location RIVER DE CHUTE ROAD

Card 1 Of 1 9/27/2018

Building Style <b>0</b>	SF Bsmt Living <b>0</b>	Layout <b>0</b>
1.Conv. 5.Garrison 9.Gambrel	Fin Bsmt Grade <b>0 0</b>	1.Typical 4. 7.
2.Ranch 6.Split 10.Saltbox	OPEN-5-CUSTOMIZE <b>0</b>	2.Inadeq 5. 8.
3.R Ranch 7.Contemp 11.Other	Heat Type <b>100% 0</b>	3.Horrid 6. 9.
4.Cape 8.Log 12.	1.HWBB/Rad 5.FWA 9.No Heat	Attic <b>0</b>
Dwelling Units <b>0</b>	2.HWCI 6.GravWA 10.	1.1/4 Fin 4.Full Fin 7.
Other Units <b>0</b>	3.H Pump 7.Electric 11.	2.1/2 Fin 5.F/Stair 8.
Stories <b>0</b>	4.Steam 8.F/Wall 12.	3.3/4 Fin 6. 9.None
1.1 4.1.5 7.	Cool Type <b>0% 9 None</b>	Insulation <b>0</b>
2.2 5.1.75 8.	1.Refrig 4.W&C Air 7.	1.Full 4.Minimal 7.
3.3 6.2.5 9.	2.Evapor 5. 8.	2.Heavy 5.Partial 8.
Exterior Walls <b>0</b>	3.H Pump 6. 9.None	3.Capped 6. 9.None
1.Wood 5.Stucco 9.Other	Kitchen Style <b>0</b>	Unfinished % <b>0%</b>
2.Vin/Al 6.Brick 10.	1.Modern 4.Obsolete 7.	Grade & Factor <b>0 0%</b>
3.Compos. 7.Stone 11.	2.Typical 5. 8.	1.E Grade 4.B Grade 7.
4.Asbestos 8.Concrete 12.	3.Old Type 6. 9.None	2.D Grade 5.A Grade 8.SC Grade
Roof Surface <b>0</b>	Bath(s) Style <b>0</b>	3.C Grade 6.AA Grade 9.Same
1.Asphalt 4.Composit 7.	1.Modern 4.Obsolete 7.	SQFT (Footprint) <b>0</b>
2.Slate 5.Wood 8.	2.Typical 5. 8.	Condition <b>0</b>
3.Metal 6.Other 9.	3.Old Type 6. 9.None	1.Poor 4.Avg 7.V G
SF Masonry Trim <b>0</b>	# Rooms <b>0</b>	2.Fair 5.Avg+ 8.Exc
OPEN-3-CUSTOM <b>0</b>	# Bedrooms <b>0</b>	3.Avg- 6.Good 9.Same
OPEN-4-CUSTOM <b>0</b>	# Full Baths <b>0</b>	Phys. % Good <b>0%</b>
Year Built <b>0</b>	# Half Baths <b>0</b>	Funct. % Good <b>100%</b>
Year Remodeled <b>0</b>	# Addn Fixtures <b>0</b>	Functional Code <b>9 None</b>
Foundation <b>0</b>	# Fireplaces <b>0</b>	1.Incomp 4.Bsmt 7.
1.Concrete 4.Wood 7.		2.O-Built 5. 8.LongTerm
2.C Block 5.Slab 8.		3.Damage 6.L-T Vaca 9.None
3.Br/Stone 6.Piers 9.		Econ. % Good <b>100%</b>
Basement <b>0</b>		Economic Code <b>None</b>
1.1/4 Bmt 4.Full Bmt 7.		0.None 3.No Power 7.
2.1/2 Bmt 5.None 8.		1.Location 4.Generate 8.
3.3/4 Bmt 6. 9.None		2.Encroach 9.None 9.
Bsmt Gar # Cars <b>0</b>		Entrance Code <b>0</b>
Wet Basement <b>0</b>		1.Interior 4.Vacant 7.
1.Dry 4. 7.		2.Refusal 5.Estimate 8.
2.Damp 5. 8.	3.Informed 6.Reviewed 9.	
3.Wet 6. 9.	Information Code <b>0</b>	
		1.Owner 4.Agent 7.
		2.Relative 5.Estimate 8.
		3.Tenant 6.Exterior 9.

Date Inspected

**Additions, Outbuildings & Improvements**

Type	Year	Units	Grade	Cond	Phys.	Funct.	Sound Value
					%	%	1.One Story Fram
					%	%	2.Two Story Fram
					%	%	3.Three Story Fr
					%	%	4.1 & 1/2 Story
					%	%	5.1 & 3/4 Story
					%	%	6.2 & 1/2 Story
					%	%	21.Open Frame Por
					%	%	22.Encl Frame Por
					%	%	23.Frame Garage
					%	%	24.Frame Shed
					%	%	25.Frame Bay Wind
					%	%	26.1SFr Overhang
					%	%	27.Unfin Basement
					%	%	28.Unfinished Att
					%	%	29.Finished Attic



**Easton**

Map Lot 006-017-A

Account 382

Location 414 LADNER RD

Card 1 Of 2 9/27/2018

Building Style <b>1 Conventional</b>	SF Bsmt Living <b>0</b>	Layout <b>1 Typical</b>
1.Conv. 5.Garrison 9.Gambrel	Fin Bsmt Grade <b>0 0</b>	1.Typical 4. 7.
2.Ranch 6.Split 10.Saltbox	OPEN-5-CUSTOMIZE <b>0</b>	2.Inadeq 5. 8.
3.R Ranch 7.Contemp 11.Other	Heat Type <b>100% 5 Forced Warm Air</b>	3.Horrid 6. 9.
4.Cape 8.Log 12.	1.HWBB/Rad 5.FWA 9.No Heat	Attic <b>9 None</b>
Dwelling Units <b>1</b>	2.HWCI 6.GravWA 10.	1.1/4 Fin 4.Full Fin 7.
Other Units <b>0</b>	3.H Pump 7.Electric 11.	2.1/2 Fin 5.FI/Stair 8.
Stories <b>4 One &amp; 1/2 Story</b>	4.Steam 8.FI/Wall 12.	3.3/4 Fin 6. 9.None
1.1 4.1.5 7.	Cool Type <b>0% 9 None</b>	Insulation <b>4 Minimal</b>
2.2 5.1.75 8.	1.Refrig 4.W&C Air 7.	1.Full 4.Minimal 7.
3.3 6.2.5 9.	2.Evapor 5. 8.	2.Heavy 5.Partial 8.
Exterior Walls <b>1 Wood Siding</b>	3.H Pump 6. 9.None	3.Capped 6. 9.None
1.Wood 5.Stucco 9.Other	Kitchen Style <b>2 Typical</b>	Unfinished % <b>0%</b>
2.Vin/Al 6.Brick 10.	1.Modern 4.Obsolete 7.	Grade & Factor <b>2 Fair 115%</b>
3.Compos. 7.Stone 11.	2.Typical 5. 8.	1.E Grade 4.B Grade 7.
4.Asbestos 8.Concrete 12.	3.Old Type 6. 9.None	2.D Grade 5.A Grade 8.SC Grade
Roof Surface <b>1 Asphalt Shingles</b>	Bath(s) Style <b>2 Typical Bath(s)</b>	3.C Grade 6.AA Grade 9.Same
1.Asphalt 4.Composit 7.	1.Modern 4.Obsolete 7.	SQFT (Footprint) <b>791</b>
2.Slate 5.Wood 8.	2.Typical 5. 8.	Condition <b>3 Below Average</b>
3.Metal 6.Other 9.	3.Old Type 6. 9.None	1.Poor 4.Avg 7.V G
SF Masonry Trim <b>0</b>	# Rooms <b>8</b>	2.Fair 5.Avg+ 8.Exc
OPEN-3-CUSTOM <b>0</b>	# Bedrooms <b>3</b>	3.Avg- 6.Good 9.Same
OPEN-4-CUSTOM <b>0</b>	# Full Baths <b>1</b>	Phys. % Good <b>0%</b>
Year Built <b>1900</b>	# Half Baths <b>0</b>	Funct. % Good <b>100%</b>
Year Remodeled <b>0</b>	# Addn Fixtures <b>1</b>	Functional Code <b>9 None</b>
Foundation <b>3 Brick &amp;/or Stone</b>	# Fireplaces <b>0</b>	1.Incomp 4.Bsmt 7.
1.Concrete 4.Wood 7.	 <p><b>TRIO</b> Software A Division of Harris Computer Systems</p>	2.O-Built 5. 8.LongTerm
2.C Block 5.Slab 8.		3.Damage 6.L-T Vaca 9.None
3.Br/Stone 6.Piers 9.		Econ. % Good <b>100%</b>
Basement <b>2 1/2 Basement</b>		Economic Code <b>None</b>
1.1/4 Bmt 4.Full Bmt 7.		0.None 3.No Power 7.
2.1/2 Bmt 5.None 8.		1.Location 4.Generate 8.
3.3/4 Bmt 6. 9.None		2.Encroach 9.None 9.
Bsmt Gar # Cars <b>0</b>		Entrance Code <b>1 Interior Inspect</b>
Wet Basement <b>3 Wet Basement</b>		1.Interior 4.Vacant 7.
1.Dry 4. 7.		2.Refusal 5.Estimate 8.
2.Damp 5. 8.	3.Informed 6.Reviewed 9.	
3.Wet 6. 9.	Information Code <b>1 Owner</b>	
		1.Owner 4.Agent 7.
		2.Relative 5.Estimate 8.
		3.Tenant 6.Exterior 9.

Date Inspected 6/29/2015

**Additions, Outbuildings & Improvements**

Type	Year	Units	Grade	Cond	Phys.	Funct.	Sound Value
1 One Story Frame	0	306	0 0	0	0 %	0 %	
22 Encl Frame Porch	0	108	0 0	0	0 %	0 %	
23 Frame Garage	0	641	0 0	0	0 %	80 %	
					%	%	
					%	%	
					%	%	
					%	%	
					%	%	
					%	%	
					%	%	
					%	%	

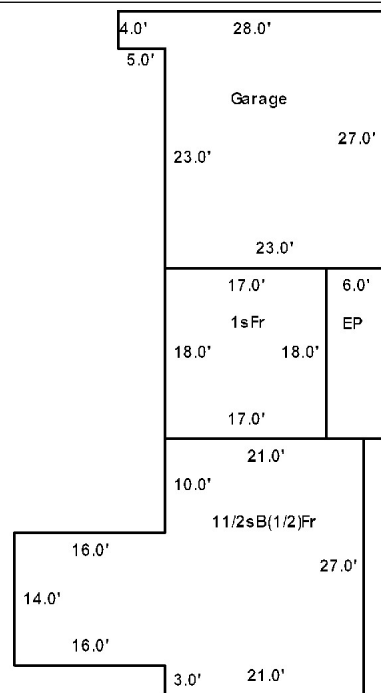

HUDSON, DALE W  
PO BOX 384  
EASTON ME 04740

B4415P221

Previous Owner  
VETERANS AFFAIRS ADM USA  
DALE HUDSON  
275 CHESTNUT STREET  
MANCHESTER NH 03101  
Sale Date: 2/12/2007

Inspection Witnessed By:

X	Date	Date Insp.
No./Date	Description	Date Insp.

Notes:

Easton

Property Data			Assessment Record						
Neighborhood <b>1 Resident/Agric.</b>			Year	Land	Buildings	Exempt	Total		
Tree Growth Year <b>0</b>			2010	0	1,400	0	1,400		
Recertified Date <b>0</b>			2011	0	1,400	0	1,400		
Y Coordinate <b>0</b>			2012	0	1,400	0	1,400		
Zone/Land Use <b>11 Residential</b>			2013	0	1,400	0	1,400		
Secondary Zone			2014	0	1,400	0	1,400		
Topography <b>1 Level 2 Rolling</b>			2015	0	4,500	0	4,500		
1.Level 4.Below St 7.			2016	0	4,500	0	4,500		
2.Rolling 5.Low 8.			2017	0	4,500	0	4,500		
3.Above St 6.Swampy 9.			2018	0	4,500	0	4,500		
Utilities									
1.Public 4.Dr Well 7.Cesspool									
2.Water 5.Dug Well 8.									
3.Sewer 6.Septic 9.None									
Street <b>1 Paved</b>									
1.Paved 4.Proposed 7.									
2.Semi Imp 5.R/W 8.									
3.Gravel 6. 9.None									
FLOOD PLAIN <b>0</b>									
CLASS <b>8</b>									
Sale Data			<b>Land Data</b>						
Sale Date			<b>Front Foot</b>	<b>Type</b>	<b>Effective</b>		<b>Influence</b>		<b>Influence Codes</b>
Price					Frontage	Depth	Factor	Code	
Sale Type			11.Regular Lot					1.Unimproved	
1.Land 4.Mobile 7.			12.Delta Triangle					2.Condition	
2.L & B 5.Other 8.			13.Nabla Triangle					3.Topography	
3.Building 6. 9.			14.Rear Land					4.Size/Shape	
Financing			15.Miscellaneous					5.Access	
1.Convent 4.Seller 7.								6.Restricted	
2.FHA/VA 5.Private 8.								7.Corner Infl	
3.Assumed 6.Cash 9.Unknown								8.Environment	
Validity								9.Fract Share	
1.Valid 4.Split 7.Changes			<b>Square Foot</b>	<b>Square Feet</b>				<b>Acres</b>	
2.Related 5.Partial 8.Other			16.Regular Lot					32.Farmland Tilla	
3.Distress 6.Exempt 9.			17.Class I Road					33.C R P	
Verified			18.Class II Road					34.Softwood-Farm	
1.Buyer 4.Agent 7.Family			19.Condominium					35.Mixed Wood-Far	
2.Seller 5.Pub Rec 8.Other			20.Sound Value					36.Hardwood-Farm	
3.Lender 6.MLS 9.								37.Softwood-TG	
			<b>Fract. Acre</b>	<b>Acreeage/Sites</b>				38.Mixed Wood-TG	
			21.Homesite (Frac					39.Hardwood-TG	
			22.Baselot (Fract					40.Wasteland	
			23.Misc (Fract)					41.Gravel Pit	
			<b>Acres</b>					42.Mobile Home Si	
			24.Homesite					43.Excess Indust	
			25.Baselot					44.Lot Improvemen	
			26.Secondary					45.Tower Site	
			27.Frontage					46.Miscellaneous	
			28.Rear Land (All					47.Pavement	
			31.Tillable					48.Farmland Pastu	
				<b>Total Acreeage</b>		0.00			

**Easton**

Map Lot 006-017-A

Account 382

Location RIVER DE CHUTE ROAD

Card 2 Of 2 9/27/2018

Building Style	SF Bsmt Living	Layout
1.Conv. 5.Garrison 9.Gambrel	Fin Bsmt Grade	1.Typical 4. 7.
2.Ranch 6.Split 10.Saltbox	OPEN-5-CUSTOMIZE	2.Inadeq 5. 8.
3.R Ranch 7.Contemp 11.Other	Heat Type <b>100%</b>	3.Horrid 6. 9.
4.Cape 8.Log 12.	1.HWBB/Rad 5.FWA 9.No Heat	Attic
Dwelling Units	2.HWCI 6.GravWA 10.	1.1/4 Fin 4.Full Fin 7.
Other Units	3.H Pump 7.Electric 11.	2.1/2 Fin 5.F/Stair 8.
Stories	4.Steam 8.F/Wall 12.	3.3/4 Fin 6. 9.None
1.1 4.1.5 7.	Cool Type <b>0%</b>	Insulation
2.2 5.1.75 8.	1.Refrig 4.W&C Air 7.	1.Full 4.Minimal 7.
3.3 6.2.5 9.	2.Evapor 5. 8.	2.Heavy 5.Partial 8.
Exterior Walls	3.H Pump 6. 9.None	3.Capped 6. 9.None
1.Wood 5.Stucco 9.Other	Kitchen Style	Unfinished %
2.Vin/Al 6.Brick 10.	1.Modern 4.Obsolete 7.	Grade & Factor
3.Compos. 7.Stone 11.	2.Typical 5. 8.	1.E Grade 4.B Grade 7.
4.Asbestos 8.Concrete 12.	3.Old Type 6. 9.None	2.D Grade 5.A Grade 8.SC Grade
Roof Surface	Bath(s) Style	3.C Grade 6.AA Grade 9.Same
1.Asphalt 4.Composit 7.	1.Modern 4.Obsolete 7.	SQFT (Footprint)
2.Slate 5.Wood 8.	2.Typical 5. 8.	Condition
3.Metal 6.Other 9.	3.Old Type 6. 9.None	1.Poor 4.Avg 7.V G
SF Masonry Trim	# Rooms	2.Fair 5.Avg+ 8.Exc
OPEN-3-CUSTOM	# Bedrooms	3.Avg- 6.Good 9.Same
OPEN-4-CUSTOM	# Full Baths	Phys. % Good
Year Built	# Half Baths	Funct. % Good
Year Remodeled	# Addn Fixtures	Functional Code
Foundation	# Fireplaces	1.Incomp 4.Bsmt 7.
1.Concrete 4.Wood 7.		2.O-Built 5. 8.LongTerm
2.C Block 5.Slab 8.		3.Damage 6.L-T Vaca 9.None
3.Br/Stone 6.Piers 9.		Econ. % Good
Basement		Economic Code
1.1/4 Bmt 4.Full Bmt 7.		0.None 3.No Power 7.
2.1/2 Bmt 5.None 8.		1.Location 4.Generate 8.
3.3/4 Bmt 6. 9.None		2.Encroach 9.None 9.
Bsmt Gar # Cars		Entrance Code <b>1 Interior Inspect</b>
Wet Basement		1.Interior 4.Vacant 7.
1.Dry 4. 7.		2.Refusal 5.Estimate 8.
2.Damp 5. 8.	3.Informed 6.Reviewed 9.	
3.Wet 6. 9.	Information Code <b>1 Owner</b>	
	1.Owner 4.Agent 7.	
	2.Relative 5.Estimate 8.	
	3.Tenant 6.Exterior 9.	

Date Inspected 6/29/2015

**Additions, Outbuildings & Improvements**

Type	Year	Units	Grade	Cond	Phys.	Funct.	Sound Value
23 Frame Garage	1930	1350	1 100	3	0 %	75 %	
					%	%	
					%	%	
					%	%	
					%	%	
					%	%	
					%	%	
					%	%	
					%	%	
					%	%	
					%	%	

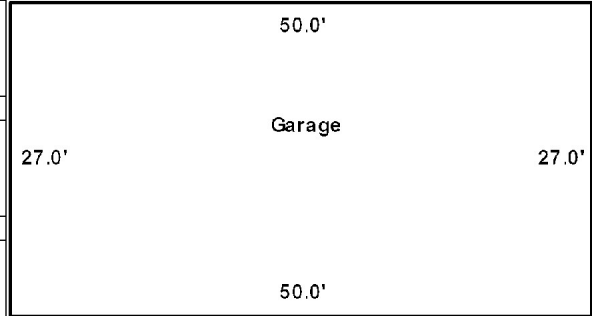

Shed  
No Value







**Easton**

Map Lot 006-017-B

Account 1062

Location LADNER ROAD

Card 1 Of 1 9/27/2018

Building Style <b>0</b>	SF Bsmt Living <b>0</b>	Layout <b>0</b>
1.Conv. 5.Garrison 9.Gambrel	Fin Bsmt Grade <b>0 0</b>	1.Typical 4. 7.
2.Ranch 6.Split 10.Saltbox	OPEN-5-CUSTOMIZE <b>0</b>	2.Inadeq 5. 8.
3.R Ranch 7.Contemp 11.Other	Heat Type <b>100% 0</b>	3.Horrid 6. 9.
4.Cape 8.Log 12.	1.HWBB/Rad 5.FWA 9.No Heat	Attic <b>0</b>
Dwelling Units <b>0</b>	2.HWCI 6.GravWA 10.	1.1/4 Fin 4.Full Fin 7.
Other Units <b>0</b>	3.H Pump 7.Electric 11.	2.1/2 Fin 5.F/Stair 8.
Stories <b>0</b>	4.Steam 8.F/Wall 12.	3.3/4 Fin 6. 9.None
1.1 4.1.5 7.	Cool Type <b>0% 9 None</b>	Insulation <b>0</b>
2.2 5.1.75 8.	1.Refrig 4.W&C Air 7.	1.Full 4.Minimal 7.
3.3 6.2.5 9.	2.Evapor 5. 8.	2.Heavy 5.Partial 8.
Exterior Walls <b>0</b>	3.H Pump 6. 9.None	3.Capped 6. 9.None
1.Wood 5.Stucco 9.Other	Kitchen Style <b>0</b>	Unfinished % <b>0%</b>
2.Vin/Al 6.Brick 10.	1.Modern 4.Obsolete 7.	Grade & Factor <b>0 0%</b>
3.Compos. 7.Stone 11.	2.Typical 5. 8.	1.E Grade 4.B Grade 7.
4.Asbestos 8.Concrete 12.	3.Old Type 6. 9.None	2.D Grade 5.A Grade 8.SC Grade
Roof Surface <b>0</b>	Bath(s) Style <b>0</b>	3.C Grade 6.AA Grade 9.Same
1.Asphalt 4.Composit 7.	1.Modern 4.Obsolete 7.	SQFT (Footprint) <b>0</b>
2.Slate 5.Wood 8.	2.Typical 5. 8.	Condition <b>0</b>
3.Metal 6.Other 9.	3.Old Type 6. 9.None	1.Poor 4.Avg 7.V G
SF Masonry Trim <b>0</b>	# Rooms <b>0</b>	2.Fair 5.Avg+ 8.Exc
OPEN-3-CUSTOM <b>0</b>	# Bedrooms <b>0</b>	3.Avg- 6.Good 9.Same
OPEN-4-CUSTOM <b>0</b>	# Full Baths <b>0</b>	Phys. % Good <b>0%</b>
Year Built <b>0</b>	# Half Baths <b>0</b>	Funct. % Good <b>100%</b>
Year Remodeled <b>0</b>	# Addn Fixtures <b>0</b>	Functional Code <b>9 None</b>
Foundation <b>0</b>	# Fireplaces <b>0</b>	1.Incomp 4.Bsmt 7.
1.Concrete 4.Wood 7.		2.O-Built 5. 8.LongTerm
2.C Block 5.Slab 8.		3.Damage 6.L-T Vaca 9.None
3.Br/Stone 6.Piers 9.		Econ. % Good <b>100%</b>
Basement <b>0</b>		Economic Code <b>None</b>
1.1/4 Bmt 4.Full Bmt 7.		0.None 3.No Power 7.
2.1/2 Bmt 5.None 8.		1.Location 4.Generate 8.
3.3/4 Bmt 6. 9.None		2.Encroach 9.None 9.
Bsmt Gar # Cars <b>0</b>		Entrance Code <b>0</b>
Wet Basement <b>0</b>		1.Interior 4.Vacant 7.
1.Dry 4. 7.		2.Refusal 5.Estimate 8.
2.Damp 5. 8.	3.Informed 6.Reviewed 9.	
3.Wet 6. 9.	Information Code <b>0</b>	
		1.Owner 4.Agent 7.
		2.Relative 5.Estimate 8.
		3.Tenant 6.Exterior 9.

Date Inspected

**Additions, Outbuildings & Improvements**

Type	Year	Units	Grade	Cond	Phys.	Funct.	Sound Value
					%	%	1.One Story Fram
					%	%	2.Two Story Fram
					%	%	3.Three Story Fr
					%	%	4.1 & 1/2 Story
					%	%	5.1 & 3/4 Story
					%	%	6.2 & 1/2 Story
					%	%	21.Open Frame Por
					%	%	22.Encl Frame Por
					%	%	23.Frame Garage
					%	%	24.Frame Shed
					%	%	25.Frame Bay Wind
					%	%	26.1SFr Overhang
					%	%	27.Unfin Basement
					%	%	28.Unfinished Att
					%	%	29.Finished Attic

SIMS, WARREN F JR  
 CENEDELLA, ARLENE J  
 430 LADNER RD  
 EASTON ME 04740

B1878P350 B5253P31

Neighborhood <b>1 Resident/Agric.</b>		
Tree Growth Year <b>0</b>		
Recertified Date <b>0</b>		
Y Coordinate <b>0</b>		
Zone/Land Use <b>11 Residential</b>		
Secondary Zone		
Topography <b>1 Level 2 Rolling</b>		
1.Level	4.Below St	7.
2.Rolling	5.Low	8.
3.Above St	6.Swampy	9.
Utilities <b>4 Drilled Well 6 Septic System</b>		
1.Public	4.Dr Well	7.Cesspool
2.Water	5.Dug Well	8.
3.Sewer	6.Septic	9.None
Street <b>1 Paved</b>		
1.Paved	4.Proposed	7.
2.Semi Imp	5.R/W	8.
3.Gravel	6.	9.None
FLOOD PLAIN <b>0</b>		
CLASS <b>1</b>		

Inspection Witnessed By:

X	Date
No./Date	Description
	Date Insp.

Notes:  
 B5253P031 11/4/2013 TENANT FOR 25 YEAR PERIOD -  
 SAMUEL & MATTIE D GINGERICH  
 \*On Card 4 Shed attached to riding arena -25% for size obsol.  
 -20% for attached

Easton

Property Data			Assessment Record						
Neighborhood <b>1 Resident/Agric.</b>			Year	Land	Buildings	Exempt	Total		
Tree Growth Year <b>0</b>			2010	33,200	60,700	6,050	87,850		
Recertified Date <b>0</b>			2011	33,200	60,600	6,050	87,750		
Y Coordinate <b>0</b>			2012	33,200	60,600	5,940	87,860		
Zone/Land Use <b>11 Residential</b>			2013	33,200	60,500	6,160	87,540		
Secondary Zone			2014	33,200	60,400	0	93,600		
Topography <b>1 Level 2 Rolling</b>			2015	70,800	77,800	0	148,600		
1.Level 4.Below St 7.			2016	70,800	77,800	0	148,600		
2.Rolling 5.Low 8.			2017	70,800	77,800	0	148,600		
3.Above St 6.Swampy 9.			2018	70,800	77,800	0	148,600		
Utilities <b>4 Drilled Well 6 Septic System</b>									
1.Public 4.Dr Well 7.Cesspool									
2.Water 5.Dug Well 8.									
3.Sewer 6.Septic 9.None									
Street <b>1 Paved</b>									
1.Paved 4.Proposed 7.									
2.Semi Imp 5.R/W 8.									
3.Gravel 6. 9.None									
FLOOD PLAIN <b>0</b>									
CLASS <b>1</b>									
Sale Data			Land Data						
Sale Date			Front Foot	Type	Effective		Influence		Influence Codes
Price			11.Regular Lot 12.Delta Triangle 13.Nabla Triangle 14.Rear Land 15.Miscellaneous		Frontage	Depth	Factor	Code	
Sale Type									
1.Land 4.Mobile 7.								2.Condition	
2.L & B 5.Other 8.								3.Topography	
3.Building 6. 9.								4.Size/Shape	
Financing								5.Access	
1.Convent 4.Seller 7.								6.Restricted	
2.FHA/VA 5.Private 8.								7.Corner Infl	
3.Assumed 6.Cash 9.Unknown								8.Environment	
Validity								9.Fract Share	
1.Valid 4.Split 7.Changes			Square Foot	Square Feet				32.Farmland Tilla	
2.Related 5.Partial 8.Other								33.C R P	
3.Distress 6.Exempt 9.								34.Softwood-Farm	
Verified								35.Mixed Wood-Far	
1.Buyer 4.Agent 7.Family								36.Hardwood-Farm	
2.Seller 5.Pub Rec 8.Other								37.Softwood-TG	
3.Lender 6.MLS 9.								38.Mixed Wood-TG	
			Fract. Acre	Acreage/Sites				39.Hardwood-TG	
								40.Wasteland	
			21.Homesite (Frac	24	1.00	100	%	0	
			22.Basemat (Frac	28	27.50	100	%	0	
			23.Misc (Frac)	31	40.00	100	%	0	
			Acres	44	1.00	100	%	0	
			24.Homesite						
			25.Basemat						
			26.Secondary						
			27.Frontage						
			28.Rear Land (All						
			31.Tillable						
			<b>Total Acreage</b>		<b>68.50</b>				42.Mobile Home Si
								43.Excess Indust	
								44.Lot Improvemen	
								45.Tower Site	
								46.Miscellaneous	
								47.Pavement	
								48.Farmland Pastu	

**Easton**

Map Lot 006-018

Account 688

Location 430 LADNER RD

Card 1 Of 6 9/27/2018

Building Style <b>1 Conventional</b>	SF Bsmt Living <b>0</b>	Layout <b>1 Typical</b>
1.Conv. 5.Garrison 9.Gambrel	Fin Bsmt Grade <b>0 0</b>	1.Typical 4. 7.
2.Ranch 6.Split 10.Saltbox	OPEN-5-CUSTOMIZE <b>0</b>	2.Inadeq 5. 8.
3.R Ranch 7.Contemp 11.Other	Heat Type <b>100% 5 Forced Warm Air</b>	3.Horrid 6. 9.
4.Cape 8.Log 12.	1.HWBB/Rad 5.FWA 9.No Heat	Attic <b>9 None</b>
Dwelling Units <b>1</b>	2.HWCI 6.GravWA 10.	1.1/4 Fin 4.Full Fin 7.
Other Units <b>0</b>	3.H Pump 7.Electric 11.	2.1/2 Fin 5.FI/Stair 8.
Stories <b>4 One &amp; 1/2 Story</b>	4.Steam 8.FI/Wall 12.	3.3/4 Fin 6. 9.None
1.1 4.1.5 7.	Cool Type <b>0% 9 None</b>	Insulation <b>1 Full</b>
2.2 5.1.75 8.	1.Refrig 4.W&C Air 7.	1.Full 4.Minimal 7.
3.3 6.2.5 9.	2.Evapor 5. 8.	2.Heavy 5.Partial 8.
Exterior Walls <b>1 Wood Siding</b>	3.H Pump 6. 9.None	3.Capped 6. 9.None
1.Wood 5.Stucco 9.Other	Kitchen Style <b>2 Typical</b>	Unfinished % <b>0%</b>
2.Vin/Al 6.Brick 10.	1.Modern 4.Obsolete 7.	Grade & Factor <b>2 Fair 115%</b>
3.Compos. 7.Stone 11.	2.Typical 5. 8.	1.E Grade 4.B Grade 7.
4.Asbestos 8.Concrete 12.	3.Old Type 6. 9.None	2.D Grade 5.A Grade 8.SC Grade
Roof Surface <b>1 Asphalt Shingles</b>	Bath(s) Style <b>2 Typical Bath(s)</b>	3.C Grade 6.AA Grade 9.Same
1.Asphalt 4.Composit 7.	1.Modern 4.Obsolete 7.	SQFT (Footprint) <b>920</b>
2.Slate 5.Wood 8.	2.Typical 5. 8.	Condition <b>7 Very Good</b>
3.Metal 6.Other 9.	3.Old Type 6. 9.None	1.Poor 4.Avg 7.V G
SF Masonry Trim <b>0</b>	# Rooms <b>10</b>	2.Fair 5.Avg+ 8.Exc
OPEN-3-CUSTOM <b>0</b>	# Bedrooms <b>5</b>	3.Avg- 6.Good 9.Same
OPEN-4-CUSTOM <b>0</b>	# Full Baths <b>2</b>	Phys. % Good <b>0%</b>
Year Built <b>1900</b>	# Half Baths <b>0</b>	Funct. % Good <b>100%</b>
Year Remodeled <b>0</b>	# Addn Fixtures <b>0</b>	Functional Code <b>9 None</b>
Foundation <b>3 Brick &amp;/or Stone</b>	# Fireplaces <b>0</b>	1.Incomp 4.Bsmt 7.
1.Concrete 4.Wood 7.	 <p><b>TRIO</b> Software A Division of Harris Computer Systems</p>	2.O-Built 5. 8.LongTerm
2.C Block 5.Slab 8.		3.Damage 6.L-T Vaca 9.None
3.Br/Stone 6.Piers 9.		Econ. % Good <b>100%</b>
Basement <b>3 3/4 Basement</b>		Economic Code <b>None</b>
1.1/4 Bmt 4.Full Bmt 7.		0.None 3.No Power 7.
2.1/2 Bmt 5.None 8.		1.Location 4.Generate 8.
3.3/4 Bmt 6. 9.None		2.Encroach 9.None 9.
Bsmt Gar # Cars <b>0</b>		Entrance Code <b>1 Interior Inspect</b>
Wet Basement <b>3 Wet Basement</b>		1.Interior 4.Vacant 7.
1.Dry 4. 7.		2.Refusal 5.Estimate 8.
2.Damp 5. 8.	3.Informed 6.Reviewed 9.	
3.Wet 6. 9.	Information Code <b>1 Owner</b>	
		1.Owner 4.Agent 7.
		2.Relative 5.Estimate 8.
		3.Tenant 6.Exterior 9.

Date Inspected 6/30/2015

**Additions, Outbuildings & Improvements**

Type	Year	Units	Grade	Cond	Phys.	Funct.	Sound Value
22 Encl Frame Porch	0	224	0 0	0	0 %	0 %	
21 Open Frame	0	257	0 0	0	0 %	0 %	
83 Frame BSMT	1985	64	9 100	4	0 %	100 %	
4 1 & 1/2 Story Fr	0	256	0 0	0	0 %	0 %	
66 Greenhouse	1980	112	9 100	4	0 %	100 %	
68 Wood Deck	1985	91	9 100	4	0 %	100 %	
24 Frame Shed	0	70	9 100	9	0 %	80 %	
79 1.25 S-Gar	0	224	9 100	9	0 %	80 %	
61 Canopy	0	224	0 0	0	0 %	0 %	
62 Patio	1985	247	9 100	4	0 %	100 %	

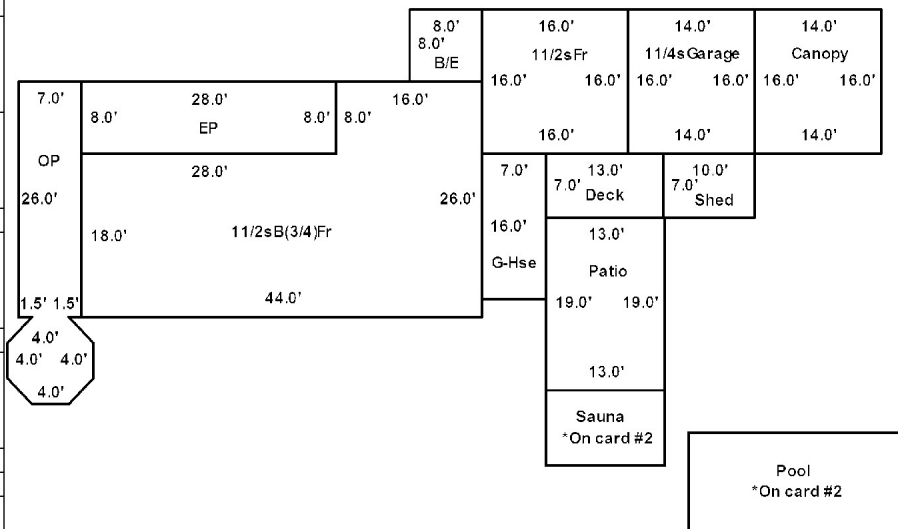

SIMS, WARREN F JR  
 CENEDELLA, ARLENE J  
 430 LADNER RD  
 EASTON ME 04740

B1878P350 B5253P31

<b>Property Data</b>		
Neighborhood	<b>1 Resident/Agric.</b>	
Tree Growth Year	<b>0</b>	
Recertified Date	<b>0</b>	
Y Coordinate	<b>0</b>	
Zone/Land Use	<b>11 Residential</b>	
Secondary Zone		
Topography	<b>1 Level</b>	<b>2 Rolling</b>
1.Level	4.Below St	7.
2.Rolling	5.Low	8.
3.Above St	6.Swampy	9.
Utilities		
1.Public	4.Dr Well	7.Cesspool
2.Water	5.Dug Well	8.
3.Sewer	6.Septic	9.None
Street	<b>1 Paved</b>	
1.Paved	4.Proposed	7.
2.Semi Imp	5.R/W	8.
3.Gravel	6.	9.None
FLOOD PLAIN	<b>0</b>	
CLASS	<b>1</b>	

Inspection Witnessed By:		
X		Date
No./Date	Description	Date Insp.

Notes:		
Validity		
1.Valid	4.Split	7.Changes
2.Related	5.Partial	8.Other
3.Distress	6.Exempt	9.
Verified		
1.Buyer	4.Agent	7.Family
2.Seller	5.Pub Rec	8.Other
3.Lender	6.MLS	9.

<b>Assessment Record</b>				
Year	Land	Buildings	Exempt	Total
2010	0	2,300	0	2,300
2011	0	2,300	0	2,300
2012	0	2,300	0	2,300
2013	0	2,300	0	2,300
2014	0	2,300	0	2,300
2015	0	16,600	0	16,600
2016	0	16,600	0	16,600
2017	0	16,600	0	16,600
2018	0	16,600	0	16,600

<b>Land Data</b>						
<b>Front Foot</b>	<b>Type</b>	<b>Effective</b>		<b>Influence</b>		<b>Influence Codes</b>
		<b>Frontage</b>	<b>Depth</b>	<b>Factor</b>	<b>Code</b>	
11.Regular Lot				%		1.Unimproved
12.Delta Triangle				%		2.Condition
13.Nabla Triangle				%		3.Topography
14.Rear Land				%		4.Size/Shape
15.Miscellaneous				%		5.Access
				%		6.Restricted
				%		7.Corner Infl
				%		8.Environment
				%		9.Fract Share
<b>Square Foot</b>		<b>Square Feet</b>				<b>Acres</b>
16.Regular Lot				%		32.Farmland Tilla
17.Class I Road				%		33.C R P
18.Class II Road				%		34.Softwood-Farm
19.Condominium				%		35.Mixed Wood-Far
20.Sound Value				%		36.Hardwood-Farm
				%		37.Softwood-TG
				%		38.Mixed Wood-TG
				%		39.Hardwood-TG
				%		40.Wasteland
				%		41.Gravel Pit
				%		42.Mobile Home Si
				%		43.Excess Indust
				%		44.Lot Improvemen
				%		45.Tower Site
				%		46.Miscellaneous
				%		47.Pavement
				%		48.Farmland Pastu
<b>Total Acreage</b>				0.00		

**Easton**

Map Lot 006-018

Account 688

Location RIVER DE CHUTE ROAD

Card 2 Of 6 9/27/2018

Building Style	SF Bsmt Living	Layout
1.Conv. 5.Garrison 9.Gambrel	Fin Bsmt Grade	1.Typical 4. 7.
2.Ranch 6.Split 10.Saltbox	OPEN-5-CUSTOMIZE	2.Inadeq 5. 8.
3.R Ranch 7.Contemp 11.Other	Heat Type <b>100%</b>	3.Horrid 6. 9.
4.Cape 8.Log 12.	1.HWBB/Rad 5.FWA 9.No Heat	Attic
Dwelling Units	2.HWCI 6.GravWA 10.	1.1/4 Fin 4.Full Fin 7.
Other Units	3.H Pump 7.Electric 11.	2.1/2 Fin 5.F/Stair 8.
Stories	4.Steam 8.F/Wall 12.	3.3/4 Fin 6. 9.None
1.1 4.1.5 7.	Cool Type <b>0%</b>	Insulation
2.2 5.1.75 8.	1.Refrig 4.W&C Air 7.	1.Full 4.Minimal 7.
3.3 6.2.5 9.	2.Evapor 5. 8.	2.Heavy 5.Partial 8.
Exterior Walls	3.H Pump 6. 9.None	3.Capped 6. 9.None
1.Wood 5.Stucco 9.Other	Kitchen Style	Unfinished %
2.Vin/Al 6.Brick 10.	1.Modern 4.Obsolete 7.	Grade & Factor
3.Compos. 7.Stone 11.	2.Typical 5. 8.	1.E Grade 4.B Grade 7.
4.Asbestos 8.Concrete 12.	3.Old Type 6. 9.None	2.D Grade 5.A Grade 8.SC Grade
Roof Surface	Bath(s) Style	3.C Grade 6.AA Grade 9.Same
1.Asphalt 4.Composit 7.	1.Modern 4.Obsolete 7.	SQFT (Footprint)
2.Slate 5.Wood 8.	2.Typical 5. 8.	Condition
3.Metal 6.Other 9.	3.Old Type 6. 9.None	1.Poor 4.Avg 7.V G
SF Masonry Trim	# Rooms	2.Fair 5.Avg+ 8.Exc
OPEN-3-CUSTOM	# Bedrooms	3.Avg- 6.Good 9.Same
OPEN-4-CUSTOM	# Full Baths	Phys. % Good
Year Built	# Half Baths	Funct. % Good
Year Remodeled	# Addn Fixtures	Functional Code
Foundation	# Fireplaces	1.Incomp 4.Bsmt 7.
1.Concrete 4.Wood 7.		2.O-Built 5. 8.LongTerm
2.C Block 5.Slab 8.		3.Damage 6.L-T Vaca 9.None
3.Br/Stone 6.Piers 9.		Econ. % Good
Basement		Economic Code
1.1/4 Bmt 4.Full Bmt 7.		0.None 3.No Power 7.
2.1/2 Bmt 5.None 8.		1.Location 4.Generate 8.
3.3/4 Bmt 6. 9.None		2.Encroach 9.None 9.
Bsmt Gar # Cars		Entrance Code <b>1 Interior Inspect</b>
Wet Basement		1.Interior 4.Vacant 7.
1.Dry 4. 7.		2.Refusal 5.Estimate 8.
2.Damp 5. 8.	3.Informed 6.Reviewed 9.	
3.Wet 6. 9.	Information Code <b>1 Owner</b>	
		1.Owner 4.Agent 7.
		2.Relative 5.Estimate 8.
		3.Tenant 6.Exterior 9.

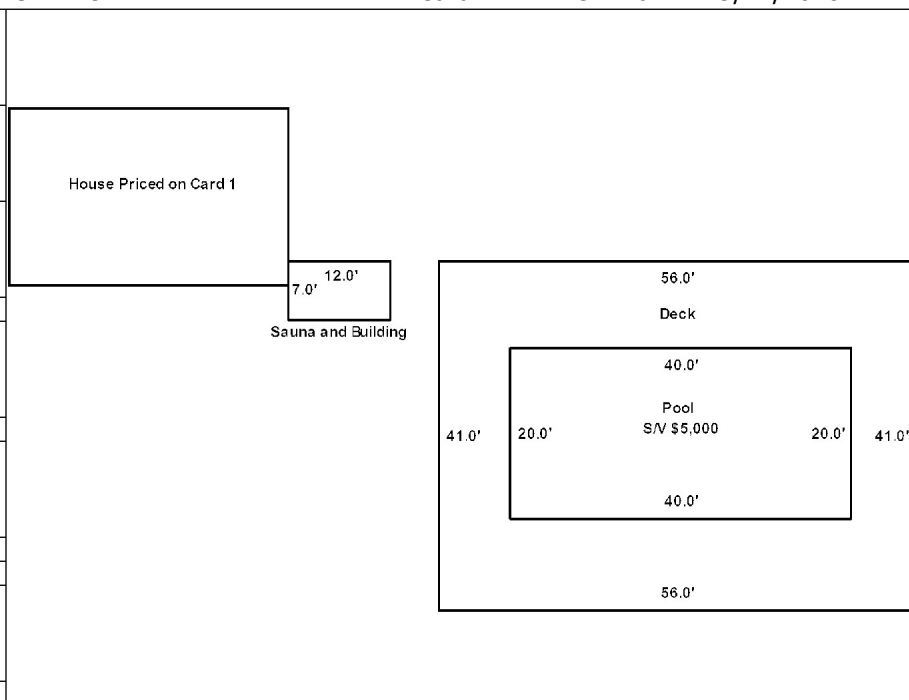

Date Inspected 6/30/2015

Additions, Outbuildings & Improvements								
Type	Year	Units	Grade	Cond	Phys.	Funct.	Sound Value	
7 Sauna & Building	1985	84	2 115	4	0 %	50 %		1.One Story Fram
68 Wood Deck	2010	1496	2 115	3	0 %	100 %		2.Two Story Fram
63 Swimming Pool	1985				%	%	5,000	3.Three Story Fr
					%	%		4.1 & 1/2 Story
					%	%		5.1 & 3/4 Story
					%	%		6.2 & 1/2 Story
					%	%		21.Open Frame Por
					%	%		22.Encl Frame Por
					%	%		23.Frame Garage
					%	%		24.Frame Shed
					%	%		25.Frame Bay Wind
					%	%		26.1SFr Overhang
					%	%		27.Unfin Basement
					%	%		28.Unfinished Att
					%	%		29.Finished Attic



**Easton**

Map Lot 006-018

Account 688

Location RIVER DE CHUTE ROAD

Card 3 Of 6 9/27/2018

Building Style <b>11 Other</b>	SF Bsmt Living <b>0</b>	Layout <b>1 Typical</b>
1.Conv. 5.Garrison 9.Gambrel	Fin Bsmt Grade <b>0 0</b>	1.Typical 4. 7.
2.Ranch 6.Split 10.Saltbox	OPEN-5-CUSTOMIZE <b>0</b>	2.Inadeq 5. 8.
3.R Ranch 7.Contemp 11.Other	Heat Type <b>100% 5 Forced Warm Air</b>	3.Horrid 6. 9.
4.Cape 8.Log 12.	1.HWBB/Rad 5.FWA 9.No Heat	Attic <b>9 None</b>
Dwelling Units <b>1</b>	2.HWCI 6.GravWA 10.	1.1/4 Fin 4.Full Fin 7.
Other Units <b>0</b>	3.H Pump 7.Electric 11.	2.1/2 Fin 5.F/Stair 8.
Stories <b>4 One &amp; 1/2 Story</b>	4.Steam 8.F/Wall 12.	3.3/4 Fin 6. 9.None
1.1 4.1.5 7.	Cool Type <b>0% 9 None</b>	Insulation <b>1 Full</b>
2.2 5.1.75 8.	1.Refrig 4.W&C Air 7.	1.Full 4.Minimal 7.
3.3 6.2.5 9.	2.Evapor 5. 8.	2.Heavy 5.Partial 8.
Exterior Walls <b>2 Vinyl/Aluminum</b>	3.H Pump 6. 9.None	3.Capped 6. 9.None
1.Wood 5.Stucco 9.Other	Kitchen Style <b>2 Typical</b>	Unfinished % <b>66%</b>
2.Vin/Al 6.Brick 10.	1.Modern 4.Obsolete 7.	Grade & Factor <b>2 Fair 110%</b>
3.Compos. 7.Stone 11.	2.Typical 5. 8.	1.E Grade 4.B Grade 7.
4.Asbestos 8.Concrete 12.	3.Old Type 6. 9.None	2.D Grade 5.A Grade 8.SC Grade
Roof Surface <b>1 Asphalt Shingles</b>	Bath(s) Style <b>2 Typical Bath(s)</b>	3.C Grade 6.AA Grade 9.Same
1.Asphalt 4.Composit 7.	1.Modern 4.Obsolete 7.	SQFT (Footprint) <b>720</b>
2.Slate 5.Wood 8.	2.Typical 5. 8.	Condition <b>4 Average</b>
3.Metal 6.Other 9.	3.Old Type 6. 9.None	1.Poor 4.Avg 7.V G
SF Masonry Trim <b>0</b>	# Rooms <b>2</b>	2.Fair 5.Avg+ 8.Exc
OPEN-3-CUSTOM <b>0</b>	# Bedrooms <b>1</b>	3.Avg- 6.Good 9.Same
OPEN-4-CUSTOM <b>0</b>	# Full Baths <b>1</b>	Phys. % Good <b>0%</b>
Year Built <b>1995</b>	# Half Baths <b>0</b>	Funct. % Good <b>100%</b>
Year Remodeled <b>0</b>	# Addn Fixtures <b>0</b>	Functional Code <b>9 None</b>
Foundation <b>5 Concrete Slab</b>	# Fireplaces <b>0</b>	1.Incomp 4.Bsmt 7.
1.Concrete 4.Wood 7.		2.O-Built 5. 8.LongTerm
2.C Block 5.Slab 8.		3.Damage 6.L-T Vaca 9.None
3.Br/Stone 6.Piers 9.		Econ. % Good <b>100%</b>
Basement <b>9 No Basement</b>		Economic Code <b>None</b>
1.1/4 Bmt 4.Full Bmt 7.		0.None 3.No Power 7.
2.1/2 Bmt 5.None 8.		1.Location 4.Generate 8.
3.3/4 Bmt 6. 9.None		2.Encroach 9.None 9.
Bsmt Gar # Cars <b>0</b>		Entrance Code <b>1 Interior Inspect</b>
Wet Basement <b>9 No Basement</b>		1.Interior 4.Vacant 7.
1.Dry 4. 7.		2.Refusal 5.Estimate 8.
2.Damp 5. 8.	3.Informed 6.Reviewed 9.	
3.Wet 6. 9.	Information Code <b>1 Owner</b>	
	1.Owner 4.Agent 7.	
	2.Relative 5.Estimate 8.	
	3.Tenant 6.Exterior 9.	

Date Inspected 6/30/2015

**Additions, Outbuildings & Improvements**

Type	Year	Units	Grade	Cond	Phys.	Funct.	Sound Value
68 Wood Deck	0	260	2 100	4	0 %	100 %	
					%	%	
					%	%	
					%	%	
					%	%	
					%	%	
					%	%	
					%	%	
					%	%	
					%	%	
					%	%	

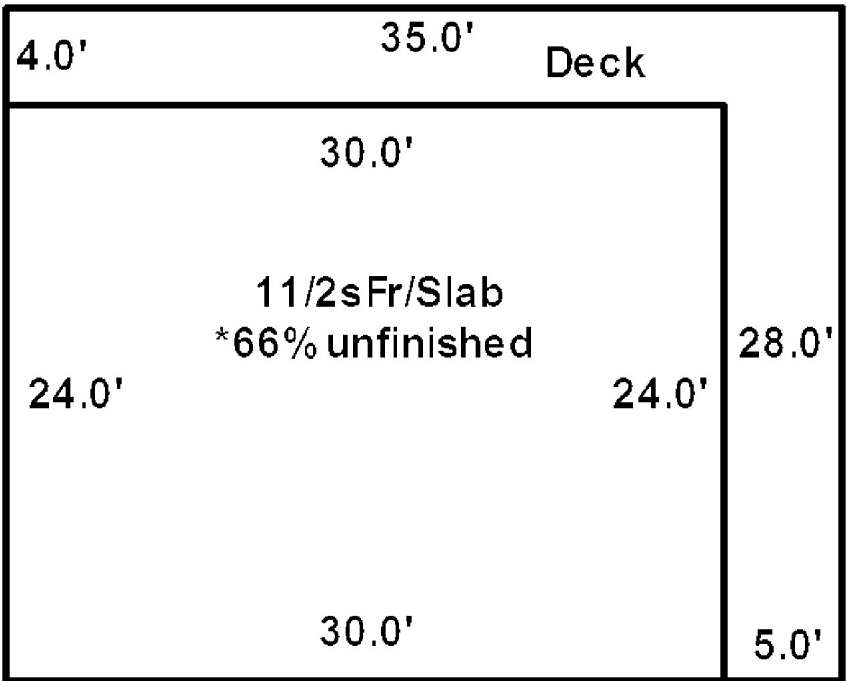



SIMS, WARREN F JR  
CENEDELLA, ARLENE J  
430 LADNER RD  
EASTON ME 04740

B1878P350 B5253P31

Inspection Witnessed By:

X	Date	Description	Date Insp.

Notes:  
Riding arena overbuilt for market -25% obs + 25% size obs=  
net -50%

Easton

Property Data			Assessment Record						
Neighborhood <b>1 Resident/Agric.</b>			Year	Land	Buildings	Exempt	Total		
Tree Growth Year <b>0</b>			2010	0	26,900	0	26,900		
Recertified Date <b>0</b>			2011	0	26,500	0	26,500		
Y Coordinate <b>0</b>			2012	0	26,200	0	26,200		
Zone/Land Use <b>11 Residential</b>			2013	0	25,800	0	25,800		
Secondary Zone			2014	0	25,300	0	25,300		
Topography <b>1 Level 2 Rolling</b>			2015	0	108,700	0	108,700		
1.Level 4.Below St 7.			2016	0	108,700	0	108,700		
2.Rolling 5.Low 8.			2017	0	108,700	0	108,700		
3.Above St 6.Swampy 9.			2018	0	108,700	0	108,700		
Utilities									
1.Public 4.Dr Well 7.Cesspool									
2.Water 5.Dug Well 8.									
3.Sewer 6.Septic 9.None									
Street <b>1 Paved</b>									
1.Paved 4.Proposed 7.									
2.Semi Imp 5.R/W 8.									
3.Gravel 6. 9.None									
FLOOD PLAIN <b>0</b>			<b>Land Data</b>						
CLASS <b>8</b>			<b>Front Foot</b>	<b>Type</b>	<b>Effective</b>		<b>Influence</b>		<b>Influence Codes</b>
<b>Sale Data</b>					Frontage	Depth	Factor	Code	
Sale Date			11.Regular Lot					1.Unimproved	
Price			12.Delta Triangle					2.Condition	
Sale Type			13.Nabla Triangle					3.Topography	
1.Land 4.Mobile 7.			14.Rear Land					4.Size/Shape	
2.L & B 5.Other 8.			15.Miscellaneous					5.Access	
3.Building 6. 9.								6.Restricted	
Financing								7.Corner Infl	
1.Convent 4.Seller 7.			<b>Square Foot</b>	<b>Square Feet</b>				8.Environment	
2.FHA/VA 5.Private 8.			16.Regular Lot					9.Fract Share	
3.Assumed 6.Cash 9.Unknown			17.Class I Road					<b>Acres</b>	
Validity			18.Class II Road					32.Farmland Tilla	
1.Valid 4.Split 7.Changes			19.Condominium					33.C R P	
2.Related 5.Partial 8.Other			20.Sound Value					34.Softwood-Farm	
3.Distress 6.Exempt 9.								35.Mixed Wood-Far	
Verified			<b>Fract. Acre</b>	<b>Acres/Sites</b>				36.Hardwood-Farm	
1.Buyer 4.Agent 7.Family			21.Homesite (Frac					37.Softwood-TG	
2.Seller 5.Pub Rec 8.Other			22.Baselot (Fract					38.Mixed Wood-TG	
3.Lender 6.MLS 9.			23.Misc (Fract)					39.Hardwood-TG	
			<b>Acres</b>					40.Wasteland	
			24.Homesite					41.Gravel Pit	
			25.Baselot					42.Mobile Home Si	
			26.Secondary					43.Excess Indust	
			27.Frontage					44.Lot Improvemen	
			28.Rear Land (All					45.Tower Site	
			31.Tillable					46.Miscellaneous	
			<b>Total Acreage</b>		0.00			47.Pavement	
								48.Farmland Pastu	

**Easton**

Map Lot 006-018

Account 688

Location RIVER DE CHUTE ROAD

Card 4

Of 6

9/27/2018

Building Style	SF Bsmt Living	Layout
1.Conv. 5.Garrison 9.Gambrel	Fin Bsmt Grade	1.Typical 4. 7.
2.Ranch 6.Split 10.Saltbox	OPEN-5-CUSTOMIZE	2.Inadeq 5. 8.
3.R Ranch 7.Contemp 11.Other	Heat Type <b>100%</b>	3.Horrid 6. 9.
4.Cape 8.Log 12.	1.HWBB/Rad 5.FWA 9.No Heat	Attic
Dwelling Units	2.HWCI 6.GravWA 10.	1.1/4 Fin 4.Full Fin 7.
Other Units	3.H Pump 7.Electric 11.	2.1/2 Fin 5.FI/Stair 8.
Stories	4.Steam 8.FI/Wall 12.	3.3/4 Fin 6. 9.None
1.1 4.1.5 7.	Cool Type <b>0%</b>	Insulation
2.2 5.1.75 8.	1.Refrig 4.W&C Air 7.	1.Full 4.Minimal 7.
3.3 6.2.5 9.	2.Evapor 5. 8.	2.Heavy 5.Partial 8.
Exterior Walls	3.H Pump 6. 9.None	3.Capped 6. 9.None
1.Wood 5.Stucco 9.Other	Kitchen Style	Unfinished %
2.Vin/Al 6.Brick 10.	1.Modern 4.Obsolete 7.	Grade & Factor
3.Compos. 7.Stone 11.	2.Typical 5. 8.	1.E Grade 4.B Grade 7.
4.Asbestos 8.Concrete 12.	3.Old Type 6. 9.None	2.D Grade 5.A Grade 8.SC Grade
Roof Surface	Bath(s) Style	3.C Grade 6.AA Grade 9.Same
1.Asphalt 4.Composit 7.	1.Modern 4.Obsolete 7.	SQFT (Footprint)
2.Slate 5.Wood 8.	2.Typical 5. 8.	Condition
3.Metal 6.Other 9.	3.Old Type 6. 9.None	1.Poor 4.Avg 7.V G
SF Masonry Trim	# Rooms	2.Fair 5.Avg+ 8.Exc
OPEN-3-CUSTOM	# Bedrooms	3.Avg- 6.Good 9.Same
OPEN-4-CUSTOM	# Full Baths	Phys. % Good
Year Built	# Half Baths	Funct. % Good
Year Remodeled	# Addn Fixtures	Functional Code
Foundation	# Fireplaces	1.Incomp 4.Bsmt 7.
1.Concrete 4.Wood 7.		2.O-Built 5. 8.LongTerm
2.C Block 5.Slab 8.		3.Damage 6.L-T Vaca 9.None
3.Br/Stone 6.Piers 9.		Econ. % Good
Basement		Economic Code
1.1/4 Bmt 4.Full Bmt 7.		0.None 3.No Power 7.
2.1/2 Bmt 5.None 8.		1.Location 4.Generate 8.
3.3/4 Bmt 6. 9.None		2.Encroach 9.None 9.
Bsmt Gar # Cars		Entrance Code <b>1 Interior Inspect</b>
Wet Basement		1.Interior 4.Vacant 7.
1.Dry 4. 7.		2.Refusal 5.Estimate 8.
2.Damp 5. 8.	3.Informed 6.Reviewed 9.	
3.Wet 6. 9.	Information Code <b>1 Owner</b>	
	1.Owner 4.Agent 7.	
	2.Relative 5.Estimate 8.	
	3.Tenant 6.Exterior 9.	

Date Inspected 6/30/2015

**Additions, Outbuildings & Improvements**

Type	Year	Units	Grade	Cond	Phys.	Funct.	Sound Value
692 Riding Arena /0	1988	7200	2 100	4	0 %	50 %	
61 Canopy	1988	2400	2 100	4	0 %	75 %	
61 Canopy	1993	192	2 100	4	0 %	100 %	
1 One Story Frame	1993	400	2 100	4	0 %	100 %	
21 Open Frame	1993	160	2 100	4	0 %	100 %	
24 Frame Shed	1993	400	3 100	4	0 %	80 %	
24 Frame Shed	1988	2720	2 100	4	0 %	55 %	
					%	%	
					%	%	
					%	%	

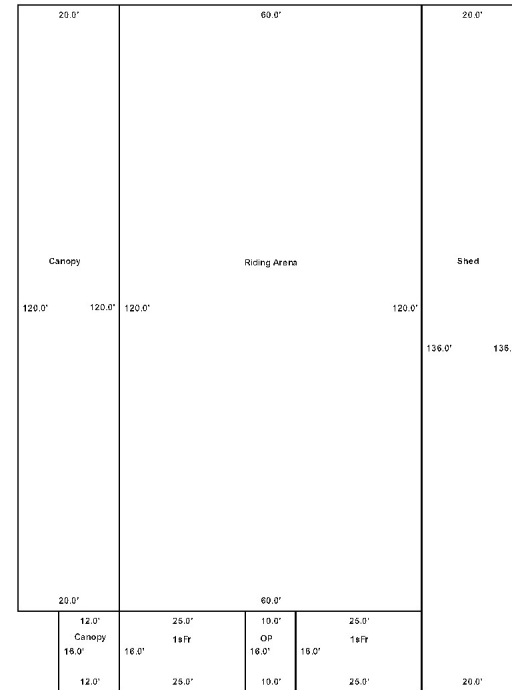

SIMS, WARREN F JR  
CENEDELLA, ARLENE J  
430 LADNER RD  
EASTON ME 04740

B1878P350 B5253P31

Inspection Witnessed By:

No./Date	Description	Date Insp.
X		

Notes:

Easton

Property Data			Assessment Record						
Neighborhood <b>1 Resident/Agric.</b>			Year	Land	Buildings	Exempt	Total		
Tree Growth Year <b>0</b>			2010	0	9,000	0	9,000		
Recertified Date <b>0</b>			2011	0	8,900	0	8,900		
Y Coordinate <b>0</b>			2012	0	8,900	0	8,900		
Zone/Land Use <b>11 Residential</b>			2013	0	8,800	0	8,800		
Secondary Zone			2014	0	8,800	0	8,800		
Topography <b>1 Level 2 Rolling</b>			2015	0	31,400	0	31,400		
1.Level 4.Below St 7.			2016	0	31,400	0	31,400		
2.Rolling 5.Low 8.			2017	0	31,400	0	31,400		
3.Above St 6.Swampy 9.			2018	0	31,400	0	31,400		
Utilities									
1.Public 4.Dr Well 7.Cesspool									
2.Water 5.Dug Well 8.									
3.Sewer 6.Septic 9.None									
Street <b>1 Paved</b>									
1.Paved 4.Proposed 7.									
2.Semi Imp 5.R/W 8.									
3.Gravel 6. 9.None									
FLOOD PLAIN <b>0</b>									
CLASS <b>8</b>									
Sale Data			Land Data						
Sale Date			Front Foot	Type	Effective		Influence		Influence Codes
Price			11.Regular Lot		Frontage	Depth	Factor	Code	
Sale Type			12.Delta Triangle				%		1.Unimproved
1.Land 4.Mobile 7.			13.Nabla Triangle				%		2.Condition
2.L & B 5.Other 8.			14.Rear Land				%		3.Topography
3.Building 6. 9.			15.Miscellaneous				%		4.Size/Shape
Financing							%		5.Access
1.Convent 4.Seller 7.							%		6.Restricted
2.FHA/VA 5.Private 8.							%		7.Corner Infl
3.Assumed 6.Cash 9.Unknown							%		8.Environment
Validity							%		9.Fract Share
1.Valid 4.Split 7.Changes			Square Foot	Square Feet					32.Farmland Tilla
2.Related 5.Partial 8.Other			16.Regular Lot				%		33.C R P
3.Distress 6.Exempt 9.			17.Class I Road				%		34.Softwood-Farm
Verified			18.Class II Road				%		35.Mixed Wood-Far
1.Buyer 4.Agent 7.Family			19.Condominium				%		36.Hardwood-Farm
2.Seller 5.Pub Rec 8.Other			20.Sound Value				%		37.Softwood-TG
3.Lender 6.MLS 9.							%		38.Mixed Wood-TG
			Fract. Acre	Acreage/Sites					39.Hardwood-TG
			21.Homesite (Frac)				%		40.Wasteland
			22.Baselot (Frac)				%		41.Gravel Pit
			23.Misc (Fract)				%		42.Mobile Home Si
			Acres				%		43.Excess Indust
			24.Homesite				%		44.Lot Improvemen
			25.Baselot				%		45.Tower Site
			26.Secondary				%		46.Miscellaneous
			27.Frontage				%		47.Pavement
			28.Rear Land (All				%		48.Farmland Pastu
			31.Tillable				%		
					<b>Total Acreage</b>	<b>0.00</b>			

**Easton**

Map Lot 006-018

Account 688

Location RIVER DE CHUTE ROAD

Card 5

Of 6

9/27/2018

Building Style	SF Bsmt Living	Layout
1.Conv. 5.Garrison 9.Gambrel	Fin Bsmt Grade	1.Typical 4. 7.
2.Ranch 6.Split 10.Saltbox	OPEN-5-CUSTOMIZE	2.Inadeq 5. 8.
3.R Ranch 7.Contemp 11.Other	Heat Type <b>100%</b>	3.Horrid 6. 9.
4.Cape 8.Log 12.	1.HWBB/Rad 5.FWA 9.No Heat	Attic
Dwelling Units	2.HWCI 6.GravWA 10.	1.1/4 Fin 4.Full Fin 7.
Other Units	3.H Pump 7.Electric 11.	2.1/2 Fin 5.F/Stair 8.
Stories	4.Steam 8.F/Wall 12.	3.3/4 Fin 6. 9.None
1.1 4.1.5 7.	Cool Type <b>0%</b>	Insulation
2.2 5.1.75 8.	1.Refrig 4.W&C Air 7.	1.Full 4.Minimal 7.
3.3 6.2.5 9.	2.Evapor 5. 8.	2.Heavy 5.Partial 8.
Exterior Walls	3.H Pump 6. 9.None	3.Capped 6. 9.None
1.Wood 5.Stucco 9.Other	Kitchen Style	Unfinished %
2.Vin/Al 6.Brick 10.	1.Modern 4.Obsolete 7.	Grade & Factor
3.Compos. 7.Stone 11.	2.Typical 5. 8.	1.E Grade 4.B Grade 7.
4.Asbestos 8.Concrete 12.	3.Old Type 6. 9.None	2.D Grade 5.A Grade 8.SC Grade
Roof Surface	Bath(s) Style	3.C Grade 6.AA Grade 9.Same
1.Asphalt 4.Composit 7.	1.Modern 4.Obsolete 7.	SQFT (Footprint)
2.Slate 5.Wood 8.	2.Typical 5. 8.	Condition
3.Metal 6.Other 9.	3.Old Type 6. 9.None	1.Poor 4.Avg 7.V G
SF Masonry Trim	# Rooms	2.Fair 5.Avg+ 8.Exc
OPEN-3-CUSTOM	# Bedrooms	3.Avg- 6.Good 9.Same
OPEN-4-CUSTOM	# Full Baths	Phys. % Good
Year Built	# Half Baths	Funct. % Good
Year Remodeled	# Addn Fixtures	Functional Code
Foundation	# Fireplaces	1.Incomp 4.Bsmt 7.
1.Concrete 4.Wood 7.	 <p><b>TRIO</b> Software A Division of Harris Computer Systems</p>	2.O-Built 5. 8.LongTerm
2.C Block 5.Slab 8.		3.Damage 6.L-T Vaca 9.None
3.Br/Stone 6.Piers 9.		Econ. % Good
Basement		Economic Code
1.1/4 Bmt 4.Full Bmt 7.		0.None 3.No Power 7.
2.1/2 Bmt 5.None 8.		1.Location 4.Generate 8.
3.3/4 Bmt 6. 9.None		2.Encroach 9.None 9.
Bsmt Gar # Cars		Entrance Code <b>1 Interior Inspect</b>
Wet Basement		1.Interior 4.Vacant 7.
1.Dry 4. 7.		2.Refusal 5.Estimate 8.
2.Damp 5. 8.	3.Informed 6.Reviewed 9.	
3.Wet 6. 9.	Information Code <b>1 Owner</b>	
	1.Owner 4.Agent 7.	
	2.Relative 5.Estimate 8.	
	3.Tenant 6.Exterior 9.	

Date Inspected 6/30/2015

**Additions, Outbuildings & Improvements**

Type	Year	Units	Grade	Cond	Phys.	Funct.	Sound Value
73 2 Story Barn	1900	1260	2 100	4	0 %	75 %	
24 Frame Shed	1977	165	2 100	4	0 %	80 %	
61 Canopy	1977	698	2 100	4	0 %	100 %	
24 Frame Shed	1977	520	2 100	4	0 %	80 %	
23 Frame Garage	1977	840	2 100	4	0 %	80 %	
					%	%	
					%	%	
					%	%	
					%	%	
					%	%	
					%	%	

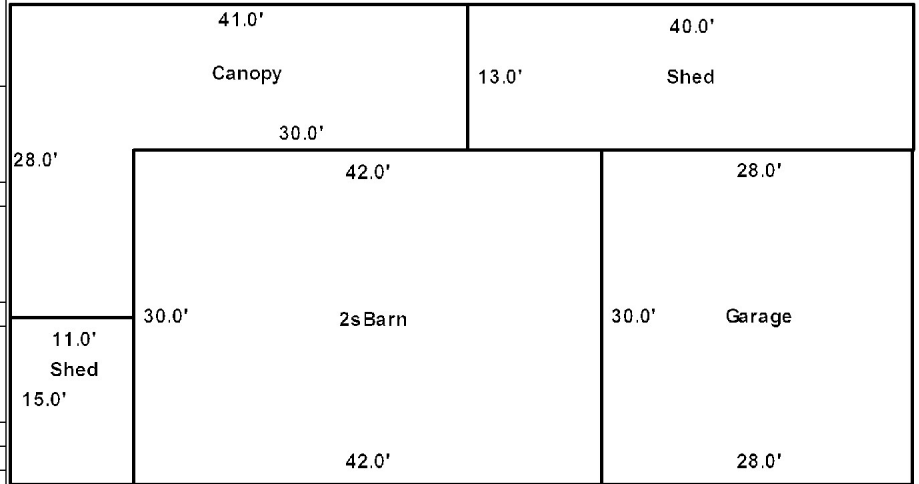







**Easton**

Map Lot 006-018-A

Account 793

Location 424 LADNER ROAD

Card 1 Of 2 9/27/2018

Building Style <b>11 Other</b>	SF Bsmt Living <b>0</b>	Layout <b>2 Inadequate</b>
1.Conv. 5.Garrison 9.Gambrel	Fin Bsmt Grade <b>0 0</b>	1.Typical 4. 7.
2.Ranch 6.Split 10.Saltbox	OPEN-5-CUSTOMIZE <b>0</b>	2.Inadeq 5. 8.
3.R Ranch 7.Contemp 11.Other	Heat Type <b>0% 9 Not Heated</b>	3.Horrid 6. 9.
4.Cape 8.Log 12.	1.HWBB/Rad 5.FWA 9.No Heat	Attic <b>9 None</b>
Dwelling Units <b>1</b>	2.HWCI 6.GravWA 10.	1.1/4 Fin 4.Full Fin 7.
Other Units <b>0</b>	3.H Pump 7.Electric 11.	2.1/2 Fin 5.FI/Stair 8.
Stories <b>1 One Story</b>	4.Steam 8.FI/Wall 12.	3.3/4 Fin 6. 9.None
1.1 4.1.5 7.	Cool Type <b>0% 9 None</b>	Insulation <b>1 Full</b>
2.2 5.1.75 8.	1.Refrig 4.W&C Air 7.	1.Full 4.Minimal 7.
3.3 6.2.5 9.	2.Evapor 5. 8.	2.Heavy 5.Partial 8.
Exterior Walls <b>9 Other</b>	3.H Pump 6. 9.None	3.Capped 6. 9.None
1.Wood 5.Stucco 9.Other	Kitchen Style <b>2 Typical</b>	Unfinished % <b>0%</b>
2.Vin/Al 6.Brick 10.	1.Modern 4.Obsolete 7.	Grade & Factor <b>1 Low 110%</b>
3.Compos. 7.Stone 11.	2.Typical 5. 8.	1.E Grade 4.B Grade 7.
4.Asbestos 8.Concrete 12.	3.Old Type 6. 9.None	2.D Grade 5.A Grade 8.SC Grade
Roof Surface <b>1 Asphalt Shingles</b>	Bath(s) Style <b>2 Typical Bath(s)</b>	3.C Grade 6.AA Grade 9.Same
1.Asphalt 4.Composit 7.	1.Modern 4.Obsolete 7.	SQFT (Footprint) <b>384</b>
2.Slate 5.Wood 8.	2.Typical 5. 8.	Condition <b>4 Average</b>
3.Metal 6.Other 9.	3.Old Type 6. 9.None	1.Poor 4.Avg 7.V G
SF Masonry Trim <b>0</b>	# Rooms <b>2</b>	2.Fair 5.Avg+ 8.Exc
OPEN-3-CUSTOM <b>0</b>	# Bedrooms <b>1</b>	3.Avg- 6.Good 9.Same
OPEN-4-CUSTOM <b>0</b>	# Full Baths <b>1</b>	Phys. % Good <b>0%</b>
Year Built <b>2009</b>	# Half Baths <b>0</b>	Funct. % Good <b>65%</b>
Year Remodeled <b>0</b>	# Addn Fixtures <b>0</b>	Functional Code <b>1 Incomplete</b>
Foundation <b>6 Piers</b>	# Fireplaces <b>0</b>	1.Incomp 4.Bsmt 7.
1.Concrete 4.Wood 7.	 <p><b>TRIO</b> Software A Division of Harris Computer Systems</p>	2.O-Built 5. 8.LongTerm
2.C Block 5.Slab 8.		3.Damage 6.L-T Vaca 9.None
3.Br/Stone 6.Piers 9.		Econ. % Good <b>100%</b>
Basement <b>9 No Basement</b>		Economic Code <b>None</b>
1.1/4 Bmt 4.Full Bmt 7.		0.None 3.No Power 7.
2.1/2 Bmt 5.None 8.		1.Location 4.Generate 8.
3.3/4 Bmt 6. 9.None		2.Encroach 9.None 9.
Bsmt Gar # Cars <b>0</b>		Entrance Code <b>1 Interior Inspect</b>
Wet Basement <b>9 No Basement</b>		1.Interior 4.Vacant 7.
1.Dry 4. 7.		2.Refusal 5.Estimate 8.
2.Damp 5. 8.	3.Informed 6.Reviewed 9.	
3.Wet 6. 9.	Information Code <b>1 Owner</b>	
		1.Owner 4.Agent 7.
		2.Relative 5.Estimate 8.
		3.Tenant 6.Exterior 9.

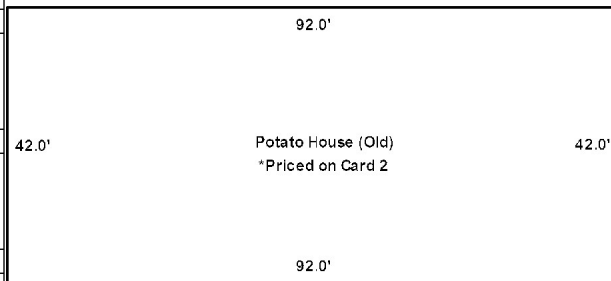
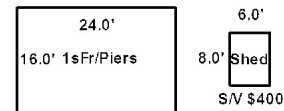

Date Inspected 6/30/2015

**Additions, Outbuildings & Improvements**

Type	Year	Units	Grade	Cond	Phys.	Funct.	Sound Value
24 Frame Shed	0				%	%	400
					%	%	
					%	%	
					%	%	
					%	%	
					%	%	
					%	%	
					%	%	
					%	%	
					%	%	
					%	%	



- 1.One Story Fram
- 2.Two Story Fram
- 3.Three Story Fr
- 4.1 & 1/2 Story
- 5.1 & 3/4 Story
- 6.2 & 1/2 Story
- 21.Open Frame Por
- 22.Encl Frame Por
- 23.Frame Garage
- 24.Frame Shed
- 25.Frame Bay Wind
- 26.1SFr Overhang
- 27.Unfin Basement
- 28.Unfinished Att
- 29.Finished Attic





**Easton**

Map Lot 006-018-A

Account 793

Location 424 LADNER ROAD

Card 2 Of 2 9/27/2018

Building Style	SF Bsmt Living	Layout
1.Conv. 5.Garrison 9.Gambrel	Fin Bsmt Grade	1.Typical 4. 7.
2.Ranch 6.Split 10.Saltbox	OPEN-5-CUSTOMIZE	2.Inadeq 5. 8.
3.R Ranch 7.Contemp 11.Other	Heat Type 0%	3.Horrid 6. 9.
4.Cape 8.Log 12.	1.HWBB/Rad 5.FWA 9.No Heat	Attic
Dwelling Units	2.HWCI 6.GravWA 10.	1.1/4 Fin 4.Full Fin 7.
Other Units	3.H Pump 7.Electric 11.	2.1/2 Fin 5.F/Stair 8.
Stories	4.Steam 8.F/Wall 12.	3.3/4 Fin 6. 9.None
1.1 4.1.5 7.	Cool Type 0%	Insulation
2.2 5.1.75 8.	1.Refrig 4.W&C Air 7.	1.Full 4.Minimal 7.
3.3 6.2.5 9.	2.Evapor 5. 8.	2.Heavy 5.Partial 8.
Exterior Walls	3.H Pump 6. 9.None	3.Capped 6. 9.None
1.Wood 5.Stucco 9.Other	Kitchen Style	Unfinished %
2.Vin/Al 6.Brick 10.	1.Modern 4.Obsolete 7.	Grade & Factor
3.Compos. 7.Stone 11.	2.Typical 5. 8.	1.E Grade 4.B Grade 7.
4.Asbestos 8.Concrete 12.	3.Old Type 6. 9.None	2.D Grade 5.A Grade 8.SC Grade
Roof Surface	Bath(s) Style	3.C Grade 6.AA Grade 9.Same
1.Asphalt 4.Composit 7.	1.Modern 4.Obsolete 7.	SQFT (Footprint)
2.Slate 5.Wood 8.	2.Typical 5. 8.	Condition
3.Metal 6.Other 9.	3.Old Type 6. 9.None	1.Poor 4.Avg 7.V G
SF Masonry Trim	# Rooms	2.Fair 5.Avg+ 8.Exc
OPEN-3-CUSTOM	# Bedrooms	3.Avg- 6.Good 9.Same
OPEN-4-CUSTOM	# Full Baths	Phys. % Good
Year Built	# Half Baths	Funct. % Good
Year Remodeled	# Addn Fixtures	Functional Code
Foundation	# Fireplaces	1.Incomp 4.Bsmt 7.
1.Concrete 4.Wood 7.	 <p><b>TRIO</b> Software A Division of Harris Computer Systems</p>	2.O-Built 5. 8.LongTerm
2.C Block 5.Slab 8.		3.Damage 6.L-T Vaca 9.None
3.Br/Stone 6.Piers 9.		Econ. % Good
Basement		Economic Code
1.1/4 Bmt 4.Full Bmt 7.		0.None 3.No Power 7.
2.1/2 Bmt 5.None 8.		1.Location 4.Generate 8.
3.3/4 Bmt 6. 9.None		2.Encroach 9.None 9.
Bsmt Gar # Cars		Entrance Code 1 Interior Inspect
Wet Basement		1.Interior 4.Vacant 7.
1.Dry 4. 7.		2.Refusal 5.Estimate 8.
2.Damp 5. 8.	3.Informed 6.Reviewed 9.	
3.Wet 6. 9.	Information Code 1 Owner	
	1.Owner 4.Agent 7.	
	2.Relative 5.Estimate 8.	
	3.Tenant 6.Exterior 9.	

Date Inspected 6/30/2015

**Additions, Outbuildings & Improvements**

Type	Year	Units	Grade	Cond	Phys.	Funct.	Sound Value
351 Pot.Hse (Old)	1940	3864	3 100	1	0 %	25 %	
					%	%	
					%	%	
					%	%	
					%	%	
					%	%	
					%	%	
					%	%	
					%	%	
					%	%	
					%	%	
					%	%	
					%	%	
					%	%	
					%	%	
					%	%	
					%	%	
					%	%	
					%	%	
					%	%	

House Priced on Card 1

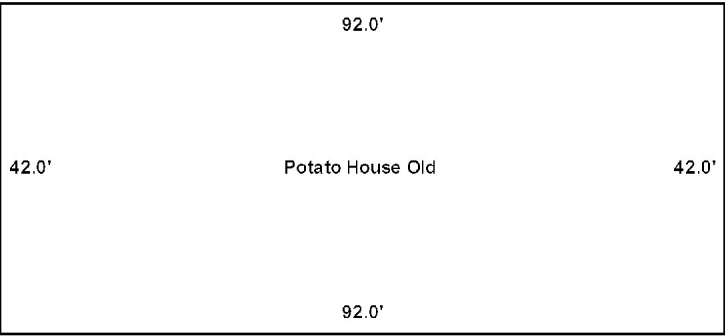

GINGERICH, SAMUEL  
 GINGERICH, MATTIE D  
 C/O SIMS, WARREN F JR  
 430 LADNER RD  
 EASTON ME 04740

			Property Data			Assessment Record						
			Neighborhood	1 Resident/Agric.		Year	Land	Buildings	Exempt	Total		
			Tree Growth Year 0			2014	0	36,300	0	36,300		
			Recertified Date 0			2015	0	43,500	0	43,500		
			Zone/Land Use 11 Residential			2016	0	43,500	0	43,500		
			Secondary Zone			2017	0	43,500	0	43,500		
			Topography 2 Rolling			2018	0	43,500	0	43,500		
			1.Level 4.Below St 7. 2.Rolling 5.Low 8. 3.Above St 6.Swampy 9.									
			Utilities 9 None									
			1.Public 4.Dr Well 7.Cesspool 2.Water 5.Dug Well 8. 3.Sewer 6.Septic 9.None									
			Street 1 Paved									
			1.Paved 4.Proposed 7. 2.Semi Imp 5.R/W 8. 3.Gravel 6. 9.None									
			FLOOD PLAIN 0			<b>Land Data</b>						
			CLASS 0									
Inspection Witnessed By:			<b>Sale Data</b>			11.Regular Lot	Type	Effective		Influence		Influence Codes
								Sale Date	Frontage	Depth	Factor	
X			Date			12.Delta Triangle						1.Unimproved
No./Date	Description	Date Insp.	Sale Type	14.Rear Land							3.Topography	
			1.Land 4.Mobile 7.									15.Miscellaneous
			2.L & B 5.Other 8.	Square Foot		Square Feet				5.Access		
			3.Building 6. 9.	16.Regular Lot							6.Restricted	
			Financing									17.Class I Road
			1.Convent 4.Seller 7.	18.Class II Road							8.Environment	
			2.FHA/VA 5.Private 8.									19.Condominium
			3.Assumed 6.Cash 9.Unknown	20.Sound Value							32.Farmland Tilla	
			Validity									21.Homesite (Fract)
			1.Valid 4.Split 7.Changes	22.Baslot (Fract)							34.Softwood-Farm	
			2.Related 5.Partial 8.Other									23.Misc (Fract)
			3.Distress 6.Exempt 9.	Acres							36.Hardwood-Farm	
			Verified									24.Homesite
			1.Buyer 4.Agent 7.Family	25.Baslot							38.Mixed Wood-TG	
			2.Seller 5.Pub Rec 8.Other									26.Secondary
			3.Lender 6.MLS 9.	27.Frontage							40.Wasteland	
												28.Rear Land (All)
				31.Tillable							42.Mobile Home Si	
												<b>Total Acreage</b>
										44.Lot Improvemen		
										45.Tower Site		
										46.Miscellaneous		
										47.Pavement		
										48.Farmland Pastu		

**Easton**

Map Lot 006-018-ON

Account 925

Location 430 LADNER RD

Card 1 Of 1 9/27/2018

Building Style	SF Bsmt Living	Layout
1.Conv. 5.Garrison 9.Gambrel	Fin Bsmt Grade	1.Typical 4. 7.
2.Ranch 6.Split 10.Saltbox	OPEN-5-CUSTOMIZE	2.Inadeq 5. 8.
3.R Ranch 7.Contemp 11.Other	Heat Type 0%	3.Horrid 6. 9.
4.Cape 8.Log 12.	1.HWBB/Rad 5.FWA 9.No Heat	Attic
Dwelling Units	2.HWCI 6.GravWA 10.	1.1/4 Fin 4.Full Fin 7.
Other Units	3.H Pump 7.Electric 11.	2.1/2 Fin 5.F/Stair 8.
Stories	4.Steam 8.F/Wall 12.	3.3/4 Fin 6. 9.None
1.1 4.1.5 7.	Cool Type 0%	Insulation
2.2 5.1.75 8.	1.Refrig 4.W&C Air 7.	1.Full 4.Minimal 7.
3.3 6.2.5 9.	2.Evapor 5. 8.	2.Heavy 5.Partial 8.
Exterior Walls	3.H Pump 6. 9.None	3.Capped 6. 9.None
1.Wood 5.Stucco 9.Other	Kitchen Style	Unfinished %
2.Vin/Al 6.Brick 10.	1.Modern 4.Obsolete 7.	Grade & Factor
3.Compos. 7.Stone 11.	2.Typical 5. 8.	1.E Grade 4.B Grade 7.
4.Asbestos 8.Concrete 12.	3.Old Type 6. 9.None	2.D Grade 5.A Grade 8.SC Grade
Roof Surface	Bath(s) Style	3.C Grade 6.AA Grade 9.Same
1.Asphalt 4.Composit 7.	1.Modern 4.Obsolete 7.	SQFT (Footprint)
2.Slate 5.Wood 8.	2.Typical 5. 8.	Condition
3.Metal 6.Other 9.	3.Old Type 6. 9.None	1.Poor 4.Avg 7.V G
SF Masonry Trim	# Rooms	2.Fair 5.Avg+ 8.Exc
OPEN-3-CUSTOM	# Bedrooms	3.Avg- 6.Good 9.Same
OPEN-4-CUSTOM	# Full Baths	Phys. % Good
Year Built	# Half Baths	Funct. % Good
Year Remodeled	# Addn Fixtures	Functional Code
Foundation	# Fireplaces	1.Incomp 4.Bsmt 7.
1.Concrete 4.Wood 7.		2.O-Built 5. 8.LongTerm
2.C Block 5.Slab 8.		3.Damage 6.L-T Vaca 9.None
3.Br/Stone 6.Piers 9.		Econ. % Good
Basement		Economic Code
1.1/4 Bmt 4.Full Bmt 7.		0.None 3.No Power 7.
2.1/2 Bmt 5.None 8.		1.Location 4.Generate 8.
3.3/4 Bmt 6. 9.None		2.Encroach 9.None 9.
Bsmt Gar # Cars		Entrance Code 1 Interior Inspect
Wet Basement		1.Interior 4.Vacant 7.
1.Dry 4. 7.		2.Refusal 5.Estimate 8.
2.Damp 5. 8.	3.Informed 6.Reviewed 9.	
3.Wet 6. 9.	Information Code 1 Owner	
	1.Owner 4.Agent 7.	
	2.Relative 5.Estimate 8.	
	3.Tenant 6.Exterior 9.	

Date Inspected 6/30/2015

**Additions, Outbuildings & Improvements**

Type	Year	Units	Grade	Cond	Phys.	Funct.	Sound Value
80 1.5 S-Gar	2013	1872	3 100	4	0 %	75 %	
21 Open Frame	2013	296	3 100	4	0 %	100 %	
22 Encl Frame Porch	2013	280	3 100	4	0 %	100 %	
					%	%	
					%	%	
					%	%	
					%	%	
					%	%	
					%	%	
					%	%	
					%	%	
					%	%	

