

VARNUM, MARK S (TRUSTEE)
 11 BANGOR MALL BLVD
 BANGOR ME 04401

B5196P22

Previous Owner
 VARNUM, MARK S
 840 KENNEDY MEMORIAL DRIVE

OAKLAND ME 04963
 Sale Date: 3/20/2013

Property Data			Assessment Record				
Neighborhood 1 Resident/Agric.			Year	Land	Buildings	Exempt	Total
Tree Growth Year 0			2010	10,600	0	0	10,600
Recertified Date 0			2011	10,600	0	0	10,600
Y Coordinate 0			2012	10,600	0	0	10,600
Zone/Land Use 11 Residential			2013	10,600	0	0	10,600
Secondary Zone			2014	10,600	0	0	10,600
Topography 2 Rolling			2015	28,500	0	0	28,500
1.Level 4.Below St 7.			2016	28,500	0	0	28,500
2.Rolling 5.Low 8.			2017	28,500	0	0	28,500
3.Above St 6.Swampy 9.			2018	28,500	0	0	28,500
Utilities 9 None							
1.Public 4.Dr Well 7.Cesspool							
2.Water 5.Dug Well 8.							
3.Sewer 6.Septic 9.None							
Street 3 Gravel							
1.Paved 4.Proposed 7.							
2.Semi Imp 5.R/W 8.							
3.Gravel 6. 9.None							
FLOOD PLAIN 0							
CLASS 1							
Sale Data							
Sale Date							
Price							
Sale Type							
1.Land 4.Mobile 7.							
2.L & B 5.Other 8.							
3.Building 6. 9.							
Financing							
1.Convent 4.Seller 7.							
2.FHA/VA 5.Private 8.							
3.Assumed 6.Cash 9.Unknown							
Validity							
1.Valid 4.Split 7.Changes							
2.Related 5.Partial 8.Other							
3.Distress 6.Exempt 9.							
Verified							
1.Buyer 4.Agent 7.Family							
2.Seller 5.Pub Rec 8.Other							
3.Lender 6.MLS 9.							

Inspection Witnessed By:

No./Date	Description	Date Insp.
X		

Notes:

Easton

Land Data						
Front Foot	Type	Effective		Influence		Influence Codes
		Frontage	Depth	Factor	Code	
11.Regular Lot				%		1.Unimproved
12.Delta Triangle				%		2.Condition
13.Nabla Triangle				%		3.Topography
14.Rear Land				%		4.Size/Shape
15.Miscellaneous				%		5.Access
				%		6.Restricted
				%		7.Corner Infl
				%		8.Environment
				%		9.Fract Share
Square Foot		Square Feet				Acres
16.Regular Lot				%		32.Farmland Tilla
17.Class I Road				%		33.C R P
18.Class II Road				%		34.Softwood-Farm
19.Condominium				%		35.Mixed Wood-Far
20.Sound Value				%		36.Hardwood-Farm
				%		37.Softwood-TG
				%		38.Mixed Wood-TG
25		1.00		100 %	0	39.Hardwood-TG
28		38.00		100 %	0	40.Wasteland
				%		41.Gravel Pit
				%		42.Mobile Home Si
				%		43.Excess Indust
				%		44.Lot Improvemen
				%		45.Tower Site
				%		46.Miscellaneous
				%		47.Pavement
				%		48.Farmland Pastu
Total Acreage				39.00		

Easton

Map Lot 003-021

Account 796

Location MAHANY ROAD

Card 1 Of 1 9/27/2018

Building Style	SF Bsmt Living	Layout
1.Conv. 5.Garrison 9.Gambrel	Fin Bsmt Grade	1.Typical 4. 7.
2.Ranch 6.Split 10.Saltbox	OPEN-5-CUSTOMIZE	2.Inadeq 5. 8.
3.R Ranch 7.Contemp 11.Other	Heat Type 100%	3.Horrid 6. 9.
4.Cape 8.Log 12.	1.HWBB/Rad 5.FWA 9.No Heat	Attic
Dwelling Units	2.HWCI 6.GravWA 10.	1.1/4 Fin 4.Full Fin 7.
Other Units	3.H Pump 7.Electric 11.	2.1/2 Fin 5.F/Stair 8.
Stories	4.Steam 8.F/Wall 12.	3.3/4 Fin 6. 9.None
1.1 4.1.5 7.	Cool Type 0%	Insulation
2.2 5.1.75 8.	1.Refrig 4.W&C Air 7.	1.Full 4.Minimal 7.
3.3 6.2.5 9.	2.Evapor 5. 8.	2.Heavy 5.Partial 8.
Exterior Walls	3.H Pump 6. 9.None	3.Capped 6. 9.None
1.Wood 5.Stucco 9.Other	Kitchen Style	Unfinished %
2.Vin/Al 6.Brick 10.	1.Modern 4.Obsolete 7.	Grade & Factor
3.Compos. 7.Stone 11.	2.Typical 5. 8.	1.E Grade 4.B Grade 7.
4.Asbestos 8.Concrete 12.	3.Old Type 6. 9.None	2.D Grade 5.A Grade 8.SC Grade
Roof Surface	Bath(s) Style	3.C Grade 6.AA Grade 9.Same
1.Asphalt 4.Composit 7.	1.Modern 4.Obsolete 7.	SQFT (Footprint)
2.Slate 5.Wood 8.	2.Typical 5. 8.	Condition
3.Metal 6.Other 9.	3.Old Type 6. 9.None	1.Poor 4.Avg 7.V G
SF Masonry Trim	# Rooms	2.Fair 5.Avg+ 8.Exc
OPEN-3-CUSTOM	# Bedrooms	3.Avg- 6.Good 9.Same
OPEN-4-CUSTOM	# Full Baths	Phys. % Good
Year Built	# Half Baths	Funct. % Good
Year Remodeled	# Addn Fixtures	Functional Code
Foundation	# Fireplaces	1.Incomp 4.Bsmt 7.
1.Concrete 4.Wood 7.		2.O-Built 5. 8.LongTerm
2.C Block 5.Slab 8.		3.Damage 6.L-T Vaca 9.None
3.Br/Stone 6.Piers 9.		Econ. % Good
Basement		Economic Code
1.1/4 Bmt 4.Full Bmt 7.		0.None 3.No Power 7.
2.1/2 Bmt 5.None 8.		1.Location 4.Generate 8.
3.3/4 Bmt 6. 9.None		2.Encroach 9.None 9.
Bsmt Gar # Cars		Entrance Code 0
Wet Basement		1.Interior 4.Vacant 7.
1.Dry 4. 7.		2.Refusal 5.Estimate 8.
2.Damp 5. 8.	3.Informed 6.Reviewed 9.	
3.Wet 6. 9.	Information Code 0	
	1.Owner 4.Agent 7.	
	2.Relative 5.Estimate 8.	
	3.Tenant 6.Exterior 9.	

Date Inspected

Additions, Outbuildings & Improvements

Type	Year	Units	Grade	Cond	Phys.	Funct.	Sound Value
					%	%	1.One Story Fram
					%	%	2.Two Story Fram
					%	%	3.Three Story Fr
					%	%	4.1 & 1/2 Story
					%	%	5.1 & 3/4 Story
					%	%	6.2 & 1/2 Story
					%	%	21.Open Frame Por
					%	%	22.Encl Frame Por
					%	%	23.Frame Garage
					%	%	24.Frame Shed
					%	%	25.Frame Bay Wind
					%	%	26.1SFr Overhang
					%	%	27.Unfin Basement
					%	%	28.Unfinished Att
					%	%	29.Finished Attic

VARNUM, MARK S (TRUSTEE)
 11 BANGOR MALL BLVD
 BANGOR ME 04401

B5196P22

Previous Owner
 VARNUM, MARK S
 840 KENNEDY MEMORIAL DRIVE

OAKLAND ME 04963
 Sale Date: 3/20/2013

Previous Owner
 VARNUM, NORMAN K
 58 HILLSIDE ST

PRESQUE ISLE ME 04769 2619
 Sale Date: 6/05/2008

Property Data		
Neighborhood	1 Resident/Agric.	
Tree Growth Year	0	
Recertified Date	0	
Y Coordinate	0	
Zone/Land Use	11 Residential	
Secondary Zone		
Topography	2 Rolling	
1.Level	4.Below St	7.
2.Rolling	5.Low	8.
3.Above St	6.Swampy	9.
Utilities	9 None	
1.Public	4.Dr Well	7.Cesspool
2.Water	5.Dug Well	8.
3.Sewer	6.Septic	9.None
Street	3 Gravel	
1.Paved	4.Proposed	7.
2.Semi Imp	5.R/W	8.
3.Gravel	6.	9.None
FLOOD PLAIN	0	
CLASS	1	
Sale Data		
Sale Date		
Price		
Sale Type		
1.Land	4.Mobile	7.
2.L & B	5.Other	8.
3.Building	6.	9.
Financing		
1.Convent	4.Seller	7.
2.FHA/VA	5.Private	8.
3.Assumed	6.Cash	9.Unknown
Validity		
1.Valid	4.Split	7.Changes
2.Related	5.Partial	8.Other
3.Distress	6.Exempt	9.
Verified		
1.Buyer	4.Agent	7.Family
2.Seller	5.Pub Rec	8.Other
3.Lender	6.MLS	9.

Assessment Record				
Year	Land	Buildings	Exempt	Total
2010	52,400	13,800	0	66,200
2011	52,400	13,700	0	66,100
2012	50,700	13,600	0	64,300
2013	50,700	13,600	0	64,300
2014	50,700	26,200	0	76,900
2015	131,600	45,200	0	176,800
2016	131,600	50,800	0	182,400
2017	131,600	50,800	0	182,400
2018	131,600	50,800	0	182,400

Inspection Witnessed By:

X	Date
No./Date	Description

Notes:

Land Data						
Front Foot	Type	Effective		Influence		Influence Codes
		Frontage	Depth	Factor	Code	
11.Regular Lot				%		1.Unimproved
12.Delta Triangle				%		2.Condition
13.Nabla Triangle				%		3.Topography
14.Rear Land				%		4.Size/Shape
15.Miscellaneous				%		5.Access
				%		6.Restricted
				%		7.Corner Infl
				%		8.Environment
				%		9.Fract Share
Square Foot		Square Feet				Acres
16.Regular Lot				%		32.Farmland Tilla
17.Class I Road				%		33.C R P
18.Class II Road				%		34.Softwood-Farm
19.Condominium				%		35.Mixed Wood-Far
20.Sound Value				%		36.Hardwood-Farm
				%		37.Softwood-TG
				%		38.Mixed Wood-TG
Fract. Acre	Acreage/Sites					
21.Homesite (Frac)	24	1.00	100	%	0	39.Hardwood-TG
22.Baselot (Frac)	28	198.20	100	%	0	40.Wasteland
23.Misc (Frac)	31	23.00	100	%	0	41.Gravel Pit
				%		42.Mobile Home Si
				%		43.Excess Indust
				%		44.Lot Improvemen
				%		45.Tower Site
				%		46.Miscellaneous
				%		47.Pavement
				%		48.Farmland Pastu
Total Acreage		222.20				

Easton

Map Lot 003-022

Account 797

Location MAHANY ROAD

Card 1

Of 1

9/27/2018

Building Style 1 Conventional	SF Bsmt Living 0	Layout 1 Typical
1.Conv. 5.Garrison 9.Gambrel	Fin Bsmt Grade 0 0	1.Typical 4. 7.
2.Ranch 6.Split 10.Saltbox	OPEN-5-CUSTOMIZE 0	2.Inadeq 5. 8.
3.R Ranch 7.Contemp 11.Other	Heat Type 0% 9 Not Heated	3.Horrid 6. 9.
4.Cape 8.Log 12.	1.HWBB/Rad 5.FWA 9.No Heat	Attic 9 None
Dwelling Units 1	2.HWCI 6.GravWA 10.	1.1/4 Fin 4.Full Fin 7.
Other Units 0	3.H Pump 7.Electric 11.	2.1/2 Fin 5.FI/Stair 8.
Stories 1 One Story	4.Steam 8.FI/Wall 12.	3.3/4 Fin 6. 9.None
1.1 4.1.5 7.	Cool Type 0% 9 None	Insulation 1 Full
2.2 5.1.75 8.	1.Refrig 4.W&C Air 7.	1.Full 4.Minimal 7.
3.3 6.2.5 9.	2.Evapor 5. 8.	2.Heavy 5.Partial 8.
Exterior Walls 2 Vinyl/Aluminum	3.H Pump 6. 9.None	3.Capped 6. 9.None
1.Wood 5.Stucco 9.Other	Kitchen Style 9 None	Unfinished % 0%
2.Vin/Al 6.Brick 10.	1.Modern 4.Obsolete 7.	Grade & Factor 2 Fair 100%
3.Compos. 7.Stone 11.	2.Typical 5. 8.	1.E Grade 4.B Grade 7.
4.Asbestos 8.Concrete 12.	3.Old Type 6. 9.None	2.D Grade 5.A Grade 8.SC Grade
Roof Surface 1 Asphalt Shingles	Bath(s) Style 9 None	3.C Grade 6.AA Grade 9.Same
1.Asphalt 4.Composit 7.	1.Modern 4.Obsolete 7.	SQFT (Footprint) 816
2.Slate 5.Wood 8.	2.Typical 5. 8.	Condition 4 Average
3.Metal 6.Other 9.	3.Old Type 6. 9.None	1.Poor 4.Avg 7.V G
SF Masonry Trim 0	# Rooms 2	2.Fair 5.Avg+ 8.Exc
OPEN-3-CUSTOM 0	# Bedrooms 1	3.Avg- 6.Good 9.Same
OPEN-4-CUSTOM 0	# Full Baths 0	Phys. % Good 0%
Year Built 2008	# Half Baths 0	Funct. % Good 100%
Year Remodeled 0	# Addn Fixtures 0	Functional Code 9 None
Foundation 5 Concrete Slab	# Fireplaces 0	1.Incomp 4.Bsmt 7.
1.Concrete 4.Wood 7.		2.O-Built 5. 8.LongTerm
2.C Block 5.Slab 8.		3.Damage 6.L-T Vaca 9.None
3.Br/Stone 6.Piers 9.		Econ. % Good 100%
Basement 9 No Basement		Economic Code None
1.1/4 Bmt 4.Full Bmt 7.		0.None 3.No Power 7.
2.1/2 Bmt 5.None 8.		1.Location 4.Generate 8.
3.3/4 Bmt 6. 9.None		2.Encroach 9.None 9.
Bsmt Gar # Cars 0		Entrance Code 4 Unoccupied
Wet Basement 9 No Basement		1.Interior 4.Vacant 7.
1.Dry 4. 7.		2.Refusal 5.Estimate 8.
2.Damp 5. 8.	3.Informed 6.Reviewed 9.	
3.Wet 6. 9.	Information Code 5 Estimate	
	1.Owner 4.Agent 7.	
	2.Relative 5.Estimate 8.	
	3.Tenant 6.Exterior 9.	

Date Inspected 6/16/2015

Additions, Outbuildings & Improvements

Type	Year	Units	Grade	Cond	Phys.	Funct.	Sound Value
24 Frame Shed	2014				%	%	2,000
24 Frame Shed	2014				%	%	1,000
24 Frame Shed	2014	312	3 100	4	0 %	80 %	
24 Frame Shed	2014	312	3 100	4	0 %	80 %	
24 Frame Shed	2014	240	3 100	4	0 %	80 %	
79 1.25 S-Gar	2014	1200	3 100	4	0 %	100 %	
					%	%	
					%	%	
					%	%	
					%	%	

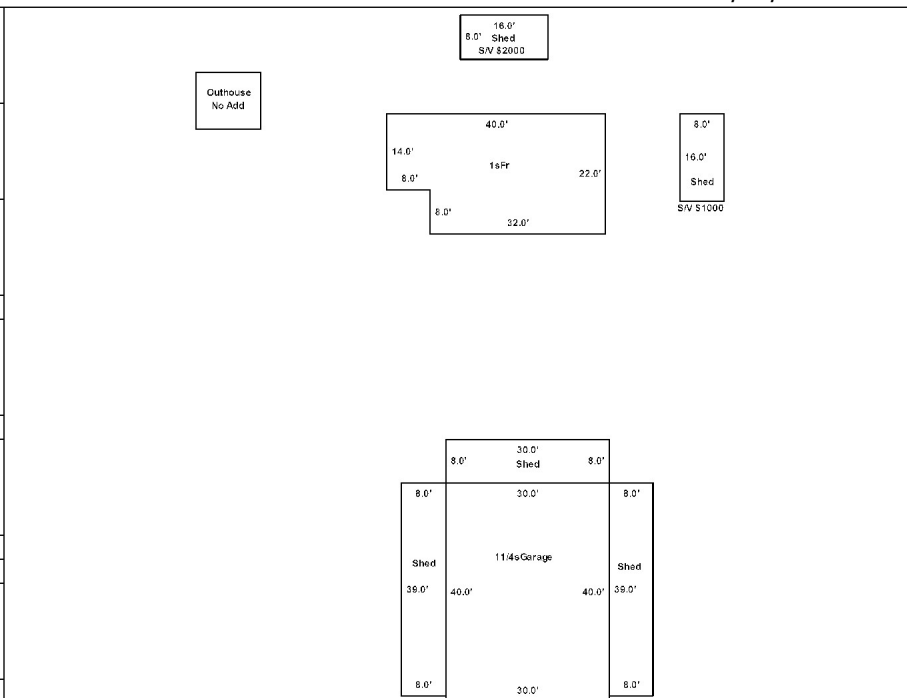

MAHANY, CAROLYNE T
268 MAHANY RD
EASTON ME 04740

B3814P143 B4507P283

Inspection Witnessed By:

X		Date
No./Date	Description	Date Insp.

Notes:

Easton

Property Data			Assessment Record																																																																																																																																																																																																																			
Neighborhood 1 Resident/Agric.			Year	Land	Buildings	Exempt	Total																																																																																																																																																																																																															
Tree Growth Year 0			2010	28,000	0	0	28,000																																																																																																																																																																																																															
Recertified Date 0			2011	28,000	0	0	28,000																																																																																																																																																																																																															
Y Coordinate 0			2012	28,000	0	0	28,000																																																																																																																																																																																																															
Zone/Land Use 11 Residential			2013	28,000	0	0	28,000																																																																																																																																																																																																															
Secondary Zone			2014	28,000	0	0	28,000																																																																																																																																																																																																															
Topography 2 Rolling			2015	67,700	0	0	67,700																																																																																																																																																																																																															
1.Level 4.Below St 7.			2016	67,700	0	0	67,700																																																																																																																																																																																																															
2.Rolling 5.Low 8.			2017	67,700	0	0	67,700																																																																																																																																																																																																															
3.Above St 6.Swampy 9.			2018	67,700	0	0	67,700																																																																																																																																																																																																															
Utilities 9 None																																																																																																																																																																																																																						
1.Public 4.Dr Well 7.Cesspool																																																																																																																																																																																																																						
2.Water 5.Dug Well 8.																																																																																																																																																																																																																						
3.Sewer 6.Septic 9.None																																																																																																																																																																																																																						
Street 1 Paved																																																																																																																																																																																																																						
1.Paved 4.Proposed 7.																																																																																																																																																																																																																						
2.Semi Imp 5.R/W 8.																																																																																																																																																																																																																						
3.Gravel 6. 9.None																																																																																																																																																																																																																						
FLOOD PLAIN 0			<table border="1"> <thead> <tr> <th colspan="5">Land Data</th> </tr> <tr> <th rowspan="2">Front Foot</th> <th rowspan="2">Type</th> <th colspan="2">Effective</th> <th colspan="2">Influence</th> <th rowspan="2">Influence Codes</th> </tr> <tr> <th>Frontage</th> <th>Depth</th> <th>Factor</th> <th>Code</th> </tr> </thead> <tbody> <tr> <td>11.Regular Lot</td> <td> </td> <td> </td> <td> </td> <td> </td> <td>%</td> <td>1.Unimproved</td> </tr> <tr> <td>12.Delta Triangle</td> <td> </td> <td> </td> <td> </td> <td> </td> <td>%</td> <td>2.Condition</td> </tr> <tr> <td>13.Nabla Triangle</td> <td> </td> <td> </td> <td> </td> <td> </td> <td>%</td> <td>3.Topography</td> </tr> <tr> <td>14.Rear Land</td> <td> </td> <td> </td> <td> </td> <td> </td> <td>%</td> <td>4.Size/Shape</td> </tr> <tr> <td>15.Miscellaneous</td> <td> </td> <td> </td> <td> </td> <td> </td> <td>%</td> <td>5.Access</td> </tr> <tr> <td> </td> <td> </td> <td> </td> <td> </td> <td> </td> <td>%</td> <td>6.Restricted</td> </tr> <tr> <td> </td> <td> </td> <td> </td> <td> </td> <td> </td> <td>%</td> <td>7.Corner Infl</td> </tr> <tr> <td> </td> <td> </td> <td> </td> <td> </td> <td> </td> <td>%</td> <td>8.Environment</td> </tr> <tr> <td> </td> <td> </td> <td> </td> <td> </td> <td> </td> <td>%</td> <td>9.Fract Share</td> </tr> <tr> <td colspan="5">Square Foot</td> <td colspan="2">Square Feet</td> <td>Acres</td> </tr> <tr> <td>16.Regular Lot</td> <td> </td> <td> </td> <td> </td> <td> </td> <td>%</td> <td>32.Farmland Tilla</td> </tr> <tr> <td>17.Class I Road</td> <td> </td> <td> </td> <td> </td> <td> </td> <td>%</td> <td>33.C R P</td> </tr> <tr> <td>18.Class II Road</td> <td> </td> <td> </td> <td> </td> <td> </td> <td>%</td> <td>34.Softwood-Farm</td> </tr> <tr> <td>19.Condominium</td> <td> </td> <td> </td> <td> </td> <td> </td> <td>%</td> <td>35.Mixed Wood-Far</td> </tr> <tr> <td>20.Sound Value</td> <td> </td> <td> </td> <td> </td> <td> </td> <td>%</td> <td>36.Hardwood-Farm</td> </tr> <tr> <td> </td> <td> </td> <td> </td> <td> </td> <td> </td> <td>%</td> <td>37.Softwood-TG</td> </tr> <tr> <td colspan="2">Fract. Acre</td> <td colspan="5">Acres/Sites</td> <td>38.Mixed Wood-TG</td> </tr> <tr> <td>21.Homesite (Frac</td> <td>25</td> <td>1.00</td> <td>100</td> <td>%</td> <td>0</td> <td>39.Hardwood-TG</td> </tr> <tr> <td>22.Baslot (Fract</td> <td>28</td> <td>116.40</td> <td>100</td> <td>%</td> <td>0</td> <td>40.Wasteland</td> </tr> <tr> <td>23.Misc (Fract)</td> <td> </td> <td> </td> <td> </td> <td>%</td> <td> </td> <td>41.Gravel Pit</td> </tr> <tr> <td colspan="2">Acres</td> <td> </td> <td> </td> <td>%</td> <td> </td> <td>42.Mobile Home Si</td> </tr> <tr> <td>24.Homesite</td> <td> </td> <td> </td> <td> </td> <td>%</td> <td> </td> <td>43.Excess Indust</td> </tr> <tr> <td>25.Baslot</td> <td> </td> <td> </td> <td> </td> <td>%</td> <td> </td> <td>44.Lot Improvemen</td> </tr> <tr> <td>26.Secondary</td> <td> </td> <td> </td> <td> </td> <td>%</td> <td> </td> <td>45.Tower Site</td> </tr> <tr> <td>27.Frontage</td> <td> </td> <td> </td> <td> </td> <td>%</td> <td> </td> <td>46.Miscellaneous</td> </tr> <tr> <td>28.Rear Land (All</td> <td colspan="5">Total Acreage 117.40</td> <td>47.Pavement</td> </tr> <tr> <td>31.Tillable</td> <td> </td> <td> </td> <td> </td> <td> </td> <td> </td> <td>48.Farmland Pastu</td> </tr> </tbody> </table>					Land Data					Front Foot	Type	Effective		Influence		Influence Codes	Frontage	Depth	Factor	Code	11.Regular Lot					%	1.Unimproved	12.Delta Triangle					%	2.Condition	13.Nabla Triangle					%	3.Topography	14.Rear Land					%	4.Size/Shape	15.Miscellaneous					%	5.Access						%	6.Restricted						%	7.Corner Infl						%	8.Environment						%	9.Fract Share	Square Foot					Square Feet		Acres	16.Regular Lot					%	32.Farmland Tilla	17.Class I Road					%	33.C R P	18.Class II Road					%	34.Softwood-Farm	19.Condominium					%	35.Mixed Wood-Far	20.Sound Value					%	36.Hardwood-Farm						%	37.Softwood-TG	Fract. Acre		Acres/Sites					38.Mixed Wood-TG	21.Homesite (Frac	25	1.00	100	%	0	39.Hardwood-TG	22.Baslot (Fract	28	116.40	100	%	0	40.Wasteland	23.Misc (Fract)				%		41.Gravel Pit	Acres				%		42.Mobile Home Si	24.Homesite				%		43.Excess Indust	25.Baslot				%		44.Lot Improvemen	26.Secondary				%		45.Tower Site	27.Frontage				%		46.Miscellaneous	28.Rear Land (All	Total Acreage 117.40					47.Pavement	31.Tillable						48.Farmland Pastu
Land Data																																																																																																																																																																																																																						
Front Foot	Type	Effective		Influence		Influence Codes																																																																																																																																																																																																																
		Frontage	Depth	Factor	Code																																																																																																																																																																																																																	
11.Regular Lot					%	1.Unimproved																																																																																																																																																																																																																
12.Delta Triangle					%	2.Condition																																																																																																																																																																																																																
13.Nabla Triangle					%	3.Topography																																																																																																																																																																																																																
14.Rear Land					%	4.Size/Shape																																																																																																																																																																																																																
15.Miscellaneous					%	5.Access																																																																																																																																																																																																																
					%	6.Restricted																																																																																																																																																																																																																
					%	7.Corner Infl																																																																																																																																																																																																																
					%	8.Environment																																																																																																																																																																																																																
					%	9.Fract Share																																																																																																																																																																																																																
Square Foot					Square Feet		Acres																																																																																																																																																																																																															
16.Regular Lot					%	32.Farmland Tilla																																																																																																																																																																																																																
17.Class I Road					%	33.C R P																																																																																																																																																																																																																
18.Class II Road					%	34.Softwood-Farm																																																																																																																																																																																																																
19.Condominium					%	35.Mixed Wood-Far																																																																																																																																																																																																																
20.Sound Value					%	36.Hardwood-Farm																																																																																																																																																																																																																
					%	37.Softwood-TG																																																																																																																																																																																																																
Fract. Acre		Acres/Sites					38.Mixed Wood-TG																																																																																																																																																																																																															
21.Homesite (Frac	25	1.00	100	%	0	39.Hardwood-TG																																																																																																																																																																																																																
22.Baslot (Fract	28	116.40	100	%	0	40.Wasteland																																																																																																																																																																																																																
23.Misc (Fract)				%		41.Gravel Pit																																																																																																																																																																																																																
Acres				%		42.Mobile Home Si																																																																																																																																																																																																																
24.Homesite				%		43.Excess Indust																																																																																																																																																																																																																
25.Baslot				%		44.Lot Improvemen																																																																																																																																																																																																																
26.Secondary				%		45.Tower Site																																																																																																																																																																																																																
27.Frontage				%		46.Miscellaneous																																																																																																																																																																																																																
28.Rear Land (All	Total Acreage 117.40					47.Pavement																																																																																																																																																																																																																
31.Tillable						48.Farmland Pastu																																																																																																																																																																																																																

Easton

Map Lot 003-023

Account 864

Location MAHANY ROAD

Card 1 Of 1 9/27/2018

Building Style 0	SF Bsmt Living 0	Layout 0
1.Conv. 5.Garrison 9.Gambrel	Fin Bsmt Grade 0 0	1.Typical 4. 7.
2.Ranch 6.Split 10.Saltbox	OPEN-5-CUSTOMIZE 0	2.Inadeq 5. 8.
3.R Ranch 7.Contemp 11.Other	Heat Type 100% 0	3.Horrid 6. 9.
4.Cape 8.Log 12.	1.HWBB/Rad 5.FWA 9.No Heat	Attic 0
Dwelling Units 0	2.HWCI 6.GravWA 10.	1.1/4 Fin 4.Full Fin 7.
Other Units 0	3.H Pump 7.Electric 11.	2.1/2 Fin 5.F/Stair 8.
Stories 0	4.Steam 8.F/Wall 12.	3.3/4 Fin 6. 9.None
1.1 4.1.5 7.	Cool Type 0% 9 None	Insulation 0
2.2 5.1.75 8.	1.Refrig 4.W&C Air 7.	1.Full 4.Minimal 7.
3.3 6.2.5 9.	2.Evapor 5. 8.	2.Heavy 5.Partial 8.
Exterior Walls 0	3.H Pump 6. 9.None	3.Capped 6. 9.None
1.Wood 5.Stucco 9.Other	Kitchen Style 0	Unfinished % 0%
2.Vin/Al 6.Brick 10.	1.Modern 4.Obsolete 7.	Grade & Factor 0 0%
3.Compos. 7.Stone 11.	2.Typical 5. 8.	1.E Grade 4.B Grade 7.
4.Asbestos 8.Concrete 12.	3.Old Type 6. 9.None	2.D Grade 5.A Grade 8.SC Grade
Roof Surface 0	Bath(s) Style 0	3.C Grade 6.AA Grade 9.Same
1.Asphalt 4.Composit 7.	1.Modern 4.Obsolete 7.	SQFT (Footprint) 0
2.Slate 5.Wood 8.	2.Typical 5. 8.	Condition 0
3.Metal 6.Other 9.	3.Old Type 6. 9.None	1.Poor 4.Avg 7.V G
SF Masonry Trim 0	# Rooms 0	2.Fair 5.Avg+ 8.Exc
OPEN-3-CUSTOM 0	# Bedrooms 0	3.Avg- 6.Good 9.Same
OPEN-4-CUSTOM 0	# Full Baths 0	Phys. % Good 0%
Year Built 0	# Half Baths 0	Funct. % Good 100%
Year Remodeled 0	# Addn Fixtures 0	Functional Code 9 None
Foundation 0	# Fireplaces 0	1.Incomp 4.Bsmt 7.
1.Concrete 4.Wood 7.		2.O-Built 5. 8.LongTerm
2.C Block 5.Slab 8.		3.Damage 6.L-T Vaca 9.None
3.Br/Stone 6.Piers 9.		Econ. % Good 100%
Basement 0		Economic Code None
1.1/4 Bmt 4.Full Bmt 7.		0.None 3.No Power 7.
2.1/2 Bmt 5.None 8.		1.Location 4.Generate 8.
3.3/4 Bmt 6. 9.None		2.Encroach 9.None 9.
Bsmt Gar # Cars 0		Entrance Code 0
Wet Basement 0		1.Interior 4.Vacant 7.
1.Dry 4. 7.		2.Refusal 5.Estimate 8.
2.Damp 5. 8.	3.Informed 6.Reviewed 9.	
3.Wet 6. 9.	Information Code 0	
		1.Owner 4.Agent 7.
		2.Relative 5.Estimate 8.
		3.Tenant 6.Exterior 9.

Date Inspected

Additions, Outbuildings & Improvements

Type	Year	Units	Grade	Cond	Phys.	Funct.	Sound Value
					%	%	1.One Story Fram
					%	%	2.Two Story Fram
					%	%	3.Three Story Fr
					%	%	4.1 & 1/2 Story
					%	%	5.1 & 3/4 Story
					%	%	6.2 & 1/2 Story
					%	%	21.Open Frame Por
					%	%	22.Encl Frame Por
					%	%	23.Frame Garage
					%	%	24.Frame Shed
					%	%	25.Frame Bay Wind
					%	%	26.1SFr Overhang
					%	%	27.Unfin Basement
					%	%	28.Unfinished Att
					%	%	29.Finished Attic

MAHANY, BARBARA
 MAHANY, CAROLYN T JT
 268 MAHANY RD
 EASTON ME 04740

B5616P64
 Previous Owner
 MAHANY, BARBARA E & CAROLYN T JT
 268 MAHANY RD
 EASTON ME 04740
 Sale Date: 4/14/2010

Previous Owner
 MAHANY, BARBARA E
 268 MAHANY RD
 EASTON ME 04740
 Sale Date: 3/12/2010

Inspection Witnessed By:

X	Date
No./Date	Description
	Date Insp.

Notes:
 EASEMENT DEED TO EMERA - B5616P64 12/13/16

Property Data		
Neighborhood	1 Resident/Agric.	
Tree Growth Year	0	
Recertified Date	0	
Y Coordinate	0	
Zone/Land Use	11 Residential	
Secondary Zone		
Topography	1 Level	2 Rolling
1.Level	4.Below St	7.
2.Rolling	5.Low	8.
3.Above St	6.Swampy	9.
Utilities	4 Drilled Well	6 Septic System
1.Public	4.Dr Well	7.Cesspool
2.Water	5.Dug Well	8.
3.Sewer	6.Septic	9.None
Street	1 Paved	
1.Paved	4.Proposed	7.
2.Semi Imp	5.R/W	8.
3.Gravel	6.	9.None
FLOOD PLAIN	0	
CLASS	1	
Sale Data		
Sale Date		
Price		
Sale Type		
1.Land	4.Mobile	7.
2.L & B	5.Other	8.
3.Building	6.	9.
Financing		
1.Convent	4.Seller	7.
2.FHA/VA	5.Private	8.
3.Assumed	6.Cash	9.Unknown
Validity		
1.Valid	4.Split	7.Changes
2.Related	5.Partial	8.Other
3.Distress	6.Exempt	9.
Verified		
1.Buyer	4.Agent	7.Family
2.Seller	5.Pub Rec	8.Other
3.Lender	6.MLS	9.

Assessment Record				
Year	Land	Buildings	Exempt	Total
2010	28,400	40,000	6,050	62,350
2011	28,400	40,000	6,050	62,350
2012	28,400	40,000	5,940	62,460
2013	28,400	40,000	6,160	62,240
2014	28,400	40,000	6,160	62,240
2015	69,000	71,000	10,000	130,000
2016	69,000	71,000	15,000	125,000
2017	69,000	71,000	20,000	120,000
2018	69,000	71,000	20,000	120,000

Land Data						
Front Foot	Type	Effective		Influence		Influence Codes
		Frontage	Depth	Factor	Code	
11.Regular Lot				%		1.Unimproved
12.Delta Triangle				%		2.Condition
13.Nabla Triangle				%		3.Topography
14.Rear Land				%		4.Size/Shape
15.Miscellaneous				%		5.Access
				%		6.Restricted
				%		7.Corner Infl
				%		8.Environment
				%		9.Fract Share
Square Foot		Square Feet				Acres
16.Regular Lot				%		
17.Class I Road				%		33.C R P
18.Class II Road				%		34.Softwood-Farm
19.Condominium				%		35.Mixed Wood-Far
20.Sound Value				%		36.Hardwood-Farm
				%		37.Softwood-TG
				%		38.Mixed Wood-TG
				%		39.Hardwood-TG
				%		40.Wasteland
				%		41.Gravel Pit
				%		42.Mobile Home Si
				%		43.Excess Indust
				%		44.Lot Improvemen
				%		45.Tower Site
				%		46.Miscellaneous
				%		47.Pavement
				%		48.Farmland Pastu
Total Acreage				89.00		

Easton

Map Lot 003-024

Account 479

Location 268 MAHANY ROAD

Card 1 Of 2 9/27/2018

Building Style 1 Conventional	SF Bsmt Living 0	Layout 1 Typical
1.Conv. 5.Garrison 9.Gambrel	Fin Bsmt Grade 0 0	1.Typical 4. 7.
2.Ranch 6.Split 10.Saltbox	OPEN-5-CUSTOMIZE 0	2.Inadeq 5. 8.
3.R Ranch 7.Contemp 11.Other	Heat Type 100% 5 Forced Warm Air	3.Horrid 6. 9.
4.Cape 8.Log 12.	1.HWBB/Rad 5.FWA 9.No Heat	Attic 9 None
Dwelling Units 1	2.HWCI 6.GravWA 10.	1.1/4 Fin 4.Full Fin 7.
Other Units 0	3.H Pump 7.Electric 11.	2.1/2 Fin 5.FI/Stair 8.
Stories 2 Two Story	4.Steam 8.FI/Wall 12.	3.3/4 Fin 6. 9.None
1.1 4.1.5 7.	Cool Type 0% 9 None	Insulation 4 Minimal
2.2 5.1.75 8.	1.Refrig 4.W&C Air 7.	1.Full 4.Minimal 7.
3.3 6.2.5 9.	2.Evapor 5. 8.	2.Heavy 5.Partial 8.
Exterior Walls 2 Vinyl/Aluminum	3.H Pump 6. 9.None	3.Capped 6. 9.None
1.Wood 5.Stucco 9.Other	Kitchen Style 2 Typical	Unfinished % 0%
2.Vin/Al 6.Brick 10.	1.Modern 4.Obsolete 7.	Grade & Factor 2 Fair 115%
3.Compos. 7.Stone 11.	2.Typical 5. 8.	1.E Grade 4.B Grade 7.
4.Asbestos 8.Concrete 12.	3.Old Type 6. 9.None	2.D Grade 5.A Grade 8.SC Grade
Roof Surface 1 Asphalt Shingles	Bath(s) Style 2 Typical Bath(s)	3.C Grade 6.AA Grade 9.Same
1.Asphalt 4.Composit 7.	1.Modern 4.Obsolete 7.	SQFT (Footprint) 598
2.Slate 5.Wood 8.	2.Typical 5. 8.	Condition 5 Above Average
3.Metal 6.Other 9.	3.Old Type 6. 9.None	1.Poor 4.Avg 7.V G
SF Masonry Trim 0	# Rooms 7	2.Fair 5.Avg+ 8.Exc
OPEN-3-CUSTOM 0	# Bedrooms 4	3.Avg- 6.Good 9.Same
OPEN-4-CUSTOM 0	# Full Baths 1	Phys. % Good 0%
Year Built 1888	# Half Baths 0	Funct. % Good 100%
Year Remodeled 0	# Addn Fixtures 0	Functional Code 9 None
Foundation 3 Brick &/or Stone	# Fireplaces 0	1.Incomp 4.Bsmt 7.
1.Concrete 4.Wood 7.		2.O-Built 5. 8.LongTerm
2.C Block 5.Slab 8.		3.Damage 6.L-T Vaca 9.None
3.Br/Stone 6.Piers 9.		Econ. % Good 100%
Basement 4 Full Basement		Economic Code None
1.1/4 Bmt 4.Full Bmt 7.		0.None 3.No Power 7.
2.1/2 Bmt 5.None 8.		1.Location 4.Generate 8.
3.3/4 Bmt 6. 9.None		2.Encroach 9.None 9.
Bsmt Gar # Cars 0		Entrance Code 1 Interior Inspect
Wet Basement 2 Damp Basement		1.Interior 4.Vacant 7.
1.Dry 4. 7.		2.Refusal 5.Estimate 8.
2.Damp 5. 8.	3.Informed 6.Reviewed 9.	
3.Wet 6. 9.	Information Code 1 Owner	
		1.Owner 4.Agent 7.
		2.Relative 5.Estimate 8.
		3.Tenant 6.Exterior 9.

Date Inspected 6/30/2015

Additions, Outbuildings & Improvements							
Type	Year	Units	Grade	Cond	Phys.	Funct.	Sound Value
45 2S Fr Bay	0	18	0 0	0	0 %	0 %	
45 2S Fr Bay	0	18	0 0	0	0 %	0 %	
21 Open Frame	0	386	0 0	0	0 %	0 %	
5 1 & 3/4 Story Fr	0	416	0 0	0	0 %	0 %	
27 Unfin Basement	0	416	0 0	0	0 %	0 %	
24 Frame Shed	0	405	3 100	5	0 %	80 %	
					%	%	
					%	%	
					%	%	
					%	%	
					%	%	

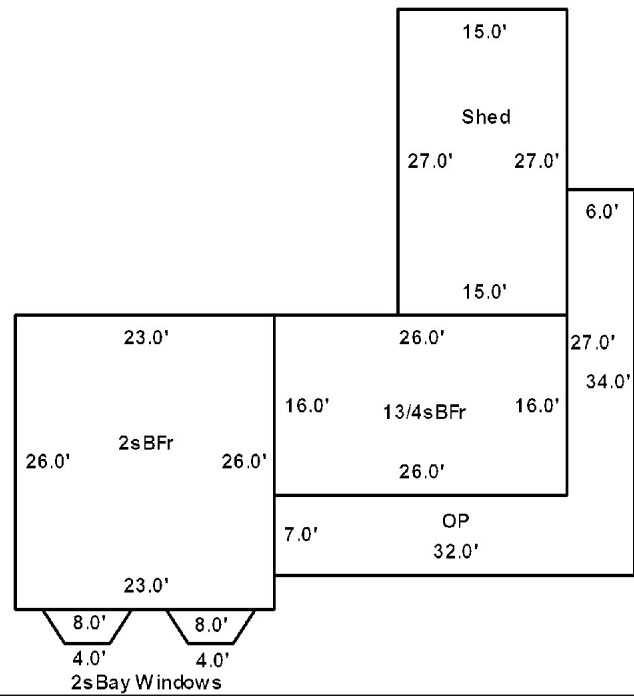

- 1.One Story Fram
- 2.Two Story Fram
- 3.Three Story Fr
- 4.1 & 1/2 Story
- 5.1 & 3/4 Story
- 6.2 & 1/2 Story
- 21.Open Frame Por
- 22.Encl Frame Por
- 23.Frame Garage
- 24.Frame Shed
- 25.Frame Bay Wind
- 26.1SFr Overhang
- 27.Unfin Basement
- 28.Unfinished Att
- 29.Finished Attic

MAHANY, BARBARA
 MAHANY, CAROLYN T JT
 268 MAHANY RD
 EASTON ME 04740

B5616P64

Previous Owner
 MAHANY, BARBARA E & CAROLYN T JT
 268 MAHANY RD

EASTON ME 04740
 Sale Date: 4/14/2010

Previous Owner
 MAHANY, BARBARA E
 268 MAHANY RD

EASTON ME 04740
 Sale Date: 3/12/2010

Inspection Witnessed By:

X	Date	Description	Date Insp.

Notes:
 At property owners request, returned to check outbuildings.
 Reduced from 75% functional to 50% functional. 2017

Easton

Property Data			Assessment Record						
Neighborhood 1 Resident/Agric.			Year	Land	Buildings	Exempt	Total		
Tree Growth Year 0			2010	0	4,600	0	4,600		
Recertified Date 0			2011	0	4,600	0	4,600		
Y Coordinate 0			2012	0	4,600	0	4,600		
Zone/Land Use 11 Residential			2013	0	4,600	0	4,600		
Secondary Zone			2014	0	4,600	0	4,600		
Topography 1 Level 2 Rolling			2015	0	25,800	0	25,800		
1.Level 4.Below St 7.			2016	0	25,800	0	25,800		
2.Rolling 5.Low 8.			2017	0	16,800	0	16,800		
3.Above St 6.Swampy 9.			2018	0	16,800	0	16,800		
Utilities									
1.Public 4.Dr Well 7.Cesspool									
2.Water 5.Dug Well 8.									
3.Sewer 6.Septic 9.None									
Street 1 Paved									
1.Paved 4.Proposed 7.									
2.Semi Imp 5.R/W 8.									
3.Gravel 6. 9.None									
FLOOD PLAIN 0			Land Data						
CLASS 8			Front Foot	Type	Effective		Influence		Influence Codes
Sale Data					Frontage	Depth	Factor	Code	
Sale Date			11.Regular Lot					1.Unimproved	
Price			12.Delta Triangle					2.Condition	
Sale Type			13.Nabla Triangle					3.Topography	
1.Land 4.Mobile 7.			14.Rear Land					4.Size/Shape	
2.L & B 5.Other 8.			15.Miscellaneous					5.Access	
3.Building 6. 9.								6.Restricted	
Financing								7.Corner Infl	
1.Convent 4.Seller 7.			Square Foot	Square Feet				8.Environment	
2.FHA/VA 5.Private 8.			16.Regular Lot					9.Fract Share	
3.Assumed 6.Cash 9.Unknown			17.Class I Road					Acres	
Validity			18.Class II Road					32.Farmland Tilla	
1.Valid 4.Split 7.Changes			19.Condominium					33.C R P	
2.Related 5.Partial 8.Other			20.Sound Value					34.Softwood-Farm	
3.Distress 6.Exempt 9.								35.Mixed Wood-Far	
Verified			Fract. Acre	Acreege/Sites				36.Hardwood-Farm	
1.Buyer 4.Agent 7.Family			21.Homesite (Fract)					37.Softwood-TG	
2.Seller 5.Pub Rec 8.Other			22.Baselot (Fract)					38.Mixed Wood-TG	
3.Lender 6.MLS 9.			23.Misc (Fract)					39.Hardwood-TG	
			Acres					40.Wasteland	
			24.Homesite					41.Gravel Pit	
			25.Baselot					42.Mobile Home Si	
			26.Secondary					43.Excess Indust	
			27.Frontage					44.Lot Improvemen	
			28.Rear Land (All					45.Tower Site	
			31.Tillable					46.Miscellaneous	
				Total Acreege		0.00		47.Pavement	
								48.Farmland Pastu	

Easton

Map Lot 003-024

Account 479

Location MAHANY ROAD

Card 2 Of 2 9/27/2018

Building Style			SF Bsmt Living			Layout				
1.Conv.	5.Garrison	9.Gambrel	Fin Bsmt Grade			1.Typical	4.	7.		
2.Ranch	6.Split	10.Saltbox	OPEN-5-CUSTOMIZE			2.Inadeq	5.	8.		
3.R Ranch	7.Contemp	11.Other	Heat Type 100%			3.Horrid	6.	9.		
4.Cape	8.Log	12.	1.HWBB/Rad	5.FWA	9.No Heat	Attic				
Dwelling Units			2.HWCI	6.GravWA	10.	1.1/4 Fin	4.Full Fin	7.		
Other Units			3.H Pump	7.Electric	11.	2.1/2 Fin	5.F/Stair	8.		
Stories			4.Steam	8.F/Wall	12.	3.3/4 Fin	6.	9.None		
1.1	4.1.5	7.	Cool Type 0%			Insulation				
2.2	5.1.75	8.	1.Refrig	4.W&C Air	7.	1.Full	4.Minimal	7.		
3.3	6.2.5	9.	2.Evapor	5.	8.	2.Heavy	5.Partial	8.		
Exterior Walls			3.H Pump	6.	9.None	3.Capped	6.	9.None		
1.Wood	5.Stucco	9.Other	Kitchen Style			Unfinished %				
2.Vin/Al	6.Brick	10.	1.Modern	4.Obsolete	7.	Grade & Factor				
3.Compos.	7.Stone	11.	2.Typical	5.	8.	1.E Grade	4.B Grade	7.		
4.Asbestos	8.Concrete	12.	3.Old Type	6.	9.None	2.D Grade	5.A Grade	8.SC Grade		
Roof Surface			Bath(s) Style			3.C Grade	6.AA Grade	9.Same		
1.Asphalt	4.Composit	7.	1.Modern	4.Obsolete	7.	SQFT (Footprint)				
2.Slate	5.Wood	8.	2.Typical	5.	8.	Condition				
3.Metal	6.Other	9.	3.Old Type	6.	9.None	1.Poor	4.Avg	7.V G		
SF Masonry Trim			# Rooms			2.Fair	5.Avg+	8.Exc		
OPEN-3-CUSTOM			# Bedrooms			3.Avg-	6.Good	9.Same		
OPEN-4-CUSTOM			# Full Baths			Phys. % Good				
Year Built			# Half Baths			Funct. % Good				
Year Remodeled			# Addn Fixtures			Functional Code				
Foundation			# Fireplaces			1.Incomp	4.Bsmt	7.		
1.Concrete	4.Wood	7.				2.O-Built	5.	8.LongTerm		
2.C Block	5.Slab	8.				Econ. % Good				
3.Br/Stone	6.Piers	9.				Economic Code				
Basement						0.None			3.No Power	7.
1.1/4 Bmt	4.Full Bmt	7.				1.Location			4.Generate	8.
2.1/2 Bmt	5.None	8.				2.Encroach			9.None	9.
3.3/4 Bmt	6.	9.None				Entrance Code 1 Interior Inspect				
Bsmt Gar # Cars						1.Interior			4.Vacant	7.
Wet Basement						2.Refusal			5.Estimate	8.
1.Dry	4.	7.				3.Informed			6.Reviewed	9.
2.Damp	5.	8.	Information Code 1 Owner							
3.Wet	6.	9.	1.Owner			4.Agent	7.			
Date Inspected 6/30/2015			2.Relative			5.Estimate	8.			
			3.Tenant			6.Exterior	9.			

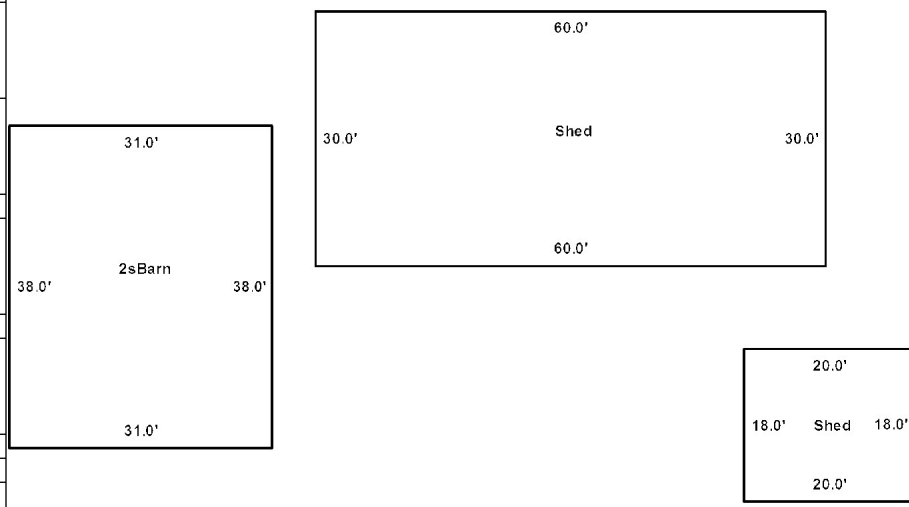

Additions, Outbuildings & Improvements								1.One Story Fram
Type	Year	Units	Grade	Cond	Phys.	Funct.	Sound Value	2.Two Story Fram
73 2 Story Barn	1888	1178	3 100	3	0 %	50 %		3.Three Story Fr
24 Frame Shed	1946	1800	3 100	3	0 %	50 %		4.1 & 1/2 Story
24 Frame Shed	1920	360	2 100	3	0 %	50 %		5.1 & 3/4 Story
					%	%		6.2 & 1/2 Story
					%	%		21.Open Frame Por
					%	%		22.Encl Frame Por
					%	%		23.Frame Garage
					%	%		24.Frame Shed
					%	%		25.Frame Bay Wind
					%	%		26.1SFr Overhang
					%	%		27.Unfin Basement
					%	%		28.Unfinished Att
					%	%		29.Finished Attic



MASON, BRUCE A
 MASON, DORIS J JT
 PO BOX 467
 PRESQUE ISLE ME 04769 0467

B4721P316

Previous Owner
 MINOTT, CORINNE J
 356 HIGHLAND RD

BRUNSWICK ME 04011
 Sale Date: 7/06/2009

Previous Owner
 MINOTT, JAMES A
 GAMANCHE, CORINNE J JT
 356 HIGHLAND RD
 BRUNSWICK ME 04011
 Sale Date: 6/08/2006

Property Data			Assessment Record				
Neighborhood	1 Resident/Agric.		Year	Land	Buildings	Exempt	Total
Tree Growth Year	0		2010	12,500	8,700	0	21,200
Recertified Date	0		2011	12,500	8,600	0	21,100
Y Coordinate	0		2012	12,500	15,700	0	28,200
Zone/Land Use	11 Residential		2013	12,500	15,600	0	28,100
Secondary Zone			2014	12,500	15,500	0	28,000
Topography	1 Level	2 Rolling	2015	27,500	55,900	0	83,400
1.Level	4.Below St	7.	2016	27,500	55,900	0	83,400
2.Rolling	5.Low	8.	2017	27,500	55,900	0	83,400
3.Above St	6.Swampy	9.	2018	27,500	55,900	0	83,400
Utilities	9 None						
1.Public	4.Dr Well	7.Cesspool					
2.Water	5.Dug Well	8.					
3.Sewer	6.Septic	9.None					
Street	3 Gravel						
1.Paved	4.Proposed	7.					
2.Semi Imp	5.R/W	8.					
3.Gravel	6.	9.None					

Inspection Witnessed By:

X	Date
No./Date	Description
	Date Insp.

Notes:
 SOLD 10/87 \$17,000.
 *Shares well & septic

Sale Data		
Sale Date	7/06/2009	
Price	49,000	
Sale Type	2 Land & Buildings	
1.Land	4.Mobile	7.
2.L & B	5.Other	8.
3.Building	6.	9.
Financing	9 Unknown	
1.Convent	4.Seller	7.
2.FHA/VA	5.Private	8.
3.Assumed	6.Cash	9.Unknown
Validity	1 Arms Length Sale	
1.Valid	4.Split	7.Changes
2.Related	5.Partial	8.Other
3.Distress	6.Exempt	9.
Verified	5 Public Record	
1.Buyer	4.Agent	7.Family
2.Seller	5.Pub Rec	8.Other
3.Lender	6.MLS	9.

Land Data						
Front Foot	Type	Effective		Influence		Influence Codes
		Frontage	Depth	Factor	Code	
11.Regular Lot				%		1.Unimproved
12.Delta Triangle				%		2.Condition
13.Nabla Triangle				%		3.Topography
14.Rear Land				%		4.Size/Shape
15.Miscellaneous				%		5.Access
				%		6.Restricted
				%		7.Corner Infl
				%		8.Environment
				%		9.Fract Share
Square Foot		Square Feet		Acres		
16.Regular Lot				%		32.Farmland Tilla
17.Class I Road				%		33.C R P
18.Class II Road				%		34.Softwood-Farm
19.Condominium				%		35.Mixed Wood-Far
20.Sound Value				%		36.Hardwood-Farm
				%		37.Softwood-TG
				%		38.Mixed Wood-TG
				%		39.Hardwood-TG
				%		40.Wasteland
				%		41.Gravel Pit
				%		42.Mobile Home Si
				%		43.Excess Indust
				%		44.Lot Improvemen
				%		45.Tower Site
				%		46.Miscellaneous
				%		47.Pavement
				%		48.Farmland Pastu
Total Acreage		22.00				

Easton

Map Lot 003-025

Account 671

Location HERSOM ROAD

Card 1 Of 2 9/27/2018

Building Style 1 Conventional	SF Bsmt Living 0	Layout 1 Typical
1.Conv. 5.Garrison 9.Gambrel	Fin Bsmt Grade 0 0	1.Typical 4. 7.
2.Ranch 6.Split 10.Saltbox	OPEN-5-CUSTOMIZE 0	2.Inadeq 5. 8.
3.R Ranch 7.Contemp 11.Other	Heat Type 100% 7 Electric	3.Horrid 6. 9.
4.Cape 8.Log 12.	1.HWBB/Rad 5.FWA 9.No Heat	Attic 9 None
Dwelling Units 1	2.HWCI 6.GravWA 10.	1.1/4 Fin 4.Full Fin 7.
Other Units 0	3.H Pump 7.Electric 11.	2.1/2 Fin 5.FI/Stair 8.
Stories 1 One Story	4.Steam 8.FI/Wall 12.	3.3/4 Fin 6. 9.None
1.1 4.1.5 7.	Cool Type 0% 9 None	Insulation 1 Full
2.2 5.1.75 8.	1.Refrig 4.W&C Air 7.	1.Full 4.Minimal 7.
3.3 6.2.5 9.	2.Evapor 5. 8.	2.Heavy 5.Partial 8.
Exterior Walls 1 Wood Siding	3.H Pump 6. 9.None	3.Capped 6. 9.None
1.Wood 5.Stucco 9.Other	Kitchen Style 2 Typical	Unfinished % 0%
2.Vin/Al 6.Brick 10.	1.Modern 4.Obsolete 7.	Grade & Factor 2 Fair 105%
3.Compos. 7.Stone 11.	2.Typical 5. 8.	1.E Grade 4.B Grade 7.
4.Asbestos 8.Concrete 12.	3.Old Type 6. 9.None	2.D Grade 5.A Grade 8.SC Grade
Roof Surface 3 Sheet Metal	Bath(s) Style 2 Typical Bath(s)	3.C Grade 6.AA Grade 9.Same
1.Asphalt 4.Composit 7.	1.Modern 4.Obsolete 7.	SQFT (Footprint) 336
2.Slate 5.Wood 8.	2.Typical 5. 8.	Condition 4 Average
3.Metal 6.Other 9.	3.Old Type 6. 9.None	1.Poor 4.Avg 7.V G
SF Masonry Trim 0	# Rooms 3	2.Fair 5.Avg+ 8.Exc
OPEN-3-CUSTOM 0	# Bedrooms 1	3.Avg- 6.Good 9.Same
OPEN-4-CUSTOM 0	# Full Baths 1	Phys. % Good 0%
Year Built 2005	# Half Baths 0	Funct. % Good 100%
Year Remodeled 0	# Addn Fixtures 0	Functional Code 9 None
Foundation 6 Piers	# Fireplaces 0	1.Incomp 4.Bsmt 7.
1.Concrete 4.Wood 7.		2.O-Built 5. 8.LongTerm
2.C Block 5.Slab 8.		3.Damage 6.L-T Vaca 9.None
3.Br/Stone 6.Piers 9.		Econ. % Good 100%
Basement 9 No Basement		Economic Code None
1.1/4 Bmt 4.Full Bmt 7.		0.None 3.No Power 7.
2.1/2 Bmt 5.None 8.		1.Location 4.Generate 8.
3.3/4 Bmt 6. 9.None		2.Encroach 9.None 9.
Bsmt Gar # Cars 0		Entrance Code 1 Interior Inspect
Wet Basement 9 No Basement		1.Interior 4.Vacant 7.
1.Dry 4. 7.		2.Refusal 5.Estimate 8.
2.Damp 5. 8.		3.Informed 6.Reviewed 9.
3.Wet 6. 9.		Information Code 1 Owner
		1.Owner 4.Agent 7.
		2.Relative 5.Estimate 8.
		3.Tenant 6.Exterior 9.

Date Inspected 6/22/2015

Additions, Outbuildings & Improvements

Type	Year	Units	Grade	Cond	Phys.	Funct.	Sound Value
1 One Story Frame	2007	264	0 0	0	0 %	0 %	
1 One Story Frame	2011	336	0 0	0	0 %	0 %	
23 Frame Garage	2013	504	0 0	0	0 %	80 %	
1 One Story Frame	2011	192	0 0	0	0 %	0 %	
21 Open Frame	2011	156	0 0	0	0 %	0 %	
					%	%	
					%	%	
					%	%	
					%	%	
					%	%	
					%	%	

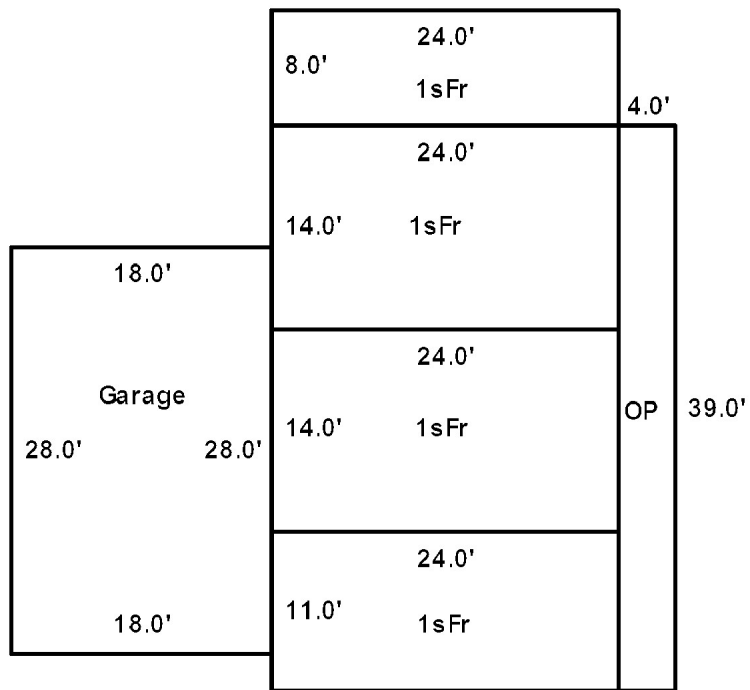

MASON, BRUCE A
 MASON, DORIS J JT
 PO BOX 467
 PRESQUE ISLE ME 04769 0467

B4721P316

Previous Owner
 MINOTT, CORINNE J
 356 HIGHLAND RD

BRUNSWICK ME 04011
 Sale Date: 7/06/2009

Previous Owner
 MINOTT, JAMES A
 GAMANCHE, CORINNE J JT
 356 HIGHLAND RD
 BRUNSWICK ME 04011
 Sale Date: 6/08/2006

Inspection Witnessed By:

X	Date	Date Insp.
No./Date	Description	Date Insp.

Notes:

Easton

Property Data		
Neighborhood	1 Resident/Agric.	
Tree Growth Year	0	
Recertified Date	0	
Y Coordinate	0	
Zone/Land Use	41 Agricultural	
Secondary Zone		
Topography	1 Level	2 Rolling
1.Level	4.Below St	7.
2.Rolling	5.Low	8.
3.Above St	6.Swampy	9.
Utilities	9 None	
1.Public	4.Dr Well	7.Cesspool
2.Water	5.Dug Well	8.
3.Sewer	6.Septic	9.None
Street	3 Gravel	
1.Paved	4.Proposed	7.
2.Semi Imp	5.R/W	8.
3.Gravel	6.	9.None
FLOOD PLAIN	0	
CLASS	9	
Sale Data		
Sale Date	7/06/2009	
Price	49,000	
Sale Type	2 Land & Buildings	
1.Land	4.Mobile	7.
2.L & B	5.Other	8.
3.Building	6.	9.
Financing	9 Unknown	
1.Convent	4.Seller	7.
2.FHA/VA	5.Private	8.
3.Assumed	6.Cash	9.Unknown
Validity	1 Arms Length Sale	
1.Valid	4.Split	7.Changes
2.Related	5.Partial	8.Other
3.Distress	6.Exempt	9.
Verified	5 Public Record	
1.Buyer	4.Agent	7.Family
2.Seller	5.Pub Rec	8.Other
3.Lender	6.MLS	9.

Assessment Record				
Year	Land	Buildings	Exempt	Total
2010	0	5,700	0	5,700
2011	0	5,600	0	5,600
2012	0	5,600	0	5,600
2013	0	5,600	0	5,600
2014	0	20,000	0	20,000
2015	0	60,800	0	60,800
2016	0	60,800	0	60,800
2017	0	60,800	0	60,800
2018	0	58,500	0	58,500

Land Data						
Front Foot	Type	Effective		Influence		Influence Codes
		Frontage	Depth	Factor	Code	
11.Regular Lot				%		1.Unimproved
12.Delta Triangle				%		2.Condition
13.Nabla Triangle				%		3.Topography
14.Rear Land				%		4.Size/Shape
15.Miscellaneous				%		5.Access
				%		6.Restricted
				%		7.Corner Infl
				%		8.Environment
				%		9.Fract Share
Square Foot		Square Feet				Acres
16.Regular Lot				%		32.Farmland Tilla
17.Class I Road				%		33.C R P
18.Class II Road				%		34.Softwood-Farm
19.Condominium				%		35.Mixed Wood-Far
20.Sound Value				%		36.Hardwood-Farm
				%		37.Softwood-TG
				%		38.Mixed Wood-TG
				%		39.Hardwood-TG
				%		40.Wasteland
				%		41.Gravel Pit
				%		42.Mobile Home Si
				%		43.Excess Indust
				%		44.Lot Improvemen
				%		45.Tower Site
				%		46.Miscellaneous
				%		47.Pavement
				%		48.Farmland Pastu
Total Acreage				0.00		

Easton

Map Lot 003-025

Account 671

Location HERSOM ROAD

Card 2

Of 2

9/27/2018

Building Style 1 Conventional	SF Bsmt Living 0	Layout 1 Typical
1.Conv. 5.Garrison 9.Gambrel	Fin Bsmt Grade 0 0	1.Typical 4. 7.
2.Ranch 6.Split 10.Saltbox	OPEN-5-CUSTOMIZE 0	2.Inadeq 5. 8.
3.R Ranch 7.Contemp 11.Other	Heat Type 100% 7 Electric	3.Horrid 6. 9.
4.Cape 8.Log 12.	1.HWBB/Rad 5.FWA 9.No Heat	Attic 9 None
Dwelling Units 1	2.HWCI 6.GravWA 10.	1.1/4 Fin 4.Full Fin 7.
Other Units 0	3.H Pump 7.Electric 11.	2.1/2 Fin 5.FI/Stair 8.
Stories 1 One Story	4.Steam 8.FI/Wall 12.	3.3/4 Fin 6. 9.None
1.1 4.1.5 7.	Cool Type 0% 9 None	Insulation 1 Full
2.2 5.1.75 8.	1.Refrig 4.W&C Air 7.	1.Full 4.Minimal 7.
3.3 6.2.5 9.	2.Evapor 5. 8.	2.Heavy 5.Partial 8.
Exterior Walls 2 Vinyl/Aluminum	3.H Pump 6. 9.None	3.Capped 6. 9.None
1.Wood 5.Stucco 9.Other	Kitchen Style 2 Typical	Unfinished % 0%
2.Vin/Al 6.Brick 10.	1.Modern 4.Obsolete 7.	Grade & Factor 2 Fair 105%
3.Compos. 7.Stone 11.	2.Typical 5. 8.	1.E Grade 4.B Grade 7.
4.Asbestos 8.Concrete 12.	3.Old Type 6. 9.None	2.D Grade 5.A Grade 8.SC Grade
Roof Surface 3 Sheet Metal	Bath(s) Style 2 Typical Bath(s)	3.C Grade 6.AA Grade 9.Same
1.Asphalt 4.Composit 7.	1.Modern 4.Obsolete 7.	SQFT (Footprint) 342
2.Slate 5.Wood 8.	2.Typical 5. 8.	Condition 4 Average
3.Metal 6.Other 9.	3.Old Type 6. 9.None	1.Poor 4.Avg 7.V G
SF Masonry Trim 0	# Rooms 3	2.Fair 5.Avg+ 8.Exc
OPEN-3-CUSTOM 0	# Bedrooms 1	3.Avg- 6.Good 9.Same
OPEN-4-CUSTOM 0	# Full Baths 1	Phys. % Good 0%
Year Built 2007	# Half Baths 1	Funct. % Good 100%
Year Remodeled 0	# Addn Fixtures 0	Functional Code 9 None
Foundation 6 Piers	# Fireplaces 0	1.Incomp 4.Bsmt 7.
1.Concrete 4.Wood 7.	 <p>TRIO Software A Division of Harris Computer Systems</p>	2.O-Built 5. 8.LongTerm
2.C Block 5.Slab 8.		3.Damage 6.L-T Vaca 9.None
3.Br/Stone 6.Piers 9.		Econ. % Good 100%
Basement 9 No Basement		Economic Code None
1.1/4 Bmt 4.Full Bmt 7.		0.None 3.No Power 7.
2.1/2 Bmt 5.None 8.		1.Location 4.Generate 8.
3.3/4 Bmt 6. 9.None		2.Encroach 9.None 9.
Bsmt Gar # Cars 0		Entrance Code 1 Interior Inspect
Wet Basement 9 No Basement		1.Interior 4.Vacant 7.
1.Dry 4. 7.		2.Refusal 5.Estimate 8.
2.Damp 5. 8.	3.Informed 6.Reviewed 9.	
3.Wet 6. 9.	Information Code 1 Owner	
		1.Owner 4.Agent 7.
		2.Relative 5.Estimate 8.
		3.Tenant 6.Exterior 9.

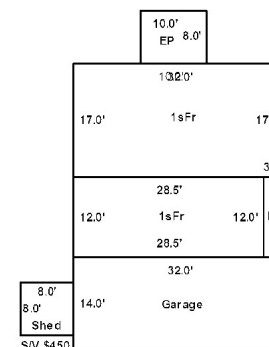
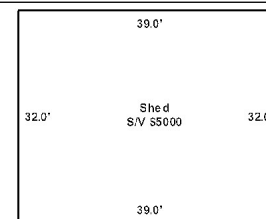

Date Inspected 6/22/2015

Additions, Outbuildings & Improvements

Type	Year	Units	Grade	Cond	Phys.	Funct.	Sound Value
22 Encl Frame Porch	2013	42	0 0	0	0 %	0 %	
1 One Story Frame	2013	544	0 0	0	0 %	0 %	
23 Frame Garage	2013	80	1 100	4	0 %	80 %	
24 Frame Shed	0				%	%	450
22 Encl Frame Porch	2014	448	3 100	4	0 %	100 %	
24 Frame Shed	2013				%	%	5,000
					%	%	
					%	%	
					%	%	
					%	%	
					%	%	
					%	%	
					%	%	
					%	%	



BERNIER, CARL E
241 HERSOM ROAD
EASTON ME 04740

B3900P60

Inspection Witnessed By:

X	Date	
No./Date	Description	Date Insp.

Notes:

Easton

Property Data			Assessment Record						
Neighborhood 1 Resident/Agric.			Year	Land	Buildings	Exempt	Total		
Tree Growth Year 0			2010	10,800	15,500	6,050	20,250		
Recertified Date 0			2011	10,800	14,700	6,050	19,450		
Y Coordinate 0			2012	10,800	35,100	5,940	39,960		
Zone/Land Use 11 Residential			2013	10,800	34,300	6,160	38,940		
Secondary Zone			2014	10,800	33,300	6,160	37,940		
Topography 2 Rolling			2015	26,500	54,200	10,000	70,700		
1.Level 4.Below St 7.			2016	26,500	54,200	15,000	65,700		
2.Rolling 5.Low 8.			2017	26,500	54,200	20,000	60,700		
3.Above St 6.Swampy 9.			2018	26,500	54,200	20,000	60,700		
Utilities 4 Drilled Well 6 Septic System									
1.Public 4.Dr Well 7.Cesspool									
2.Water 5.Dug Well 8.									
3.Sewer 6.Septic 9.None									
Street 1 Paved									
1.Paved 4.Proposed 7.									
2.Semi Imp 5.R/W 8.									
3.Gravel 6. 9.None									
FLOOD PLAIN 0			Land Data						
CLASS 9			Front Foot	Type	Effective		Influence		Influence Codes
					Frontage	Depth	Factor	Code	
Sale Data			11.Regular Lot						1.Unimproved
Sale Date 11/01/2003			12.Delta Triangle						2.Condition
Price 11,500			13.Nabla Triangle						3.Topography
Sale Type 1 Land Only			14.Rear Land						4.Size/Shape
1.Land 4.Mobile 7.			15.Miscellaneous						5.Access
2.L & B 5.Other 8.			Square Foot	Square Feet					6.Restricted
3.Building 6. 9.				16.Regular Lot					7.Corner Infl
Financing 9 Unknown			17.Class I Road						8.Environment
1.Convent 4.Seller 7.			18.Class II Road						9.Fract Share
2.FHA/VA 5.Private 8.			19.Condominium						Acres
3.Assumed 6.Cash 9.Unknown			20.Sound Value						32.Farmland Tilla
Validity 1 Arms Length Sale			Fract. Acre	Acres/Sites					33.C R P
1.Valid 4.Split 7.Changes				21.Homesite (Frac	24	1.00	100	%	0
2.Related 5.Partial 8.Other			22.Baslot (Fract	28	19.00	100	%	0	35.Mixed Wood-Far
3.Distress 6.Exempt 9.			23.Misc (Fract)	44	1.00	100	%	0	36.Hardwood-Farm
Verified 5 Public Record			Acres						37.Softwood-TG
1.Buyer 4.Agent 7.Family			24.Homesite						38.Mixed Wood-TG
2.Seller 5.Pub Rec 8.Other			25.Baslot						39.Hardwood-TG
3.Lender 6.MLS 9.			26.Secondary						40.Wasteland
			27.Frontage						41.Gravel Pit
			28.Rear Land (All						42.Mobile Home Si
			31.Tillable						43.Excess Indust
				Total Acreage		20.00			44.Lot Improvemen
									45.Tower Site
									46.Miscellaneous
									47.Pavement
									48.Farmland Pastu

Easton

Map Lot 003-025-A

Account 1079

Location 241 HERSOM RD

Card 1

Of 1

9/27/2018

Building Style 0	SF Bsmt Living 0	Layout 0
1.Conv. 5.Garrison 9.Gambrel	Fin Bsmt Grade 0 0	1.Typical 4. 7.
2.Ranch 6.Split 10.Saltbox	OPEN-5-CUSTOMIZE 0	2.Inadeq 5. 8.
3.R Ranch 7.Contemp 11.Other	Heat Type 100% 0	3.Horrid 6. 9.
4.Cape 8.Log 12.	1.HWBB/Rad 5.FWA 9.No Heat	Attic 0
Dwelling Units 0	2.HWCI 6.GravWA 10.	1.1/4 Fin 4.Full Fin 7.
Other Units 0	3.H Pump 7.Electric 11.	2.1/2 Fin 5.FI/Stair 8.
Stories 0	4.Steam 8.FI/Wall 12.	3.3/4 Fin 6. 9.None
1.1 4.1.5 7.	Cool Type 0% 9 None	Insulation 0
2.2 5.1.75 8.	1.Refrig 4.W&C Air 7.	1.Full 4.Minimal 7.
3.3 6.2.5 9.	2.Evapor 5. 8.	2.Heavy 5.Partial 8.
Exterior Walls 0	3.H Pump 6. 9.None	3.Capped 6. 9.None
1.Wood 5.Stucco 9.Other	Kitchen Style 0	Unfinished % 0%
2.Vin/Al 6.Brick 10.	1.Modern 4.Obsolete 7.	Grade & Factor 0 0%
3.Compos. 7.Stone 11.	2.Typical 5. 8.	1.E Grade 4.B Grade 7.
4.Asbestos 8.Concrete 12.	3.Old Type 6. 9.None	2.D Grade 5.A Grade 8.SC Grade
Roof Surface 0	Bath(s) Style 0	3.C Grade 6.AA Grade 9.Same
1.Asphalt 4.Composit 7.	1.Modern 4.Obsolete 7.	SQFT (Footprint) 0
2.Slate 5.Wood 8.	2.Typical 5. 8.	Condition 0
3.Metal 6.Other 9.	3.Old Type 6. 9.None	1.Poor 4.Avg 7.V G
SF Masonry Trim 0	# Rooms 0	2.Fair 5.Avg+ 8.Exc
OPEN-3-CUSTOM 0	# Bedrooms 0	3.Avg- 6.Good 9.Same
OPEN-4-CUSTOM 0	# Full Baths 0	Phys. % Good 0%
Year Built 0	# Half Baths 0	Funct. % Good 100%
Year Remodeled 0	# Addn Fixtures 0	Functional Code 9 None
Foundation 0	# Fireplaces 0	1.Incomp 4.Bsmt 7.
1.Concrete 4.Wood 7.		2.O-Built 5. 8.LongTerm
2.C Block 5.Slab 8.		3.Damage 6.L-T Vaca 9.None
3.Br/Stone 6.Piers 9.		Econ. % Good 100%
Basement 0		Economic Code None
1.1/4 Bmt 4.Full Bmt 7.		0.None 3.No Power 7.
2.1/2 Bmt 5.None 8.		1.Location 4.Generate 8.
3.3/4 Bmt 6. 9.None		2.Encroach 9.None 9.
Bsmt Gar # Cars 0		Entrance Code 5 Estimated
Wet Basement 0		1.Interior 4.Vacant 7.
1.Dry 4. 7.		2.Refusal 5.Estimate 8.
2.Damp 5. 8.	3.Informed 6.Reviewed 9.	
3.Wet 6. 9.	Information Code 6 Exterior	
	1.Owner 4.Agent 7.	
	2.Relative 5.Estimate 8.	
	3.Tenant 6.Exterior 9.	

Date Inspected 6/16/2015

Additions, Outbuildings & Improvements

Type	Year	Units	Grade	Cond	Phys.	Funct.	Sound Value
998 14Mobile Home	2000	14x66	4 100	4	0 %	100 %	
68 Wood Deck	2011	32	3 100	4	0 %	100 %	
24 Frame Shed	2011				%	%	1,250
43 2S Frame Garage	2011	1360	3 100	4	0 %	75 %	
23 Frame Garage	2011	600	3 100	4	0 %	80 %	
409 Concrete Pad	2002	924	3 100	4	0 %	100 %	
					%	%	
					%	%	
					%	%	
					%	%	
					%	%	

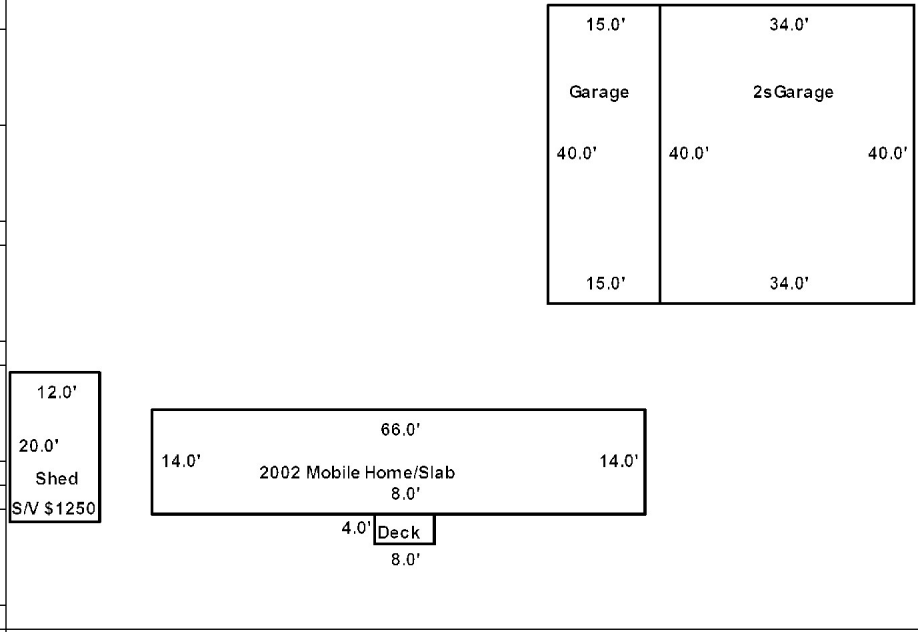

SAMON, MICHAEL E & JO ANN TRUSTEES
 SAMON FAMILY TRUST OF 2000
 265 HERSOM RD
 EASTON ME 04740

B3365P298 B4984P249

Property Data			Assessment Record				
Neighborhood	1 Resident/Agric.		Year	Land	Buildings	Exempt	Total
Tree Growth Year	0		2012	14,400	2,300	2,970	13,730
Recertified Date	0		2013	14,400	12,400	3,080	23,720
Y Coordinate	0		2014	14,400	18,200	3,080	29,520
Zone/Land Use	11 Residential		2015	41,000	28,400	16,000	53,400
Secondary Zone			2016	41,000	28,400	21,000	48,400
Topography	2 Rolling		2017	41,000	28,400	26,000	43,400
			2018	41,000	28,400	26,000	43,400
1.Level	4.Below St	7.					
2.Rolling	5.Low	8.					
3.Above St	6.Swampy	9.					
Utilities	4 Drilled Well 6 Septic System						
1.Public	4.Dr Well	7.Cesspool					
2.Water	5.Dug Well	8.					
3.Sewer	6.Septic	9.None					
Street	3 Gravel						
1.Paved	4.Proposed	7.					
2.Semi Imp	5.R/W	8.					
3.Gravel	6.	9.None					
FLOOD PLAIN	0						
CLASS	0						
Sale Data							
Sale Date							
Price							
Sale Type							
1.Land	4.Mobile	7.					
2.L & B	5.Other	8.					
3.Building	6.	9.					
Financing							
1.Convent	4.Seller	7.					
2.FHA/VA	5.Private	8.					
3.Assumed	6.Cash	9.Unknown					
Validity							
1.Valid	4.Split	7.Changes					
2.Related	5.Partial	8.Other					
3.Distress	6.Exempt	9.					
Verified							
1.Buyer	4.Agent	7.Family					
2.Seller	5.Pub Rec	8.Other					
3.Lender	6.MLS	9.					

Inspection Witnessed By:

No./Date	Description	Date Insp.
X		

Notes:

Easton

Land Data						
Front Foot	Type	Effective		Influence		Influence Codes
		Frontage	Depth	Factor	Code	
11.Regular Lot				%		1.Unimproved
12.Delta Triangle				%		2.Condition
13.Nabla Triangle				%		3.Topography
14.Rear Land				%		4.Size/Shape
15.Miscellaneous				%		5.Access
				%		6.Restricted
				%		7.Corner Infl
				%		8.Environment
				%		9.Fract Share
Square Foot		Square Feet				Acres
16.Regular Lot				%		32.Farmland Tilla
17.Class I Road				%		33.C R P
18.Class II Road				%		34.Softwood-Farm
19.Condominium				%		35.Mixed Wood-Far
20.Sound Value				%		36.Hardwood-Farm
				%		37.Softwood-TG
				%		38.Mixed Wood-TG
				%		39.Hardwood-TG
				%		40.Wasteland
				%		41.Gravel Pit
				%		42.Mobile Home Si
				%		43.Excess Indust
				%		44.Lot Improvemen
				%		45.Tower Site
				%		46.Miscellaneous
				%		47.Pavement
				%		48.Farmland Pastu
Total Acreage				37.00		

Easton

Map Lot 003-026

Account 906

Location 265 HERSOM ROAD

Card 1

Of 1

9/27/2018

Building Style	SF Bsmt Living	Layout
1.Conv. 5.Garrison 9.Gambrel	Fin Bsmt Grade	1.Typical 4. 7.
2.Ranch 6.Split 10.Saltbox	OPEN-5-CUSTOMIZE	2.Inadeq 5. 8.
3.R Ranch 7.Contemp 11.Other	Heat Type 100%	3.Horrid 6. 9.
4.Cape 8.Log 12.	1.HWBB/Rad 5.FWA 9.No Heat	Attic
Dwelling Units	2.HWCI 6.GravWA 10.	1.1/4 Fin 4.Full Fin 7.
Other Units	3.H Pump 7.Electric 11.	2.1/2 Fin 5.FI/Stair 8.
Stories	4.Steam 8.FI/Wall 12.	3.3/4 Fin 6. 9.None
1.1 4.1.5 7.	Cool Type 0%	Insulation
2.2 5.1.75 8.	1.Refrig 4.W&C Air 7.	1.Full 4.Minimal 7.
3.3 6.2.5 9.	2.Evapor 5. 8.	2.Heavy 5.Partial 8.
Exterior Walls	3.H Pump 6. 9.None	3.Capped 6. 9.None
1.Wood 5.Stucco 9.Other	Kitchen Style	Unfinished %
2.Vin/Al 6.Brick 10.	1.Modern 4.Obsolete 7.	Grade & Factor
3.Compos. 7.Stone 11.	2.Typical 5. 8.	1.E Grade 4.B Grade 7.
4.Asbestos 8.Concrete 12.	3.Old Type 6. 9.None	2.D Grade 5.A Grade 8.SC Grade
Roof Surface	Bath(s) Style	3.C Grade 6.AA Grade 9.Same
1.Asphalt 4.Composit 7.	1.Modern 4.Obsolete 7.	SQFT (Footprint)
2.Slate 5.Wood 8.	2.Typical 5. 8.	Condition
3.Metal 6.Other 9.	3.Old Type 6. 9.None	1.Poor 4.Avg 7.V G
SF Masonry Trim	# Rooms	2.Fair 5.Avg+ 8.Exc
OPEN-3-CUSTOM	# Bedrooms	3.Avg- 6.Good 9.Same
OPEN-4-CUSTOM	# Full Baths	Phys. % Good
Year Built	# Half Baths	Funct. % Good
Year Remodeled	# Addn Fixtures	Functional Code
Foundation	# Fireplaces	1.Incomp 4.Bsmt 7.
1.Concrete 4.Wood 7.	 <p>TRIO Software A Division of Harris Computer Systems</p>	2.O-Built 5. 8.LongTerm
2.C Block 5.Slab 8.		3.Damage 6.L-T Vaca 9.None
3.Br/Stone 6.Piers 9.		Econ. % Good
Basement		Economic Code
1.1/4 Bmt 4.Full Bmt 7.		0.None 3.No Power 7.
2.1/2 Bmt 5.None 8.		1.Location 4.Generate 8.
3.3/4 Bmt 6. 9.None		2.Encroach 9.None 9.
Bsmt Gar # Cars		Entrance Code 1 Interior Inspect
Wet Basement		1.Interior 4.Vacant 7.
1.Dry 4. 7.		2.Refusal 5.Estimate 8.
2.Damp 5. 8.	3.Informed 6.Reviewed 9.	
3.Wet 6. 9.	Information Code 1 Owner	
	1.Owner 4.Agent 7.	
	2.Relative 5.Estimate 8.	
	3.Tenant 6.Exterior 9.	

Date Inspected 6/16/2015

Additions, Outbuildings & Improvements

Type	Year	Units	Grade	Cond	Phys.	Funct.	Sound Value
756 Claridge M/H	1998	14x56	4 100	4	0 %	100 %	
61 Canopy	2013	70	2 100	4	0 %	100 %	
22 Encl Frame Porch	2013	88	2 100	4	0 %	100 %	
23 Frame Garage	2013	500	3 100	4	0 %	100 %	
24 Frame Shed	2013	240	3 100	4	0 %	80 %	
24 Frame Shed	2011	512	2 100	4	0 %	100 %	
					%	%	
					%	%	
					%	%	
					%	%	
					%	%	

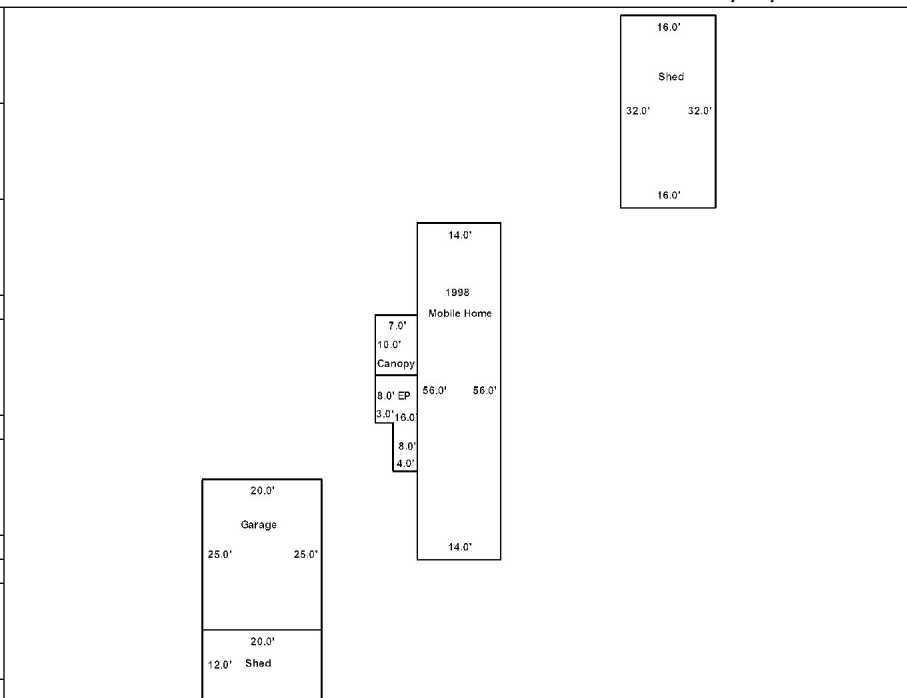

Easton

Map Lot 003-026-A

Account 495

Location 245 HERSOM ROAD

Card 1 Of 1 9/27/2018

Building Style 2 Ranch	SF Bsmt Living 0	Layout 1 Typical
1.Conv. 5.Garrison 9.Gambrel	Fin Bsmt Grade 0 0	1.Typical 4. 7.
2.Ranch 6.Split 10.Saltbox	OPEN-5-CUSTOMIZE 0	2.Inadeq 5. 8.
3.R Ranch 7.Contemp 11.Other	Heat Type 100% 1 Hot Water BB/Radiant	3.Horrid 6. 9.
4.Cape 8.Log 12.	1.HWBB/Rad 5.FWA 9.No Heat	Attic 9 None
Dwelling Units 1	2.HWCI 6.GravWA 10.	1.1/4 Fin 4.Full Fin 7.
Other Units 0	3.H Pump 7.Electric 11.	2.1/2 Fin 5.FI/Stair 8.
Stories 1 One Story	4.Steam 8.FI/Wall 12.	3.3/4 Fin 6. 9.None
1.1 4.1.5 7.	Cool Type 0% 9 None	Insulation 1 Full
2.2 5.1.75 8.	1.Refrig 4.W&C Air 7.	1.Full 4.Minimal 7.
3.3 6.2.5 9.	2.Evapor 5. 8.	2.Heavy 5.Partial 8.
Exterior Walls 2 Vinyl/Aluminum	3.H Pump 6. 9.None	3.Capped 6. 9.None
1.Wood 5.Stucco 9.Other	Kitchen Style 2 Typical	Unfinished % 0%
2.Vin/Al 6.Brick 10.	1.Modern 4.Obsolete 7.	Grade & Factor 3 Average 100%
3.Compos. 7.Stone 11.	2.Typical 5. 8.	1.E Grade 4.B Grade 7.
4.Asbestos 8.Concrete 12.	3.Old Type 6. 9.None	2.D Grade 5.A Grade 8.SC Grade
Roof Surface 3 Sheet Metal	Bath(s) Style 2 Typical Bath(s)	3.C Grade 6.AA Grade 9.Same
1.Asphalt 4.Composit 7.	1.Modern 4.Obsolete 7.	SQFT (Footprint) 1288
2.Slate 5.Wood 8.	2.Typical 5. 8.	Condition 4 Average
3.Metal 6.Other 9.	3.Old Type 6. 9.None	1.Poor 4.Avg 7.V G
SF Masonry Trim 0	# Rooms 5	2.Fair 5.Avg+ 8.Exc
OPEN-3-CUSTOM 0	# Bedrooms 3	3.Avg- 6.Good 9.Same
OPEN-4-CUSTOM 0	# Full Baths 1	Phys. % Good 0%
Year Built 1996	# Half Baths 1	Funct. % Good 100%
Year Remodeled 0	# Addn Fixtures 0	Functional Code 9 None
Foundation 1 Concrete	# Fireplaces 0	1.Incomp 4.Bsmt 7.
1.Concrete 4.Wood 7.	 <p>TRIO Software A Division of Harris Computer Systems</p>	2.O-Built 5. 8.LongTerm
2.C Block 5.Slab 8.		3.Damage 6.L-T Vaca 9.None
3.Br/Stone 6.Piers 9.		Econ. % Good 100%
Basement 4 Full Basement		Economic Code None
1.1/4 Bmt 4.Full Bmt 7.		0.None 3.No Power 7.
2.1/2 Bmt 5.None 8.		1.Location 4.Generate 8.
3.3/4 Bmt 6. 9.None		2.Encroach 9.None 9.
Bsmt Gar # Cars 0		Entrance Code 1 Interior Inspect
Wet Basement 3 Wet Basement		1.Interior 4.Vacant 7.
1.Dry 4. 7.		2.Refusal 5.Estimate 8.
2.Damp 5. 8.	3.Informed 6.Reviewed 9.	
3.Wet 6. 9.	Information Code 1 Owner	
		1.Owner 4.Agent 7.
		2.Relative 5.Estimate 8.
		3.Tenant 6.Exterior 9.

Date Inspected 6/22/2015

Additions, Outbuildings & Improvements

Type	Year	Units	Grade	Cond	Phys.	Funct.	Sound Value
22 Encl Frame Porch	1997	128	9 100	9	0 %	100 %	
68 Wood Deck	0	128	0 0	0	0 %	0 %	
21 Open Frame	2000	160	9 100	9	0 %	100 %	
68 Wood Deck	2000	104	9 100	9	0 %	100 %	
24 Frame Shed	2000				%	%	850
23 Frame Garage	1997	768	3 100	4	0 %	100 %	
					%	%	
					%	%	
					%	%	
					%	%	

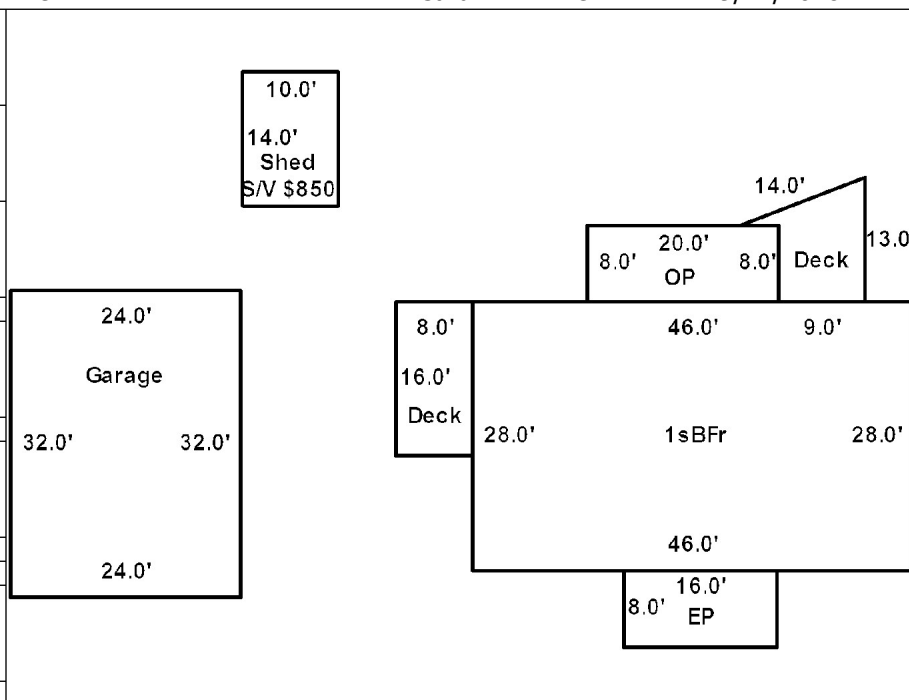

- 1.One Story Fram
- 2.Two Story Fram
- 3.Three Story Fr
- 4.1 & 1/2 Story
- 5.1 & 3/4 Story
- 6.2 & 1/2 Story
- 21.Open Frame Por
- 22.Encl Frame Por
- 23.Frame Garage
- 24.Frame Shed
- 25.Frame Bay Wind
- 26.1SFr Overhang
- 27.Unfin Basement
- 28.Unfinished Att
- 29.Finished Attic