

Easton

Map Lot 002-001

Account 15

Location HOULTON ROAD

Card 1 Of 1 9/27/2018

Building Style	SF Bsmt Living	Layout
1.Conv. 5.Garrison 9.Gambrel	Fin Bsmt Grade	1.Typical 4. 7.
2.Ranch 6.Split 10.Saltbox	OPEN-5-CUSTOMIZE	2.Inadeq 5. 8.
3.R Ranch 7.Contemp 11.Other	Heat Type 100%	3.Horrid 6. 9.
4.Cape 8.Log 12.	1.HWBB/Rad 5.FWA 9.No Heat	Attic
Dwelling Units	2.HWCI 6.GravWA 10.	1.1/4 Fin 4.Full Fin 7.
Other Units	3.H Pump 7.Electric 11.	2.1/2 Fin 5.F/Stair 8.
Stories	4.Steam 8.F/Wall 12.	3.3/4 Fin 6. 9.None
1.1 4.1.5 7.	Cool Type 0%	Insulation
2.2 5.1.75 8.	1.Refrig 4.W&C Air 7.	1.Full 4.Minimal 7.
3.3 6.2.5 9.	2.Evapor 5. 8.	2.Heavy 5.Partial 8.
Exterior Walls	3.H Pump 6. 9.None	3.Capped 6. 9.None
1.Wood 5.Stucco 9.Other	Kitchen Style	Unfinished %
2.Vin/Al 6.Brick 10.	1.Modern 4.Obsolete 7.	Grade & Factor
3.Compos. 7.Stone 11.	2.Typical 5. 8.	1.E Grade 4.B Grade 7.
4.Asbestos 8.Concrete 12.	3.Old Type 6. 9.None	2.D Grade 5.A Grade 8.SC Grade
Roof Surface	Bath(s) Style	3.C Grade 6.AA Grade 9.Same
1.Asphalt 4.Composit 7.	1.Modern 4.Obsolete 7.	SQFT (Footprint)
2.Slate 5.Wood 8.	2.Typical 5. 8.	Condition
3.Metal 6.Other 9.	3.Old Type 6. 9.None	1.Poor 4.Avg 7.V G
SF Masonry Trim	# Rooms	2.Fair 5.Avg+ 8.Exc
OPEN-3-CUSTOM	# Bedrooms	3.Avg- 6.Good 9.Same
OPEN-4-CUSTOM	# Full Baths	Phys. % Good
Year Built	# Half Baths	Funct. % Good
Year Remodeled	# Addn Fixtures	Functional Code
Foundation	# Fireplaces	1.Incomp 4.Bsmt 7.
1.Concrete 4.Wood 7.		2.O-Built 5. 8.LongTerm
2.C Block 5.Slab 8.		3.Damage 6.L-T Vaca 9.None
3.Br/Stone 6.Piers 9.		Econ. % Good
Basement		Economic Code
1.1/4 Bmt 4.Full Bmt 7.		0.None 3.No Power 7.
2.1/2 Bmt 5.None 8.		1.Location 4.Generate 8.
3.3/4 Bmt 6. 9.None		2.Encroach 9.None 9.
Bsmt Gar # Cars		Entrance Code 0
Wet Basement		1.Interior 4.Vacant 7.
1.Dry 4. 7.		2.Refusal 5.Estimate 8.
2.Damp 5. 8.	3.Informed 6.Reviewed 9.	
3.Wet 6. 9.	Information Code 0	
Date Inspected	1.Owner 4.Agent 7.	
	2.Relative 5.Estimate 8.	
	3.Tenant 6.Exterior 9.	

Additions, Outbuildings & Improvements								1.One Story Fram
Type	Year	Units	Grade	Cond	Phys.	Funct.	Sound Value	2.Two Story Fram
					%	%		3.Three Story Fr
					%	%		4.1 & 1/2 Story
					%	%		5.1 & 3/4 Story
					%	%		6.2 & 1/2 Story
					%	%		21.Open Frame Por
					%	%		22.Encl Frame Por
					%	%		23.Frame Garage
					%	%		24.Frame Shed
					%	%		25.Frame Bay Wind
					%	%		26.1SFr Overhang
					%	%		27.Unfin Basement
					%	%		28.Unfinished Att
					%	%		29.Finished Attic

Easton

Map Lot 002-002

Account 527

Location HERSOM ROAD

Card 1 Of 1 9/27/2018

Building Style 0	SF Bsmt Living 0	Layout 0
1.Conv. 5.Garrison 9.Gambrel	Fin Bsmt Grade 0 0	1.Typical 4. 7.
2.Ranch 6.Split 10.Saltbox	OPEN-5-CUSTOMIZE 0	2.Inadeq 5. 8.
3.R Ranch 7.Contemp 11.Other	Heat Type 100% 0	3.Horrid 6. 9.
4.Cape 8.Log 12.	1.HWBB/Rad 5.FWA 9.No Heat	Attic 0
Dwelling Units 0	2.HWCI 6.GravWA 10.	1.1/4 Fin 4.Full Fin 7.
Other Units 0	3.H Pump 7.Electric 11.	2.1/2 Fin 5.F/Stair 8.
Stories 0	4.Steam 8.F/Wall 12.	3.3/4 Fin 6. 9.None
1.1 4.1.5 7.	Cool Type 0% 9 None	Insulation 0
2.2 5.1.75 8.	1.Refrig 4.W&C Air 7.	1.Full 4.Minimal 7.
3.3 6.2.5 9.	2.Evapor 5. 8.	2.Heavy 5.Partial 8.
Exterior Walls 0	3.H Pump 6. 9.None	3.Capped 6. 9.None
1.Wood 5.Stucco 9.Other	Kitchen Style 0	Unfinished % 0%
2.Vin/Al 6.Brick 10.	1.Modern 4.Obsolete 7.	Grade & Factor 0 0%
3.Compos. 7.Stone 11.	2.Typical 5. 8.	1.E Grade 4.B Grade 7.
4.Asbestos 8.Concrete 12.	3.Old Type 6. 9.None	2.D Grade 5.A Grade 8.SC Grade
Roof Surface 0	Bath(s) Style 0	3.C Grade 6.AA Grade 9.Same
1.Asphalt 4.Composit 7.	1.Modern 4.Obsolete 7.	SQFT (Footprint) 0
2.Slate 5.Wood 8.	2.Typical 5. 8.	Condition 0
3.Metal 6.Other 9.	3.Old Type 6. 9.None	1.Poor 4.Avg 7.V G
SF Masonry Trim 0	# Rooms 0	2.Fair 5.Avg+ 8.Exc
OPEN-3-CUSTOM 0	# Bedrooms 0	3.Avg- 6.Good 9.Same
OPEN-4-CUSTOM 0	# Full Baths 0	Phys. % Good 0%
Year Built 0	# Half Baths 0	Funct. % Good 100%
Year Remodeled 0	# Addn Fixtures 0	Functional Code 9 None
Foundation 0	# Fireplaces 0	1.Incomp 4.Bsmt 7.
1.Concrete 4.Wood 7.		2.O-Built 5. 8.LongTerm
2.C Block 5.Slab 8.		3.Damage 6.L-T Vaca 9.None
3.Br/Stone 6.Piers 9.		Econ. % Good 100%
Basement 0		Economic Code None
1.1/4 Bmt 4.Full Bmt 7.		0.None 3.No Power 7.
2.1/2 Bmt 5.None 8.		1.Location 4.Generate 8.
3.3/4 Bmt 6. 9.None		2.Encroach 9.None 9.
Bsmt Gar # Cars 0		Entrance Code 0
Wet Basement 0		1.Interior 4.Vacant 7.
1.Dry 4. 7.		2.Refusal 5.Estimate 8.
2.Damp 5. 8.	3.Informed 6.Reviewed 9.	
3.Wet 6. 9.	Information Code 0	
		1.Owner 4.Agent 7.
		2.Relative 5.Estimate 8.
		3.Tenant 6.Exterior 9.

Date Inspected

Additions, Outbuildings & Improvements

Type	Year	Units	Grade	Cond	Phys.	Funct.	Sound Value
					%	%	1.One Story Fram
					%	%	2.Two Story Fram
					%	%	3.Three Story Fr
					%	%	4.1 & 1/2 Story
					%	%	5.1 & 3/4 Story
					%	%	6.2 & 1/2 Story
					%	%	21.Open Frame Por
					%	%	22.Encl Frame Por
					%	%	23.Frame Garage
					%	%	24.Frame Shed
					%	%	25.Frame Bay Wind
					%	%	26.1SFr Overhang
					%	%	27.Unfin Basement
					%	%	28.Unfinished Att
					%	%	29.Finished Attic

Easton

Map Lot 002-003

Account 561

Location HERSOM ROAD

Card 1 Of 1 9/27/2018

Building Style	SF Bsmt Living	Layout
1.Conv. 5.Garrison 9.Gambrel	Fin Bsmt Grade	1.Typical 4. 7.
2.Ranch 6.Split 10.Saltbox	OPEN-5-CUSTOMIZE	2.Inadeq 5. 8.
3.R Ranch 7.Contemp 11.Other	Heat Type 100%	3.Horrid 6. 9.
4.Cape 8.Log 12.	1.HWBB/Rad 5.FWA 9.No Heat	Attic
Dwelling Units	2.HWCI 6.GravWA 10.	1.1/4 Fin 4.Full Fin 7.
Other Units	3.H Pump 7.Electric 11.	2.1/2 Fin 5.F/Stair 8.
Stories	4.Steam 8.F/Wall 12.	3.3/4 Fin 6. 9.None
1.1 4.1.5 7.	Cool Type 0%	Insulation
2.2 5.1.75 8.	1.Refrig 4.W&C Air 7.	1.Full 4.Minimal 7.
3.3 6.2.5 9.	2.Evapor 5. 8.	2.Heavy 5.Partial 8.
Exterior Walls	3.H Pump 6. 9.None	3.Capped 6. 9.None
1.Wood 5.Stucco 9.Other	Kitchen Style	Unfinished %
2.Vin/Al 6.Brick 10.	1.Modern 4.Obsolete 7.	Grade & Factor
3.Compos. 7.Stone 11.	2.Typical 5. 8.	1.E Grade 4.B Grade 7.
4.Asbestos 8.Concrete 12.	3.Old Type 6. 9.None	2.D Grade 5.A Grade 8.SC Grade
Roof Surface	Bath(s) Style	3.C Grade 6.AA Grade 9.Same
1.Asphalt 4.Composit 7.	1.Modern 4.Obsolete 7.	SQFT (Footprint)
2.Slate 5.Wood 8.	2.Typical 5. 8.	Condition
3.Metal 6.Other 9.	3.Old Type 6. 9.None	1.Poor 4.Avg 7.V G
SF Masonry Trim	# Rooms	2.Fair 5.Avg+ 8.Exc
OPEN-3-CUSTOM	# Bedrooms	3.Avg- 6.Good 9.Same
OPEN-4-CUSTOM	# Full Baths	Phys. % Good
Year Built	# Half Baths	Funct. % Good
Year Remodeled	# Addn Fixtures	Functional Code
Foundation	# Fireplaces	1.Incomp 4.Bsmt 7.
1.Concrete 4.Wood 7.		2.O-Built 5. 8.LongTerm
2.C Block 5.Slab 8.		3.Damage 6.L-T Vaca 9.None
3.Br/Stone 6.Piers 9.		Econ. % Good
Basement		Economic Code
1.1/4 Bmt 4.Full Bmt 7.		0.None 3.No Power 7.
2.1/2 Bmt 5.None 8.		1.Location 4.Generate 8.
3.3/4 Bmt 6. 9.None		2.Encroach 9.None 9.
Bsmt Gar # Cars		Entrance Code 0
Wet Basement		1.Interior 4.Vacant 7.
1.Dry 4. 7.		2.Refusal 5.Estimate 8.
2.Damp 5. 8.	3.Informed 6.Reviewed 9.	
3.Wet 6. 9.	Information Code 0	
Date Inspected	1.Owner 4.Agent 7.	
	2.Relative 5.Estimate 8.	
	3.Tenant 6.Exterior 9.	

Additions, Outbuildings & Improvements								1.One Story Fram
Type	Year	Units	Grade	Cond	Phys.	Funct.	Sound Value	2.Two Story Fram
					%	%		3.Three Story Fr
					%	%		4.1 & 1/2 Story
					%	%		5.1 & 3/4 Story
					%	%		6.2 & 1/2 Story
					%	%		21.Open Frame Por
					%	%		22.Encl Frame Por
					%	%		23.Frame Garage
					%	%		24.Frame Shed
					%	%		25.Frame Bay Wind
					%	%		26.1SFr Overhang
					%	%		27.Unfin Basement
					%	%		28.Unfinished Att
					%	%		29.Finished Attic

Easton

Map Lot 002-004

Account 14

Location HERSOM ROAD

Card 1 Of 1 9/27/2018

Building Style 0	SF Bsmt Living 0	Layout 0
1.Conv. 5.Garrison 9.Gambrel	Fin Bsmt Grade 0 0	1.Typical 4. 7.
2.Ranch 6.Split 10.Saltbox	OPEN-5-CUSTOMIZE 0	2.Inadeq 5. 8.
3.R Ranch 7.Contemp 11.Other	Heat Type 100% 0	3.Horrid 6. 9.
4.Cape 8.Log 12.	1.HWBB/Rad 5.FWA 9.No Heat	Attic 0
Dwelling Units 0	2.HWCI 6.GravWA 10.	1.1/4 Fin 4.Full Fin 7.
Other Units 0	3.H Pump 7.Electric 11.	2.1/2 Fin 5.F/Stair 8.
Stories 0	4.Steam 8.F/Wall 12.	3.3/4 Fin 6. 9.None
1.1 4.1.5 7.	Cool Type 0% 9 None	Insulation 0
2.2 5.1.75 8.	1.Refrig 4.W&C Air 7.	1.Full 4.Minimal 7.
3.3 6.2.5 9.	2.Evapor 5. 8.	2.Heavy 5.Partial 8.
Exterior Walls 0	3.H Pump 6. 9.None	3.Capped 6. 9.None
1.Wood 5.Stucco 9.Other	Kitchen Style 0	Unfinished % 0%
2.Vin/Al 6.Brick 10.	1.Modern 4.Obsolete 7.	Grade & Factor 0 0%
3.Compos. 7.Stone 11.	2.Typical 5. 8.	1.E Grade 4.B Grade 7.
4.Asbestos 8.Concrete 12.	3.Old Type 6. 9.None	2.D Grade 5.A Grade 8.SC Grade
Roof Surface 0	Bath(s) Style 0	3.C Grade 6.AA Grade 9.Same
1.Asphalt 4.Composit 7.	1.Modern 4.Obsolete 7.	SQFT (Footprint) 0
2.Slate 5.Wood 8.	2.Typical 5. 8.	Condition 0
3.Metal 6.Other 9.	3.Old Type 6. 9.None	1.Poor 4.Avg 7.V G
SF Masonry Trim 0	# Rooms 0	2.Fair 5.Avg+ 8.Exc
OPEN-3-CUSTOM 0	# Bedrooms 0	3.Avg- 6.Good 9.Same
OPEN-4-CUSTOM 0	# Full Baths 0	Phys. % Good 0%
Year Built 0	# Half Baths 0	Funct. % Good 100%
Year Remodeled 0	# Addn Fixtures 0	Functional Code 9 None
Foundation 0	# Fireplaces 0	1.Incomp 4.Bsmt 7.
1.Concrete 4.Wood 7.		2.O-Built 5. 8.LongTerm
2.C Block 5.Slab 8.		3.Damage 6.L-T Vaca 9.None
3.Br/Stone 6.Piers 9.		Econ. % Good 100%
Basement 0		Economic Code None
1.1/4 Bmt 4.Full Bmt 7.		0.None 3.No Power 7.
2.1/2 Bmt 5.None 8.		1.Location 4.Generate 8.
3.3/4 Bmt 6. 9.None		2.Encroach 9.None 9.
Bsmt Gar # Cars 0		Entrance Code 0
Wet Basement 0		1.Interior 4.Vacant 7.
1.Dry 4. 7.		2.Refusal 5.Estimate 8.
2.Damp 5. 8.	3.Informed 6.Reviewed 9.	
3.Wet 6. 9.	Information Code 0	
		1.Owner 4.Agent 7.
		2.Relative 5.Estimate 8.
		3.Tenant 6.Exterior 9.

Date Inspected

Additions, Outbuildings & Improvements

Type	Year	Units	Grade	Cond	Phys.	Funct.	Sound Value
					%	%	1.One Story Fram
					%	%	2.Two Story Fram
					%	%	3.Three Story Fr
					%	%	4.1 & 1/2 Story
					%	%	5.1 & 3/4 Story
					%	%	6.2 & 1/2 Story
					%	%	21.Open Frame Por
					%	%	22.Encl Frame Por
					%	%	23.Frame Garage
					%	%	24.Frame Shed
					%	%	25.Frame Bay Wind
					%	%	26.1SFr Overhang
					%	%	27.Unfin Basement
					%	%	28.Unfinished Att
					%	%	29.Finished Attic

Easton

Map Lot 002-005-A

Account 371

Location 235 HERSOM ROAD

Card 1 Of 1 9/27/2018

Building Style 10 Saltbox	SF Bsmt Living 0	Layout 1 Typical
1.Conv. 5.Garrison 9.Gambrel	Fin Bsmt Grade 0 0	1.Typical 4. 7.
2.Ranch 6.Split 10.Saltbox	OPEN-5-CUSTOMIZE 0	2.Inadeq 5. 8.
3.R Ranch 7.Contemp 11.Other	Heat Type 100% 5 Forced Warm Air	3.Horrid 6. 9.
4.Cape 8.Log 12.	1.HWBB/Rad 5.FWA 9.No Heat	Attic 9 None
Dwelling Units 1	2.HWCI 6.GravWA 10.	1.1/4 Fin 4.Full Fin 7.
Other Units 0	3.H Pump 7.Electric 11.	2.1/2 Fin 5.FI/Stair 8.
Stories 4 One & 1/2 Story	4.Steam 8.FI/Wall 12.	3.3/4 Fin 6. 9.None
1.1 4.1.5 7.	Cool Type 0% 9 None	Insulation 5 Partial
2.2 5.1.75 8.	1.Refrig 4.W&C Air 7.	1.Full 4.Minimal 7.
3.3 6.2.5 9.	2.Evapor 5. 8.	2.Heavy 5.Partial 8.
Exterior Walls 3 Composition	3.H Pump 6. 9.None	3.Capped 6. 9.None
1.Wood 5.Stucco 9.Other	Kitchen Style 2 Typical	Unfinished % 0%
2.Vin/Al 6.Brick 10.	1.Modern 4.Obsolete 7.	Grade & Factor 2 Fair 100%
3.Compos. 7.Stone 11.	2.Typical 5. 8.	1.E Grade 4.B Grade 7.
4.Asbestos 8.Concrete 12.	3.Old Type 6. 9.None	2.D Grade 5.A Grade 8.SC Grade
Roof Surface 3 Sheet Metal	Bath(s) Style 2 Typical Bath(s)	3.C Grade 6.AA Grade 9.Same
1.Asphalt 4.Composit 7.	1.Modern 4.Obsolete 7.	SQFT (Footprint) 560
2.Slate 5.Wood 8.	2.Typical 5. 8.	Condition 2 Fair
3.Metal 6.Other 9.	3.Old Type 6. 9.None	1.Poor 4.Avg 7.V G
SF Masonry Trim 0	# Rooms 5	2.Fair 5.Avg+ 8.Exc
OPEN-3-CUSTOM 0	# Bedrooms 3	3.Avg- 6.Good 9.Same
OPEN-4-CUSTOM 0	# Full Baths 1	Phys. % Good 0%
Year Built 1950	# Half Baths 0	Funct. % Good 100%
Year Remodeled 0	# Addn Fixtures 0	Functional Code 9 None
Foundation 3 Brick &/or Stone	# Fireplaces 0	1.Incomp 4.Bsmt 7.
1.Concrete 4.Wood 7.	 <p>TRIO Software A Division of Harris Computer Systems</p>	2.O-Built 5. 8.LongTerm
2.C Block 5.Slab 8.		3.Damage 6.L-T Vaca 9.None
3.Br/Stone 6.Piers 9.		Econ. % Good 100%
Basement 4 Full Basement		Economic Code None
1.1/4 Bmt 4.Full Bmt 7.		0.None 3.No Power 7.
2.1/2 Bmt 5.None 8.		1.Location 4.Generate 8.
3.3/4 Bmt 6. 9.None		2.Encroach 9.None 9.
Bsmt Gar # Cars 0		Entrance Code 3 Information Only
Wet Basement 2 Damp Basement		1.Interior 4.Vacant 7.
1.Dry 4. 7.		2.Refusal 5.Estimate 8.
2.Damp 5. 8.	3.Informed 6.Reviewed 9.	
3.Wet 6. 9.	Information Code 1 Owner	
		1.Owner 4.Agent 7.
		2.Relative 5.Estimate 8.
		3.Tenant 6.Exterior 9.

8.0'
10.0'
Shed

Doghouse
No Add

S/V \$100

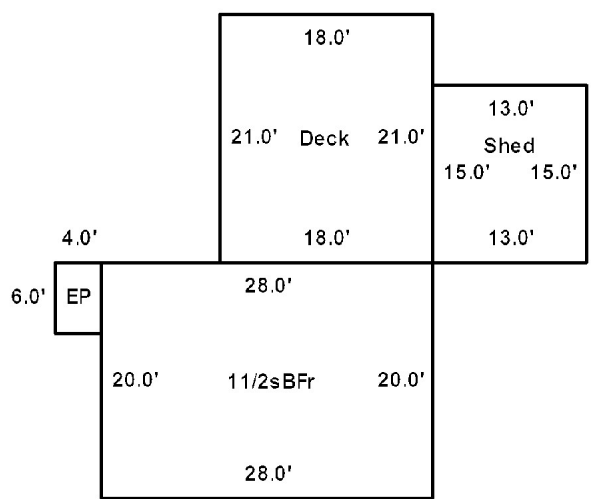

Date Inspected 6/10/2015

Additions, Outbuildings & Improvements

Type	Year	Units	Grade	Cond	Phys.	Funct.	Sound Value
22 Encl Frame Porch	0	24	0 0	0	0 %	0 %	
24 Frame Shed	0				%	%	100
68 Wood Deck	2012	378	2 100	4	0 %	100 %	
24 Frame Shed	2014	195	9 100	4	0 %	100 %	
					%	%	
					%	%	
					%	%	
					%	%	
					%	%	
					%	%	
					%	%	
					%	%	



- 1.One Story Fram
- 2.Two Story Fram
- 3.Three Story Fr
- 4.1 & 1/2 Story
- 5.1 & 3/4 Story
- 6.2 & 1/2 Story
- 21.Open Frame Por
- 22.Encl Frame Por
- 23.Frame Garage
- 24.Frame Shed
- 25.Frame Bay Wind
- 26.1SFr Overhang
- 27.Unfin Basement
- 28.Unfinished Att
- 29.Finished Attic

Easton

Map Lot 002-005-B

Account 497

Location HERSOM ROAD

Card 1 Of 1 9/27/2018

Building Style 0	SF Bsmt Living 0	Layout 0
1.Conv. 5.Garrison 9.Gambrel	Fin Bsmt Grade 0 0	1.Typical 4. 7.
2.Ranch 6.Split 10.Saltbox	OPEN-5-CUSTOMIZE 0	2.Inadeq 5. 8.
3.R Ranch 7.Contemp 11.Other	Heat Type 100% 0	3.Horrid 6. 9.
4.Cape 8.Log 12.	1.HWBB/Rad 5.FWA 9.No Heat	Attic 0
Dwelling Units 0	2.HWCI 6.GravWA 10.	1.1/4 Fin 4.Full Fin 7.
Other Units 0	3.H Pump 7.Electric 11.	2.1/2 Fin 5.F/Stair 8.
Stories 0	4.Steam 8.F/Wall 12.	3.3/4 Fin 6. 9.None
1.1 4.1.5 7.	Cool Type 0% 9 None	Insulation 0
2.2 5.1.75 8.	1.Refrig 4.W&C Air 7.	1.Full 4.Minimal 7.
3.3 6.2.5 9.	2.Evapor 5. 8.	2.Heavy 5.Partial 8.
Exterior Walls 0	3.H Pump 6. 9.None	3.Capped 6. 9.None
1.Wood 5.Stucco 9.Other	Kitchen Style 0	Unfinished % 0%
2.Vin/Al 6.Brick 10.	1.Modern 4.Obsolete 7.	Grade & Factor 0 0%
3.Compos. 7.Stone 11.	2.Typical 5. 8.	1.E Grade 4.B Grade 7.
4.Asbestos 8.Concrete 12.	3.Old Type 6. 9.None	2.D Grade 5.A Grade 8.SC Grade
Roof Surface 0	Bath(s) Style 0	3.C Grade 6.AA Grade 9.Same
1.Asphalt 4.Composit 7.	1.Modern 4.Obsolete 7.	SQFT (Footprint) 0
2.Slate 5.Wood 8.	2.Typical 5. 8.	Condition 0
3.Metal 6.Other 9.	3.Old Type 6. 9.None	1.Poor 4.Avg 7.V G
SF Masonry Trim 0	# Rooms 0	2.Fair 5.Avg+ 8.Exc
OPEN-3-CUSTOM 0	# Bedrooms 0	3.Avg- 6.Good 9.Same
OPEN-4-CUSTOM 0	# Full Baths 0	Phys. % Good 0%
Year Built 0	# Half Baths 0	Funct. % Good 100%
Year Remodeled 0	# Addn Fixtures 0	Functional Code 9 None
Foundation 0	# Fireplaces 0	1.Incomp 4.Bsmt 7.
1.Concrete 4.Wood 7.		2.O-Built 5. 8.LongTerm
2.C Block 5.Slab 8.		3.Damage 6.L-T Vaca 9.None
3.Br/Stone 6.Piers 9.		Econ. % Good 100%
Basement 0		Economic Code None
1.1/4 Bmt 4.Full Bmt 7.		0.None 3.No Power 7.
2.1/2 Bmt 5.None 8.		1.Location 4.Generate 8.
3.3/4 Bmt 6. 9.None		2.Encroach 9.None 9.
Bsmt Gar # Cars 0		Entrance Code 0
Wet Basement 0		1.Interior 4.Vacant 7.
1.Dry 4. 7.		2.Refusal 5.Estimate 8.
2.Damp 5. 8.	3.Informed 6.Reviewed 9.	
3.Wet 6. 9.	Information Code 0	
		1.Owner 4.Agent 7.
		2.Relative 5.Estimate 8.
		3.Tenant 6.Exterior 9.

Date Inspected

Additions, Outbuildings & Improvements

Type	Year	Units	Grade	Cond	Phys.	Funct.	Sound Value
					%	%	1.One Story Fram
					%	%	2.Two Story Fram
					%	%	3.Three Story Fr
					%	%	4.1 & 1/2 Story
					%	%	5.1 & 3/4 Story
					%	%	6.2 & 1/2 Story
					%	%	21.Open Frame Por
					%	%	22.Encl Frame Por
					%	%	23.Frame Garage
					%	%	24.Frame Shed
					%	%	25.Frame Bay Wind
					%	%	26.1SFr Overhang
					%	%	27.Unfin Basement
					%	%	28.Unfinished Att
					%	%	29.Finished Attic

MATRULLO, THOMAS J (TRUSTEE)
THOMAS J MATRULLO REVOCABLE TRUST
4285 LAGO WAY
SARASOTA FL 34241

B3266P158

Property Data			Assessment Record				
Neighborhood	1 Resident/Agric.		Year	Land	Buildings	Exempt	Total
Tree Growth Year	0		2010	10,800	0	0	10,800
Recertified Date	0		2011	10,800	0	0	10,800
Y Coordinate	0		2012	10,800	0	0	10,800
Zone/Land Use	11 Residential		2013	10,800	0	0	10,800
Secondary Zone			2014	10,800	0	0	10,800
Topography	1 Level	2 Rolling	2015	29,000	0	0	29,000
1.Level	4.Below St	7.	2016	29,000	0	0	29,000
2.Rolling	5.Low	8.	2017	29,000	0	0	29,000
3.Above St	6.Swampy	9.	2018	29,000	0	0	29,000
Utilities	9 None						
1.Public	4.Dr Well	7.Cesspool					
2.Water	5.Dug Well	8.					
3.Sewer	6.Septic	9.None					
Street	1 Paved						
1.Paved	4.Proposed	7.					
2.Semi Imp	5.R/W	8.					
3.Gravel	6.	9.None					

Inspection Witnessed By:

X	Date
No./Date	Description
	Date Insp.

Notes:

Sale Data		
Sale Date	10/01/1987	
Price	16,100	
Sale Type	1 Land Only	
1.Land	4.Mobile	7.
2.L & B	5.Other	8.
3.Building	6.	9.
Financing	9 Unknown	
1.Convent	4.Seller	7.
2.FHA/VA	5.Private	8.
3.Assumed	6.Cash	9.Unknown
Validity	1 Arms Length Sale	
1.Valid	4.Split	7.Changes
2.Related	5.Partial	8.Other
3.Distress	6.Exempt	9.
Verified	5 Public Record	
1.Buyer	4.Agent	7.Family
2.Seller	5.Pub Rec	8.Other
3.Lender	6.MLS	9.

Land Data						
Front Foot	Type	Effective		Influence		Influence Codes
		Frontage	Depth	Factor	Code	
11.Regular Lot				%		1.Unimproved
12.Delta Triangle				%		2.Condition
13.Nabla Triangle				%		3.Topography
14.Rear Land				%		4.Size/Shape
15.Miscellaneous				%		5.Access
				%		6.Restricted
				%		7.Corner Infl
				%		8.Environment
				%		9.Fract Share
Square Foot		Square Feet				Acres
16.Regular Lot				%		32.Farmland Tilla
17.Class I Road				%		33.C R P
18.Class II Road				%		34.Softwood-Farm
19.Condominium				%		35.Mixed Wood-Far
20.Sound Value				%		36.Hardwood-Farm
				%		37.Softwood-TG
				%		38.Mixed Wood-TG
				%		39.Hardwood-TG
				%		40.Wasteland
				%		41.Gravel Pit
				%		42.Mobile Home Si
				%		43.Excess Indust
				%		44.Lot Improvemen
				%		45.Tower Site
				%		46.Miscellaneous
				%		47.Pavement
				%		48.Farmland Pastu
Total Acreage		40.00				

Easton

Map Lot 002-005-C

Account 496

Location HERSOM ROAD

Card 1 Of 1 9/27/2018

Building Style 0	SF Bsmt Living 0	Layout 0
1.Conv. 5.Garrison 9.Gambrel	Fin Bsmt Grade 0 0	1.Typical 4. 7.
2.Ranch 6.Split 10.Saltbox	OPEN-5-CUSTOMIZE 0	2.Inadeq 5. 8.
3.R Ranch 7.Contemp 11.Other	Heat Type 100% 0	3.Horrid 6. 9.
4.Cape 8.Log 12.	1.HWBB/Rad 5.FWA 9.No Heat	Attic 0
Dwelling Units 0	2.HWCI 6.GravWA 10.	1.1/4 Fin 4.Full Fin 7.
Other Units 0	3.H Pump 7.Electric 11.	2.1/2 Fin 5.F/Stair 8.
Stories 0	4.Steam 8.F/Wall 12.	3.3/4 Fin 6. 9.None
1.1 4.1.5 7.	Cool Type 0% 9 None	Insulation 0
2.2 5.1.75 8.	1.Refrig 4.W&C Air 7.	1.Full 4.Minimal 7.
3.3 6.2.5 9.	2.Evapor 5. 8.	2.Heavy 5.Partial 8.
Exterior Walls 0	3.H Pump 6. 9.None	3.Capped 6. 9.None
1.Wood 5.Stucco 9.Other	Kitchen Style 0	Unfinished % 0%
2.Vin/Al 6.Brick 10.	1.Modern 4.Obsolete 7.	Grade & Factor 0 0%
3.Compos. 7.Stone 11.	2.Typical 5. 8.	1.E Grade 4.B Grade 7.
4.Asbestos 8.Concrete 12.	3.Old Type 6. 9.None	2.D Grade 5.A Grade 8.SC Grade
Roof Surface 0	Bath(s) Style 0	3.C Grade 6.AA Grade 9.Same
1.Asphalt 4.Composit 7.	1.Modern 4.Obsolete 7.	SQFT (Footprint) 0
2.Slate 5.Wood 8.	2.Typical 5. 8.	Condition 0
3.Metal 6.Other 9.	3.Old Type 6. 9.None	1.Poor 4.Avg 7.V G
SF Masonry Trim 0	# Rooms 0	2.Fair 5.Avg+ 8.Exc
OPEN-3-CUSTOM 0	# Bedrooms 0	3.Avg- 6.Good 9.Same
OPEN-4-CUSTOM 0	# Full Baths 0	Phys. % Good 0%
Year Built 0	# Half Baths 0	Funct. % Good 100%
Year Remodeled 0	# Addn Fixtures 0	Functional Code 9 None
Foundation 0	# Fireplaces 0	1.Incomp 4.Bsmt 7.
1.Concrete 4.Wood 7.		2.O-Built 5. 8.LongTerm
2.C Block 5.Slab 8.		3.Damage 6.L-T Vaca 9.None
3.Br/Stone 6.Piers 9.		Econ. % Good 100%
Basement 0		Economic Code None
1.1/4 Bmt 4.Full Bmt 7.		0.None 3.No Power 7.
2.1/2 Bmt 5.None 8.		1.Location 4.Generate 8.
3.3/4 Bmt 6. 9.None		2.Encroach 9.None 9.
Bsmt Gar # Cars 0		Entrance Code 0
Wet Basement 0		1.Interior 4.Vacant 7.
1.Dry 4. 7.		2.Refusal 5.Estimate 8.
2.Damp 5. 8.	3.Informed 6.Reviewed 9.	
3.Wet 6. 9.	Information Code 0	
		1.Owner 4.Agent 7.
		2.Relative 5.Estimate 8.
		3.Tenant 6.Exterior 9.

Date Inspected

Additions, Outbuildings & Improvements

Type	Year	Units	Grade	Cond	Phys.	Funct.	Sound Value
					%	%	1.One Story Fram
					%	%	2.Two Story Fram
					%	%	3.Three Story Fr
					%	%	4.1 & 1/2 Story
					%	%	5.1 & 3/4 Story
					%	%	6.2 & 1/2 Story
					%	%	21.Open Frame Por
					%	%	22.Encl Frame Por
					%	%	23.Frame Garage
					%	%	24.Frame Shed
					%	%	25.Frame Bay Wind
					%	%	26.1SFr Overhang
					%	%	27.Unfin Basement
					%	%	28.Unfinished Att
					%	%	29.Finished Attic

FARLAND, JOHN J
134 SOUTHBRIDGE ROAD
NORTH OXFORD MA 01537

B3902P25 B5604P147

Previous Owner
DERNLAN, GARY D
14575 PADDOCK DRIVE

WELLINGTON FL 33414
Sale Date: 2/26/2014

Inspection Witnessed By:

X Date

No./Date	Description	Date Insp.

Notes:

Easton

Property Data			Assessment Record						
Neighborhood 1 Resident/Agric.			Year	Land	Buildings	Exempt	Total		
Tree Growth Year 0			2010	13,200	0	0	13,200		
Recertified Date 0			2011	13,200	0	0	13,200		
Y Coordinate 0			2012	13,200	0	0	13,200		
Zone/Land Use 11 Residential			2013	13,200	0	0	13,200		
Secondary Zone			2014	13,200	0	0	13,200		
Topography 1 Level 2 Rolling			2015	36,000	0	0	36,000		
1.Level 4.Below St 7.			2016	36,000	0	0	36,000		
2.Rolling 5.Low 8.			2017	36,000	0	0	36,000		
3.Above St 6.Swampy 9.			2018	36,000	0	0	36,000		
Utilities 9 None									
1.Public 4.Dr Well 7.Cesspool									
2.Water 5.Dug Well 8.									
3.Sewer 6.Septic 9.None									
Street 1 Paved									
1.Paved 4.Proposed 7.									
2.Semi Imp 5.R/W 8.									
3.Gravel 6. 9.None									
FLOOD PLAIN 0			Land Data						
CLASS 1			Front Foot	Type	Effective		Influence		Influence Codes
Sale Data					Frontage	Depth	Factor	Code	
Sale Date 2/26/2014			11.Regular Lot						1.Unimproved
Price 20,400			12.Delta Triangle						2.Condition
Sale Type 1 Land Only			13.Nabla Triangle						3.Topography
1.Land 4.Mobile 7.			14.Rear Land						4.Size/Shape
2.L & B 5.Other 8.			15.Miscellaneous						5.Access
3.Building 6. 9.									6.Restricted
Financing 9 Unknown									7.Corner Infl
1.Convent 4.Seller 7.			Square Foot	Square Feet					8.Environment
2.FHA/VA 5.Private 8.			16.Regular Lot						9.Fract Share
3.Assumed 6.Cash 9.Unknown			17.Class I Road						Acres
Validity 1 Arms Length Sale			18.Class II Road						32.Farmland Tilla
1.Valid 4.Split 7.Changes			19.Condominium						33.C R P
2.Related 5.Partial 8.Other			20.Sound Value						34.Softwood-Farm
3.Distress 6.Exempt 9.									35.Mixed Wood-Far
Verified 5 Public Record			Fract. Acre	Acreege/Sites					36.Hardwood-Farm
1.Buyer 4.Agent 7.Family			21.Homesite (Frac	25	1.00	100	%	0	37.Softwood-TG
2.Seller 5.Pub Rec 8.Other			22.Baselot (Fract	28	53.00	100	%	0	38.Mixed Wood-TG
3.Lender 6.MLS 9.			23.Misc (Fract)						39.Hardwood-TG
			Acres						40.Wasteland
			24.Homesite						41.Gravel Pit
			25.Baselot						42.Mobile Home Si
			26.Secondary						43.Excess Indust
			27.Frontage						44.Lot Improvemen
			28.Rear Land (All	Total Acreege		54.00			45.Tower Site
			31.Tillable						46.Miscellaneous
									47.Pavement
									48.Farmland Pastu

Easton

Map Lot 002-006

Account 145

Location HERSOM ROAD

Card 1 Of 1 9/27/2018

Building Style 0	SF Bsmt Living 0	Layout 0
1.Conv. 5.Garrison 9.Gambrel	Fin Bsmt Grade 0 0	1.Typical 4. 7.
2.Ranch 6.Split 10.Saltbox	OPEN-5-CUSTOMIZE 0	2.Inadeq 5. 8.
3.R Ranch 7.Contemp 11.Other	Heat Type 100% 0	3.Horrid 6. 9.
4.Cape 8.Log 12.	1.HWBB/Rad 5.FWA 9.No Heat	Attic 0
Dwelling Units 0	2.HWCI 6.GravWA 10.	1.1/4 Fin 4.Full Fin 7.
Other Units 0	3.H Pump 7.Electric 11.	2.1/2 Fin 5.FI/Stair 8.
Stories 0	4.Steam 8.FI/Wall 12.	3.3/4 Fin 6. 9.None
1.1 4.1.5 7.	Cool Type 0% 9 None	Insulation 0
2.2 5.1.75 8.	1.Refrig 4.W&C Air 7.	1.Full 4.Minimal 7.
3.3 6.2.5 9.	2.Evapor 5. 8.	2.Heavy 5.Partial 8.
Exterior Walls 0	3.H Pump 6. 9.None	3.Capped 6. 9.None
1.Wood 5.Stucco 9.Other	Kitchen Style 0	Unfinished % 0%
2.Vin/Al 6.Brick 10.	1.Modern 4.Obsolete 7.	Grade & Factor 0 0%
3.Compos. 7.Stone 11.	2.Typical 5. 8.	1.E Grade 4.B Grade 7.
4.Asbestos 8.Concrete 12.	3.Old Type 6. 9.None	2.D Grade 5.A Grade 8.SC Grade
Roof Surface 0	Bath(s) Style 0	3.C Grade 6.AA Grade 9.Same
1.Asphalt 4.Composit 7.	1.Modern 4.Obsolete 7.	SQFT (Footprint) 0
2.Slate 5.Wood 8.	2.Typical 5. 8.	Condition 0
3.Metal 6.Other 9.	3.Old Type 6. 9.None	1.Poor 4.Avg 7.V G
SF Masonry Trim 0	# Rooms 0	2.Fair 5.Avg+ 8.Exc
OPEN-3-CUSTOM 0	# Bedrooms 0	3.Avg- 6.Good 9.Same
OPEN-4-CUSTOM 0	# Full Baths 0	Phys. % Good 0%
Year Built 0	# Half Baths 0	Funct. % Good 100%
Year Remodeled 0	# Addn Fixtures 0	Functional Code 9 None
Foundation 0	# Fireplaces 0	1.Incomp 4.Bsmt 7.
1.Concrete 4.Wood 7.		2.O-Built 5. 8.LongTerm
2.C Block 5.Slab 8.		3.Damage 6.L-T Vaca 9.None
3.Br/Stone 6.Piers 9.		Econ. % Good 100%
Basement 0		Economic Code None
1.1/4 Bmt 4.Full Bmt 7.		0.None 3.No Power 7.
2.1/2 Bmt 5.None 8.		1.Location 4.Generate 8.
3.3/4 Bmt 6. 9.None		2.Encroach 9.None 9.
Bsmt Gar # Cars 0		Entrance Code 0
Wet Basement 0		1.Interior 4.Vacant 7.
1.Dry 4. 7.		2.Refusal 5.Estimate 8.
2.Damp 5. 8.	3.Informed 6.Reviewed 9.	
3.Wet 6. 9.	Information Code 0	
		1.Owner 4.Agent 7.
		2.Relative 5.Estimate 8.
		3.Tenant 6.Exterior 9.

Date Inspected

Additions, Outbuildings & Improvements

Type	Year	Units	Grade	Cond	Phys.	Funct.	Sound Value
					%	%	1.One Story Fram
					%	%	2.Two Story Fram
					%	%	3.Three Story Fr
					%	%	4.1 & 1/2 Story
					%	%	5.1 & 3/4 Story
					%	%	6.2 & 1/2 Story
					%	%	21.Open Frame Por
					%	%	22.Encl Frame Por
					%	%	23.Frame Garage
					%	%	24.Frame Shed
					%	%	25.Frame Bay Wind
					%	%	26.1SFr Overhang
					%	%	27.Unfin Basement
					%	%	28.Unfinished Att
					%	%	29.Finished Attic

COLLODEL, MICHAEL P JT
COLLODEL, DONNA J
236 HERSOM ROAD
EASTON ME 04740

B4560P102 B4625P149

Previous Owner
MULLIN, JAMES K & CHARLOU V JT
11 REECEVILLE RD

COATSVILLE PA 19320
Sale Date: 3/24/2008

Inspection Witnessed By:

X	Date	Date Insp.
No./Date	Description	Date Insp.

Notes:

Easton

Property Data			Assessment Record					
Neighborhood	1 Resident/Agric.		Year	Land	Buildings	Exempt	Total	
Tree Growth Year	0		2010	16,700	76,000	0	92,700	
Recertified Date	0		2011	16,700	76,000	0	92,700	
Y Coordinate	0		2012	16,700	75,200	0	91,900	
Zone/Land Use	11 Residential		2013	16,700	74,400	0	91,100	
Secondary Zone			2014	16,700	79,700	0	96,400	
Topography	1 Level	2 Rolling	2015	43,500	118,300	0	161,800	
1.Level	4.Below St	7.	2016	43,500	118,300	15,000	146,800	
2.Rolling	5.Low	8.	2017	43,500	118,300	20,000	141,800	
3.Above St	6.Swampy	9.	2018	43,500	118,300	20,000	141,800	
Utilities	4 Drilled Well 6 Septic System							
1.Public	4.Dr Well	7.Cesspool						
2.Water	5.Dug Well	8.						
3.Sewer	6.Septic	9.None						
Street	1 Paved							
1.Paved	4.Proposed	7.						
2.Semi Imp	5.R/W	8.						
3.Gravel	6.	9.None						
FLOOD PLAIN	0		Land Data					
CLASS	1		Front Foot	Type	Effective		Influence	
Sale Data			11.Regular Lot		Frontage	Depth	Factor	Code
Sale Date	4/02/2008		12.Delta Triangle				%	1.Unimproved
Price	55,000		13.Nabla Triangle				%	2.Condition
Sale Type	1 Land Only		14.Rear Land				%	3.Topography
1.Land	4.Mobile	7.	15.Miscellaneous				%	4.Size/Shape
2.L & B	5.Other	8.					%	5.Access
3.Building	6.	9.					%	6.Restricted
Financing	9 Unknown						%	7.Corner Infl
1.Convent	4.Seller	7.	Square Foot	Square Feet				8.Environment
2.FHA/VA	5.Private	8.	16.Regular Lot				%	9.Fract Share
3.Assumed	6.Cash	9.Unknown	17.Class I Road				%	Acres
Validity	1 Arms Length Sale		18.Class II Road				%	32.Farmland Tilla
1.Valid	4.Split	7.Changes	19.Condominium				%	33.C R P
2.Related	5.Partial	8.Other	20.Sound Value				%	34.Softwood-Farm
3.Distress	6.Exempt	9.					%	35.Mixed Wood-Far
Verified	5 Public Record						%	36.Hardwood-Farm
1.Buyer	4.Agent	7.Family	Fract. Acre	Acres/Sites				37.Softwood-TG
2.Seller	5.Pub Rec	8.Other	21.Homesite (Frac	24	1.00	100	%	0
3.Lender	6.MLS	9.	22.Baselot (Fract	28	53.00	100	%	0
			23.Misc (Fract)	44	1.00	100	%	0
			Acres				%	
			24.Homesite				%	
			25.Baselot				%	
			26.Secondary				%	
			27.Frontage				%	
			28.Rear Land (All	Total Acreage		54.00		
			31.Tillable					
								46.Miscellaneous
								47.Pavement
								48.Farmland Pastu

Easton

Map Lot 002-006-A

Account 1077

Location 236 HERSOM RD

Card 1 Of 1 9/27/2018

Building Style 2 Ranch	SF Bsmt Living 0	Layout 1 Typical
1.Conv. 5.Garrison 9.Gambrel	Fin Bsmt Grade 0 0	1.Typical 4. 7.
2.Ranch 6.Split 10.Saltbox	OPEN-5-CUSTOMIZE 0	2.Inadeq 5. 8.
3.R Ranch 7.Contemp 11.Other	Heat Type 100% 1 Hot Water BB/Radiant	3.Horrid 6. 9.
4.Cape 8.Log 12.	1.HWBB/Rad 5.FWA 9.No Heat	Attic 9 None
Dwelling Units 1	2.HWCI 6.GravWA 10.	1.1/4 Fin 4.Full Fin 7.
Other Units 0	3.H Pump 7.Electric 11.	2.1/2 Fin 5.FI/Stair 8.
Stories 1 One Story	4.Steam 8.FI/Wall 12.	3.3/4 Fin 6. 9.None
1.1 4.1.5 7.	Cool Type 0% 9 None	Insulation 1 Full
2.2 5.1.75 8.	1.Refrig 4.W&C Air 7.	1.Full 4.Minimal 7.
3.3 6.2.5 9.	2.Evapor 5. 8.	2.Heavy 5.Partial 8.
Exterior Walls 2 Vinyl/Aluminum	3.H Pump 6. 9.None	3.Capped 6. 9.None
1.Wood 5.Stucco 9.Other	Kitchen Style 2 Typical	Unfinished % 0%
2.Vin/Al 6.Brick 10.	1.Modern 4.Obsolete 7.	Grade & Factor 4 Good 100%
3.Compos. 7.Stone 11.	2.Typical 5. 8.	1.E Grade 4.B Grade 7.
4.Asbestos 8.Concrete 12.	3.Old Type 6. 9.None	2.D Grade 5.A Grade 8.SC Grade
Roof Surface 1 Asphalt Shingles	Bath(s) Style 2 Typical Bath(s)	3.C Grade 6.AA Grade 9.Same
1.Asphalt 4.Composit 7.	1.Modern 4.Obsolete 7.	SQFT (Footprint) 1600
2.Slate 5.Wood 8.	2.Typical 5. 8.	Condition 4 Average
3.Metal 6.Other 9.	3.Old Type 6. 9.None	1.Poor 4.Avg 7.V G
SF Masonry Trim 0	# Rooms 5	2.Fair 5.Avg+ 8.Exc
OPEN-3-CUSTOM 0	# Bedrooms 3	3.Avg- 6.Good 9.Same
OPEN-4-CUSTOM 0	# Full Baths 2	Phys. % Good 0%
Year Built 2009	# Half Baths 0	Funct. % Good 100%
Year Remodeled 0	# Addn Fixtures 0	Functional Code 9 None
Foundation 1 Concrete	# Fireplaces 0	1.Incomp 4.Bsmt 7.
1.Concrete 4.Wood 7.	 <p>TRIO Software A Division of Harris Computer Systems</p>	2.O-Built 5. 8.LongTerm
2.C Block 5.Slab 8.		3.Damage 6.L-T Vaca 9.None
3.Br/Stone 6.Piers 9.		Econ. % Good 100%
Basement 4 Full Basement		Economic Code None
1.1/4 Bmt 4.Full Bmt 7.		0.None 3.No Power 7.
2.1/2 Bmt 5.None 8.		1.Location 4.Generate 8.
3.3/4 Bmt 6. 9.None		2.Encroach 9.None 9.
Bsmt Gar # Cars 0		Entrance Code 1 Interior Inspect
Wet Basement 1 Dry Basement		1.Interior 4.Vacant 7.
1.Dry 4. 7.		2.Refusal 5.Estimate 8.
2.Damp 5. 8.	3.Informed 6.Reviewed 9.	
3.Wet 6. 9.	Information Code 1 Owner	
		1.Owner 4.Agent 7.
		2.Relative 5.Estimate 8.
		3.Tenant 6.Exterior 9.

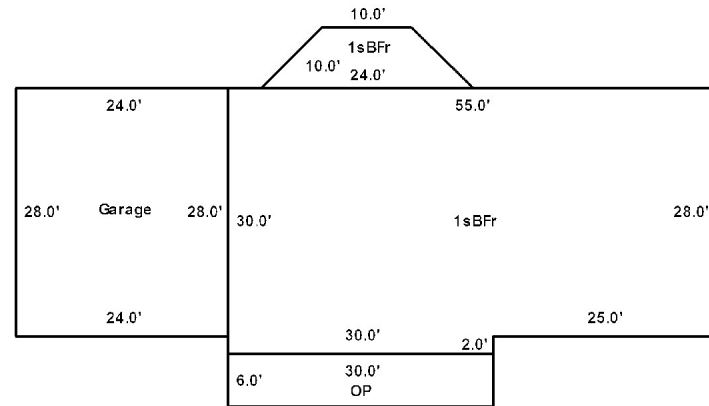
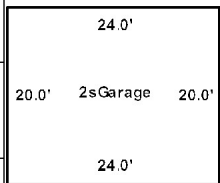

Date Inspected 6/11/2015

Additions, Outbuildings & Improvements

Type	Year	Units	Grade	Cond	Phys.	Funct.	Sound Value
21 Open Frame	0	180	0 0	0	0 %	0 %	
20 1 Story Basement	0	119	0 0	0	0 %	0 %	
23 Frame Garage	0	672	0 0	0	0 %	80 %	
43 2S Frame Garage	2013	480	3 115	4	0 %	100 %	
					%	%	
					%	%	
					%	%	
					%	%	
					%	%	
					%	%	
					%	%	



- 1.One Story Fram
- 2.Two Story Fram
- 3.Three Story Fr
- 4.1 & 1/2 Story
- 5.1 & 3/4 Story
- 6.2 & 1/2 Story
- 21.Open Frame Por
- 22.Encl Frame Por
- 23.Frame Garage
- 24.Frame Shed
- 25.Frame Bay Wind
- 26.1SFr Overhang
- 27.Unfin Basement
- 28.Unfinished Att
- 29.Finished Attic

Easton

Map Lot 002-007

Account 13

Location HERSOM ROAD

Card 1 Of 1 9/27/2018

Building Style 0	SF Bsmt Living 0	Layout 0
1.Conv. 5.Garrison 9.Gambrel	Fin Bsmt Grade 0 0	1.Typical 4. 7.
2.Ranch 6.Split 10.Saltbox	OPEN-5-CUSTOMIZE 0	2.Inadeq 5. 8.
3.R Ranch 7.Contemp 11.Other	Heat Type 100% 0	3.Horrid 6. 9.
4.Cape 8.Log 12.	1.HWBB/Rad 5.FWA 9.No Heat	Attic 0
Dwelling Units 0	2.HWCI 6.GravWA 10.	1.1/4 Fin 4.Full Fin 7.
Other Units 0	3.H Pump 7.Electric 11.	2.1/2 Fin 5.F/Stair 8.
Stories 0	4.Steam 8.F/Wall 12.	3.3/4 Fin 6. 9.None
1.1 4.1.5 7.	Cool Type 0% 9 None	Insulation 0
2.2 5.1.75 8.	1.Refrig 4.W&C Air 7.	1.Full 4.Minimal 7.
3.3 6.2.5 9.	2.Evapor 5. 8.	2.Heavy 5.Partial 8.
Exterior Walls 0	3.H Pump 6. 9.None	3.Capped 6. 9.None
1.Wood 5.Stucco 9.Other	Kitchen Style 0	Unfinished % 0%
2.Vin/Al 6.Brick 10.	1.Modern 4.Obsolete 7.	Grade & Factor 0 0%
3.Compos. 7.Stone 11.	2.Typical 5. 8.	1.E Grade 4.B Grade 7.
4.Asbestos 8.Concrete 12.	3.Old Type 6. 9.None	2.D Grade 5.A Grade 8.SC Grade
Roof Surface 0	Bath(s) Style 0	3.C Grade 6.AA Grade 9.Same
1.Asphalt 4.Composit 7.	1.Modern 4.Obsolete 7.	SQFT (Footprint) 0
2.Slate 5.Wood 8.	2.Typical 5. 8.	Condition 0
3.Metal 6.Other 9.	3.Old Type 6. 9.None	1.Poor 4.Avg 7.V G
SF Masonry Trim 0	# Rooms 0	2.Fair 5.Avg+ 8.Exc
OPEN-3-CUSTOM 0	# Bedrooms 0	3.Avg- 6.Good 9.Same
OPEN-4-CUSTOM 0	# Full Baths 0	Phys. % Good 0%
Year Built 0	# Half Baths 0	Funct. % Good 100%
Year Remodeled 0	# Addn Fixtures 0	Functional Code 9 None
Foundation 0	# Fireplaces 0	1.Incomp 4.Bsmt 7.
1.Concrete 4.Wood 7.		2.O-Built 5. 8.LongTerm
2.C Block 5.Slab 8.		3.Damage 6.L-T Vaca 9.None
3.Br/Stone 6.Piers 9.		Econ. % Good 100%
Basement 0		Economic Code None
1.1/4 Bmt 4.Full Bmt 7.		0.None 3.No Power 7.
2.1/2 Bmt 5.None 8.		1.Location 4.Generate 8.
3.3/4 Bmt 6. 9.None		2.Encroach 9.None 9.
Bsmt Gar # Cars 0		Entrance Code 0
Wet Basement 0		1.Interior 4.Vacant 7.
1.Dry 4. 7.		2.Refusal 5.Estimate 8.
2.Damp 5. 8.	3.Informed 6.Reviewed 9.	
3.Wet 6. 9.	Information Code 0	
		1.Owner 4.Agent 7.
		2.Relative 5.Estimate 8.
		3.Tenant 6.Exterior 9.

Date Inspected

Additions, Outbuildings & Improvements

Type	Year	Units	Grade	Cond	Phys.	Funct.	Sound Value
					%	%	1.One Story Fram
					%	%	2.Two Story Fram
					%	%	3.Three Story Fr
					%	%	4.1 & 1/2 Story
					%	%	5.1 & 3/4 Story
					%	%	6.2 & 1/2 Story
					%	%	21.Open Frame Por
					%	%	22.Encl Frame Por
					%	%	23.Frame Garage
					%	%	24.Frame Shed
					%	%	25.Frame Bay Wind
					%	%	26.1SFr Overhang
					%	%	27.Unfin Basement
					%	%	28.Unfinished Att
					%	%	29.Finished Attic

HAMMOND, BETTY E
HAMMOND, KENNETH J JT
202 HERSOM RD
EASTON ME 04740

B5159P198

Previous Owner
HAMMOND, BETTY E
202 HERSOM RD

EASTON ME 04740
Sale Date: 3/07/2013

Inspection Witnessed By:

X	Date	Description	Date Insp.

Notes:

Easton

Property Data			Assessment Record							
Neighborhood 1 Resident/Agric.			Year	Land	Buildings	Exempt	Total			
Tree Growth Year 0			2010	6,700	9,800	6,050	10,450			
Recertified Date 0			2011	6,700	9,100	6,050	9,750			
Y Coordinate 0			2012	6,700	8,500	5,940	9,260			
Zone/Land Use 11 Residential			2013	6,700	7,900	6,160	8,440			
Secondary Zone			2014	6,700	7,300	6,160	7,840			
Topography 1 Level 2 Rolling			2015	17,200	12,600	10,000	19,800			
1.Level 4.Below St 7.			2016	17,200	12,600	15,000	14,800			
2.Rolling 5.Low 8.			2017	17,200	12,600	20,000	9,800			
3.Above St 6.Swampy 9.			2018	17,200	12,600	20,000	9,800			
Utilities 4 Drilled Well 6 Septic System										
1.Public 4.Dr Well 7.Cesspool										
2.Water 5.Dug Well 8.										
3.Sewer 6.Septic 9.None										
Street 1 Paved										
1.Paved 4.Proposed 7.										
2.Semi Imp 5.R/W 8.										
3.Gravel 6. 9.None										
FLOOD PLAIN 0			Land Data							
CLASS 9			Front Foot	Type	Effective		Influence		Influence Codes	
Sale Date					Frontage	Depth	Factor	Code		
Price			11.Regular Lot						1.Unimproved	
Sale Type			12.Delta Triangle						2.Condition	
1.Land 4.Mobile 7.			13.Nabla Triangle						3.Topography	
2.L & B 5.Other 8.			14.Rear Land						4.Size/Shape	
3.Building 6. 9.			15.Miscellaneous						5.Access	
Financing									6.Restricted	
1.Convent 4.Seller 7.			Square Foot	Square Feet					7.Corner Infl	
2.FHA/VA 5.Private 8.			16.Regular Lot						8.Environment	
3.Assumed 6.Cash 9.Unknown			17.Class I Road						9.Fract Share	
Validity			18.Class II Road						Acres	
1.Valid 4.Split 7.Changes			19.Condominium						32.Farmland Tilla	
2.Related 5.Partial 8.Other			20.Sound Value						33.C R P	
3.Distress 6.Exempt 9.									34.Softwood-Farm	
Verified			Fract. Acre	Acreege/Sites					35.Mixed Wood-Far	
1.Buyer 4.Agent 7.Family			21.Homesite (Frac	24	1.00	100	%	0	36.Hardwood-Farm	
2.Seller 5.Pub Rec 8.Other			22.Baslot (Fract	28	0.30	100	%	0	37.Softwood-TG	
3.Lender 6.MLS 9.			23.Misc (Fract)	44	1.00	100	%	0	38.Mixed Wood-TG	
			Acres						39.Hardwood-TG	
			24.Homesite						40.Wasteland	
			25.Baslot						41.Gravel Pit	
			26.Secondary						42.Mobile Home Si	
			27.Frontage						43.Excess Indust	
			28.Rear Land (All	Total Acreege 1.30						44.Lot Improvemen
			31.Tillable							
									46.Miscellaneous	
									47.Pavement	
									48.Farmland Pastu	

Easton

Map Lot 002-007-A

Account 336

Location 202 HERSOM ROAD

Card 1 Of 1 9/27/2018

Building Style 0	SF Bsmt Living 0	Layout 0
1.Conv. 5.Garrison 9.Gambrel	Fin Bsmt Grade 0 0	1.Typical 4. 7.
2.Ranch 6.Split 10.Saltbox	OPEN-5-CUSTOMIZE 0	2.Inadeq 5. 8.
3.R Ranch 7.Contemp 11.Other	Heat Type 100% 0	3.Horrid 6. 9.
4.Cape 8.Log 12.	1.HWBB/Rad 5.FWA 9.No Heat	Attic 0
Dwelling Units 0	2.HWCI 6.GravWA 10.	1.1/4 Fin 4.Full Fin 7.
Other Units 0	3.H Pump 7.Electric 11.	2.1/2 Fin 5.FI/Stair 8.
Stories 0	4.Steam 8.FI/Wall 12.	3.3/4 Fin 6. 9.None
1.1 4.1.5 7.	Cool Type 0% 9 None	Insulation 0
2.2 5.1.75 8.	1.Refrig 4.W&C Air 7.	1.Full 4.Minimal 7.
3.3 6.2.5 9.	2.Evapor 5. 8.	2.Heavy 5.Partial 8.
Exterior Walls 0	3.H Pump 6. 9.None	3.Capped 6. 9.None
1.Wood 5.Stucco 9.Other	Kitchen Style 0	Unfinished % 0%
2.Vin/Al 6.Brick 10.	1.Modern 4.Obsolete 7.	Grade & Factor 0 0%
3.Compos. 7.Stone 11.	2.Typical 5. 8.	1.E Grade 4.B Grade 7.
4.Asbestos 8.Concrete 12.	3.Old Type 6. 9.None	2.D Grade 5.A Grade 8.SC Grade
Roof Surface 0	Bath(s) Style 0	3.C Grade 6.AA Grade 9.Same
1.Asphalt 4.Composit 7.	1.Modern 4.Obsolete 7.	SQFT (Footprint) 0
2.Slate 5.Wood 8.	2.Typical 5. 8.	Condition 0
3.Metal 6.Other 9.	3.Old Type 6. 9.None	1.Poor 4.Avg 7.V G
SF Masonry Trim 0	# Rooms 0	2.Fair 5.Avg+ 8.Exc
OPEN-3-CUSTOM 0	# Bedrooms 0	3.Avg- 6.Good 9.Same
OPEN-4-CUSTOM 0	# Full Baths 0	Phys. % Good 0%
Year Built 0	# Half Baths 0	Funct. % Good 100%
Year Remodeled 0	# Addn Fixtures 0	Functional Code 9 None
Foundation 0	# Fireplaces 0	1.Incomp 4.Bsmt 7.
1.Concrete 4.Wood 7.		2.O-Built 5. 8.LongTerm
2.C Block 5.Slab 8.		3.Damage 6.L-T Vaca 9.None
3.Br/Stone 6.Piers 9.		Econ. % Good 100%
Basement 0		Economic Code None
1.1/4 Bmt 4.Full Bmt 7.		0.None 3.No Power 7.
2.1/2 Bmt 5.None 8.		1.Location 4.Generate 8.
3.3/4 Bmt 6. 9.None		2.Encroach 9.None 9.
Bsmt Gar # Cars 0		Entrance Code 1 Interior Inspect
Wet Basement 0		1.Interior 4.Vacant 7.
1.Dry 4. 7.		2.Refusal 5.Estimate 8.
2.Damp 5. 8.		3.Informed 6.Reviewed 9.
3.Wet 6. 9.		Information Code 1 Owner
		1.Owner 4.Agent 7.
		2.Relative 5.Estimate 8.
		3.Tenant 6.Exterior 9.

Date Inspected 6/10/2015

Additions, Outbuildings & Improvements

Type	Year	Units	Grade	Cond	Phys.	Funct.	Sound Value
787 Fleetwood	1994	14x66	4 100	4	0 %	100 %	
23 Frame Garage	1941	616	2 100	3	0 %	100 %	
24 Frame Shed	2012				%	%	1,000
					%	%	
					%	%	
					%	%	
					%	%	
					%	%	
					%	%	
					%	%	
					%	%	

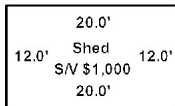
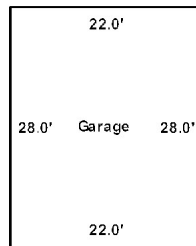
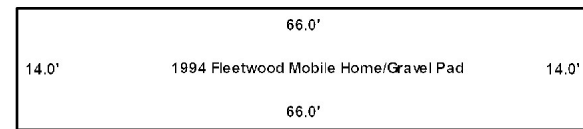

- 1.One Story Fram
- 2.Two Story Fram
- 3.Three Story Fr
- 4.1 & 1/2 Story
- 5.1 & 3/4 Story
- 6.2 & 1/2 Story
- 21.Open Frame Por
- 22.Encl Frame Por
- 23.Frame Garage
- 24.Frame Shed
- 25.Frame Bay Wind
- 26.1SFr Overhang
- 27.Unfin Basement
- 28.Unfinished Att
- 29.Finished Attic

TOWN OF EASTON
PO BOX 127
EASTON ME 04740 0127

			Property Data			Assessment Record																																																																																																																																																																																																												
			Neighborhood	1 Resident/Agric.		Year	Land	Buildings	Exempt	Total																																																																																																																																																																																																								
			Tree Growth Year		0	2010	1,200	0	1,200	0																																																																																																																																																																																																								
			Recertified Date		0	2011	1,200	0	1,200	0																																																																																																																																																																																																								
			Y Coordinate		0	2012	1,200	0	1,200	0																																																																																																																																																																																																								
			Zone/Land Use		11 Residential			2013	1,200	0	1,200	0																																																																																																																																																																																																						
			Secondary Zone			2014	1,200	0	1,200	0																																																																																																																																																																																																								
			Topography		1 Level 2 Rolling		2015	3,900	0	3,900	0																																																																																																																																																																																																							
			1.Level		4.Below St	7.	2016	3,900	0	3,900	0																																																																																																																																																																																																							
			2.Rolling		5.Low		8.	2017	3,900	0	3,900	0																																																																																																																																																																																																						
			3.Above St		6.Swampy		9.	2018	3,900	0	3,900	0																																																																																																																																																																																																						
			Utilities			9 None																																																																																																																																																																																																												
			1.Public		4.Dr Well	7.Cesspool																																																																																																																																																																																																												
			2.Water		5.Dug Well		8.																																																																																																																																																																																																											
			3.Sewer		6.Septic		9.None																																																																																																																																																																																																											
			Street		1 Paved																																																																																																																																																																																																													
			1.Paved		4.Proposed	7.	Land Data																																																																																																																																																																																																											
			2.Semi Imp		5.R/W						8.																																																																																																																																																																																																							
			3.Gravel		9.None		<table border="1"> <thead> <tr> <th rowspan="2">Front Foot</th> <th rowspan="2">Type</th> <th colspan="2">Effective</th> <th colspan="2">Influence</th> <th rowspan="2">Influence Codes</th> </tr> <tr> <th>Frontage</th> <th>Depth</th> <th>Factor</th> <th>Code</th> </tr> </thead> <tbody> <tr><td>11.Regular Lot</td><td></td><td></td><td></td><td>%</td><td></td><td>1.Unimproved</td></tr> <tr><td>12.Delta Triangle</td><td></td><td></td><td></td><td>%</td><td></td><td>2.Condition</td></tr> <tr><td>13.Nabla Triangle</td><td></td><td></td><td></td><td>%</td><td></td><td>3.Topography</td></tr> <tr><td>14.Rear Land</td><td></td><td></td><td></td><td>%</td><td></td><td>4.Size/Shape</td></tr> <tr><td>15.Miscellaneous</td><td></td><td></td><td></td><td>%</td><td></td><td>5.Access</td></tr> <tr><td></td><td></td><td></td><td></td><td>%</td><td></td><td>6.Restricted</td></tr> <tr><td></td><td></td><td></td><td></td><td>%</td><td></td><td>7.Corner Infl</td></tr> <tr><td></td><td></td><td></td><td></td><td>%</td><td></td><td>8.Environment</td></tr> <tr><td></td><td></td><td></td><td></td><td>%</td><td></td><td>9.Fract Share</td></tr> <tr><td></td><td></td><td></td><td></td><td>%</td><td></td><td>Acres</td></tr> <tr><td></td><td></td><td></td><td></td><td>%</td><td></td><td>32.Farmland Tilla</td></tr> <tr><td></td><td></td><td></td><td></td><td>%</td><td></td><td>33.C R P</td></tr> <tr><td></td><td></td><td></td><td></td><td>%</td><td></td><td>34.Softwood-Farm</td></tr> <tr><td></td><td></td><td></td><td></td><td>%</td><td></td><td>35.Mixed Wood-Far</td></tr> <tr><td></td><td></td><td></td><td></td><td>%</td><td></td><td>36.Hardwood-Farm</td></tr> <tr><td></td><td></td><td></td><td></td><td>%</td><td></td><td>37.Softwood-TG</td></tr> <tr><td></td><td></td><td></td><td></td><td>%</td><td></td><td>38.Mixed Wood-TG</td></tr> <tr><td></td><td></td><td></td><td></td><td>%</td><td></td><td>39.Hardwood-TG</td></tr> <tr><td></td><td></td><td></td><td></td><td>%</td><td></td><td>40.Wasteland</td></tr> <tr><td></td><td></td><td></td><td></td><td>%</td><td></td><td>41.Gravel Pit</td></tr> <tr><td></td><td></td><td></td><td></td><td>%</td><td></td><td>42.Mobile Home Si</td></tr> <tr><td></td><td></td><td></td><td></td><td>%</td><td></td><td>43.Excess Indust</td></tr> <tr><td></td><td></td><td></td><td></td><td>%</td><td></td><td>44.Lot Improvemen</td></tr> <tr><td></td><td></td><td></td><td></td><td>%</td><td></td><td>45.Tower Site</td></tr> <tr><td></td><td></td><td></td><td></td><td>%</td><td></td><td>46.Miscellaneous</td></tr> <tr><td></td><td></td><td></td><td></td><td>%</td><td></td><td>47.Pavement</td></tr> <tr><td></td><td></td><td></td><td></td><td>%</td><td></td><td>48.Farmland Pastu</td></tr> </tbody> </table>				Front Foot	Type	Effective		Influence		Influence Codes	Frontage	Depth	Factor	Code	11.Regular Lot				%		1.Unimproved	12.Delta Triangle				%		2.Condition	13.Nabla Triangle				%		3.Topography	14.Rear Land				%		4.Size/Shape	15.Miscellaneous				%		5.Access					%		6.Restricted					%		7.Corner Infl					%		8.Environment					%		9.Fract Share					%		Acres					%		32.Farmland Tilla					%		33.C R P					%		34.Softwood-Farm					%		35.Mixed Wood-Far					%		36.Hardwood-Farm					%		37.Softwood-TG					%		38.Mixed Wood-TG					%		39.Hardwood-TG					%		40.Wasteland					%		41.Gravel Pit					%		42.Mobile Home Si					%		43.Excess Indust					%		44.Lot Improvemen					%		45.Tower Site					%		46.Miscellaneous					%		47.Pavement					%		48.Farmland Pastu
			Front Foot	Type	Effective								Influence		Influence Codes																																																																																																																																																																																																			
Frontage	Depth	Factor			Code																																																																																																																																																																																																													
11.Regular Lot				%		1.Unimproved																																																																																																																																																																																																												
12.Delta Triangle				%		2.Condition																																																																																																																																																																																																												
13.Nabla Triangle				%		3.Topography																																																																																																																																																																																																												
14.Rear Land				%		4.Size/Shape																																																																																																																																																																																																												
15.Miscellaneous				%		5.Access																																																																																																																																																																																																												
				%		6.Restricted																																																																																																																																																																																																												
				%		7.Corner Infl																																																																																																																																																																																																												
				%		8.Environment																																																																																																																																																																																																												
				%		9.Fract Share																																																																																																																																																																																																												
				%		Acres																																																																																																																																																																																																												
				%		32.Farmland Tilla																																																																																																																																																																																																												
				%		33.C R P																																																																																																																																																																																																												
				%		34.Softwood-Farm																																																																																																																																																																																																												
				%		35.Mixed Wood-Far																																																																																																																																																																																																												
				%		36.Hardwood-Farm																																																																																																																																																																																																												
				%		37.Softwood-TG																																																																																																																																																																																																												
				%		38.Mixed Wood-TG																																																																																																																																																																																																												
				%		39.Hardwood-TG																																																																																																																																																																																																												
				%		40.Wasteland																																																																																																																																																																																																												
				%		41.Gravel Pit																																																																																																																																																																																																												
				%		42.Mobile Home Si																																																																																																																																																																																																												
				%		43.Excess Indust																																																																																																																																																																																																												
				%		44.Lot Improvemen																																																																																																																																																																																																												
				%		45.Tower Site																																																																																																																																																																																																												
				%		46.Miscellaneous																																																																																																																																																																																																												
				%		47.Pavement																																																																																																																																																																																																												
				%		48.Farmland Pastu																																																																																																																																																																																																												
			FLOOD PLAIN		0			<table border="1"> <thead> <tr> <th>Front Foot</th> <th colspan="2">Square Feet</th> <th colspan="2">Acres/Sites</th> </tr> </thead> <tbody> <tr> <td>22</td> <td colspan="2">0.66</td> <td colspan="2">50 % 4</td> </tr> <tr> <td colspan="5" style="text-align: right;">Total Acreage 0.66</td> </tr> </tbody> </table>				Front Foot	Square Feet		Acres/Sites		22	0.66		50 % 4		Total Acreage 0.66																																																																																																																																																																																												
			Front Foot	Square Feet		Acres/Sites																																																																																																																																																																																																												
22	0.66		50 % 4																																																																																																																																																																																																															
Total Acreage 0.66																																																																																																																																																																																																																		
			CLASS		1																																																																																																																																																																																																													
			Sale Data			Sale Date																																																																																																																																																																																																												
			Price			Sale Type																																																																																																																																																																																																												
			1.Land		4.Mobile	7.	16.Regular Lot																																																																																																																																																																																																											
			2.L & B		5.Other	8.	17.Class I Road																																																																																																																																																																																																											
			3.Building		6.		9.	18.Class II Road																																																																																																																																																																																																										
			Financing			19.Condominium																																																																																																																																																																																																												
			1.Convent		4.Seller	7.	20.Sound Value																																																																																																																																																																																																											
			2.FHA/VA		5.Private	8.																																																																																																																																																																																																												
			3.Assumed		6.Cash		9.Unknown																																																																																																																																																																																																											
			Validity			Fract. Acre																																																																																																																																																																																																												
			1.Valid		4.Split	7.Changes	21.Homesite (Frac																																																																																																																																																																																																											
			2.Related		5.Partial	8.Other	22.Baselot (Frac																																																																																																																																																																																																											
			3.Distress		6.Exempt		9.	23.Misc (Fract)																																																																																																																																																																																																										
			Verified			Acres																																																																																																																																																																																																												
			1.Buyer		4.Agent	7.Family	24.Homesite																																																																																																																																																																																																											
			2.Seller		5.Pub Rec	8.Other	25.Baselot																																																																																																																																																																																																											
			3.Lender		6.MLS		9.	26.Secondary																																																																																																																																																																																																										
						27.Frontage																																																																																																																																																																																																												
						28.Rear Land (All																																																																																																																																																																																																												
						31.Tillable																																																																																																																																																																																																												

Inspection Witnessed By:

X	Date	Description	Date Insp.

Notes:

Easton

Map Lot 002-008

Account 766

Location HERSOM ROAD

Card 1 Of 1 9/27/2018

Building Style	SF Bsmt Living	Layout
1.Conv. 5.Garrison 9.Gambrel	Fin Bsmt Grade	1.Typical 4. 7.
2.Ranch 6.Split 10.Saltbox	OPEN-5-CUSTOMIZE	2.Inadeq 5. 8.
3.R Ranch 7.Contemp 11.Other	Heat Type 100%	3.Horrid 6. 9.
4.Cape 8.Log 12.	1.HWBB/Rad 5.FWA 9.No Heat	Attic
Dwelling Units	2.HWCI 6.GravWA 10.	1.1/4 Fin 4.Full Fin 7.
Other Units	3.H Pump 7.Electric 11.	2.1/2 Fin 5.F/Stair 8.
Stories	4.Steam 8.F/Wall 12.	3.3/4 Fin 6. 9.None
1.1 4.1.5 7.	Cool Type 0%	Insulation
2.2 5.1.75 8.	1.Refrig 4.W&C Air 7.	1.Full 4.Minimal 7.
3.3 6.2.5 9.	2.Evapor 5. 8.	2.Heavy 5.Partial 8.
Exterior Walls	3.H Pump 6. 9.None	3.Capped 6. 9.None
1.Wood 5.Stucco 9.Other	Kitchen Style	Unfinished %
2.Vin/Al 6.Brick 10.	1.Modern 4.Obsolete 7.	Grade & Factor
3.Compos. 7.Stone 11.	2.Typical 5. 8.	1.E Grade 4.B Grade 7.
4.Asbestos 8.Concrete 12.	3.Old Type 6. 9.None	2.D Grade 5.A Grade 8.SC Grade
Roof Surface	Bath(s) Style	3.C Grade 6.AA Grade 9.Same
1.Asphalt 4.Composit 7.	1.Modern 4.Obsolete 7.	SQFT (Footprint)
2.Slate 5.Wood 8.	2.Typical 5. 8.	Condition
3.Metal 6.Other 9.	3.Old Type 6. 9.None	1.Poor 4.Avg 7.V G
SF Masonry Trim	# Rooms	2.Fair 5.Avg+ 8.Exc
OPEN-3-CUSTOM	# Bedrooms	3.Avg- 6.Good 9.Same
OPEN-4-CUSTOM	# Full Baths	Phys. % Good
Year Built	# Half Baths	Funct. % Good
Year Remodeled	# Addn Fixtures	Functional Code
Foundation	# Fireplaces	1.Incomp 4.Bsmt 7.
1.Concrete 4.Wood 7.		2.O-Built 5. 8.LongTerm
2.C Block 5.Slab 8.		3.Damage 6.L-T Vaca 9.None
3.Br/Stone 6.Piers 9.		Econ. % Good
Basement		Economic Code
1.1/4 Bmt 4.Full Bmt 7.		0.None 3.No Power 7.
2.1/2 Bmt 5.None 8.		1.Location 4.Generate 8.
3.3/4 Bmt 6. 9.None		2.Encroach 9.None 9.
Bsmt Gar # Cars		Entrance Code 0
Wet Basement		1.Interior 4.Vacant 7.
1.Dry 4. 7.		2.Refusal 5.Estimate 8.
2.Damp 5. 8.	3.Informed 6.Reviewed 9.	
3.Wet 6. 9.	Information Code 0	
Date Inspected	1.Owner 4.Agent 7.	
	2.Relative 5.Estimate 8.	
	3.Tenant 6.Exterior 9.	

Additions, Outbuildings & Improvements								1.One Story Fram
Type	Year	Units	Grade	Cond	Phys.	Funct.	Sound Value	2.Two Story Fram
					%	%		3.Three Story Fr
					%	%		4.1 & 1/2 Story
					%	%		5.1 & 3/4 Story
					%	%		6.2 & 1/2 Story
					%	%		21.Open Frame Por
					%	%		22.Encl Frame Por
					%	%		23.Frame Garage
					%	%		24.Frame Shed
					%	%		25.Frame Bay Wind
					%	%		26.1SFr Overhang
					%	%		27.Unfin Basement
					%	%		28.Unfinished Att
					%	%		29.Finished Attic

MCCRUM LAND LLC
PO BOX 660
MARS HILL ME 04758 0660

B5136P86

Previous Owner
MCCRUM, DAVID B
MCCRUM, PATRICIA T
PO BOX 660
MARS HILL ME 04758
Sale Date: 12/12/2012

Inspection Witnessed By:

X	Date	Date Insp.
No./Date	Description	Date Insp.

Notes:

Easton

Property Data			Assessment Record					
Neighborhood	1 Resident/Agric.		Year	Land	Buildings	Exempt	Total	
Tree Growth Year	0		2010	17,600	0	0	17,600	
Recertified Date	0		2011	17,600	0	0	17,600	
Y Coordinate	0		2012	17,600	0	0	17,600	
Zone/Land Use	11 Residential		2013	17,600	0	0	17,600	
Secondary Zone			2014	17,600	0	0	17,600	
Topography	1 Level	2 Rolling	2015	42,500	0	0	42,500	
1.Level	4.Below St	7.	2016	42,500	0	0	42,500	
2.Rolling	5.Low	8.	2017	42,500	0	0	42,500	
3.Above St	6.Swampy	9.	2018	42,500	0	0	42,500	
Utilities	9 None							
1.Public	4.Dr Well	7.Cesspool						
2.Water	5.Dug Well	8.						
3.Sewer	6.Septic	9.None						
Street	1 Paved							
1.Paved	4.Proposed	7.						
2.Semi Imp	5.R/W	8.						
3.Gravel	6.	9.None						
FLOOD PLAIN	0		Land Data					
CLASS	1		Front Foot	Type	Effective		Influence	
Sale Data			11.Regular Lot		Frontage	Depth	Factor	Code
			12.Delta Triangle					
Sale Date			13.Nabla Triangle					
Price			14.Rear Land					
Sale Type			15.Miscellaneous					
1.Land	4.Mobile	7.	Square Foot		Square Feet			
2.L & B	5.Other	8.	16.Regular Lot					
3.Building	6.	9.	17.Class I Road					
Financing			18.Class II Road					
1.Convent	4.Seller	7.	19.Condominium					
2.FHA/VA	5.Private	8.	20.Sound Value					
3.Assumed	6.Cash	9.Unknown	Fract. Acre		Acreage/Sites			
Validity			21.Homesite (Frac	25		1.00	100	% 0
1.Valid	4.Split	7.Changes	22.Baslot (Frac	28		42.00	100	% 0
2.Related	5.Partial	8.Other	23.Misc (Fract)	31		12.00	100	% 0
3.Distress	6.Exempt	9.	Acres					
Verified			24.Homesite					
1.Buyer	4.Agent	7.Family	25.Baslot					
2.Seller	5.Pub Rec	8.Other	26.Secondary					
3.Lender	6.MLS	9.	27.Frontage					
			28.Rear Land (All	Total Acreage		55.00		
			31.Tillable					

- 1.Unimproved
- 2.Condition
- 3.Topography
- 4.Size/Shape
- 5.Access
- 6.Restricted
- 7.Corner Infl
- 8.Environment
- 9.Fract Share
- Acres**
- 32.Farmland Tilla
- 33.C R P
- 34.Softwood-Farm
- 35.Mixed Wood-Far
- 36.Hardwood-Farm
- 37.Softwood-TG
- 38.Mixed Wood-TG
- 39.Hardwood-TG
- 40.Wasteland
- 41.Gravel Pit
- 42.Mobile Home Si
- 43.Excess Indust
- 44.Lot Improvemen
- 45.Tower Site
- 46.Miscellaneous
- 47.Pavement
- 48.Farmland Pastu

Easton

Map Lot 002-009

Account 525

Location HERSOM ROAD

Card 1 Of 1 9/27/2018

Building Style 0	SF Bsmt Living 0	Layout 0
1.Conv. 5.Garrison 9.Gambrel	Fin Bsmt Grade 0 0	1.Typical 4. 7.
2.Ranch 6.Split 10.Saltbox	OPEN-5-CUSTOMIZE 0	2.Inadeq 5. 8.
3.R Ranch 7.Contemp 11.Other	Heat Type 100% 0	3.Horrid 6. 9.
4.Cape 8.Log 12.	1.HWBB/Rad 5.FWA 9.No Heat	Attic 0
Dwelling Units 0	2.HWCI 6.GravWA 10.	1.1/4 Fin 4.Full Fin 7.
Other Units 0	3.H Pump 7.Electric 11.	2.1/2 Fin 5.F/Stair 8.
Stories 0	4.Steam 8.F/Wall 12.	3.3/4 Fin 6. 9.None
1.1 4.1.5 7.	Cool Type 0% 9 None	Insulation 0
2.2 5.1.75 8.	1.Refrig 4.W&C Air 7.	1.Full 4.Minimal 7.
3.3 6.2.5 9.	2.Evapor 5. 8.	2.Heavy 5.Partial 8.
Exterior Walls 0	3.H Pump 6. 9.None	3.Capped 6. 9.None
1.Wood 5.Stucco 9.Other	Kitchen Style 0	Unfinished % 0%
2.Vin/Al 6.Brick 10.	1.Modern 4.Obsolete 7.	Grade & Factor 0 0%
3.Compos. 7.Stone 11.	2.Typical 5. 8.	1.E Grade 4.B Grade 7.
4.Asbestos 8.Concrete 12.	3.Old Type 6. 9.None	2.D Grade 5.A Grade 8.SC Grade
Roof Surface 0	Bath(s) Style 0	3.C Grade 6.AA Grade 9.Same
1.Asphalt 4.Composit 7.	1.Modern 4.Obsolete 7.	SQFT (Footprint) 0
2.Slate 5.Wood 8.	2.Typical 5. 8.	Condition 0
3.Metal 6.Other 9.	3.Old Type 6. 9.None	1.Poor 4.Avg 7.V G
SF Masonry Trim 0	# Rooms 0	2.Fair 5.Avg+ 8.Exc
OPEN-3-CUSTOM 0	# Bedrooms 0	3.Avg- 6.Good 9.Same
OPEN-4-CUSTOM 0	# Full Baths 0	Phys. % Good 0%
Year Built 0	# Half Baths 0	Funct. % Good 100%
Year Remodeled 0	# Addn Fixtures 0	Functional Code 9 None
Foundation 0	# Fireplaces 0	1.Incomp 4.Bsmt 7.
1.Concrete 4.Wood 7.		2.O-Built 5. 8.LongTerm
2.C Block 5.Slab 8.		3.Damage 6.L-T Vaca 9.None
3.Br/Stone 6.Piers 9.		Econ. % Good 100%
Basement 0		Economic Code None
1.1/4 Bmt 4.Full Bmt 7.		0.None 3.No Power 7.
2.1/2 Bmt 5.None 8.		1.Location 4.Generate 8.
3.3/4 Bmt 6. 9.None		2.Encroach 9.None 9.
Bsmt Gar # Cars 0		Entrance Code 0
Wet Basement 0		1.Interior 4.Vacant 7.
1.Dry 4. 7.		2.Refusal 5.Estimate 8.
2.Damp 5. 8.	3.Informed 6.Reviewed 9.	
3.Wet 6. 9.	Information Code 0	
		1.Owner 4.Agent 7.
		2.Relative 5.Estimate 8.
		3.Tenant 6.Exterior 9.

Date Inspected

Additions, Outbuildings & Improvements

Type	Year	Units	Grade	Cond	Phys.	Funct.	Sound Value
					%	%	1.One Story Fram
					%	%	2.Two Story Fram
					%	%	3.Three Story Fr
					%	%	4.1 & 1/2 Story
					%	%	5.1 & 3/4 Story
					%	%	6.2 & 1/2 Story
					%	%	21.Open Frame Por
					%	%	22.Encl Frame Por
					%	%	23.Frame Garage
					%	%	24.Frame Shed
					%	%	25.Frame Bay Wind
					%	%	26.1SFr Overhang
					%	%	27.Unfin Basement
					%	%	28.Unfinished Att
					%	%	29.Finished Attic

Easton

Map Lot 002-010

Account 560

Location HERSOM ROAD

Card 1 Of 1 9/27/2018

Building Style	SF Bsmt Living	Layout
1.Conv. 5.Garrison 9.Gambrel	Fin Bsmt Grade	1.Typical 4. 7.
2.Ranch 6.Split 10.Saltbox	OPEN-5-CUSTOMIZE	2.Inadeq 5. 8.
3.R Ranch 7.Contemp 11.Other	Heat Type 100%	3.Horrid 6. 9.
4.Cape 8.Log 12.	1.HWBB/Rad 5.FWA 9.No Heat	Attic
Dwelling Units	2.HWCI 6.GravWA 10.	1.1/4 Fin 4.Full Fin 7.
Other Units	3.H Pump 7.Electric 11.	2.1/2 Fin 5.F/Stair 8.
Stories	4.Steam 8.F/Wall 12.	3.3/4 Fin 6. 9.None
1.1 4.1.5 7.	Cool Type 0%	Insulation
2.2 5.1.75 8.	1.Refrig 4.W&C Air 7.	1.Full 4.Minimal 7.
3.3 6.2.5 9.	2.Evapor 5. 8.	2.Heavy 5.Partial 8.
Exterior Walls	3.H Pump 6. 9.None	3.Capped 6. 9.None
1.Wood 5.Stucco 9.Other	Kitchen Style	Unfinished %
2.Vin/Al 6.Brick 10.	1.Modern 4.Obsolete 7.	Grade & Factor
3.Compos. 7.Stone 11.	2.Typical 5. 8.	1.E Grade 4.B Grade 7.
4.Asbestos 8.Concrete 12.	3.Old Type 6. 9.None	2.D Grade 5.A Grade 8.SC Grade
Roof Surface	Bath(s) Style	3.C Grade 6.AA Grade 9.Same
1.Asphalt 4.Composit 7.	1.Modern 4.Obsolete 7.	SQFT (Footprint)
2.Slate 5.Wood 8.	2.Typical 5. 8.	Condition
3.Metal 6.Other 9.	3.Old Type 6. 9.None	1.Poor 4.Avg 7.V G
SF Masonry Trim	# Rooms	2.Fair 5.Avg+ 8.Exc
OPEN-3-CUSTOM	# Bedrooms	3.Avg- 6.Good 9.Same
OPEN-4-CUSTOM	# Full Baths	Phys. % Good
Year Built	# Half Baths	Funct. % Good
Year Remodeled	# Addn Fixtures	Functional Code
Foundation	# Fireplaces	1.Incomp 4.Bsmt 7.
1.Concrete 4.Wood 7.		2.O-Built 5. 8.LongTerm
2.C Block 5.Slab 8.		3.Damage 6.L-T Vaca 9.None
3.Br/Stone 6.Piers 9.		Econ. % Good
Basement		Economic Code
1.1/4 Bmt 4.Full Bmt 7.		0.None 3.No Power 7.
2.1/2 Bmt 5.None 8.		1.Location 4.Generate 8.
3.3/4 Bmt 6. 9.None		2.Encroach 9.None 9.
Bsmt Gar # Cars		Entrance Code 0
Wet Basement		1.Interior 4.Vacant 7.
1.Dry 4. 7.		2.Refusal 5.Estimate 8.
2.Damp 5. 8.	3.Informed 6.Reviewed 9.	
3.Wet 6. 9.	Information Code 0	
Date Inspected	1.Owner 4.Agent 7.	
	2.Relative 5.Estimate 8.	
	3.Tenant 6.Exterior 9.	

Additions, Outbuildings & Improvements								1.One Story Fram
Type	Year	Units	Grade	Cond	Phys.	Funct.	Sound Value	2.Two Story Fram
					%	%		3.Three Story Fr
					%	%		4.1 & 1/2 Story
					%	%		5.1 & 3/4 Story
					%	%		6.2 & 1/2 Story
					%	%		21.Open Frame Por
					%	%		22.Encl Frame Por
					%	%		23.Frame Garage
					%	%		24.Frame Shed
					%	%		25.Frame Bay Wind
					%	%		26.1SFr Overhang
					%	%		27.Unfin Basement
					%	%		28.Unfinished Att
					%	%		29.Finished Attic